



STAGE III - PHASE 1 CONSTRUCTION

- 1) KEEP SIDE ROAD DETOUR-WESTBOUND E MAIN STREET PUT IN PLACE DURING STAGE II, PHASE 2
- 2) REMOVE SHORT TERM PAVEMENT STRIPING WHERE NECESSARY AND SHIFT TRAFFIC TO STAGE III TRAFFIC CONFIGURATION
- 3) PLACE TEMPORARY TRAFFIC SIGNALS AT INTERSECTION OF E CLAY ST AND VANDALIA ST AND INTERSECTION OF N MORRISON AND E MAIN ST
- 4) REMOVE EXISTING PAVEMENT AND CURB AND GUTTERS ON WEST SIDE OF IL RTE 159 ROADWAY SOUTH OF E MAIN ST TO ALLEY 156+02 AND BETWEEN E CLAY ST AND E JOHNSON ST
- 5) REMOVE EXISTING PAVEMENT AND CURB AND GUTTERS ON NORTH SIDE OF E MAIN ST AT VANDALIA ST, RECONSTRUCT CURB AND GUTTER AND CONSTRUCT PARKING AREA ON VANDALIA ST
- 6) REMOVE EXISTING PAVEMENT, CURB AND GUTTERS, AND SIDEWALKS AS REQUIRED, AND RECONSTRUCT CURB AND GUTTER ON NORTH SIDE OF E CLAY ST
- 7) REMOVE EXISTING PAVEMENT AND CURB AND GUTTER AS NEEDED, AND CONSTRUCT NEW PARKING AREA ON S MORRISON
- 8) STOP SIGNS AND STREET SIGNS INCLUDING NO LEFT/RIGHT TURN SIGNS AT SIDEROADS SHALL BE ADJUSTED AND MAINTAINED BY THE CONTRACTOR
- 9) PROPER DRAINAGE SHALL BE MAINTAINED BY THE CONTRACTOR
- 10) TWO LANES OF TRAFFIC SHALL BE MAINTAINED ON IL RTE 159 AT ALL TIMES
- 11) AT LEAST ONE LANE OF TRAFFIC SHALL BE MAINTAINED ON E MAIN ST AND E CLAY ST AT ALL TIMES

LEGEND

DIRECTION OF TRAFFIC

CONSTRUCTION

TEMPORARY HMA PAVEMENT

TRAFFIC DRUM WITH STEADY BURNING LIGHT

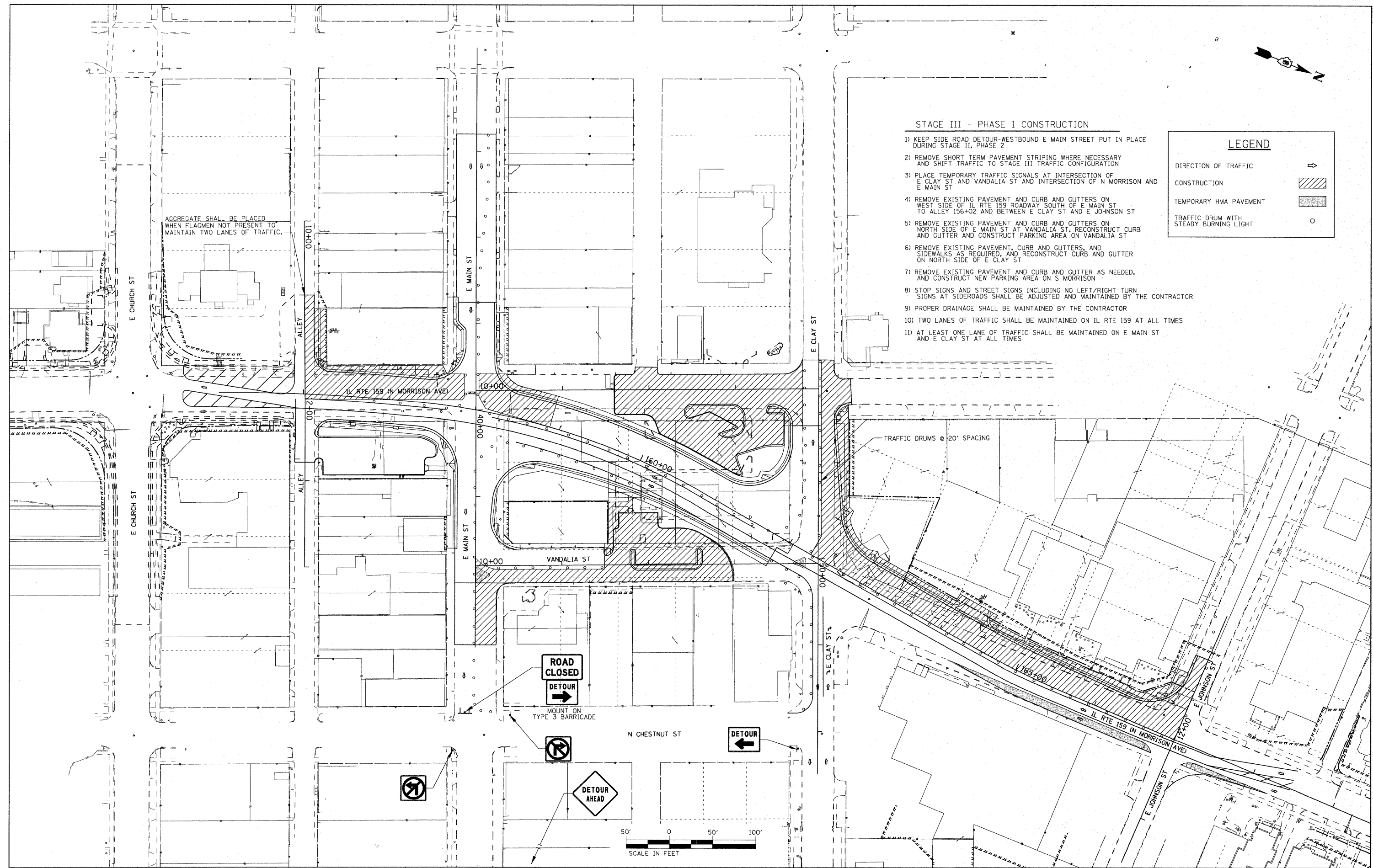

ROAD CLOSED
DETOUR

MOUNT ON TYPE 3 BARRICADE



DETOUR



FILE NAME =	USER NAME = default	DESIGNED -	REVISED -	STATE OF ILLINOIS DEPARTMENT OF TRANSPORTATION	SUGGESTED STAGES OF CONSTRUCTION AND TRAFFIC CONTROL STAGE 3 - PHASE 1	F.A.P. RTE.	SECTION	COUNTY	TOTAL SHEETS	SHEET NO.	
P:\Projects\513521\CADD\05N\0876D04-sh1	teging.dgn	DRAWN -	REVISED -			600	60-130,31,128)-N-1	MADISON	152	81	
PLOT SCALE = 50.0000' / IN.		CHECKED -	REVISED -			CONTRACT NO. 76D54					
PLOT DATE = 6/16/2012		DATE -	REVISED -			ILLINOIS FED. AID PROJECT					
					SCALE: 1" = 50' SHEET NO. 6 OF 9 SHEETS STA. N/A TO STA. N/A						