



STAGE IV - PHASE 1 CONSTRUCTION

- 1) SIDE ROAD DETOUR - WESTBOUND E CLAY ST-TO NORTHBOUND IL RTE 159 ONTO N AURORA ST-TO WESTBOUND E JOHNSON ST BACK TO IL RTE 159
- 2) REMOVE SHORT TERM PAVEMENT MARKING AND SWITCH TRAFFIC TO STAGE IV TRAFFIC CONFIGURATION
- 3) REMOVE EXISTING PAVEMENT, TEMPORARY BINDER AND SURFACE, CURB AND GUTTER, AND SIDEWALK ON EAST SIDE OF IL RTE 159 FROM E CLAY ST TO E JOHNSON ST
- 4) CONSTRUCT UTILITIES AS REQUIRED, INCLUDING STORM AND SANITARY SEWERS
- 5) CONSTRUCT NEW CURB AND GUTTER AND DRAINAGE STRUCTURES
- 6) PLACE HMA BINDER FOR EAST HALF OF IL RTE 159 ROADWAY FROM E CLAY ST TO E JOHNSON ST. TWO WAY TRAFFIC SHALL BE MAINTAINED AT ALL TIMES
- 7) STOP SIGNS AND STREET SIGNS AT SIDE ROADS SHALL BE ADJUSTED AND MAINTAINED BY THE CONTRACTOR
- 8) PROPER DRAINAGE SHALL BE MAINTAINED BY THE CONTRACTOR

LEGEND

DIRECTION OF TRAFFIC

CONSTRUCTION

TEMPORARY HMA PAVEMENT

TRAFFIC DRUM WITH STEADY BURNING LIGHT

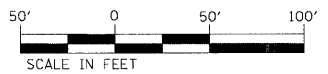
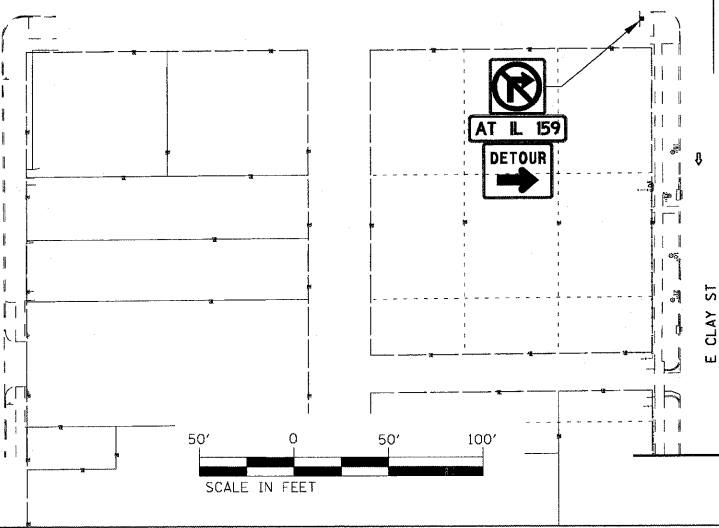
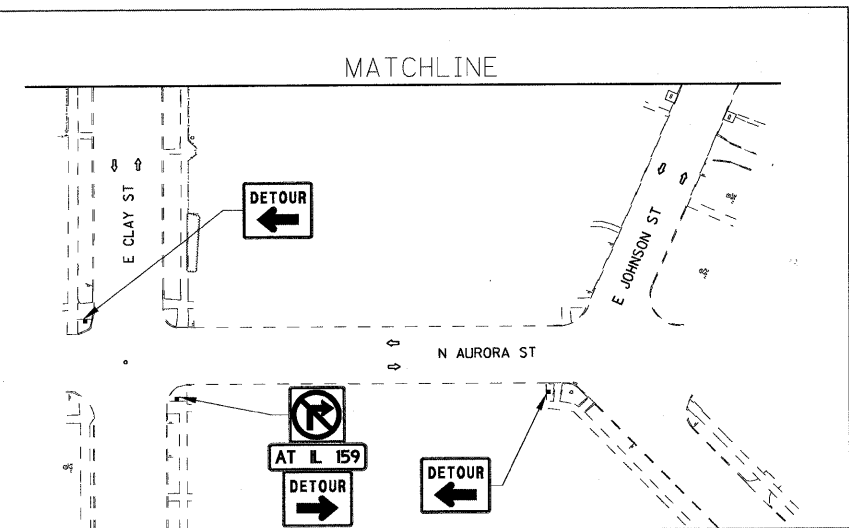
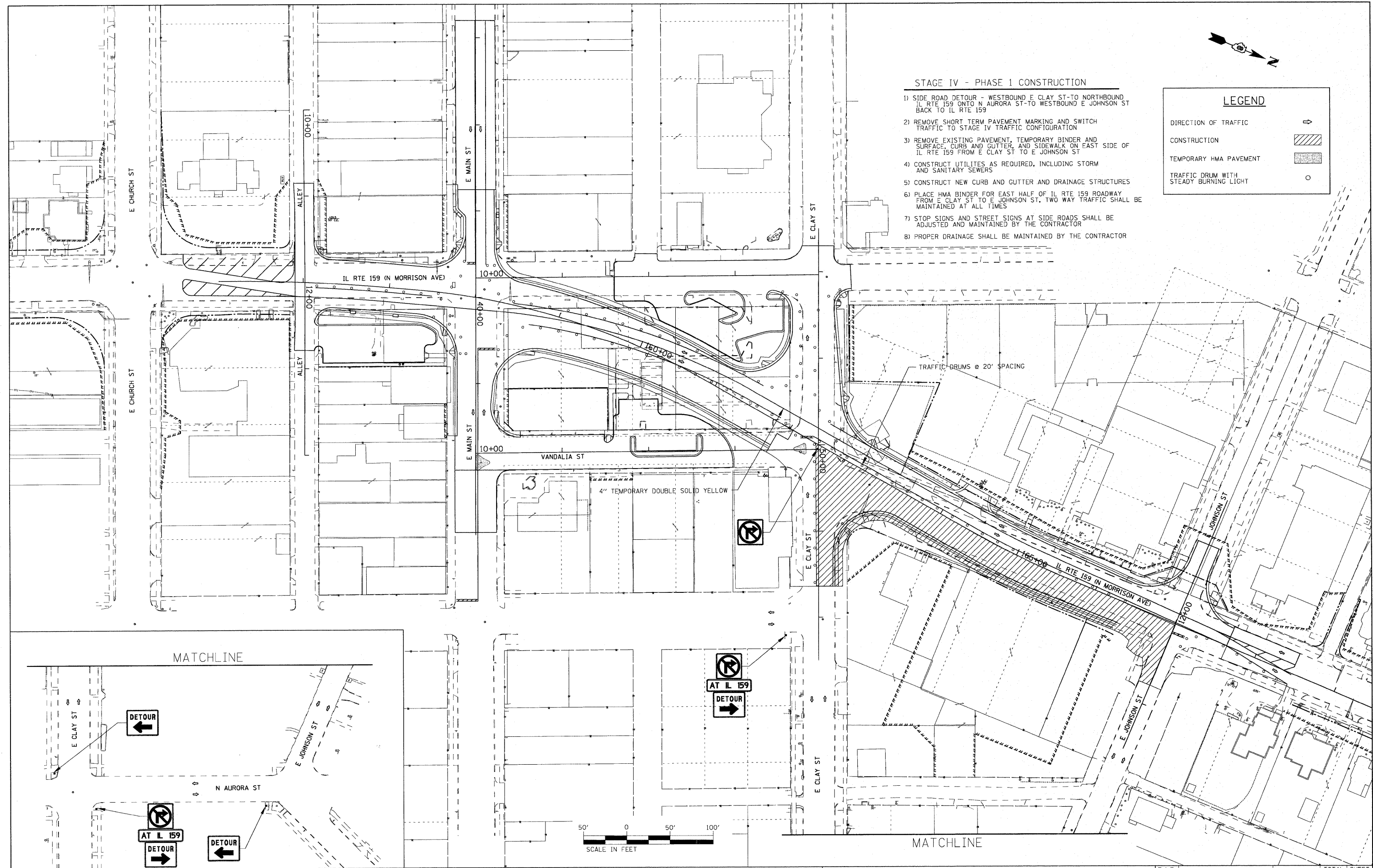

FILE NAME =	USER NAME = default	DESIGNED -	REVISED -
P:\Projects\513521\CADD\GNN\0876D54-ent\staging.dgn		DRAWN -	REVISED -
	PLOT SCALE = 50.0000' / 1" IN.	CHECKED -	REVISED -
	PLOT DATE = 6/16/2010	DATE -	REVISED -

**STATE OF ILLINOIS
DEPARTMENT OF TRANSPORTATION**

**SUGGESTED STAGES OF CONSTRUCTION AND TRAFFIC CONTROL
STAGE 4 - PHASE 1**

SCALE: 1" = 50' SHEET NO. 8 OF 9 SHEETS STA. N/A TO STA. N/A

F.A.P. RTE.	SECTION	COUNTY	TOTAL SHEETS	SHEET NO.
600	60-(30,31,128)-N-1	MADISON	152	83
CONTRACT NO. 76D54			ILLINOIS FED. AID PROJECT	