

NORTHEAST ¼ AND NORTHWEST ¼ SECTION 33, TOWNSHIP 18N RANGE 1W OF THE 4TH P.M.



CONTROL POINT TABLE				
POINT	NORTHING	EASTING	ELEVATION	DESCRIPTION
CP 1	1637.12	2821.67	565.40	IR 3/8" W/ SURVEY MARKER CAP, N. SIDE RIVER DR. IN GRASS STRIP, NE. OF 2ND INT. E. OF CULVERT
CP 2	1728.51	3443.30	565.96	IR 3/8" W/ SURVEY MARKER CAP, N. SIDE RIVER DR. IN GRASS STRIP, 5' +/- N. OF B/C, 15' +/- S.W. OF PP W/ TRANS

RIVER DRIVE ALIGNMENT TABLE		
STA	NORTHING	EASTING
10+00.00	1320.74	840.67
12+10.04	1352.08	1048.36
13+65.71	1379.73	1201.55
14+79.45	1395.87	1314.14
25+90.37	1557.03	2413.31
36+66.48	1713.48	3477.99
41+22.86	1679.30	3933.54
43+85.61	1711.68	4195.07
45+20.56	1733.21	4328.29
46+89.26	1739.18	4497.05

RIVER DRIVE CURVE DATA	RIVER DRIVE CURVE DATA	RIVER DRIVE CURVE DATA
PI STA = 36+66.48	PI STA = 41+22.86	PI STA = 45+20.56
Δ = 12° 39' 02"	Δ = 11° 20' 53"	Δ = 07° 08' 59"
R = 500.00'	R = 1200.00'	R = 1000.00'
T = 55.42'	T = 119.23'	T = 62.47'
L = 110.40'	L = 237.67'	L = 124.79'
E = 3.06'	E = 5.91'	E = 1.95'
PC STA = 36+11.06	PC STA = 40+03.63	PC STA = 44+58.08
PT STA = 37+21.46	PT STA = 42+41.31	PT STA = 45+82.87

34TH STREET ALIGNMENT TABLE		
STA	NORTHING	EASTING
66+00.00	1181.22	4365.98
71+52.40	1733.62	4363.21

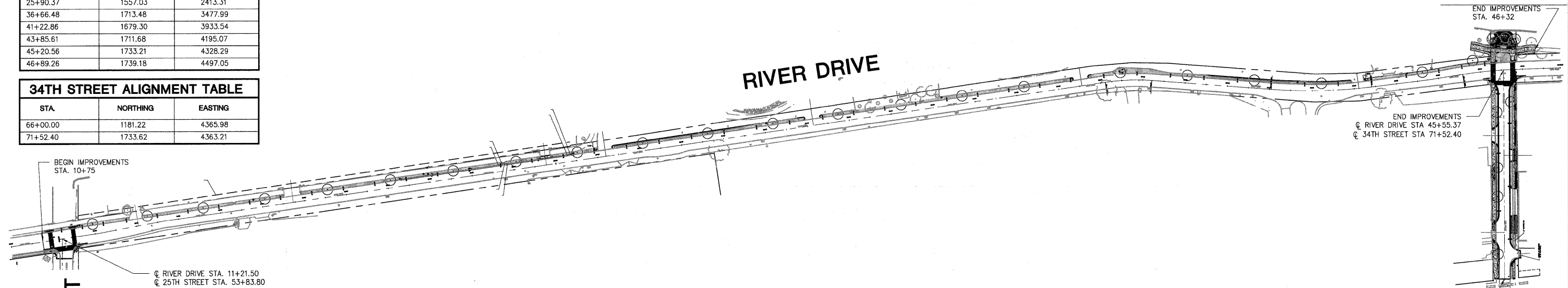

UTILITIES LEGEND

EXISTING	DESCRIPTION	BY OTHERS PROPOSED
---OE---	ELECTRIC LINE - OVERHEAD	---OHE---
---E---	ELECTRICAL LINE - UNDERGROUND	---
---4" G---	GAS MAIN	---4" G---
---S---	SANITARY SEWER	---
---STM---	STEAM	---
---S---	STORM SEWER	---
---T---	UNDERGROUND TELEPHONE	---
---W---	WATER MAIN	---

LEGEND

GENERAL SITE	
PLAN MARK	DESCRIPTION
[Hatched Box]	EXISTING STRUCTURE
[Sunburst]	EXISTING TREES
[Circle with dot]	PROPOSED TREES
[Circle with cross]	GUARD POST/ BOLLARD
[Arrow]	FLOW ARROW
[Ramp]	SIDEWALK RAMP
[Slope Arrow]	SLOPE ARROW
[Single Pole]	SINGLE POLE SIGN
[Double Pole]	DOUBLE POLE SIGN

LEGEND

SURVEY	
PLAN MARK	DESCRIPTION
[Bench Mark]	BENCH MARK
[Bridge]	BRIDGE
[Iron Rod]	IRON ROD - FOUND
[Service Pole]	SERVICE POLE

LEGEND

UTILITIES	
PLAN MARK	DESCRIPTION
[Curb Inlet]	CURB INLET
[Decorative Light]	DECORATIVE STREET LIGHT
[Manhole]	DRAINAGE MANHOLE
[Fire Hydrant]	FIRE HYDRANT
[Flared End]	FLARED END SECTION
[Gas]	GAS
[Guy Anchor]	GUY ANCHOR
[Intake Square]	INTAKE - SQUARE
[Manhole]	MANHOLE
[Midamerican Pole]	MIDAMERICAN POLE
[Sanitary Manhole]	SANITARY MANHOLE
[Telephone Pedestal]	TELEPHONE PEDESTAL
[Utility Pole]	UTILITY POLE
[Valve]	VALVE
[Water]	WATER

SHIVE HATTERY
 Cedar Rapids, IA \ Iowa City, IA \ Des Moines, IA
 Moline, IL \ Bloomington, IL \ Chicago, IL
 SHIVE-HATTERY, INC. 1701 RIVER DRIVE, SUITE 200 MOLINE, IL 61265
 PHONE (309) 764-7650 FAX (309) 764-8616
 http://www.shive-hattery.com
 ILLINOIS FIRM NUMBER: 184-000214

FILE NAME =	USER NAME = \$USER\$	DESIGNED - PHM	REVISED -	STATE OF ILLINOIS DEPARTMENT OF TRANSPORTATION	PLAN SHEET	F.A.U. RTE.	SECTION	COUNTY	TOTAL SHEETS	SHEET NO.	
\$FILEL\$		DRAWN - MAC	REVISED -			5756	06-00234-00-LS	ROCK ISLAND	30	8	
	PLOT SCALE = \$SCALE\$	CHECKED - 07-06-10	REVISED -			CONTRACT NO. 85517					
	PLOT DATE = \$DATE\$	DATE - 07-06-10	REVISED -			FED. ROAD DIST. NO. 2 ILLINOIS FED. AID PROJECT					
				SCALE: NTS	SHEET NO. 8 OF 30 SHEETS	STA.	TO STA.				