

PLAN	DESIGNED	BY	DATE
	PLOTTED		
	ALIGNED		
	CHECKED		
	NO.		
	FILE NAME		

PROFILE	DESIGNED	BY	DATE
	PLOTTED		
	GRADES		
	CHECKED		
	NO.		
	NOTATIONS		

EXIST. CURVE C2
 PI STA. = 769+23.86
 $\Delta = 40^\circ 17' 15''$ (L-F) - CONSTRUCTION LIMITS
 D = 3° 59' 43"
 R = 1,434.12'
 T = 526.06'
 L = 1,008.40'
 E = 93.44'
 e = 6.00%
 T.R. = 40.00'
 S.E. RUN = 160.00'
 P.C. STA. = 763+97.80
 P.T. STA. = 774+06.20

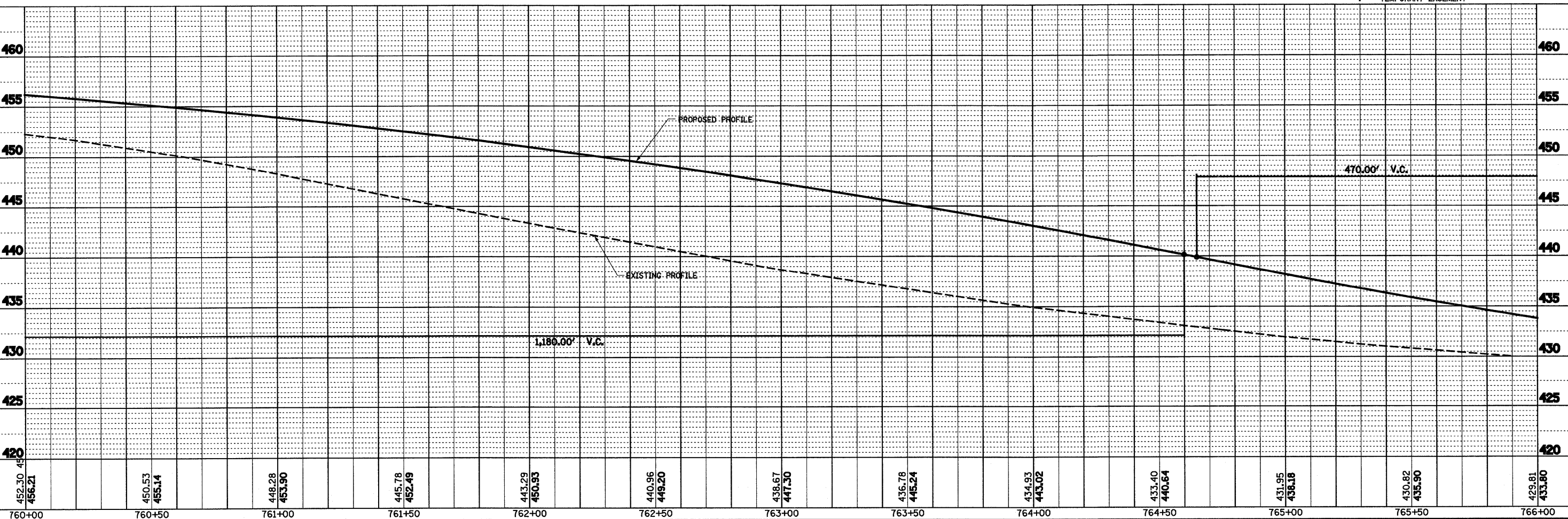
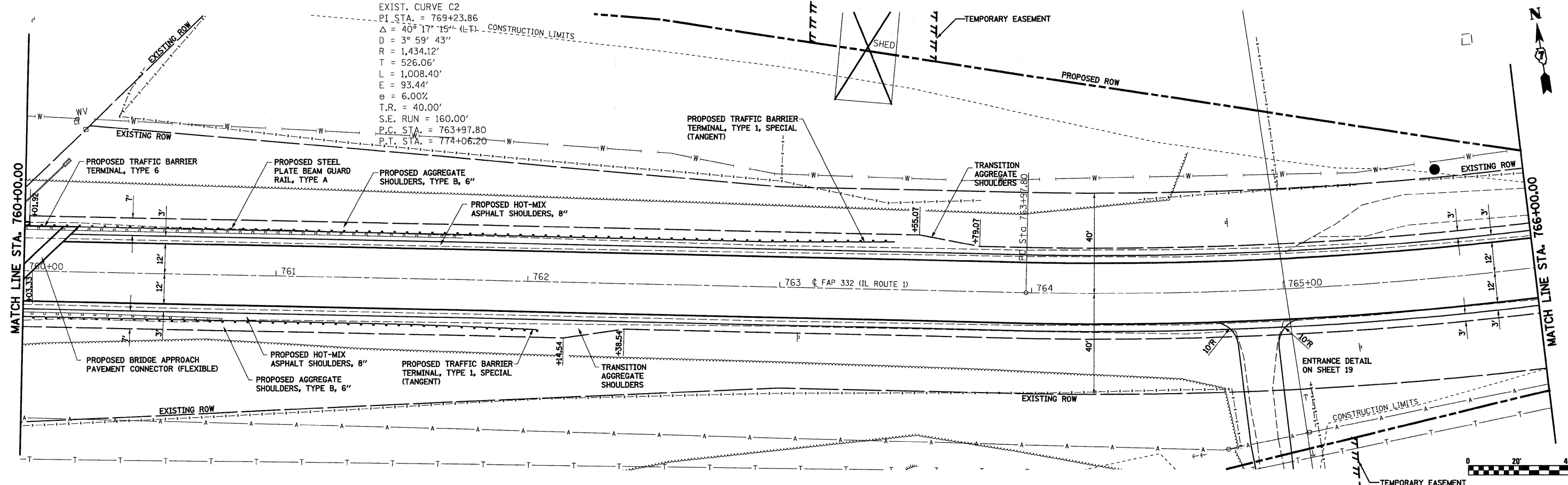

FILE NAME =	USER NAME = jennifer	DESIGNED - JLS	REVISED - 07-14-09	STATE OF ILLINOIS DEPARTMENT OF TRANSPORTATION	PLAN AND PROFILE, FAP 332 (ILLINOIS ROUTE 1)	F.A.P. RTE. = 332	SECTION = 103B-1	COUNTY = WABASH	TOTAL SHEETS = 90	SHEET NO. = 16		
PLOT SCALE = 1/4" = 20'	DATE = 7-01-08	CHECKED - BRM	REVISED - 09-28-09			SCALE: 1"=20'	SHEET NO. 3 OF 4 SHEETS	STA. 760+00.00 TO STA. 766+00.00	CONTRACT NO. 94754			
PLOT DATE = 10/1/2009		REVISOR -				FED. ROAD DIST. NO. ILLINOIS FED. AID PROJECT						