

PLAN  
 SUBMITTED BY: \_\_\_\_\_ DATE: \_\_\_\_\_  
 CHECKED BY: \_\_\_\_\_  
 NO. \_\_\_\_\_  
 TITLE \_\_\_\_\_

PROFILE  
 SUBMITTED BY: \_\_\_\_\_ DATE: \_\_\_\_\_  
 CHECKED BY: \_\_\_\_\_  
 NO. \_\_\_\_\_  
 TITLE \_\_\_\_\_

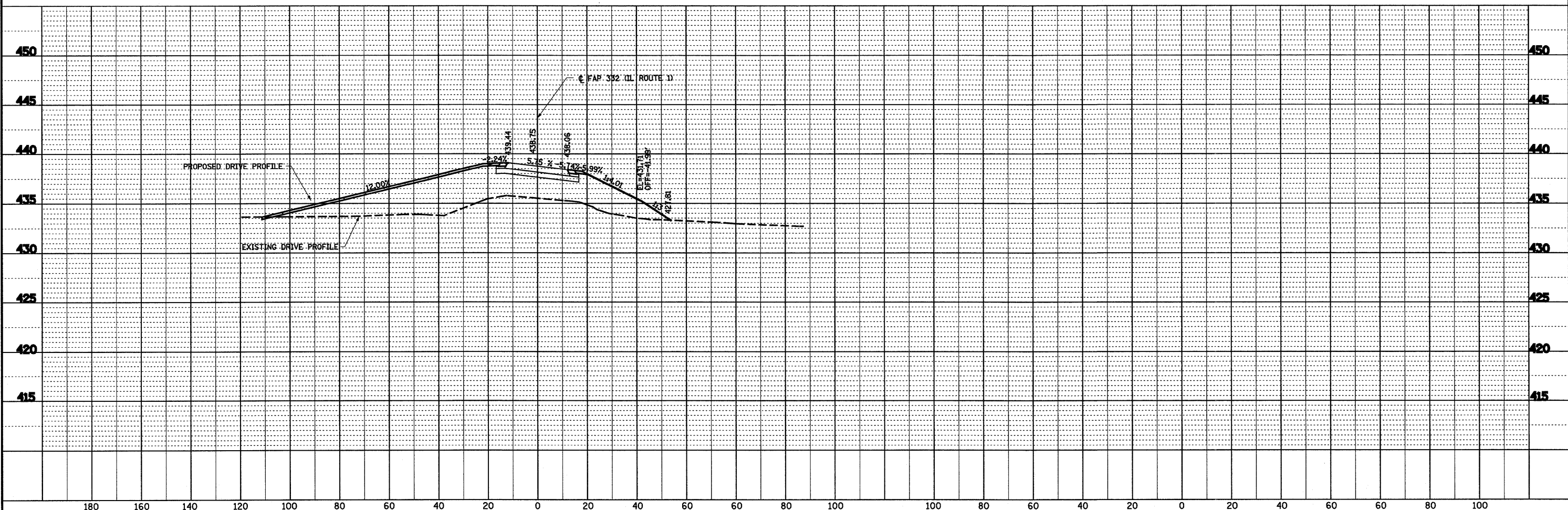
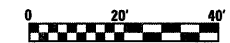
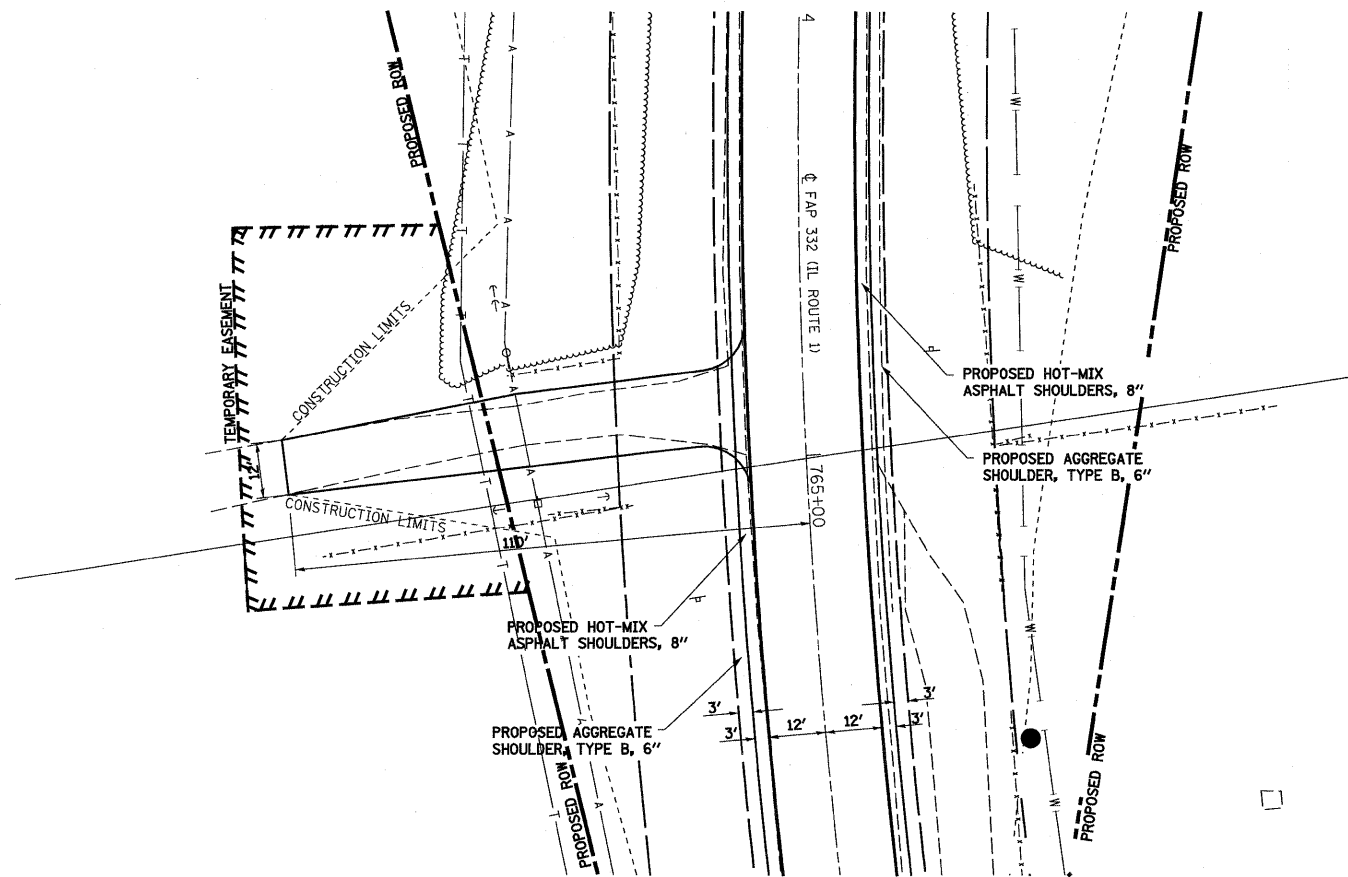

FILE NAME =	USER NAME = jennifer	DESIGNED - JLS	REVISED - 07-14-09	<b>STATE OF ILLINOIS DEPARTMENT OF TRANSPORTATION</b>		<b>ENTRANCE STA 764+88.16</b>		F.A.P. RTE. 332	SECTION 103B-1	COUNTY WABASH	TOTAL SHEETS 90	SHEET NO. 19
PROJECT NO. 2008-001 Dist. 7	DESIGNED BY: jennifer	DRAWN - MAB	REVISED - 09-28-09					CONTRACT NO. 94754				
		CHECKED - BRM	REVISED -					SCALE: 1"=20'				
		DATE - 7-01-08	REVISED -					SHEET NO. 1 OF 1 SHEETS				
PLOT SCALE = 40,000 / IN.		DATE - 10/1/2009		STA. TO STA.		FED. ROAD DIST. NO. ILLINOIS FED. AID PROJECT						