

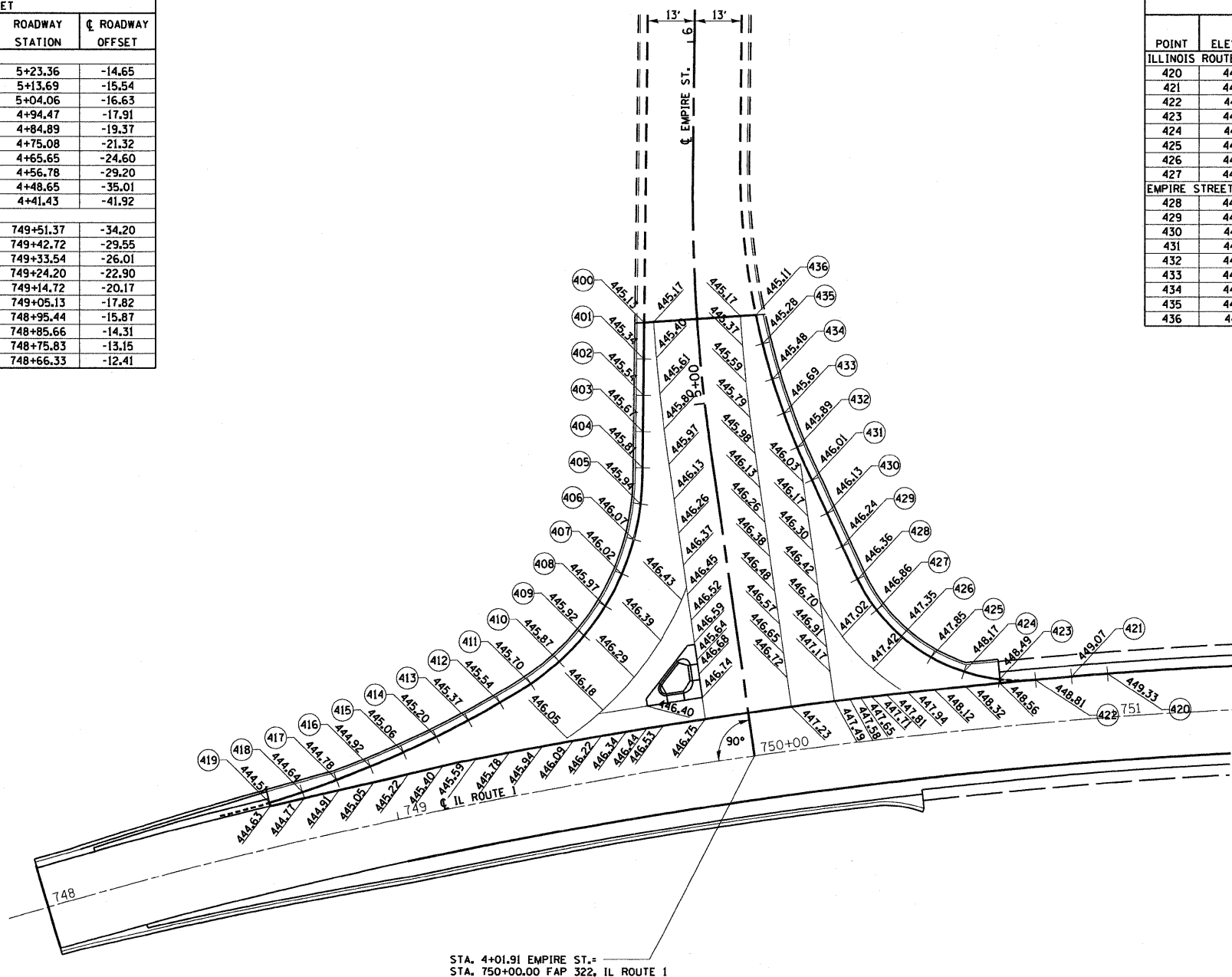

NORTHWEST QUADRANT - EMPIRE STREET					
POINT	ELEVATION	NORTHING	EASTING	ROADWAY STATION	ROADWAY OFFSET
EMPIRE STREET					
400	445.13	632,030.29	1,139,036.76	5+23.36	-14.65
401	445.34	632,020.29	1,139,036.64	5+13.69	-15.54
402	445.54	632,010.29	1,139,036.53	5+04.06	-16.63
403	445.67	632,000.29	1,139,036.42	4+94.47	-17.91
404	445.81	631,990.29	1,139,036.31	4+84.89	-19.37
405	445.94	631,980.31	1,139,035.77	4+75.08	-21.32
406	446.07	631,970.50	1,139,033.87	4+65.65	-24.60
407	446.02	631,961.07	1,139,030.58	4+56.78	-29.20
408	445.97	631,952.19	1,139,025.99	4+48.65	-35.01
409	445.92	631,944.06	1,139,020.18	4+41.43	-41.92
ILLINOIS ROUTE 1					
410	445.87	631,936.85	1,139,013.27	749+51.37	-34.20
411	445.70	631,930.68	1,139,005.41	749+42.72	-29.55
412	445.54	631,925.48	1,138,996.87	749+33.54	-26.01
413	445.37	631,920.60	1,138,988.14	749+24.20	-22.90
414	445.20	631,916.02	1,138,979.25	749+14.72	-20.17
415	445.06	631,911.74	1,138,970.21	749+05.13	-17.82
416	444.92	631,907.76	1,138,961.04	748+95.44	-15.87
417	444.78	631,904.09	1,138,951.74	748+85.66	-14.31
418	444.64	631,900.73	1,138,942.32	748+75.83	-13.15
419	444.51	631,897.80	1,138,933.16	748+66.33	-12.41

NORTHEAST QUADRANT - EMPIRE STREET					
POINT	ELEVATION	NORTHING	EASTING	ROADWAY STATION	ROADWAY OFFSET
ILLINOIS ROUTE 1					
420	449.33	631,933.60	1,139,164.93	750+99.12	-12.00
421	449.07	631,932.83	1,139,154.96	750+89.20	-12.00
422	448.81	631,931.99	1,139,145.00	750+79.28	-12.00
423	448.49	631,932.11	1,139,135.02	750+69.44	-13.03
424	448.17	631,934.22	1,139,125.26	750+60.03	-16.08
425	447.85	631,938.22	1,139,116.11	750+51.46	-21.01
426	447.35	631,943.96	1,139,107.94	750+44.09	-27.60
427	446.86	631,951.20	1,139,101.08	750+38.22	-35.59
EMPIRE STREET					
428	446.36	631,959.67	1,139,095.79	4+46.11	35.14
429	446.24	631,968.74	1,139,091.57	4+55.69	32.26
430	446.13	631,977.82	1,139,087.37	4+65.27	29.40
431	446.01	631,986.89	1,139,083.18	4+74.85	26.54
432	445.89	631,996.01	1,139,079.08	4+84.46	23.78
433	445.69	632,005.32	1,139,075.41	4+94.54	21.41
434	445.48	632,014.79	1,139,072.22	5+04.71	19.33
435	445.28	632,024.41	1,139,069.50	5+14.96	17.55
436	445.11	632,032.41	1,139,067.63	5+23.36	16.30



STA. 4+01.91 EMPIRE ST. =
 STA. 750+00.00 FAP 322, IL ROUTE 1

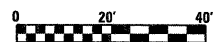

FILE NAME =	USER NAME = paul	DESIGNED - JLS	REVISED -	STATE OF ILLINOIS DEPARTMENT OF TRANSPORTATION	INTERSECTION PAVEMENT ELEVATION DETAILS, FAP 322 (ILLINOIS ROUTE 1)			F.A.P. RTE. 332	SECTION 103B-1	COUNTY WABASH	TOTAL SHEETS 90	SHEET NO. 30
Drawn by: [unclear]	Drawn by: [unclear]	DRAWN - MAB	REVISED -		SCALE: 1"=20'	SHEET NO. 2 OF 3 SHEETS	STA. TO STA.	FED. ROAD DIST. NO.	ILLINOIS FED. AID PROJECT	CONTRACT NO. 94754		
PLOT SCALE = 40.0000" / IN.	PLOT DATE = 4/29/2009	CHECKED - BRM	REVISED -									
		DATE - 6-20-08	REVISED -									