

ROUTE NO.	SECTION	CITY	TOTAL SHEETS	SHEET NO.
05-0000-01-PP		OREANA	46	25
FED. ROAD DIST. NO.	ILLINOIS		PROJECT HPP-0913 (001)	

CONTRACT NUMBER 95537

REVISIONS	NO.	BY	DATE
	1	MHP	1-8-00

SCALE: 1" = 60'

DATE: Aug. 2006
JOB NO.: 06-040A

DESIGNED: MHP
DRAWN: Les Jenkns
FIELD BOOK: XXX

BAYBRIDGE & ASSOCIATES, INC.
Consulting Engineers
1670 SOUTH TAYLORVILLE ROAD
DECATUR, ILLINOIS
Illinois License 184-001265

VILLAGE OF OREANA, ILLINOIS
SAFE TRAIL PROJECT
JOINTING DETAILS

SHEET NO. **25**
OF 46

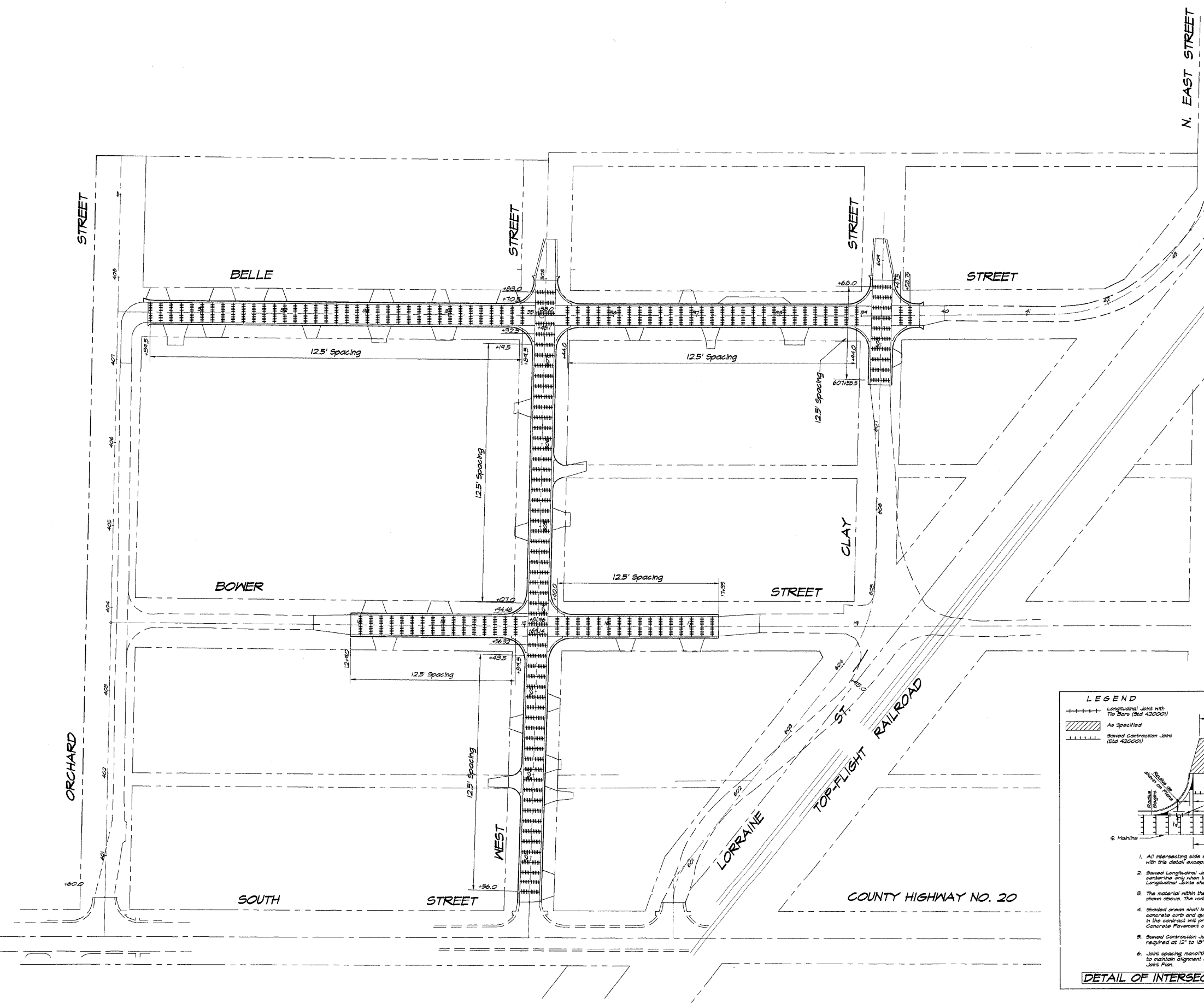

LEGEND

- Longitudinal Joint with Tie Bars (Std 42000)
- As Specified
- Saved Contraction Joint (Std 42000)

1. All intersecting side streets shall be constructed in accordance with this detail except those noted in the plans.

2. Saved Longitudinal Joints with tie bars will be slanted along the centerline only when the street return is poured full width. Other Longitudinal Joints shall be according to Standard 42000.

3. The material within the width transition area may be different than shown above. The width transition may not be required at all locations.

4. Shaded areas shall be poured monolithic with adjacent combination concrete curb and gutter. This work will be measured and included in the contract unit price per square yard for Portland Cement Concrete Pavement of the thickness specified in plans.

5. Saved Contraction Joints, as shown in Standard 42000, shall be required at 12' to 18' spacing.

6. Joint spacing, monolithic pours and other features may be modified to maintain alignment of joints between adjacent panels. See pavement Joint Plan.

DETAIL OF INTERSECTING SIDE STREET