

GENERAL NOTES:

THIS SECTION SHALL BE CONSTRUCTED IN ACCORDANCE WITH THE PLANS, SPECIAL PROVISIONS AND "STANDARD SPECIFICATIONS FOR ROAD AND BRIDGE CONSTRUCTION", ADOPTED JANUARY 1, 2007.

THE WORK INVOLVED ON THIS SECTION CONSISTS OF THE REMOVAL OF THE EXISTING STRUCTURE, THE CONSTRUCTION OF A 55 FOOT LONG SINGLE SPAN PRECAST PRESTRESSED CONCRETE DECK BEAM BRIDGE, EARTH APPROACHES, AGGREGATE SURFACE COURSE AND OTHER MISCELLANEOUS ITEMS NECESSARY TO COMPLETE THIS SECTION.

ALL ELEVATIONS ARE BASED ON U.S.G.S. MEAN SEA LEVEL DATUM.

IT SHALL BE THE CONTRACTOR'S RESPONSIBILITY TO CONTACT ALL THE UTILITIES, AFFECTING THE PROJECT, PRIOR TO CONSTRUCTION.

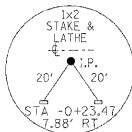

NOTE: CONSTRUCTION TRANSITIONS
 STA. 2+00 TO STA. 2+50
 STA. 7+50 TO STA. 8+00
 ALL QUANTITIES ARE INCLUDED IN THE PROPOSAL

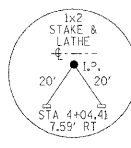

T.R.	SECTION	COUNTY	TOTAL SHEETS	SHEET NO.
185	07-06115-00-BR	EDWARDS	12	2
FED. ROAD DIST. NO. 7		ILLINOIS	BUTTER CREEK	
PROJECT: HARRIS-0470233		CONTRACT # 95633		
LEC JOB # H081025D				

323 W. 3RD ST.
 P.O. BOX 160
 MT. CARMEL, IL
 62863
 PHONE:
 (618)-262-8651
 FAX:
 (618)-263-3327

405 W. STATE ST
 SUITE 1
 PRINCETON, IN
 47870
 PHONE:
 (812)-386-7611
 FAX:
 (812)-385-2812



PROFESSIONAL DESIGN FIRM
 LAND SURVEY &
 PROFESSIONAL ENGINEERING CORPORATION
 184-030887
 (62-032435)(95-002769)

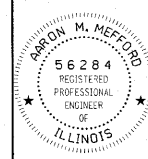

AARON M. MEFFORD
 NAME
 SIGNATURE
 DATE
 11-30-11
 EXPIRES

BUTTER CREEK
 TOWNSHIP ROUTE 185
 EDWARDS COUNTY, ILLINOIS

SHEET TITLE:

PLAN & PROFILE

SCALE: VPIES
 BY: AMM
 DATE: 6/25/10
 REV:

2 OF 12 SHEETS

SHEET NO. 2

TYPICAL CROSS SECTION PROPOSED

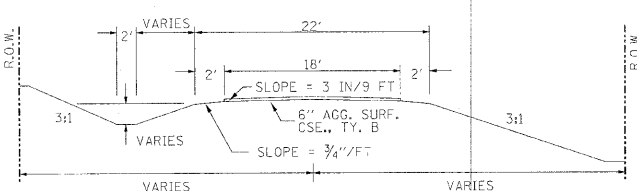

TYPICAL CROSS SECTION EXISTING

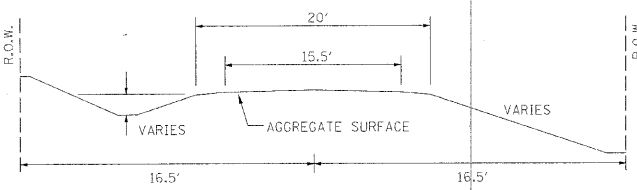

FIELD ENTRANCE DETAIL

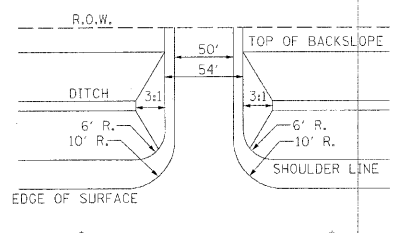

UTILITIES:
 J.U.L.L.E. 1-800-892-0123

NOTE: CONSTRUCT SPECIAL DITCH

- STA 2+00 TO STA 4+00 LT & RT
- STA 5+16 TO STA 6+81.7 RT
- STA 5+50 TO STA 7+29.5 LT
- STA 6+81.7 TO STA 8+00 RT
- STA 7+29.5 TO STA 8+00 LT

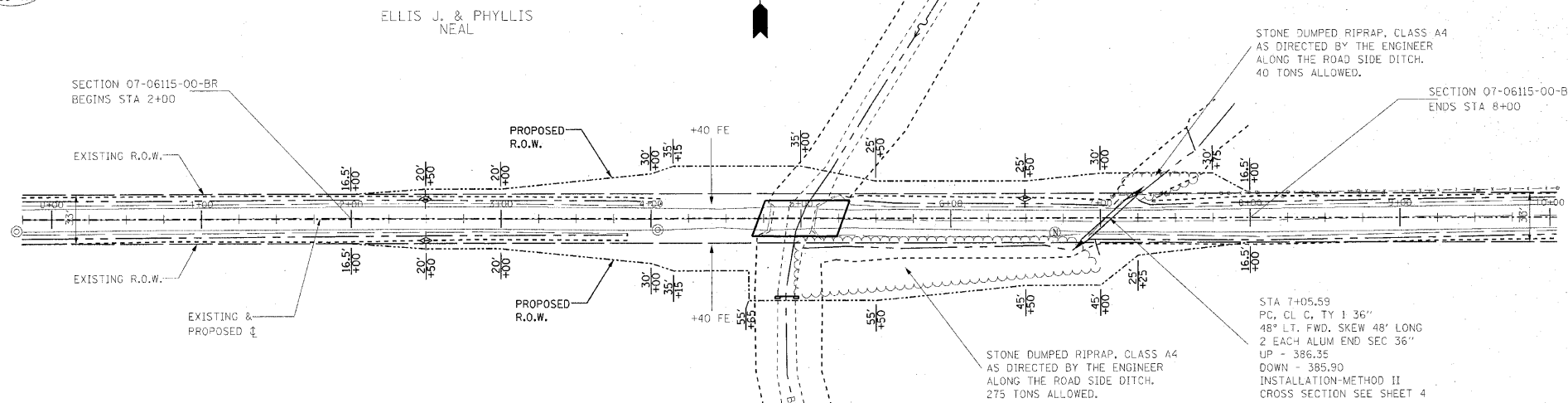

ELLIS J. & PHYLLIS NEAL

DANIEL & AMANDA METCALF

EXISTING BRIDGE STA 4+94.3; STRUCTURE NUMBER: 024-3064
 A 30' LONG SINGLE SPAN BRIDGE WITH 3" WOOD DECK WITH 2" WOOD RUNNERS ON 2-12" C-CHANNELS AND 6-12" I-BEAMS WITH 12" I-BEAM CAP ON 7-10" WOOD PILE AND STEEL PLATE MUD WALL ON EAST SIDE; CONCRETE MUD WALLS AND CONCRETE WINGWALLS ON WEST SIDE.

ONE (1) EACH-REMOVAL OF EXISTING STRUCTURES ALLOWED IN THIS PROPOSAL.

NOTE: FILL NEXT TO BRIDGE TO BE AGGREGATE SURFACE COURSE

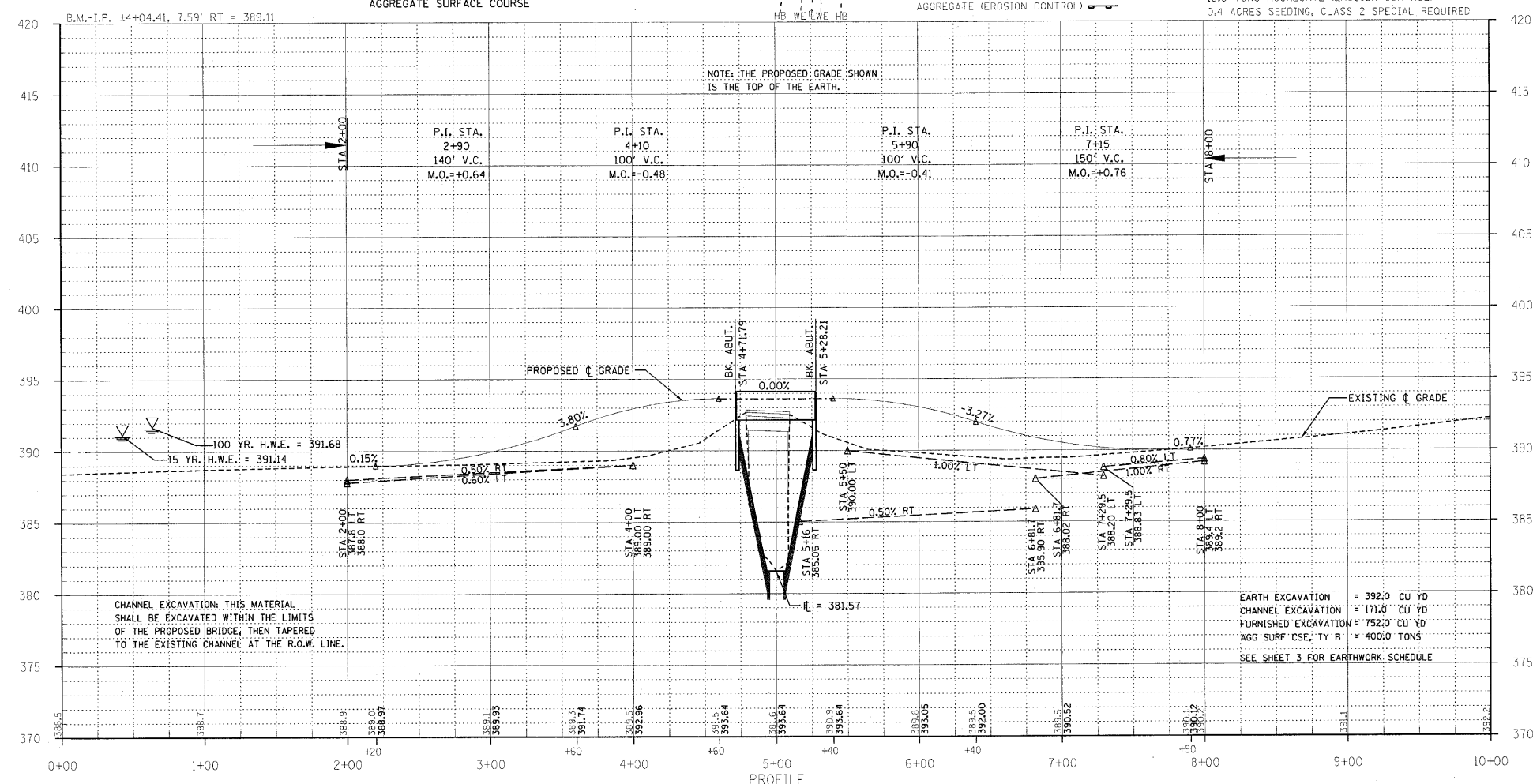

PROPOSED STRUCTURE: NO. 024-3138, STA 5+00,
 A 55' LONG SINGLE SPAN P.P.C.D.B. BRIDGE WITH 21" DEPTH BEAMS, SPILL THROUGH TYPE ABUTMENTS, 24' WIDTH, 0% GRADE, 20° LT FWD. SKEW.

SEE SHEETS 5-12 FOR THE DESIGN AND BILL OF MATERIALS.

35.0 UNIT TREE REMOVAL (6 TO 15 UNITS DIAMETER)
 74.0 UNIT TREE REMOVAL (OVER 15 UNITS DIAMETER)
 18.0 FOOT TEMPORARY DITCH CHECKS
 13.0 TONS AGGREGATE (EROSION CONTROL)
 0.4 ACRES SEEDING, CLASS 2 SPECIAL REQUIRED