

T.R.	SECTION	COUNTY	TOTAL SHEETS	SHEET NO.
4	07-05121-00-BR	WABASH	4	1
FED. ROAD DIST. NO. 7 ILLINOIS		FED. AID PROJECT		PHONE: (618)-262-8651
PROJECT # BROS-185(031)		CONTRACT # 95634		FAX: (618)-263-3327
LEC JOB # H081026WB		DRAINAGE DITCH		

323 W. 3RD ST.  
P.O. BOX 160  
MT. CARMEL, IL  
62863  
PHONE: (618)-262-8651  
FAX: (618)-263-3327

405 W. STATE ST  
SUITE 1  
PRINCETON, IN  
47670  
PHONE: (812)-386-7811  
FAX: (812)-385-2812

PROFESSIONAL DESIGN FIRM  
LAND SURVEY & PROFESSIONAL ENGINEERING CORPORATION  
184-00087  
(62-032435)(35-002789)

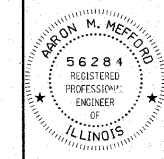

AARON M. MEFFORD  
NAME  
SIGNATURE  
DATE  
11-30-11  
EXPIRES

TOWNSHIP ROUTE 4  
OVER DRAINAGE DITCH  
WABASH COUNTY, ILLINOIS

SHEET TITLE:  
TITLE SHEET

SCALE: VARIES  
BY: AMM  
DATE: 8/31/10  
REV:

1 OF 4  
SHEETS  
SHEET NO.  
1

# STATE OF ILLINOIS DEPARTMENT OF TRANSPORTATION PLANS FOR PROPOSED FEDERAL AID – H.B.P. PROJECT

## T.R. 4 WABASH COUNTY SECTION 07-05121-00-BR PROJECT NO. BROS-185(031) JOB NO. C-97-134-10 CONTRACT #95634 DRAINAGE DITCH

### INDEX OF SHEETS

SHEET NO.	DESCRIPTION
1	TITLE SHEET & SUMMARY OF QUANTITIES
2	PLAN & PROFILE, TYPICAL SECTIONS & GENERAL NOTES
3-4	ROADWAY CROSS SECTIONS

### STANDARDS

000001-05	STANDARD SYMBOLS, ABBREVIATIONS & PATTERNS (6 SHEETS)
280001-05	TEMPORARY EROSION CONTROL SYSTEMS (2 SHEETS)
515001-03	NAME PLATE FOR BRIDGES
701901-01	TRAFFIC CONTROL DEVICES
B.L.R. 21-8	TYPICAL APPLICATION OF TRAFFIC CONTROL DEVICES FOR CONSTRUCTION ON RURAL LOCAL HIGHWAYS
B.L.R. 22-6	TYPICAL APPLICATION OF TRAFFIC CONTROL DEVICES FOR CONSTRUCTION ON RURAL LOCAL HIGHWAYS (TWO-LANE TWO-WAY RURAL TRAFFIC) (ROAD CLOSED TO THRU TRAFFIC)
B.L.R. 26-2	STEEL PLATE BEAM GUARDRAIL 27 1/2" HEIGHT

### SUMMARY OF QUANTITIES

QUANTITY	UNIT	ITEM	CODE NO.
6.00	CU YD	EARTH EXCAVATION	20200100
167.00	CU YD	FURNISHED EXCAVATION	20400800
464.00	TON	POROUS GRANULAR BACKFILL	20900310
0.20	ACRE	SEEDING, CLASS 2 (SPECIAL)	25001000
9.00	TON	AGGREGATE (EROSION CONTROL)	28001000
360.00	TON	STONE DUMPED RIPRAP, CLASS A4	28100807
160.00	TON	AGGREGATE SURFACE COURSE, TYPE B	40200800
1.00	EACH	REMOVAL OF EXISTING STRUCTURES	50100100
194.00	CU YD	STRUCTURE EXCAVATION	50200100
1.00	EACH	NAME PLATES	51500100
60.00	FOOT	PIPE CULVERTS, CLASS D, TYPE 1 15"	54200220
60.00	FOOT	PIPE CULVERTS, CLASS D, TYPE 1 24"	54200229
94.00	FOOT	STEEL PLATE BEAM GUARDRAIL, TYPE A, 6 FOOT POSTS	63000001 *
1.00	L SUM	MOBILIZATION	67100100
22.50	FOOT	ALUMINUM STRUCTURAL PLATE BOX CULVERT (SPECIAL) 142 SQUARE FOOT	
2.00	EACH	TRAFFIC BARRIER TERMINAL, TYPE I	LR631020 *

\*SPECIALTY ITEMS

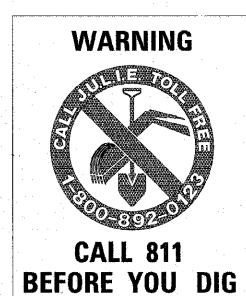

DESIGN DESIGNATION:  
DESIGN SPEED: 30 MPH  
HIGHWAY CLASS - LOCAL ROAD  
EXISTING STRUCTURE NO.: 093-3012  
PROPOSED STRUCTURE NO.: 093-5005  
CURRENT A.D.T. = 75  
CONTRACT NO. 95634

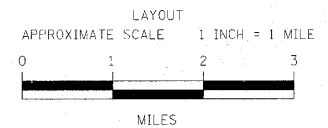
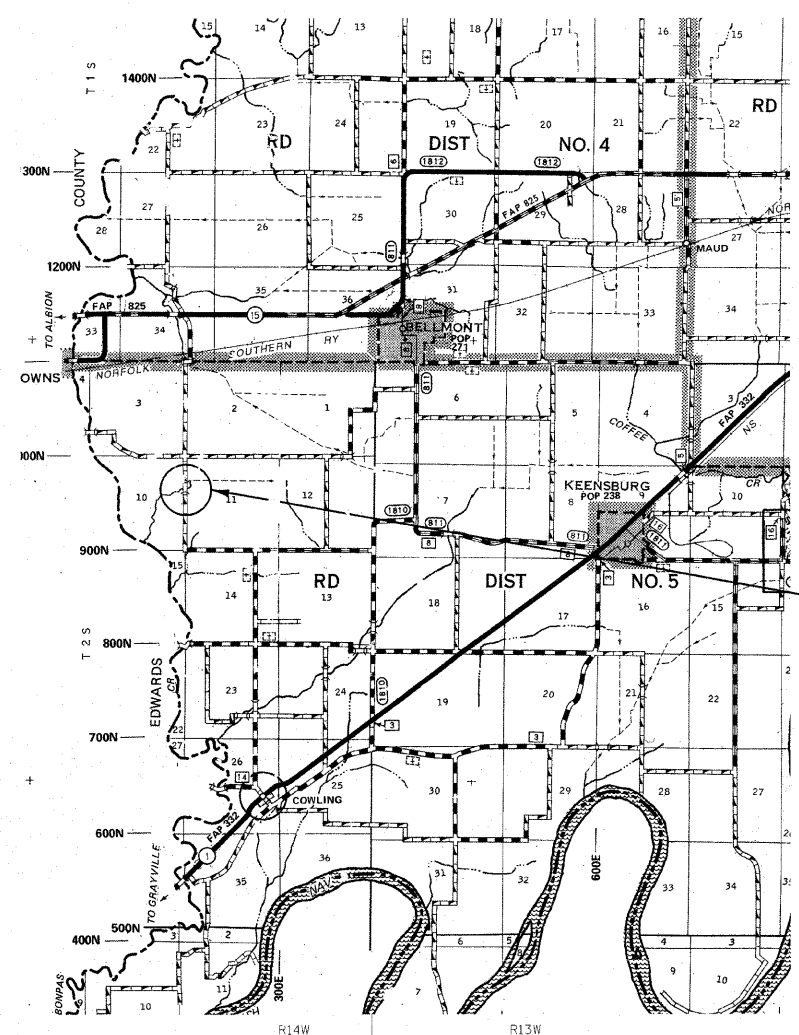

GROSS LENGTH	125.00 FT	0.024 MILES
OMISSIONS	0.00 FT	0.000 MILES
NET LENGTH	125.00 FT	0.024 MILES

PLAN	1" = 50'	
PROFILE	1" = 50'	
PROFILE VERT.	1" = 5'	
CROSS SECTION	1" = 5'	

SECTION 07-05121-00-BR  
BEGIN: STATION 4+25

STATION 5+00, STRUCTURE NO. 093-5005  
AN ALUMINUM STRUCTURAL PLATE BOX CULVERT  
(SPECIAL) 142.6 SQ. FT. 22.5' LENGTH;  
INCLUDING HEADWALLS AND WINGWALLS.

SECTION 07-05121-00-BR  
ENDS STATION 5+50

APPROVED June 30, 2010

[Signature]  
COUNTY ENGINEER

PASSED 7-12 2010

Maurice Carl  
DISTRICT SEVEN ENGINEER OF  
LOCAL ROADS & STREETS

Releasing For  
Bid Based on  
Limited Review 7/12 2010

Roger L. Drushel  
DEPUTY DIRECTOR OF HIGHWAYS,  
REGION FOUR ENGINEER

STATE OF ILLINOIS  
DEPARTMENT OF TRANSPORTATION