

GENERAL NOTES:

THIS SECTION SHALL BE CONSTRUCTED IN ACCORDANCE WITH THE PLANS, SPECIAL PROVISIONS AND "STANDARD SPECIFICATIONS FOR ROAD AND BRIDGE CONSTRUCTION", ADOPTED JANUARY 1, 2007.

THE WORK INVOLVED ON THIS SECTION CONSISTS OF THE REMOVAL OF THE EXISTING STRUCTURE, THE CONSTRUCTION OF A 142.6 SQUARE FOOT OPENING ALUMINUM BOX CULVERT, EARTH APPROACHES, AGGREGATE SURFACE COURSE AND OTHER MISCELLANEOUS ITEMS NECESSARY TO COMPLETE THIS SECTION.

ALL ELEVATIONS ARE BASED ON U.S.G.S. MEAN SEA LEVEL DATUM.

IT SHALL BE THE CONTRACTOR'S RESPONSIBILITY TO CONTACT ALL THE UTILITIES, AFFECTING THE PROJECT, PRIOR TO CONSTRUCTION.

NOTE: CONSTRUCTION TRANSITION
 STA. 4+25 TO STA 4+75
 STA 5+00 TO STA 5+50

ALL QUANTITIES ARE INCLUDED IN THE PROPOSAL

T.R.	SECTION	COUNTY	TOTAL SHEETS	SHEET NO.
4	07-05121-00-BR	WABASH	4	2
FED. ROAD DIST. NO. 7 ILLINOIS		FED. AID PROJECT		
PROJECT# BROS-185(031)		CONTRACT# 95634		
JOB NO. C-97-134-10		DRAINAGE DITCH		
LEC JOB # HOBL026WB				

323 W. 3RD ST.
 P.O. BOX 180
 MT. CARMEL, IL
 62863
 PHONE:
 (618)-262-8651
 FAX:
 (618)-263-3327

405 W. STATE ST
 SUITE 1
 PRINCETON, IN
 47670
 PHONE:
 (812)-386-7611
 FAX:
 (812)-386-2812



PROFESSIONAL DESIGN FIRM
 LAND SURVEY &
 PROFESSIONAL
 ENGINEERING
 CORPORATION
 184-00087
 (62-032435)/(35-002769)



AARON M. MEFFORD
 NAME
 SIGNATURE
 DATE
 6-30-11
 11-30-11
 EXPIRES

TOWNSHIP ROUTE 4
 OVER DRAINAGE DITCH
 WABASH COUNTY, ILLINOIS

SHEET TITLE:
 PLAN & PROFILE

SCALE: VARIES
 BY: AMM
 DATE: 6/30/11
 REV:

2 OF 4
 SHEETS
 SHEET NO.
 2

TYPICAL CROSS SECTION PROPOSED

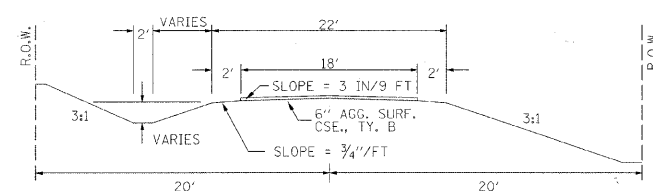

TYPICAL CROSS SECTION EXISTING

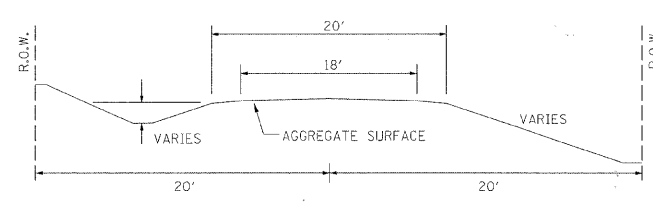

NOTE: STEEL PLATE BEAM GUARDRAIL TYPE A

STA 4+78 TO STA 5+20 LT
 STA 4+84 TO STA 5+28 RT

NOTE: TRAFFIC BARRIER TERMINAL TYPE 1

STA 4+68 TO STA 4+84 RT
 STA 5+20 TO STA 5+45 LT

UTILITIES:

J.U.L.L.E.
 1-800-892-0123
 MT. CARMEL PUBLIC UTILITY
 1-618-262-5151
 AMEREN CIPS
 1-888-789-2477

FIELD ENTRANCE DETAIL

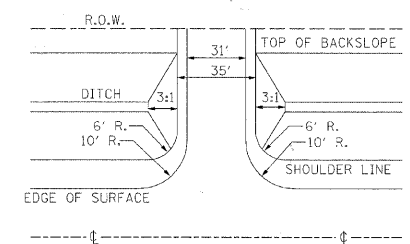

DRAINAGE DITCH
 BUILT 2011 BY
 WABASH COUNTY
 SEC. 07-05121-00-BR
 ROAD DISTRICT #5
 STR. NO. 093-5005
 LOADING HS-20

NAME PLATE
 5' @ 5' @ 515001

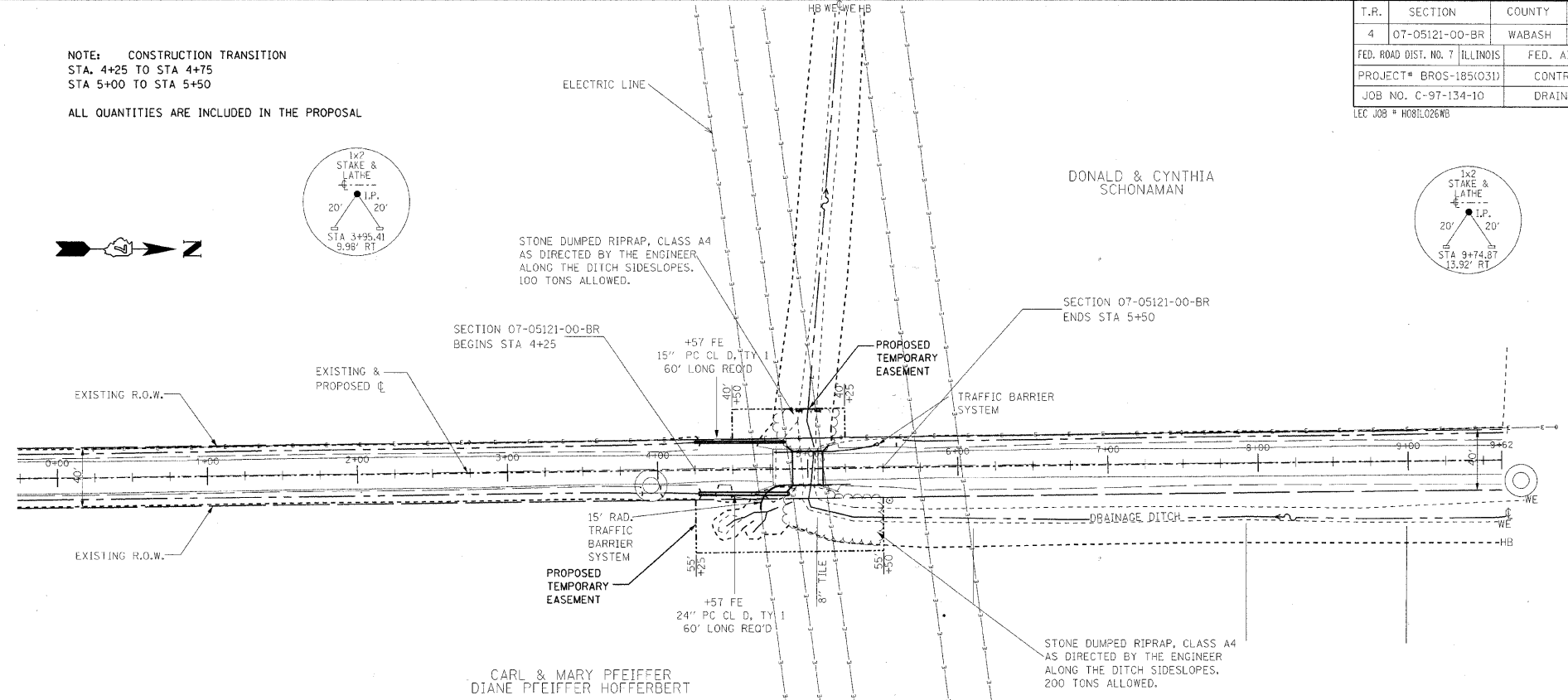

EXISTING BRIDGE STA 4+91.8; STRUCTURE NUMBER: 093-3012
 A 30' LONG SINGLE SPAN 27" CONCRETE DECK BEAMS BRIDGE WITH
 WOOD CAP ON WOOD PILING WITH WOOD MIDWALLS AND WOOD WINGWALLS.

ONE (1) EACH-REMOVAL OF EXISTING STRUCTURES ALLOWED IN
 THIS PROPOSAL.

NOTE: FILL NEXT TO BRIDGE TO BE
 POROUS GRANULAR BACKFILL

PROPOSED STRUCTURE: NO. 093-5005, STA 5+00,
 ALUMINUM STRUCTURAL PLATE BOX CULVERT (SPECIAL) 142.6 SQ. FT.
 22.5' LENGTH 0° SKEW; INCLUDING HEADWALLS AND WINGWALLS.
 60 TON STONE DUMPED RIPRAP, CLASS A4 SHALL BE PLACED AT THE
 BOTTOM OF THE PROPOSED STRUCTURE.

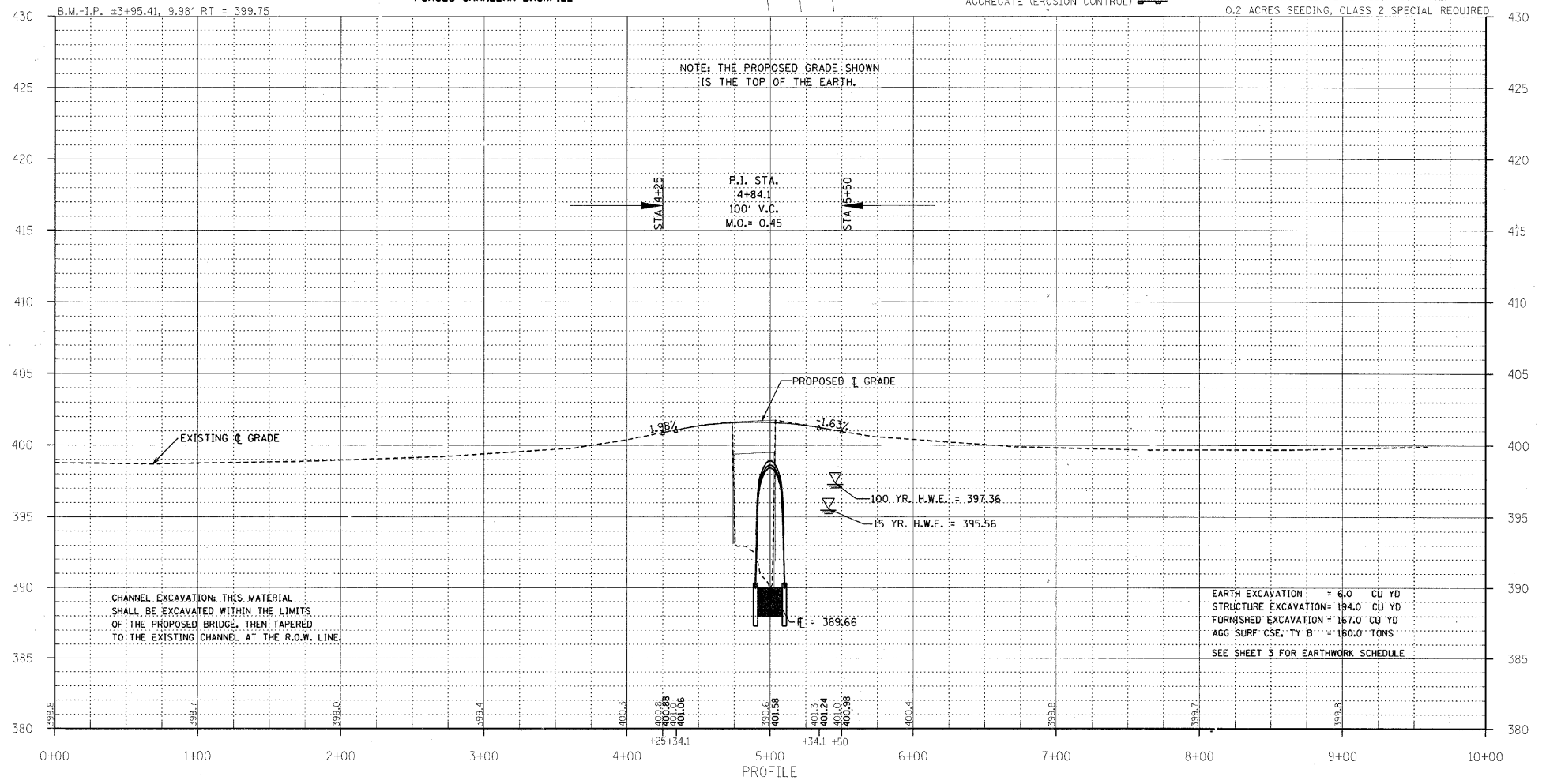

PROFILE
 0+00 1+00 2+00 3+00 4+00 4+25+34.1 5+00 5+34.1+50 6+00 7+00 8+00 9+00 10+00