

T.R.	SECTION	COUNTY	TOTAL SHEETS	SHEET NO.
4	07-05121-00-BR	WABASH	4	1
FED. ROAD DIST. NO. 7 ILLINOIS		FED. AID PROJECT		
PROJECT # BROS-185(031)		CONTRACT # 95634		
LEC JOB # H081026WB		DRAINAGE DITCH		

323 W. 3RD ST.
P.O. BOX 160
MT. CARMEL, IL
62863
PHONE:
(618)-262-8651
FAX:
(618)-263-3327

405 W. STATE ST
SUITE 1
PRINCETON, IN
47670
PHONE:
(812)-386-7811
FAX:
(812)-385-2812



PROFESSIONAL DESIGN FIRM
LAND SURVEY & PROFESSIONAL ENGINEERING CORPORATION
184-00087
(62-032435)(35-002789)

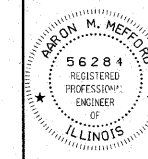

AARON M. MEFFORD
NAME
Aaron Mefford
SIGNATURE
6-30-11
DATE
11-30-11
EXPIRES

TOWNSHIP ROUTE 4
OVER DRAINAGE DITCH
WABASH COUNTY, ILLINOIS

SHEET TITLE:

TITLE SHEET

SCALE: VARIES

BY: AMM

DATE: 6/30/11

REV:

1 OF 4

SHEETS

SHEET NO.
1

INDEX OF SHEETS

SHEET NO.	DESCRIPTION
1	TITLE SHEET & SUMMARY OF QUANTITIES
2	PLAN & PROFILE, TYPICAL SECTIONS & GENERAL NOTES
3-4	ROADWAY CROSS SECTIONS

STANDARDS

000001-05	STANDARD SYMBOLS, ABBREVIATIONS & PATTERNS (6 SHEETS)
280001-05	TEMPORARY EROSION CONTROL SYSTEMS (2 SHEETS)
515001-03	NAME PLATE FOR BRIDGES
701901-01	TRAFFIC CONTROL DEVICES
B.L.R. 21-8	TYPICAL APPLICATION OF TRAFFIC CONTROL DEVICES FOR CONSTRUCTION ON RURAL LOCAL HIGHWAYS
B.L.R. 22-6	TYPICAL APPLICATION OF TRAFFIC CONTROL DEVICES FOR CONSTRUCTION ON RURAL LOCAL HIGHWAYS (TWO-LANE TWO-WAY RURAL TRAFFIC) (ROAD CLOSED TO THRU TRAFFIC)
B.L.R. 26-2	STEEL PLATE BEAM GUARDRAIL 27 1/2" HEIGHT

SUMMARY OF QUANTITIES

QUANTITY	UNIT	ITEM	CODE NO.
6.00	CU YD	EARTH EXCAVATION	20200100
167.00	CU YD	FURNISHED EXCAVATION	20400800
464.00	TON	POROUS GRANULAR BACKFILL	20900310
0.20	ACRE	SEEDING, CLASS 2 (SPECIAL)	25001000
9.00	TON	AGGREGATE (EROSION CONTROL)	28001000
360.00	TON	STONE DUMPED RIPRAP, CLASS A4	28100807
160.00	TON	AGGREGATE SURFACE COURSE, TYPE B	40200800
1.00	EACH	REMOVAL OF EXISTING STRUCTURES	50100100
194.00	CU YD	STRUCTURE EXCAVATION	50200100
1.00	EACH	NAME PLATES	51500100
60.00	FOOT	PIPE CULVERTS, CLASS D, TYPE 1 15"	54200220
60.00	FOOT	PIPE CULVERTS, CLASS D, TYPE 1 24"	54200229
94.00	FOOT	STEEL PLATE BEAM GUARDRAIL, TYPE A, 6 FOOT POSTS	63000001 *
1.00	L SUM	MOBILIZATION	67100100
22.50	FOOT	ALUMINUM STRUCTURAL PLATE BOX CULVERT (SPECIAL) 142 SQUARE FOOT	
2.00	EACH	TRAFFIC BARRIER TERMINAL, TYPE 1	LR631020 *

*SPECIALTY ITEMS

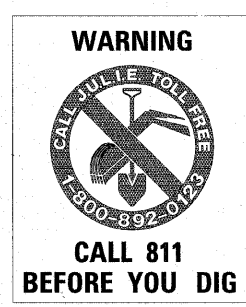

DESIGN DESIGNATION:
DESIGN SPEED: 30 MPH
HIGHWAY CLASS - LOCAL ROAD
EXISTING STRUCTURE NO.: 093-3012
PROPOSED STRUCTURE NO.: 093-5005
CURRENT A.D.T. = 75
CONTRACT NO. 95634



STATE OF ILLINOIS DEPARTMENT OF TRANSPORTATION PLANS FOR PROPOSED FEDERAL AID - H.B.P. PROJECT

T.R. 4 WABASH COUNTY SECTION 07-05121-00-BR
PROJECT NO. BROS-185(031) JOB NO. C-97-134-10
CONTRACT #95634 DRAINAGE DITCH

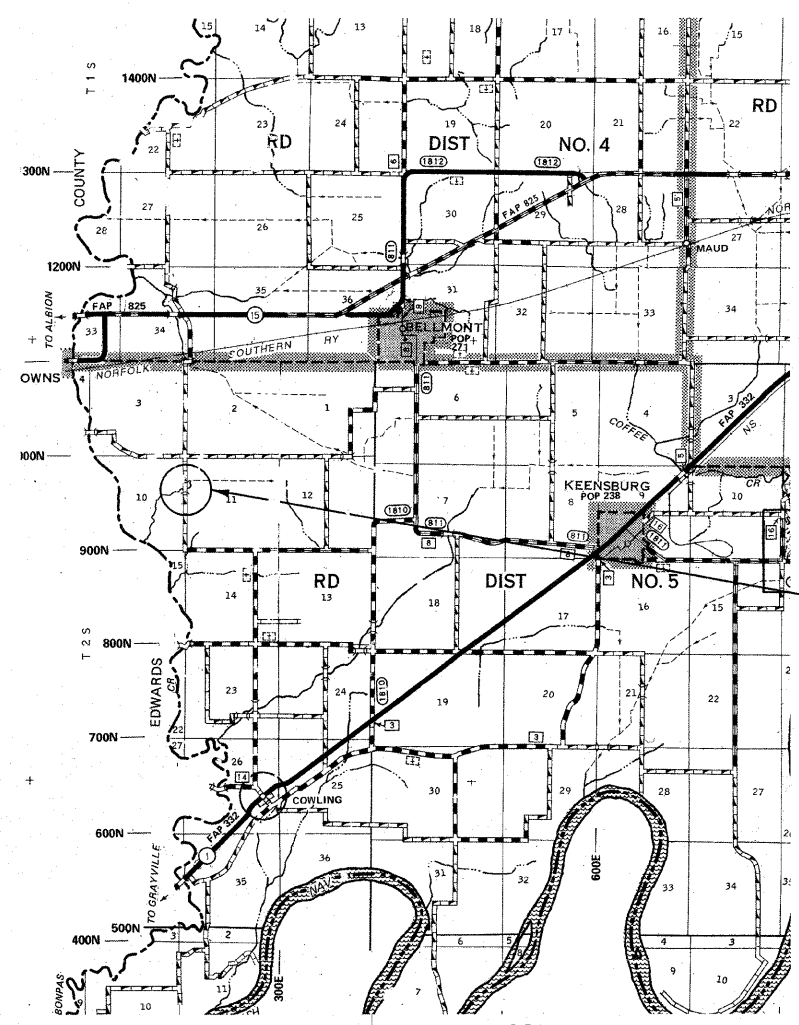

LAYOUT
APPROXIMATE SCALE 1 INCH = 1 MILE

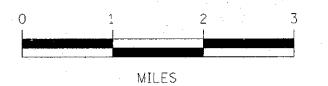

GROSS LENGTH	125.00 FT	0.024 MILES
OMISSIONS	0.00 FT	0.000 MILES
NET LENGTH	125.00 FT	0.024 MILES

PLAN	1" = 50'	
PROFILE	1" = 50'	
PROFILE VERT.	1" = 5'	
CROSS SECTION	1" = 5'	

SECTION 07-05121-00-BR
BEGIN: STATION 4+25

STATION 5+00, STRUCTURE NO. 093-5005
AN ALUMINUM STRUCTURAL PLATE BOX CULVERT
(SPECIAL) 142.6 SQ. FT. 22.5' LENGTH;
INCLUDING HEADWALLS AND WINGWALLS.

SECTION 07-05121-00-BR
ENDS STATION 5+50

APPROVED June 30, 2010

A. K. B. A.
COUNTY ENGINEER

PASSED 7-12 2010

Maureen East
DISTRICT SEVEN ENGINEER OF
LOCAL ROADS & STREETS

Releasing For
Bid Based on
Limited Review 7/12 2010

Roger L. Drushel
DEPUTY DIRECTOR OF HIGHWAYS,
REGION FOUR ENGINEER

STATE OF ILLINOIS
DEPARTMENT OF TRANSPORTATION

GENERAL NOTES:

THIS SECTION SHALL BE CONSTRUCTED IN ACCORDANCE WITH THE PLANS, SPECIAL PROVISIONS AND "STANDARD SPECIFICATIONS FOR ROAD AND BRIDGE CONSTRUCTION", ADOPTED JANUARY 1, 2007.

THE WORK INVOLVED ON THIS SECTION CONSISTS OF THE REMOVAL OF THE EXISTING STRUCTURE, THE CONSTRUCTION OF A 142.6 SQUARE FOOT OPENING ALUMINUM BOX CULVERT, EARTH APPROACHES, AGGREGATE SURFACE COURSE AND OTHER MISCELLANEOUS ITEMS NECESSARY TO COMPLETE THIS SECTION.

ALL ELEVATIONS ARE BASED ON U.S.G.S. MEAN SEA LEVEL DATUM.

IT SHALL BE THE CONTRACTOR'S RESPONSIBILITY TO CONTACT ALL THE UTILITIES, AFFECTING THE PROJECT, PRIOR TO CONSTRUCTION.

NOTE: CONSTRUCTION TRANSITION
 STA. 4+25 TO STA 4+75
 STA 5+00 TO STA 5+50

ALL QUANTITIES ARE INCLUDED IN THE PROPOSAL

T.R.	SECTION	COUNTY	TOTAL SHEETS	SHEET NO.
4	07-05121-00-BR	WABASH	4	2
FED. ROAD DIST. NO. 7 ILLINOIS		FED. AID PROJECT		
PROJECT# BROS-185(031)		CONTRACT# 95634		
JOB NO. C-97-134-10		DRAINAGE DITCH		
LEC JOB # HOBILO26WB				

323 W. 3RD ST.
 P.O. BOX 180
 MT. CARMEL, IL
 62863
 PHONE:
 (618)-262-8651
 FAX:
 (618)-263-3327

405 W. STATE ST
 SUITE 1
 PRINCETON, IN
 47670
 PHONE:
 (812)-386-7611
 FAX:
 (812)-386-2812



PROFESSIONAL DESIGN FIRM
 LAND SURVEY &
 PROFESSIONAL
 ENGINEERING
 CORPORATION
 184-00087
 (62-032435)/(35-002769)



AARON M. MEFFORD
 NAME
 SIGNATURE
 DATE
 6-30-11
 11-30-11
 EXPIRES

TOWNSHIP ROUTE 4
 OVER DRAINAGE DITCH
 WABASH COUNTY, ILLINOIS

SHEET TITLE:
 PLAN & PROFILE

SCALE: VARIES
 BY: AMM
 DATE: 6/30/11
 REV:

2 OF 4
 SHEETS
 SHEET NO.
 2

TYPICAL CROSS SECTION PROPOSED

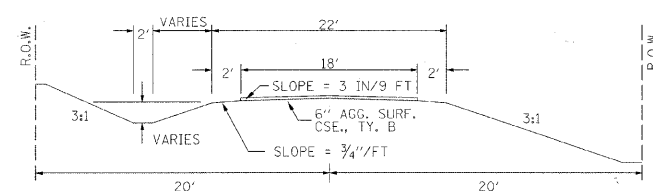

TYPICAL CROSS SECTION EXISTING

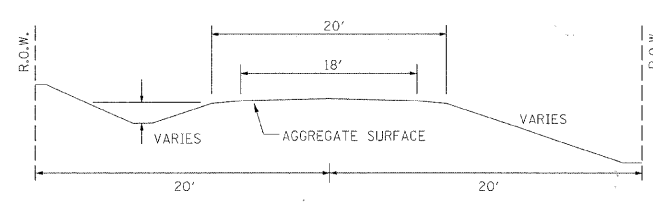

NOTE: STEEL PLATE BEAM GUARDRAIL TYPE A

STA 4+78 TO STA 5+20 LT
 STA 4+84 TO STA 5+28 RT

NOTE: TRAFFIC BARRIER TERMINAL TYPE 1

STA 4+68 TO STA 4+84 RT
 STA 5+20 TO STA 5+45 LT

UTILITIES:
 J.U.L.L.E.
 1-800-892-0123
 MT. CARMEL PUBLIC UTILITY
 1-618-262-5151
 AMEREN CIPS
 1-888-789-2477

FIELD ENTRANCE DETAIL

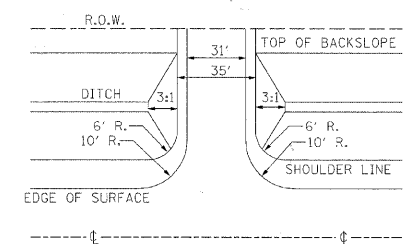

DRAINAGE DITCH
 BUILT 2011 BY
 WABASH COUNTY
 SEC. 07-05121-00-BR
 ROAD DISTRICT #5
 STR. NO. 093-5005
 LOADING HS-20

NAME PLATE
 5' @ 5' @ 515001

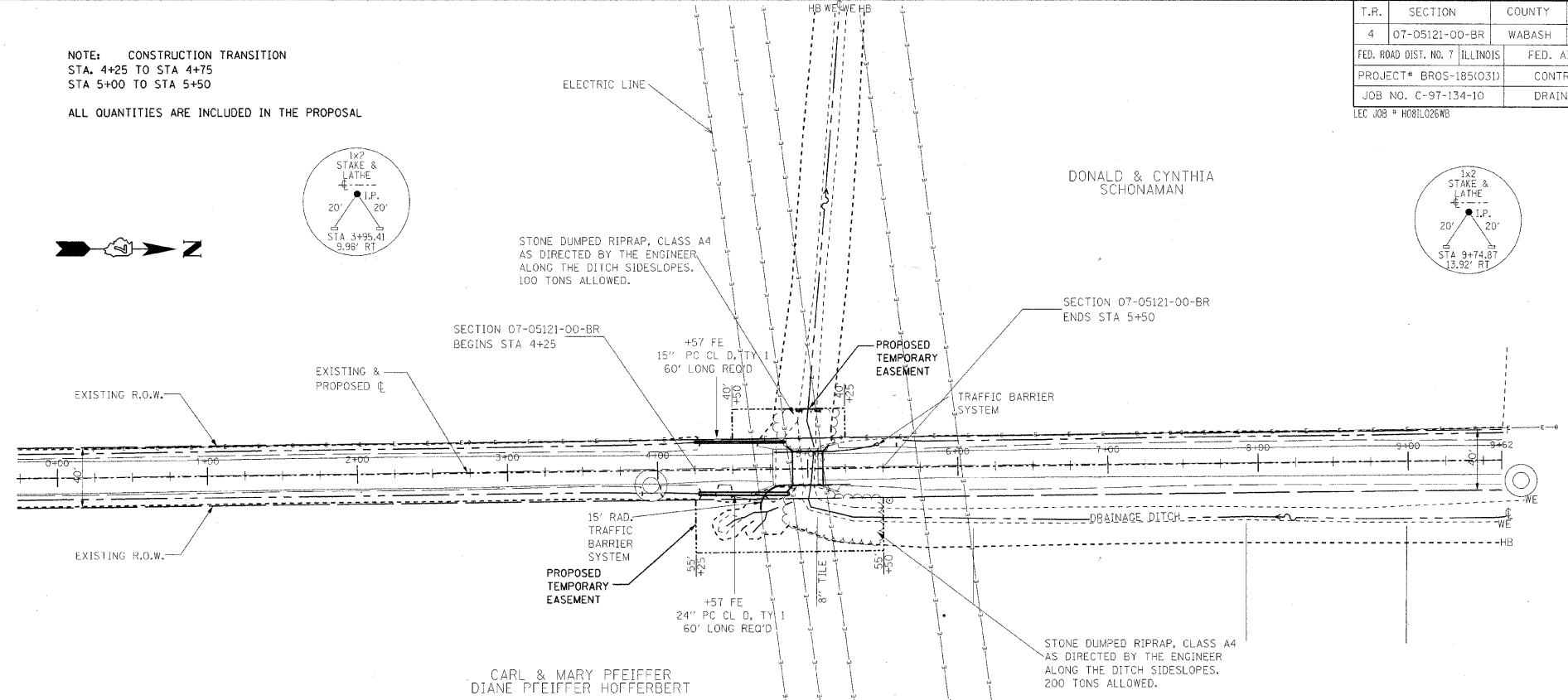

EXISTING BRIDGE STA 4+91.8; STRUCTURE NUMBER: 093-3012
 A 30' LONG SINGLE SPAN 27" CONCRETE DECK BEAMS BRIDGE WITH
 WOOD CAP ON WOOD PILING WITH WOOD MIDWALLS AND WOOD WINGWALLS.

ONE (1) EACH-REMOVAL OF EXISTING STRUCTURES ALLOWED IN
 THIS PROPOSAL.

**NOTE: FILL NEXT TO BRIDGE TO BE
 POROUS GRANULAR BACKFILL**

PROPOSED STRUCTURE: NO. 093-5005, STA 5+00,
 ALUMINUM STRUCTURAL PLATE BOX CULVERT (SPECIAL) 142.6 SQ. FT.
 22.5' LENGTH 0° SKEW; INCLUDING HEADWALLS AND WINGWALLS.
 60 TON STONE DUMPED RIPRAP, CLASS A4 SHALL BE PLACED AT THE
 BOTTOM OF THE PROPOSED STRUCTURE.

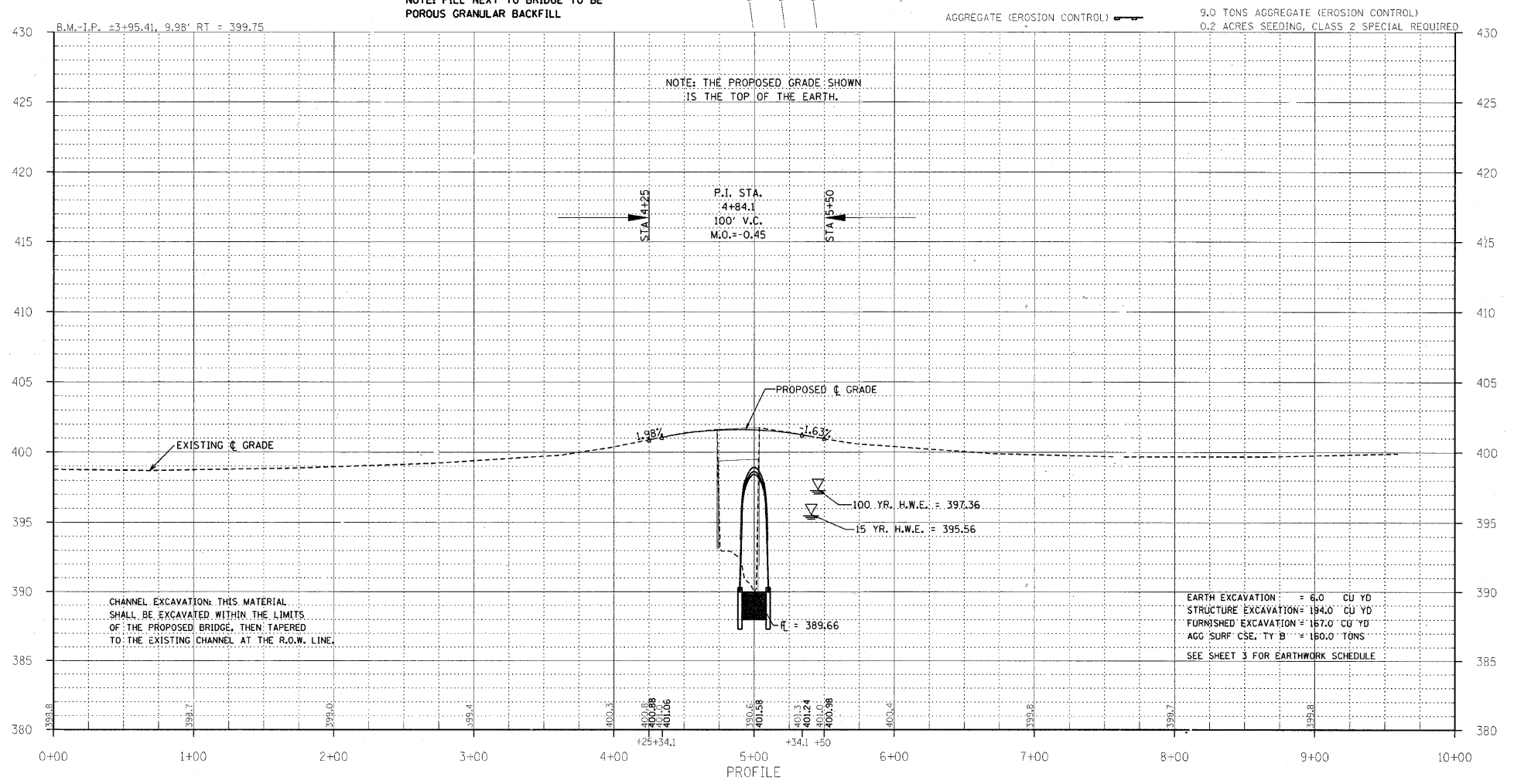

0+00 1+00 2+00 3+00 4+00 5+00 6+00 7+00 8+00 9+00 10+00
 PROFILE

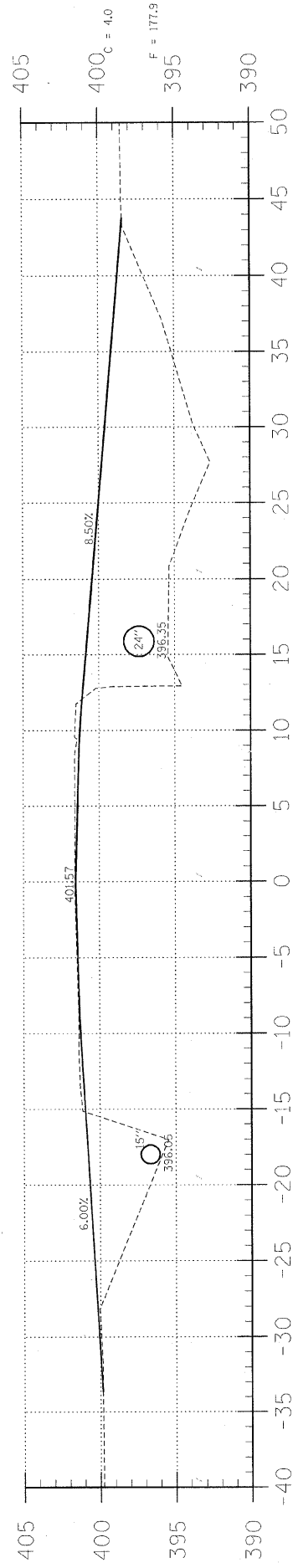

4+75

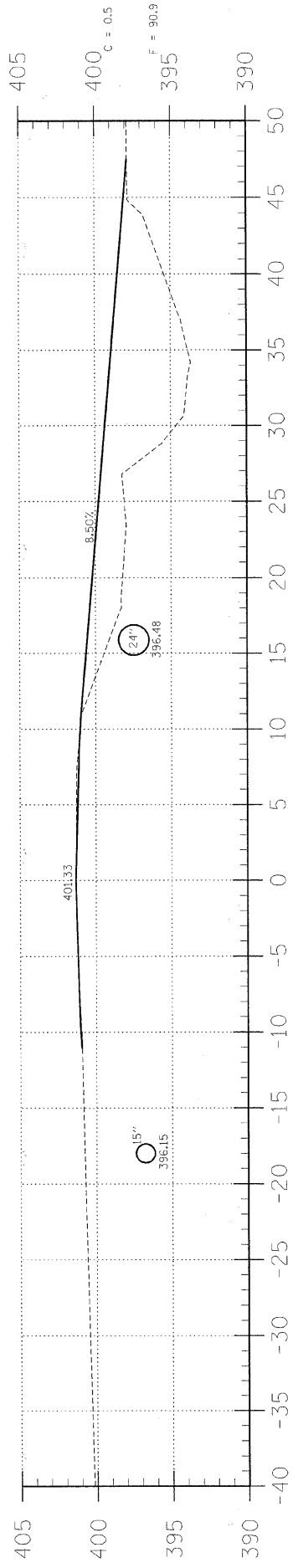

4+50

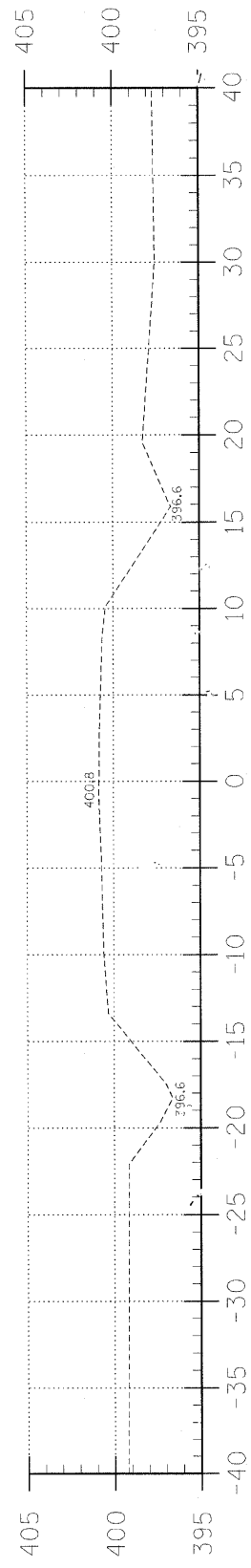

4+25

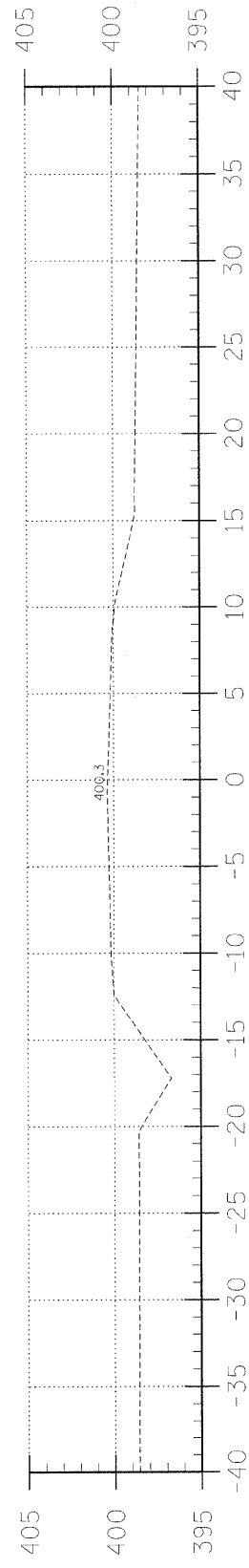

4+00

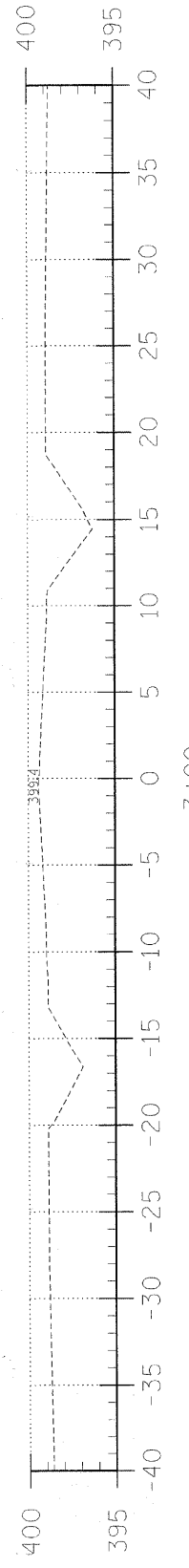

3+00

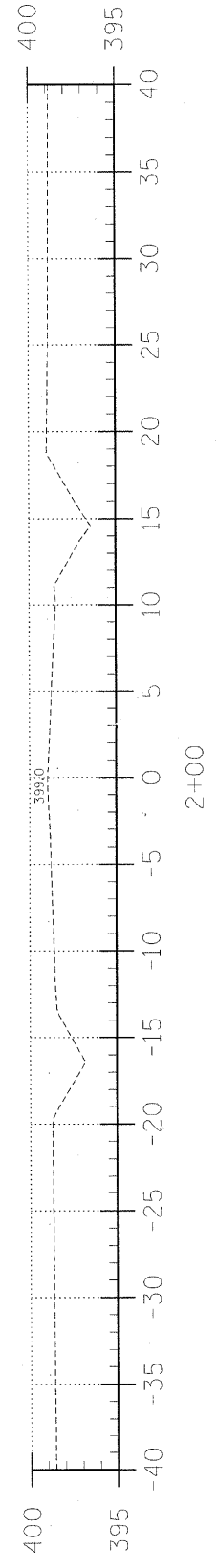

2+00

EARTHWORK SCHEDULE

LOCATION	EARTH EXCAVATION		STRUCTURE EXCAVATION		ESTIMATED UNSUITABLE MATERIAL		SUITABLE MATERIAL ADJUSTED FOR SHRINKAGE		EMBANKMENT		EARTHWORK BALANCE WASTE (+) OR SHORTAGE (-)	
	CUBIC YARD	CUBIC YARD	CUBIC YARD	CUBIC YARD	CUBIC YARD	CUBIC YARD	CUBIC YARD	CUBIC YARD	CUBIC YARD	CUBIC YARD	CUBIC YARD	CUBIC YARD
STA 0+00 TO 4+75	3.0	0.0	0.0	0.0	0.0	2.3	244.4	-242.1				
STA 4+75 TO 5+25	0.0	194.0	0.0	0.0	97.0	72.8	0.0	+72.8				
STA 5+25 TO 10+00	3.0	0.0	0.0	0.0	0.0	2.3	0.0	+2.3				
2 FIELD ENTRANCE	0.0	0.0	0.0	0.0	0.0	0.0	0.0	0.0				
TOTAL	6.0	194.0	0.0	0.0	97.0	77.4	244.4	-167.0				

TOWNSHIP ROUTE 4
OVER DRAINAGE DITCH
WABASH COUNTY, ILLINOIS

SHEET TITLE:
CROSS-SECTIONS
SCALE: 1" = 5'
BY: AMM
DATE: 6/30/11
REV:
3 OF 4 SHEETS
SHEET NO. 3



AARON M. MEFFORD
NAME
SIGNATURE
DATE: 6-30-11
EXPIRES: 11-30-11

PROFESSIONAL DESIGN FIRM
LAND SURVEY & PROFESSIONAL ENGINEERING CORPORATION
184-00088 / (62-032435) (35-002769)

LAMAC ENGINEERING CO.

405 W. STATE ST.
SUITE 1
PRINCETON, IN 47670
PHONE: (812)-386-7611
FAX: (812)-385-2812

T.R.	SECTION	COUNTY	TOTAL SHEETS	SHEET NO.
4	07-05121-00-BR	WABASH	4	3
FED. ROAD DIST. NO. 7 ILLINOIS		FED. AID PROJECT		
PROJECT# BROS-185(031)		CONTRACT# 95634		
JOB NO. C-97-134-10		DRAINAGE DITCH		

323 W. 3RD ST.
P.O. BOX 160
MT. CARMEL, IL 62863
PHONE: (618)-262-8651
FAX: (618)-263-3327

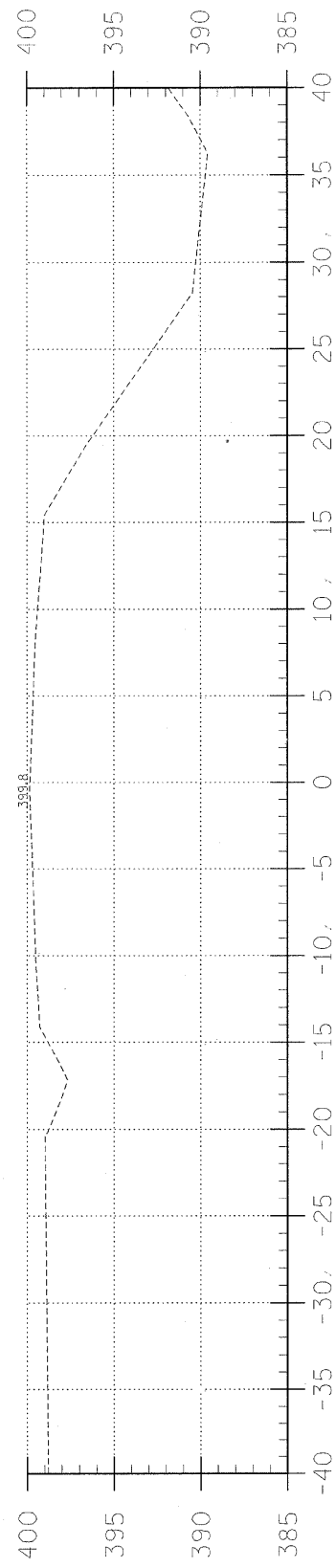

7+00

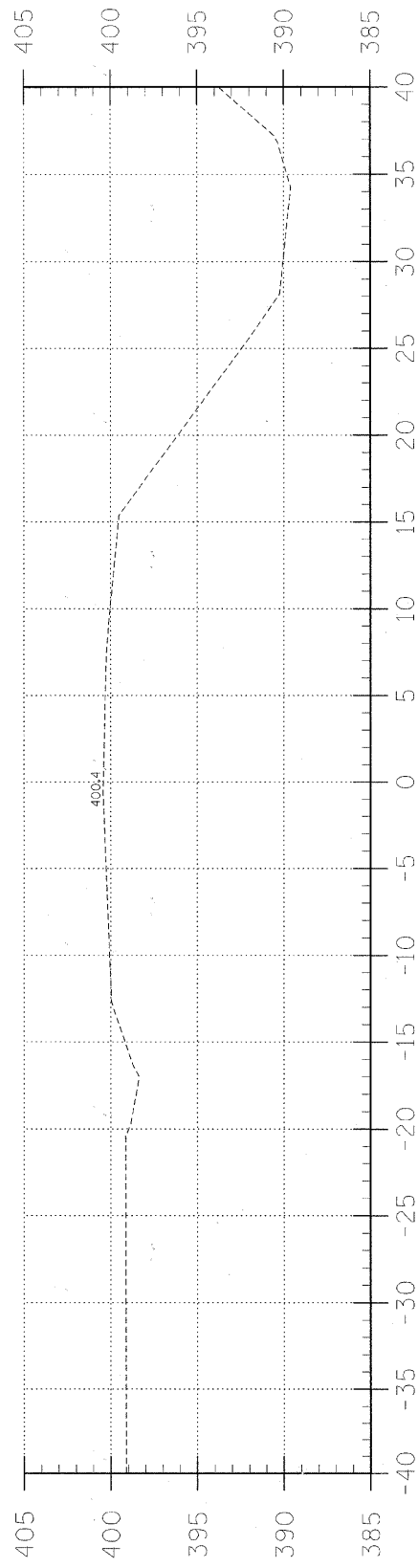

6+00

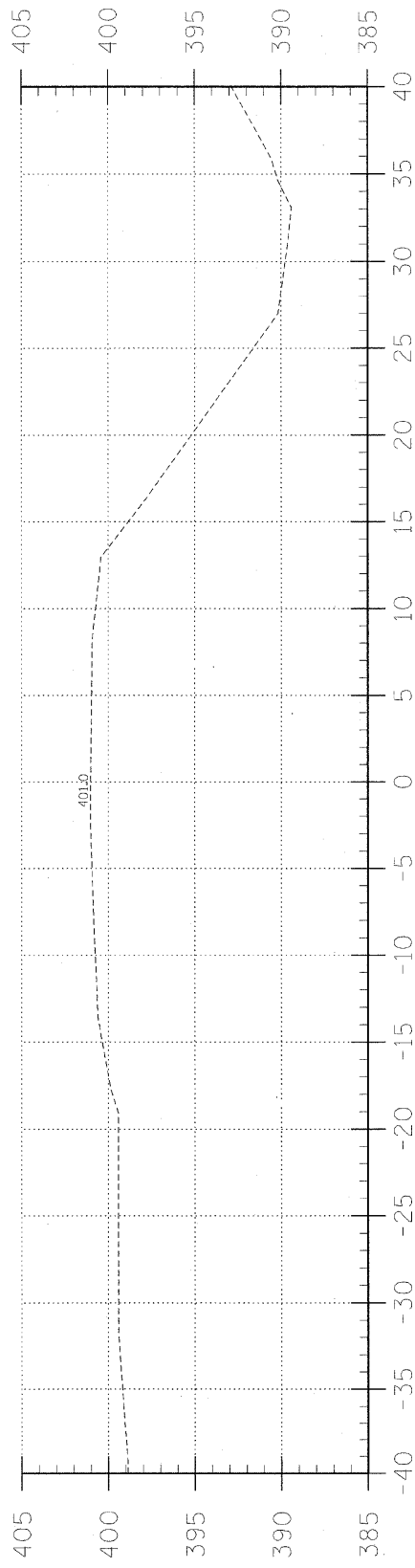

5+50

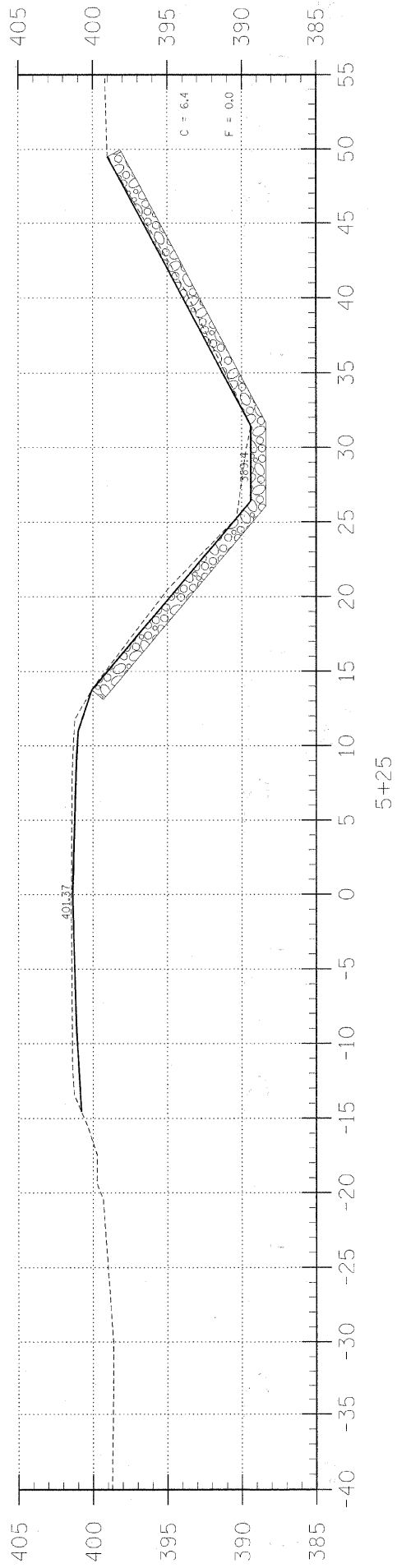

5+25

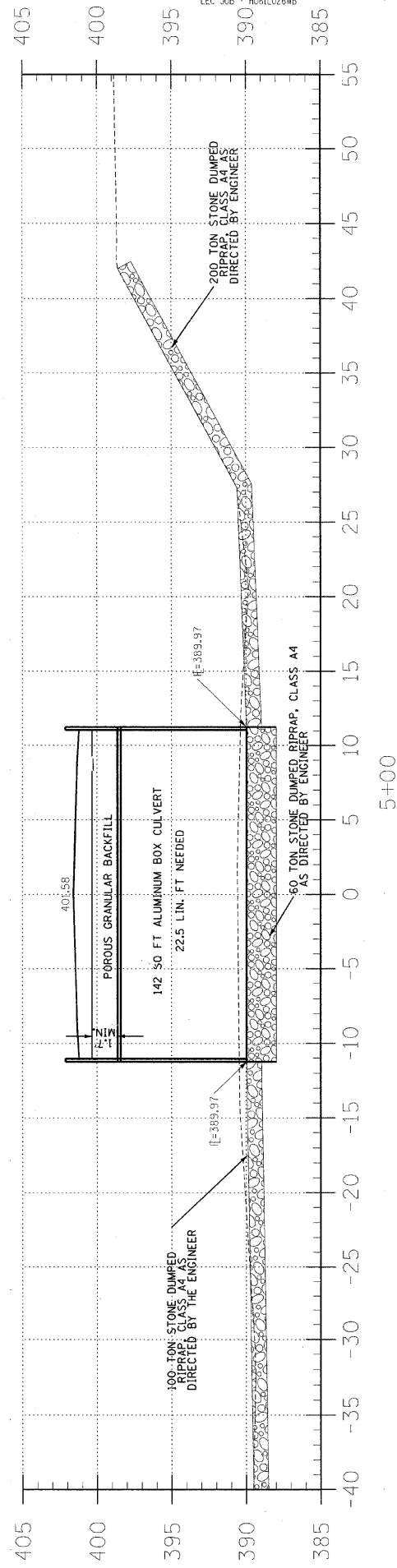

5+00

T.R.	SECTION	COUNTY	TOTAL SHEETS	SHEET NO.
4	07-05121-00-BR	WABASH	4	4
FED. ROAD DIST. NO. 7 ILLINOIS		FED. AID PROJECT		
PROJECT# BROS-185(031)		CONTRACT# 95634		
JOB NO. C-97-134-10		DRAINAGE DITCH		

LEC JOB # HCRIL026WB

405 W. STATE ST.
SUITE 1
PRINCETON, IN 47670
PHONE: (812)-386-7611
FAX: (812)-385-2812



PROFESSIONAL DESIGN FIRM
LAND SURVEY & PROFESSIONAL ENGINEERING CORPORATION
184-000887
(62-032435)(35-002769)



AARON M. MEFFORD
NAME
SIGNATURE
DATE
6-30-11
EXPIRES

TOWNSHIP ROUTE 4
OVER DRAINAGE DITCH
WABASH COUNTY, ILLINOIS

SHEET TITLE:

CROSS-SECTIONS

SCALE: 1" = 5'
BY: AMM
DATE: 8/9/09
REV:

4 OF 4 SHEETS

SHEET NO. 4