

STATE OF ILLINOIS  
DEPARTMENT OF TRANSPORTATION

F.A.P. RTE.	SECTION	COUNTY	TOTAL SHEETS	SHEET NO.
301	43RS	JO DAVIESS	33	1
		ILLINOIS	CONTRACT NO. 64N63	

FOR INDEX OF SHEETS  
AND HIGHWAY STANDARDS, SEE SHEET NO. 2

**HIGHWAY CLASSIFICATION**

CLASSIFICATION: OTHER PRINCIPAL ARTERIAL  
ADT: 14,950 (2021) PV = 13,390  
DESIGN SPEED: 30-55 MPH MU = 1010  
POSTED SPEED: 30-55 MPH SU = 550

DUNLEITH TOWNSHIP – SECTION 29

**PROPOSED  
HIGHWAY PLANS**

FAP ROUTE 301 (US 20)  
SECTION 43RS  
PROJECT HSIP-VQKG(201)  
PATCHING, RESURFACING, RESTRIPING  
JO DAVIESS COUNTY

C-92-095-21

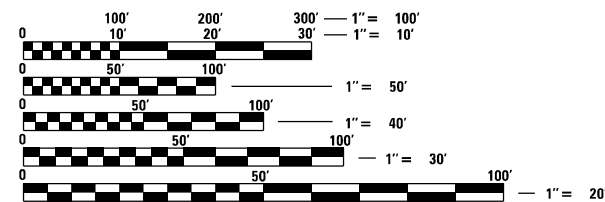
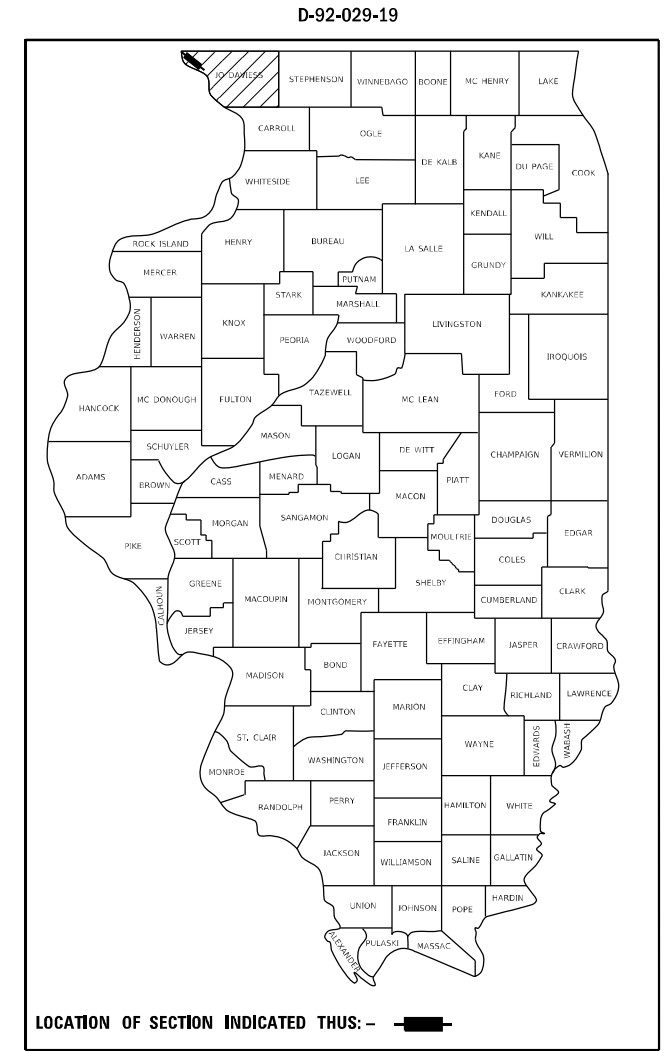

FULL SIZE PLANS HAVE BEEN PREPARED USING STANDARD ENGINEERING SCALES, REDUCED SIZED PLANS WILL NOT CONFORM TO STANDARD SCALES. IN MAKING MEASUREMENTS ON REDUCED PLANS, THE ABOVE SCALES MAY BE USED.

J.U.L.I.E.  
JOINT UTILITY LOCATION INFORMATION FOR EXCAVATORS  
1-800-892-0123  
OR 811

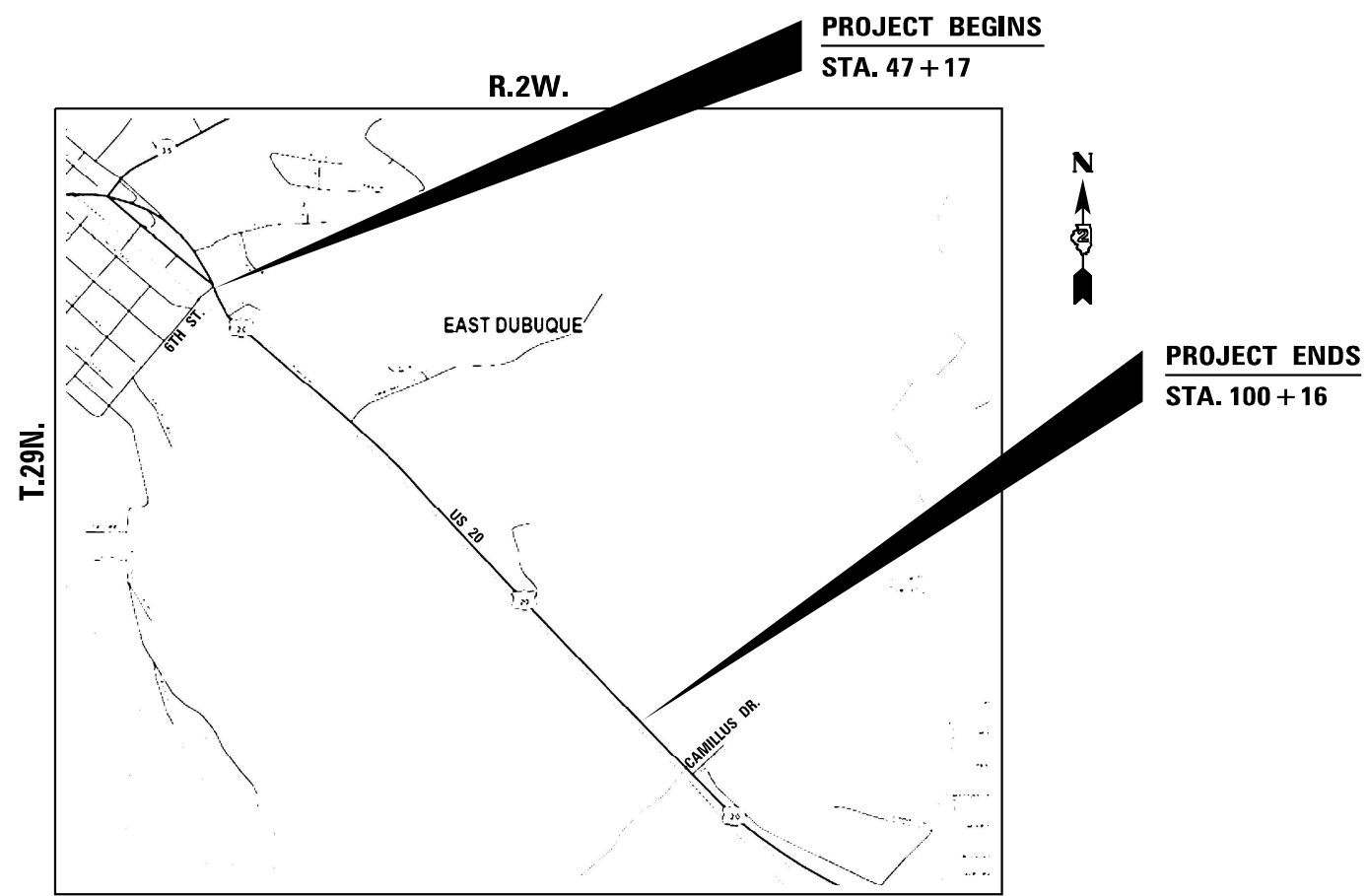

GROSS LENGTH = 5,299 FT. = 1.0 MILE  
NET LENGTH = 5,299 FT. = 1.0 MILE

PROJECT ENGINEER FAITH DUNCAN  
PROJECT MANAGER BRAD CUSHMAN 815-284-5996  
EMAIL: BRAD.CUSHMAN@ILLINOIS.GOV  
CONTRACT NO. 64N63

STATE OF ILLINOIS  
DEPARTMENT OF TRANSPORTATION

SUBMITTED 06/25 2021

*David Howard*  
REGIONAL ENGINEER

August 13, 2021  
*Scott A. Elk*  
ENGINEER OF DESIGN AND ENVIRONMENT

August 13, 2021  
*James J. Quinn*  
DIRECTOR OF HIGHWAYS PROJECT IMPLEMENTATION 13

PRINTED BY THE AUTHORITY  
OF THE STATE OF ILLINOIS

## INDEX OF SHEETS

1	COVER SHEET
2	INDEX / HIGHWAY STANDARDS
3 - 6	SUMMARY OF QUANTITIES
7	GENERAL NOTES
8 - 9	TYPICAL SECTIONS
10 - 12	SCHEDULE OF QUANTITIES
13	HMA SCHEDULE
14	PATCHING SCHEDULE
15	SIGN SCHEDULE
16 - 20	PAVEMENT MARKING & SIGN DETAILS
21	CATCH BASIN OR INLETS TO BE ADJUSTED OR RECONSTRUCTED (17.4)
22 - 25	WORK ZONE SIGN DETAILS (34.1)
26 - 29	TRAFFIC CONTROL FOR TRANSITION AREAS (38.1)
30	TRAFFIC CONTROL TYPICAL WEAVE (39.1)
31 - 33	TYPICAL PAVEMENT MARKINGS (41.1)

## HIGHWAY STANDARDS

000001-08	STANDARD SYMBOLS, ABBREVIATIONS AND PATTERNS
001001-02	AREAS OF REINFORCEMENT BARS
001006-00	DECIMAL OF AN INCH AND A FOOT
420001-09	PAVEMENT JOINTS
420701-03	PAVEMENT WELDED WIRED REINFORCEMENT
442101-09	CLASS B PATCHES
606001-07	CONCRETE CURB TYPE B AND COMBINATION CONCRETE CURB AND GUTTER
701400-10	APPROACH TO LANE CLOSURE, FREEWAY / EXPRESSWAY
701401-12	LANE CLOSURE, FREEWAY / EXPRESSWAY
701601-09	URBAN LANE CLOSURE, MULTILANE, 1W OR 2W WITH NONTRAVERSABLE MEDIAN
701602-10	URBAN LANE CLOSURE, MULTILANE, 2W WITH BIDIRECTIONAL LEFT TURN LANE
701701-10	URBAN LANE CLOSURE, MULTILANE INTERSECTION
701901-08	TRAFFIC CONTROL DEVICES
720001-01	SIGN PANEL MOUNTING DETAILS
720006-04	SIGN PANEL ERECTION DETAILS
720011-01	METAL POSTS FOR SIGNS MARKERS & DELINEATORS
728001-01	TELESCOPING STEEL SIGN SUPPORT
729001-01	APPLICATIONS OF TYPES A & B METAL POSTS (FOR SIGNS & MARKERS)
731001-01	BASE FOR TELESCOPING STEEL SIGN SUPPORT
780001-05	TYPICAL PAVEMENT MARKINGS
781001-04	TYPICAL APPLICATIONS RAISED REFLECTIVE PAVEMENT MARKERS

MODEL: Default  
 FILE NAME: p:\pub\mroom.dwt\illinois.gov\PWIDOT\Documents\DOT\_Offices\District 2\Projects\616\63\Program\_Development\Studies & Plans\Design\CADD\CAD\sheet\02-64N63-16-500.dgn

USER NAME = cushmarbw	DESIGNED -	REVISED -
	DRAWN -	REVISED -
PLOT SCALE = 100,0000' / in.	CHECKED -	REVISED -
PLOT DATE = Jun-25-2021 06:21:07 AM	DATE -	REVISED -

**STATE OF ILLINOIS  
DEPARTMENT OF TRANSPORTATION**

**INDEX / HIGHWAY STANDARDS**

SCALE: SHEET OF SHEETS STA. TO STA.

F.A.P. RTE.	SECTION	COUNTY	TOTAL SHEETS	SHEET NO.
301	43RS	JO DAVIESS	33	2
CONTRACT NO. 64N63				
ILLINOIS FED. AID PROJECT				

MODEL: Default  
 FILE NAME: \\lancom\dot\illinois\gov\pww\dot\Documents\DOT OFFICE\District 2\Projects\64N63\Program Development\Studies & Plans\Design\CD\CD\shwrs\02-64N63-111-500.dgn

CODE NO.	ITEM	UNIT	TOTAL QUANTITY	CONSTRUCTION CODE	
				90% FEDERAL 10% STATE	100% CITY
				SAFETY 0021	SAFETY 0021
				URBAN	URBAN
30300104	AGGREGATE SUBGRADE IMPROVEMENT 4"	SQ YD	430	430	
40600290	BITUMINOUS MATERIALS (TACK COAT)	POUND	23097	23097	
40600901	HOT-MIX ASPHALT BINDER COURSE (HAND METHOD), N70	TON	10	10	
40602985	HOT-MIX ASPHALT BINDER COURSE, IL-9.5, N70	TON	2284	2284	
40604050	HOT-MIX ASPHALT SURFACE COURSE, IL-9.5, MIX "C", N50	TON	245	245	
40604062	HOT-MIX ASPHALT SURFACE COURSE, IL-9.5, MIX "D", N70	TON	2741	2741	
44000500	COMBINATION CURB AND GUTTER REMOVAL	FOOT	250	250	
44200050	WELDED WIRE REINFORCEMENT	SQ YD	877	877	
44200982	CLASS B PATCHES, TYPE II, 11 INCH	SQ YD	659	659	
44200986	CLASS B PATCHES, TYPE III, 11 INCH	SQ YD	100	100	
44200988	CLASS B PATCHES, TYPE IV, 11 INCH	SQ YD	777	777	
44201299	DOWEL BARS 1 1/2"	EACH	1840	1840	
44213200	SAW CUTS	FOOT	5447	5447	
44213204	TIE BARS 3/4"	EACH	1161	1161	

USER NAME = cushmantw PLOT SCALE = 106.6228' / in. PLOT DATE = Jun-25-2021 06:21:33 AM	DESIGNED - DRAWN - CHECKED - DATE -	REVISED - REVISED - REVISED - REVISED -	<b>STATE OF ILLINOIS DEPARTMENT OF TRANSPORTATION</b>	<b>SUMMARY OF QUANTITIES</b>	F.A.P. RTE. 301	SECTION 43RS	COUNTY JO DAVIESS	TOTAL SHEETS 33	SHEET NO. 3	CONTRACT NO. 64N63	ILLINOIS FED. AID PROJECT
SCALE: SHEET OF SHEETS STA. TO STA.											

MODEL: Default  
 FILE NAME: p:\pub\mroom.dwt\illinois.gov\PWIDOT\Documents\DOT\_Offices\District 2\Projects\616\63\Program\_Development\Studies & Plans\Design\CADD\CAD\Sheet102-64N63-11-500.dgn

CODE NO.	ITEM	UNIT	TOTAL QUANTITY	CONSTRUCTION CODE	
				90% FEDERAL 10% STATE	100% CITY
				SAFETY	SAFETY
				0021 URBAN	0021 URBAN
44300200	STRIP REFLECTIVE CRACK CONTROL TREATMENT	FOOT	5299	5299	
48102100	AGGREGATE WEDGE SHOULDER, TYPE B	TON	56	56	
56109210	WATER VALVES TO BE ADJUSTED	EACH	3		3
60255500	MANHOLES TO BE ADJUSTED	EACH	7		7
60260100	INLETS TO BE ADJUSTED	EACH	25		25
60610400	COMBINATION CONCRETE CURB AND GUTTER, TYPE M-6.24	FOOT	250	250	
67000400	ENGINEER'S FIELD OFFICE, TYPE A	CAL MO	3	3	
67100100	MOBILIZATION	L SUM	1	1	
70100205	TRAFFIC CONTROL AND PROTECTION, STANDARD 701401	EACH	1	1	
70102630	TRAFFIC CONTROL AND PROTECTION, STANDARD 701601	L SUM	1	1	
70102632	TRAFFIC CONTROL AND PROTECTION, STANDARD 701602	L SUM	1	1	
70102635	TRAFFIC CONTROL AND PROTECTION, STANDARD 701701	L SUM	1	1	
70103815	TRAFFIC CONTROL SURVEILLANCE	CAL DA	10	10	
70107025	CHANGEABLE MESSAGE SIGN	CAL DA	60	60	

USER NAME = cushmarbw	DESIGNED -	REVISED -
	DRAWN -	REVISED -
PLOT SCALE = 100,0000' / in.	CHECKED -	REVISED -
PLOT DATE = Jun-25-2021 06:22:00 AM	DATE -	REVISED -

**STATE OF ILLINOIS  
 DEPARTMENT OF TRANSPORTATION**

**SUMMARY OF QUANTITIES**

SCALE: SHEET OF SHEETS STA. TO STA.

F.A.P. RTE.	SECTION	COUNTY	TOTAL SHEETS	SHEET NO.
301	43R5	JO DAVIESS	33	4
CONTRACT NO. 64N63				
ILLINOIS FED. AID PROJECT				

MODEL: Default  
 FILE NAME: p:\pub\mroom.dwt\illinois.gov\PWIDOT\Documents\DOT\_Offices\District 2\Projects\616\63\Program\_Development\Studies & Plans\Design\CADD\CAD\Sheet102-64N63-115-500.dgn

CODE NO.	ITEM	UNIT	TOTAL QUANTITY	CONSTRUCTION CODE	
				90% FEDERAL 10% STATE	100% CITY
				SAFETY	SAFETY
				0021 URBAN	0021 URBAN
70300100	SHORT TERM PAVEMENT MARKING	FOOT	21196	21196	
70300150	SHORT TERM PAVEMENT MARKING REMOVAL	SQ FT	7065	7065	
* 72000100	SIGN PANEL - TYPE 1	SQ FT	63	63	
* 72000200	SIGN PANEL - TYPE 2	SQ FT	32	32	
* 72400310	REMOVE SIGN PANEL - TYPE 1	SQ FT	75	75	
72800100	TELESCOPING STEEL SIGN SUPPORT	FOOT	70	70	
73000100	WOOD SIGN SUPPORT	FOOT	36	36	
* 78000100	THERMOPLASTIC PAVEMENT MARKING - LETTERS AND SYMBOLS	SQ FT	504	504	
* 78000200	THERMOPLASTIC PAVEMENT MARKING - LINE 4"	FOOT	21224	21224	
* 78000500	THERMOPLASTIC PAVEMENT MARKING - LINE 8"	FOOT	699	699	
* 78000600	THERMOPLASTIC PAVEMENT MARKING - LINE 12"	FOOT	1470	1470	
* 78100100	RAISED REFLECTIVE PAVEMENT MARKER	EACH	296	296	
78300200	RAISED REFLECTIVE PAVEMENT MARKER REMOVAL	EACH	119	119	
X4400196	HOT-MIX ASPHALT SURFACE REMOVAL, SPECIAL	SQ YD	589	589	

\* SPECIALTY ITEMS

USER NAME = cushmarbw	DESIGNED -	REVISED -	<b>STATE OF ILLINOIS DEPARTMENT OF TRANSPORTATION</b>	<b>SUMMARY OF QUANTITIES</b>				F.A.P. RTE.	SECTION	COUNTY	TOTAL SHEETS	SHEET NO.
PLOT SCALE = 100,0000' / in.	DRAWN -	REVISED -						301	43R5	JO DAVIESS	33	5
PLOT DATE = Jun-25-2021 06:22:26 AM	CHECKED -	REVISED -		SCALE:	SHEET	OF	SHEETS	STA.	TO STA.	CONTRACT NO. 64N63		
DATE -	REVISED -	REVISED -		ILLINOIS FED. AID PROJECT								

MODEL: Default  
 FILE NAME: p:\pub\mranon.dwt\illinois.gov\PWIDOT\Documents\DOT\_Offices\District 2\Projects\616\63\Program\_Development\Studies & Plans\Design\CADD\CAD\Sheet\02-64N63-115-500.dgn

CODE NO.	ITEM	UNIT	TOTAL QUANTITY	CONSTRUCTION CODE	
				90% FEDERAL	100% CITY
				10% STATE	
				SAFETY	SAFETY
				0021	0021
				URBAN	URBAN
X4401198	HOT-MIX ASPHALT SURFACE REMOVAL, VARIABLE DEPTH	SQ YD	866	866	
X4403700	MEDIAN REMOVAL (SPECIAL)	SQ FT	3874	3874	
X6024503	INLETS TO BE ADJUSTED WITH NEW FRAME AND GRATE (SPECIAL)	EACH	3		3
* X7830060	GROOVING FOR RECESSED PAVEMENT MARKING, LETTERS AND SYMBOLS	SQ FT	612	612	
* X7830070	GROOVING FOR RECESSED PAVEMENT MARKING 5"	FOOT	21224	21224	
* X7830076	GROOVING FOR RECESSED PAVEMENT MARKING 9"	FOOT	699	699	
* X7830078	GROOVING FOR RECESSED PAVEMENT MARKING 13"	FOOT	1470	1470	
Z0033700	LONGITUDINAL JOINT SEALANT	FOOT	16259	16259	
Z0034105	MATERIAL TRANSFER DEVICE	TON	5270	5270	
Z0042200	PORTLAND CEMENT CONCRETE PAVEMENT SURFACE REMOVAL	SQ YD	712	712	
Z0048665	RAILROAD PROTECTIVE LIABILITY INSURANCE	L SUM	1	1	

\* SPECIALTY ITEMS

USER NAME = cushmarbw	DESIGNED -	REVISED -	<b>STATE OF ILLINOIS DEPARTMENT OF TRANSPORTATION</b>	<b>SUMMARY OF QUANTITIES</b>				F.A.P. RTE.	SECTION	COUNTY	TOTAL SHEETS	SHEET NO.
PLOT SCALE = 100,0000' / in.	DRAWN -	REVISED -						301	43R5	JO DAVIESS	33	6
PLOT DATE = Jun-25-2021 06:22:51 AM	CHECKED -	REVISED -		SCALE: SHEET OF SHEETS STA. TO STA.				CONTRACT NO. 64N63				
DATE -	REVISED -	REVISED -						ILLINOIS FED. AID PROJECT				

# GENERAL NOTES

Closed expansion joints on jointed pavements shall be re-established during the patching operations. Class B Patches - when the pavement requires patching at the location of the expansion joint, a new joint should be established using a dowelled expansion patch as shown on Highway Standard 442101. When the joint is closed, but does not require patching, an expansion joint may be formed by sawing the pavement and filling the saw cut with a preformed expansion joint filler meeting the requirements of Section 1051 of the Standard Specifications as shown on Standard 420001.

When laying out for patching, the minimum distance between new patches (saw cut to saw cut) shall be 15 feet. When patch spacing is less than 15 feet, the pavement between patches shall also be removed and replaced.

The following Mixture Requirements are applicable for this project:

Location(s):	Resurfacing		
Mixture Use(s):	Surface	Binder	Shoulders
PG:	PG 58-28	PG 58-28	PG 58-28
Design Air Voids:	4.0 @ N70	4.0 @ N70	4.0 @ N50
Mixture Composition (Mixture Gradation):	IL 9.5	IL 9.5, or 9.5FG	IL 9.5, or 9.5FG
Friction Aggregate:	D	N/A	N/A
20 Year ESAL	5.4	5.4	5.4
Mix Unit Weight:	112 lbs/sy/in	N/A	112 lbs/sy/in
Quality Management Program to be Used	QCP	QCP	QC/QA
Sublot Tonnage	800	800	N/A

- 1) When a number of roller passes is specified, the Contractor may opt to use intelligent compaction in lieu of density testing under the Quality Control for Performance (QCP) program.

The Contractor will be required to furnish 5 1/2" high brass stencils as approved by the Engineer and install stationing at 250' intervals. Stationing shall be placed on both lanes of 2-lane highways and on the outside lanes in both directions on 4-lane highways. The stations shall be placed 6" inside the pavement marking edge so they can be read from the shoulder. This work will be included in the cost of the final pavement surface.

The area to be tacked or primed shall be limited to that which can be covered with HMA on the next day's production, but no more than five days in advance of the placement of the HMA, unless approved by the Engineer.

Pavement Marking shall be done according to Standard 780001, except as follows:

1. All words, such as ONLY, shall be 8 feet high.
2. All non-freeway arrows shall be the large size.
3. The distance between yellow no-passing lines shall be 8 inches, not 7 inches, as shown in the detail of Typical Lane and Edge Lines.
4. Centerline Skip Dash Pavement Marking on multi-lane divided, multi-lane undivided, and one-way roadway shall be according to District Standard 41.1.

The Contractor shall be responsible for locating and protecting utility property during construction operations as outlined in Article 107.39 of the Standard Specifications. The following listed utilities located within the project limits or immediately adjacent to the project construction limits are members of JULIE:

Mediacom	309/743-4750
Jo-Carroll Energy	815/858-5522
Nicor Gas Co.	630/388-3019
Windstream	815/592-3395
City of East Dubuque	815/747-3416
Wisconsin Independent Network	715/838-4406
Frontier (North)	815/544-6171

IDOT is not a member of JULIE. If you are near any overhead lighting, intersection lighting or traffic signals, contact the IDOT Traffic Office at 815/284-5469 at least 48 hours prior to work.

It shall be the Contractor's responsibility to contact the municipality to determine approved methods of utility structure adjustment. Utility structures may include, but are not limited to, manholes, water valves, handholes, etc. All materials and work necessary to complete adjustments per municipality requirements shall be considered included in the cost of the associated adjustment pay item.

FILE NAME = 64N63.GN.DOCX	USER NAME =	DESIGNED - Engineering Systems	REVISED -	<b>STATE OF ILLINOIS</b> <b>DEPARTMENT OF TRANSPORTATION</b>	<b>GENERAL NOTES</b>	ROUTE	SECTION	COUNTY	TOTAL SHEETS	SHEET NO.	
	PLOT SCALE =	DRAWN -	REVISED -			FAP 301	43RS	Jo Dawness	33	7	
	PLOT DATE = 8/9/2021 10:32 AM	CHECKED -	REVISED -			CONTRACT NO. 64N63		ILLINOIS	FED. AID PROJECT		
		DATE - 6/23/2021 8:55 AM	REVISED -			SCALE:	SHEET NO.	OF	SHEETS	STA.	TO STA.

**US ROUTE 20**

STA. 47+85 - 64+87

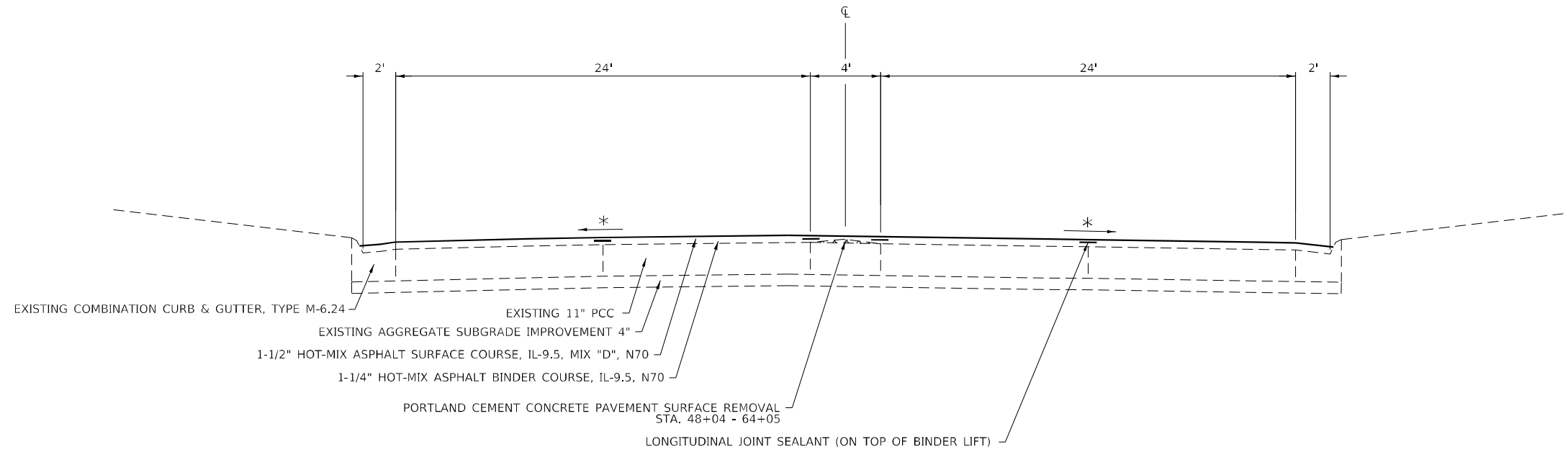

**US ROUTE 20**

STA. 64+87 - 75+47.5

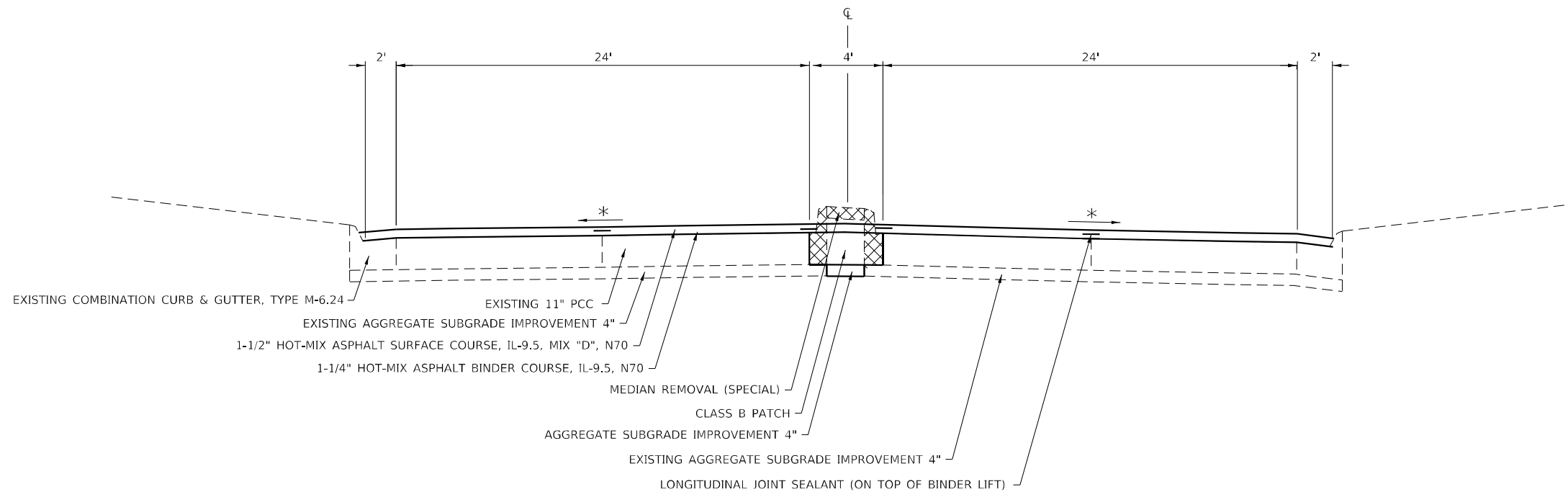

\* MATCH EXISTING CROSS SLOPE  
HMA UNIT WEIGHT 112 LBS/ SQ YD/ IN

MODEL: Default  
 FILE NAME: p:\pub\harronm.dwt\illinois.gov\PWIDOT\Documents\DOT\_Offices\District 2\Projects\64N63\Program\_Development\Studies & Plans\Design\CADD\CAD\Sheet\02-64N63-shc-type.dgn

USER NAME = cushmarbw	DESIGNED -	REVISED -
	DRAWN -	REVISED -
PLOT SCALE = 8:0 "/>		

**STATE OF ILLINOIS  
DEPARTMENT OF TRANSPORTATION**

**TYPICAL SECTION**

SCALE: SHEET OF SHEETS STA. TO STA.

F.A.P. RTE.	SECTION	COUNTY	TOTAL SHEETS	SHEET NO.
301	43RS	JO DAVIESS	33	8
CONTRACT NO. 64N63				
ILLINOIS FED. AID PROJECT				



**US ROUTE 20**

STA. 75+47.5 - 87+07

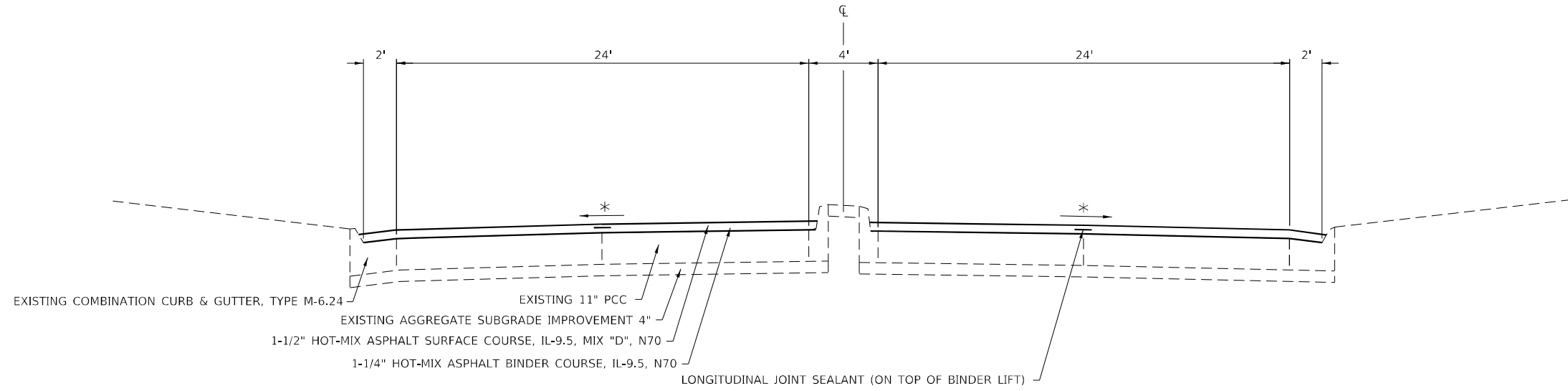

**US ROUTE 20**

STA. 87+07 - 99+41

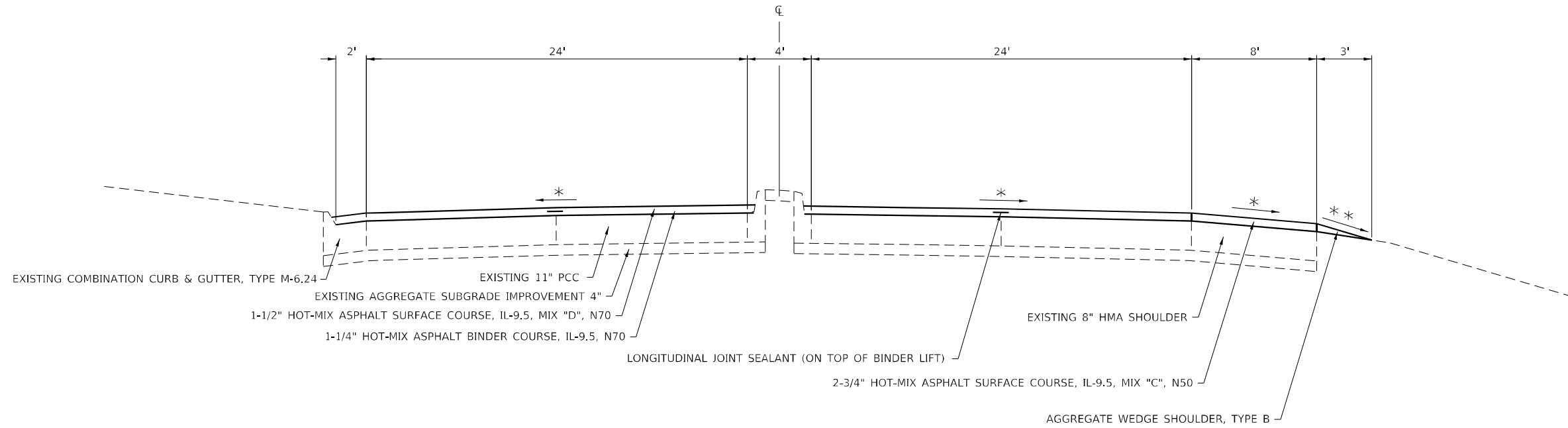

**VARIABLE MILLING & TAPER**

47+17 - 47+85

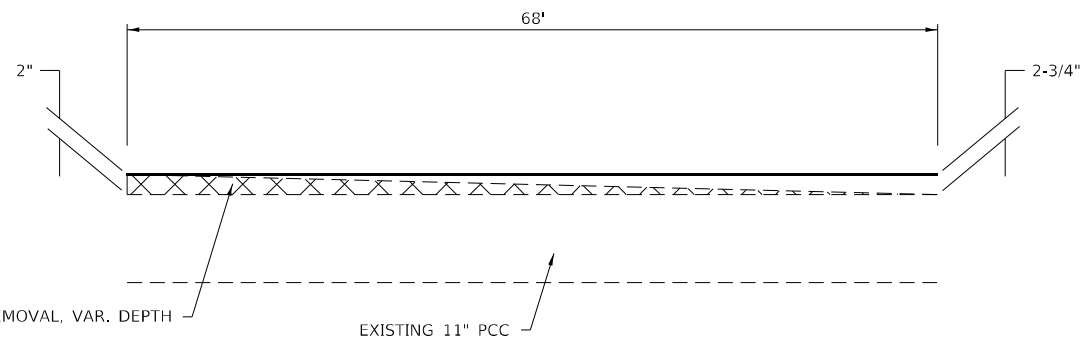

**VARIABLE MILLING & TAPER**

99+41 - 100+16

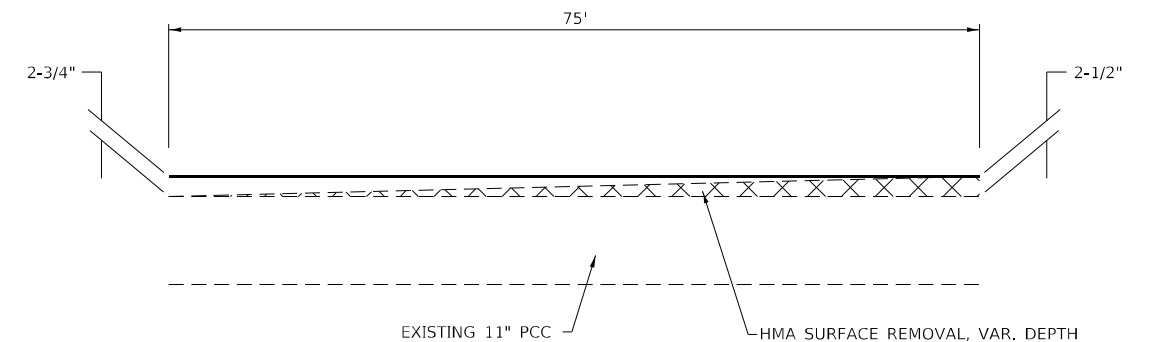

- \* MATCH EXISTING CROSS SLOPE
- \*\* 9% MAX CROSS SLOPE
- HMA UNIT WEIGHT 112 LBS/ SQ YD/ IN

USER NAME = cushmanbw	DESIGNED -	REVISED -
	DRAWN -	REVISED -
PLOT SCALE = 8:0 "/>		

**STATE OF ILLINOIS  
DEPARTMENT OF TRANSPORTATION**

**TYPICAL SECTION**

SCALE: SHEET OF SHEETS STA. TO STA.

F.A.P. RTE.	SECTION	COUNTY	TOTAL SHEETS	SHEET NO.
301	43RS	JO DAVIESS	33	9
CONTRACT NO. 64N63				
ILLINOIS FED. AID PROJECT				

MODEL: Default  
 FILE NAME: p:\pub\marmoon.edu\illinois.gov\PROJECTS\64N63\Program\_Development\Studies & Plans\Design\CADD\CAD\Sheet102-64N63-112-12.dwg  
 PROJECT: 64N63-112-12  
 OFFICE: DISTRICT 2  
 PLOT DATE: Jun-25-2021 06:35:24 AM

**44000500 COMBINATION CURB AND GUTTER REMOVAL**

FOOT	LOCATION	OFFSET	REMARKS
150	63+50 - 65+00	RT	AS DIRECTED BY RESIDENT ENGINEER
100	47+17 - 100+16	LT & RT	
<b>250</b>	<b>TOTAL</b>		

**44213204 TIE BARS 3/4"**

EACH	LOCATION	OFFSET	REMARKS
75	63+50 - 65+00	RT	AS DIRECTED BY RESIDENT ENGINEER
50	47+17 - 100+16	LT & RT	
<b>125</b>	<b>TOTAL</b>		

**56109210 WATER VALVES TO BE ADJUSTED**

EACH	LOCATION	OFFSET	REMARKS
1	49+51	LT	
1	49+52	LT	
1	58+62	LT	
<b>3</b>	<b>TOTAL</b>		

**60255500 MANHOLES TO BE ADJUSTED**

EACH	LOCATION	OFFSET	REMARKS
1	47+23	RT	
1	48+71	RT	
1	49+17	RT	
1	49+57	LT	
1	57+47	LT	
1	58+48	LT	
1	95+70	RT	
<b>7</b>	<b>TOTAL</b>		

**60260100 INLETS TO BE ADJUSTED**

EACH	LOCATION	OFFSET	REMARKS
1	49+17	LT	
1	49+21	LT	
1	49+93	LT	
1	51+31	RT	
2	54+17	LT & RT	
2	56+95	LT & RT	
2	56+99	LT & RT	
1	58+57	RT	
1	58+73	LT	
2	61+19	LT & RT	
2	63+94	LT & RT	
1	68+11	RT	
2	74+34	LT & RT	
2	76+94	LT & RT	
1	79+56	LT & RT	
1	82+18	RT	
1	89+11	LT	
1	94+23	LT	
<b>25</b>	<b>TOTAL</b>		

**60610400 COMBINATION CONCRETE CURB AND GUTTER, TYPE M-6.24**

FOOT	LOCATION	OFFSET	REMARKS
150	63+50 - 65+00	RT	AS DIRECTED BY RESIDENT ENGINEER
100	47+17 - 100+16	LT & RT	
<b>250</b>	<b>TOTAL</b>		

**70300100 SHORT TERM PAVEMENT MARKING**

FOOT	LOCATION	OFFSET	REMARKS
10598	47+17 - 100+16	LT & RT	Binder Lift
10598	47+17 - 100+16	LT & RT	Surface Lift
<b>21196</b>	<b>TOTAL</b>		

**70300150 SHORT TERM PAVEMENT MARKING REMOVAL**

SQ FT	LOCATION	OFFSET	REMARKS
3533	47+17 - 100+16	LT & RT	Binder Lift
3533	47+17 - 100+16	LT & RT	Surface Lift
<b>7065</b>	<b>TOTAL</b>		

**78000100 THERMOPLASTIC PAVEMENT MARKING - LETTERS AND SYMBOLS**

SQ FT	LOCATION	OFFSET	REMARKS
15.6	47+74		LEFT TURN ARROW
15.6	47+90		LEFT TURN ARROW
15.6	48+94		LEFT TURN ARROW
15.6	49+10		LEFT TURN ARROW
15.6	50+12		LEFT TURN ARROW
15.6	50+28		LEFT TURN ARROW
15.6	51+41		LEFT TURN ARROW
15.6	52+61		LEFT TURN ARROW
15.6	53+81		LEFT TURN ARROW
15.6	55+01		LEFT TURN ARROW
15.6	56+21		LEFT TURN ARROW
15.6	57+41		LEFT TURN ARROW
15.6	58+61		LEFT TURN ARROW
15.6	59+81		LEFT TURN ARROW
15.6	61+01		LEFT TURN ARROW
15.6	62+38		LEFT TURN ARROW
15.6	63+11		LEFT TURN ARROW
15.6	63+83		LEFT TURN ARROW
15.6	67+41		LEFT TURN ARROW
15.6	68+14		LEFT TURN ARROW
15.6	68+86		LEFT TURN ARROW
15.6	70+18		LEFT TURN ARROW
15.6	70+93		LEFT TURN ARROW
41.5	84+73		LANE DROP ARROW
15.6	85+09		LEFT TURN ARROW
15.6	85+67		LEFT TURN ARROW
15.6	86+26		LEFT TURN ARROW
15.6	86+84		LEFT TURN ARROW
41.5	90+23		LANE DROP ARROW
<b>504</b>	<b>TOTAL</b>		

MODEL: Default  
 FILE NAME: p:\pub\mranon.dwg  
 PROJECT: I:\GIS\DOT\Documents\DOT - Office\District 2\Projects\GIS\MS3\Program Development\Studies & Plans\Design\CADD\CADDsheet102-64N63-10-500.dwg

USER NAME = cushmarbw	DESIGNED -	REVISED -
	DRAWN -	REVISED -
PLOT SCALE = 100,0000' / in.	CHECKED -	REVISED -
PLOT DATE = Jun-25-2021 06:23:29 AM	DATE -	REVISED -

**STATE OF ILLINOIS  
DEPARTMENT OF TRANSPORTATION**

**SCHEDULE OF QUANTITIES**

SCALE: SHEET OF SHEETS STA. TO STA.

F.A.P. RTE.	SECTION	COUNTY	TOTAL SHEETS	SHEET NO.
301	43RS	JO DAVIESS	33	10
CONTRACT NO. 64N63				
ILLINOIS FED. AID PROJECT				

**78000200 THERMOPLASTIC PAVEMENT MARKING - LINE 4"**

FOOT	LOCATION	OFFSET	REMARKS
2195	47+11 - 69+06	RT	WHITE
1686	47+17 - 64+03	LT	WHITE
1814	47+17 - 61+68	RT	YELLOW - SOLID AND SKIP
1814	47+17 - 61+68	LT	YELLOW - SOLID AND SKIP
470	61+68 - 64+03	LT	DOUBLE YELLOW
8	64+03 -	LT	WHITE
182	64+71 - 66+49	RT	DOUBLE YELLOW
182	64+71 - 66+49	LT	DOUBLE YELLOW
401	65+05 - 69+06	LT	WHITE
8	65+05 -	LT	WHITE
261	66+49 - 69+06	LT	DOUBLE YELLOW
8	69+06	RT	WHITE
8	69+06	LT	WHITE
8	69+98	RT	WHITE
8	69+98	LT	WHITE
3018	69+98 100+16	RT	WHITE
1706	69+98 87+04	LT	WHITE
183	69+98 71+77	RT	DOUBLE YELLOW
1316	71+77 84+89	RT	DOUBLE YELLOW
370	71+77 75+43	LT	DOUBLE YELLOW
1161	75+43 87+04	LT	YELLOW
215	84+89 87+04	RT	YELLOW
298	87+78 90+52	RT +	DOUBLE YELLOW
1238	87+78 100+16	LT	WHITE
1220	87+96 100+16	LT	YELLOW
964	90+52 100+16	RT	YELLOW
241	90+52 100+16	RT	WHITE - SKIPDASH
241	90+52 100+16	LT	WHITE - SKIPDASH
<b>21224</b>	<b>TOTAL</b>		

**78000500 THERMOPLASTIC PAVEMENT MARKING - LINE 8"**

FOOT	LOCATION	OFFSET	REMARKS
185	62+18 64+03	RT	WHITE- SOLID
184	67+21 69+05	RT	WHITE- SOLID
115	69+98 71+13	LT	WHITE- SOLID
215	84+89 87+04	RT	WHITE- SOLID
<b>699</b>	<b>TOTAL</b>		

**78000600 THERMOPLASTIC PAVEMENT MARKING - LINE 12"**

FOOT	LOCATION	OFFSET	REMARKS
286	47+11 - 69+06	RT	WHITE DIAGONALS
220	47+17 - 64+03	LT	WHITE DIAGONALS
72	64+97 67+09	MEDIAN	YELLOW DIAGONALS
66	65+05 69+06	LT	WHITE DIAGONALS
125	69+98 78+74	RT	WHITE DIAGONALS
186	69+98 81+00	LT	WHITE DIAGONALS
430	71+47 84+07	MEDIAN	YELLOW DIAGONALS
85	87+85 90+00	MEDIAN	YELLOW DIAGONALS
<b>1470</b>	<b>TOTAL</b>		

**78100100 RAISED REFLECTIVE PAVEMENT MARKER**

EACH	LOCATION	OFFSET	REMARKS
5	47+40 - 49+00	RT	ONE-WAY CRYSTAL
5	47+40 - 49+00	LT	ONE-WAY CRYSTAL
37	47+17 - 61+68	RT	TWO-WAY AMBER
37	47+17 61+68	LT	TWO-WAY AMBER
19	61+68 - 64+03	LT	TWO-WAY AMBER
10	62+18 64+03	RT	ONE-WAY CRYSTAL
10	64+71 - 66+49	RT	TWO-WAY AMBER
5	64+71 - 66+49	LT	TWO-WAY AMBER
21	66+49 - 69+06	LT	TWO-WAY AMBER
10	67+21 69+05	RT	ONE-WAY CRYSTAL
15	69+98 71+77	RT	TWO-WAY AMBER
7	69+98 71+13	LT	ONE-WAY CRYSTAL
34	71+77 84+89	RT	TWO-WAY AMBER
7	71+77 73+00	LT	TWO-WAY AMBER
7	73+00 75+43	LT	TWO-WAY AMBER
16	75+93 81+93	LT	ONE-WAY CRYSTAL
9	77+00 80+10	RT	ONE-WAY CRYSTAL
6	84+89 87+04	RT	ONE-WAY CRYSTAL
8	87+78 90+52	RT +	DOUBLE YELLOW
13	90+40 100+16	RT	ONE-WAY CRYSTAL
13	90+40 100+16	LT	ONE-WAY CRYSTAL
<b>296</b>	<b>TOTAL</b>		

**78300200 RAISED REFLECTIVE PAVEMENT MARKER REMOVAL**

EACH	LOCATION	OFFSET	REMARKS
60	47+17 100+16	RT	
60	47+17 100+16	LT	
<b>119</b>	<b>TOTAL</b>		

**X6024503 INLETS TO BE ADJUSTED WITH NEW FRAME AND GRATE (SPECIAL)**

EACH	LOCATION	OFFSET	REMARKS
1	50+27	Median	Neenah Foundry # R-3210-A Grate Type C
1	65+92	Median	Neenah Foundry # R-3067-C Grate Type C
1	70+06	Median	Neenah Foundry # R-3067-C Grate Type C
<b>3</b>	<b>TOTAL</b>		

MODEL: Default  
 FILE NAME: p:\pub\lhamonm.dwt\illinois.gov\PWIDOT\Documents\DOT\_Offices\District 2\Projects\64N63\Program\_Development\Studies & Plans\Design\CADD\CAD\Sheet\02-64N63-115-S00.dgn

USER NAME = cushmarbw	DESIGNED -	REVISED -
	DRAWN -	REVISED -
PLOT SCALE = 100,0000 ' / in.	CHECKED -	REVISED -
PLOT DATE = Jun-25-2021 06:24:02 AM	DATE -	REVISED -

**STATE OF ILLINOIS  
DEPARTMENT OF TRANSPORTATION**

**SCHEDULE OF QUANTITIES**

SCALE: SHEET OF SHEETS STA. TO STA.

F.A.P. RTE.	SECTION	COUNTY	TOTAL SHEETS	SHEET NO.
301	43R5	JO DAVIESS	33	11
CONTRACT NO. 64N63				
ILLINOIS FED. AID PROJECT				

**X7830060 GROOVING FOR RECESSED PAVEMENT MARKING, LETTERS AND SYMBOLS**

SQ FT	LOCATION	OFFSET	REMARKS
18.9	47+74	-	LEFT TURN ARROW
18.9	47+90		LEFT TURN ARROW
18.9	48+94		LEFT TURN ARROW
18.9	49+10		LEFT TURN ARROW
18.9	50+12		LEFT TURN ARROW
18.9	50+28		LEFT TURN ARROW
18.9	51+41		LEFT TURN ARROW
18.9	52+61		LEFT TURN ARROW
18.9	53+81		LEFT TURN ARROW
18.9	55+01		LEFT TURN ARROW
18.9	56+21		LEFT TURN ARROW
18.9	57+41		LEFT TURN ARROW
18.9	58+61		LEFT TURN ARROW
18.9	59+81		LEFT TURN ARROW
18.9	61+01		LEFT TURN ARROW
18.9	62+38		LEFT TURN ARROW
18.9	63+11		LEFT TURN ARROW
18.9	63+83		LEFT TURN ARROW
18.9	67+41		LEFT TURN ARROW
18.9	68+14		LEFT TURN ARROW
18.9	68+86		LEFT TURN ARROW
18.9	70+18		LEFT TURN ARROW
18.9	70+93		LEFT TURN ARROW
50.7	84+73		LANE DROP ARROW
18.9	85+09		LEFT TURN ARROW
18.9	85+67		LEFT TURN ARROW
18.9	86+26		LEFT TURN ARROW
18.9	86+84		LEFT TURN ARROW
50.7	90+23		LANE DROP ARROW
<b>612</b>	<b>TOTAL</b>		

**X7830070 GROOVING FOR RECESSED PAVEMENT MARKING 5"**

FOOT	LOCATION	OFFSET	REMARKS
2195	47+11	- 69+06	RT WHITE
1686	47+17	- 64+03	LT WHITE
1814	47+17	- 61+68	RT YELLOW - SOLID AND SKIP
1814	47+17	61+68	LT YELLOW - SOLID AND SKIP
470	61+68	- 64+03	LT DOUBLE YELLOW
8	64+03	-	LT WHITE
182	64+71	- 66+49	RT DOUBLE YELLOW
182	64+71	- 66+49	LT DOUBLE YELLOW
401	65+05	- 69+06	LT WHITE
8	65+05	-	LT WHITE
261	66+49	- 69+06	LT DOUBLE YELLOW
8	69+06		RT WHITE
8	69+06		LT WHITE
8	69+98		RT WHITE
8	69+98		LT WHITE
3018	69+98	100+16	RT WHITE
1706	69+98	87+04	LT WHITE
183	69+98	71+77	RT DOUBLE YELLOW
1316	71+77	84+89	RT DOUBLE YELLOW
370	71+77	75+43	LT DOUBLE YELLOW
1161	75+43	87+04	LT YELLOW
215	84+89	87+04	RT YELLOW
298	87+78	90+52	RT + DOUBLE YELLOW
1238	87+78	100+16	LT WHITE
1220	87+96	100+16	LT YELLOW
964	90+52	100+16	RT YELLOW
241	90+52	100+16	RT WHITE - SKIPDASH
241	90+52	100+16	LT WHITE - SKIPDASH
<b>21224</b>	<b>TOTAL</b>		

**X7830076 GROOVING FOR RECESSED PAVEMENT MARKING 9"**

FOOT	LOCATION	OFFSET	REMARKS
185	62+18	64+03	RT WHITE-SOLID
184	67+21	69+05	RT WHITE-SOLID
115	69+98	71+13	LT WHITE-SOLID
215	84+89	87+04	RT WHITE-SOLID
<b>699</b>	<b>TOTAL</b>		

**X7830078 GROOVING FOR RECESSED PAVEMENT MARKING 13"**

FOOT	LOCATION	OFFSET	REMARKS
286	47+11	- 69+06	RT WHITE DIAGONALS
220	47+17	- 64+03	LT WHITE DIAGONALS
72	64+97	67+09	MEDIAN YELLOW DIAGONALS
66	65+05	69+06	LT WHITE DIAGONALS
125	69+98	78+74	RT WHITE DIAGONALS
186	69+98	81+00	LT WHITE DIAGONALS
430	71+47	84+07	MEDIAN YELLOW DIAGONALS
85	87+85	90+00	MEDIAN YELLOW DIAGONALS
<b>1470</b>	<b>TOTAL</b>		

MODEL: Default  
 FILE NAME: p:\pub\mranon.dwt\illinois.gov\PWDOT\Documents\DOT\_Office\District 2\Projects\616\63\Program\_Development\Studies & Plans\Design\CADD\CAD\Sheet\02-64N63-115-500.dgn

USER NAME = cushmarbw	DESIGNED -	REVISED -
	DRAWN -	REVISED -
PLOT SCALE = 100,0000' / in.	CHECKED -	REVISED -
PLOT DATE = Jun-25-2021 06:24:34 AM	DATE -	REVISED -

**STATE OF ILLINOIS  
DEPARTMENT OF TRANSPORTATION**

**SCHEDULE OF QUANTITIES**

SCALE: SHEET OF SHEETS STA. TO STA.

F.A.P. RTE.	SECTION	COUNTY	TOTAL SHEETS	SHEET NO.
301	43RS	JO DAVIESS	33	12
CONTRACT NO. 64N63				
ILLINOIS FED. AID PROJECT				

MODEL: Default  
 FILE NAME: J:\Illinois\dot\Documents\DOT\_Office\District 2\Projects\64N63\Program\_Development\Studies & Plans\Design\CADD\CAD\Sheet102-64N63-15-S00.dgn

LOCATION		REMARKS	PAVEMENT												AGG	BIT MAT	HMA	HMA	HMA	HMA	STRIP	AGG	LONG	MAT	PCC	HMA	HMA	MEDIAN
			LENGTH	EB	EB	Bi-Dir/	WB	WB	EB	EB	Bi-Dir/	WB	WB	AGG	(TACK	BINDER	BNDR	SURFACE	SURFACE	REFL	WEDGE	JOINT	TRANS	PAV'T	SURF	SURF	REM	
				FT	SHLDR	LANE	Turn	Lane	SHLDR	LANE	SHLDR	LANE	SHLDR	LANE	SHLDR	TON	COAT)	(H M), N70	CRSE, IL-	COURSE,	CRACK	SHLDR	SEALANT	DEVICE	SURF	REM,	REM,	VAR
STA TO STA	FT	FT	FT	FT	FT	SQ YD	SQ YD	SQ YD	SQ YD	SQ YD	SQ YD	SQ YD	POUND	TON	TON	TON	TON	FOOT	TON	FOOT	TON	SQ YD	SQ YD	SQ YD	SQ FT			
														2 APPS														
47 + 17.0	-	47 + 85.0	68	2-4	13	14	13	2-4	25	102	106	102	23	241.7	0.1	25		30	68		272	55		8	358			
47 + 85.0	-	48 + 97.0	112	4-8	13	14	13	4-8	76	168	174	168	76	446.9	0.2	46		56	112		448	102	41	12				
48 + 97.0	-	64 + 05.0	1508	8	13	14	13	8	1340	2262	2346	2262	1340	6446.7	2.9	669		802	1508		6032	1471	670	168				
64 + 05.0	-	64 + 87.0	82	8	13	14	13	8	73	123	128	123	73	350.6	0.2	36		44	82		328	80		9				
64 + 87.0	-	69 + 09.0	422	8	13	14	13	8	375	633	656	633	375	1804.1	0.8	187		225	422		1688	412		47	1688			
69 + 09.0	-	70 + 01.0	92	8	13	14	13	8	82	138	143	138	82	393.3	0.2	41		49	92		368	90		10				
70 + 01.0	-	72 + 93.0	292	8	13	14	13	8	260	438	454	438	260	1248.3	0.6	129		155	292		1168	285		32	1168			
72 + 93.0	-	75 + 47.5	254.5	8	13	14-9	13	8-13	226	382	330	382	307	1098.4	0.5	114		137	255		1018	251		28	1018			
75 + 47.5	-	82 + 24.0	676.5	var	26	4	26	var		1992		1992	228	2843.1	1.3	295		354	677		1353	649		75				
82 + 24.0	-	87 + 07.0	483		26	4	26	8		1422		1422	429	2209.7	0.9	199	66	239	483	15	966	504		54				
87 + 07.0	-	87 + 94.0	87		26	4	26	8	0	256	39	256	77	424.1	0.2	39	12	46	87	3	174	97		10				
87 + 94.0	-	99 + 41.0	1147		26	4	26	8	0	3377		3377	1020	5247.5	2.2	473	157	567	1147	36	2294	1197		127				
99 + 41.0	-	100 + 16.0	75		26	4	26	8	0	221		221	67	343.1	0.1	31	10	37	75	2	150	78		8	508			
<b>TOTAL</b>													<b>430</b>	<b>23097</b>	<b>10</b>	<b>2284</b>	<b>245</b>	<b>2741</b>	<b>5299</b>	<b>56</b>	<b>16259</b>	<b>5270</b>	<b>712</b>	<b>589</b>	<b>866</b>	<b>3874</b>		

NOTE: BITUMINOUS MATERIALS (TACK COAT) RATE OF APPLICATION 0.05 LB/SQ FT ON EXISTING SURFACE & 0.025 LB/SQ FT ON HMA BINDER COURSE  
 LONGITUDINAL JOINT SEALANT TO BE PLACED BETWEEN THE BINDER AND SURFACE LAYERS STA 47+17 TO 75+47.5 JOINT BETWEEN EXISTING LANES AND JOINT ALONG MEDIAN 75+47.5 TO 100+16 JOINT BETWEEN EXISTING LANES

USER NAME = cushmarbw	DESIGNED -	REVISED -	<b>STATE OF ILLINOIS DEPARTMENT OF TRANSPORTATION</b>	<b>HMA SCHEDULE</b>				F.A.P. RTE.	SECTION	COUNTY	TOTAL SHEETS	SHEET NO.	
PLOT SCALE = 100,0000' / in.	DRAWN -	REVISED -		SCALE:	SHEET	OF	SHEETS	STA.	TO STA.	301	43RS	33	13
PLOT DATE = Jun-25-2021 06:25:11 AM	CHECKED -	REVISED -		CONTRACT NO. 64N63									
	DATE -	REVISED -		ILLINOIS FED. AID PROJECT									

MODEL: Default  
 FILE NAME: p:\pub\mranon.dwt\illinois\pwwid\DOT\Documents\DOT - Office\District 2\Projects\616\63\Program Development\Studies & Plans\Design\CADD\CAD\Sheet\02-64N63-115-500.dgn

FIELD INPUT AREA			44200982		44200986		44200988		44213200	44201299	44213204	44200050
STA	LENGTH OF PATCH		TYPE II, 11 INCH		TYPE III, 11 INCH		TYPE IV, 11 INCH		SAWING (3W+?L) (ft)	DOWEL BARS 1 1/2" (each)	TIE BARS 3/4" (each)	WELDED WIRE REINF. (yd <sup>2</sup> )
	LT LANE (ft)	RT LANE (ft)	LT LANE (yd <sup>2</sup> )	RT LANE (yd <sup>2</sup> )	LT LANE (yd <sup>2</sup> )	RT LANE (yd <sup>2</sup> )	LT LANE (yd <sup>2</sup> )	RT LANE (yd <sup>2</sup> )				
<b>EASTBOUND</b>												
50+00	6	6	8.0	8.0	0.0	0.0	0.0	0.0	102	40	0	0.0
51+00	30	30	0.0	0.0	0.0	0.0	40.0	40.0	222	40	14	80.0
51+50	6	15	8.0	0.0	0.0	20.0	0.0	0.0	129	40	0	20.0
52+00	6	6	8.0	8.0	0.0	0.0	0.0	0.0	102	40	0	0.0
53+00	15	15	0.0	0.0	20.0	20.0	0.0	0.0	147	40	0	40.0
55+50	6	6	8.0	8.0	0.0	0.0	0.0	0.0	102	40	0	0.0
61+50	6	6	8.0	8.0	0.0	0.0	0.0	0.0	102	40	0	0.0
62+25	6		8.0	0.0	0.0	0.0	0.0	0.0	54	20	0	0.0
62+50	6	6	8.0	8.0	0.0	0.0	0.0	0.0	102	40	0	0.0
64+50	6		8.0	0.0	0.0	0.0	0.0	0.0	54	20	0	0.0
64+75	6		8.0	0.0	0.0	0.0	0.0	0.0	54	20	0	0.0
65+50	10		13.3	0.0	0.0	0.0	0.0	0.0	66	20	0	0.0
66+00	6	6	8.0	8.0	0.0	0.0	0.0	0.0	102	40	0	0.0
68+00	6	6	8.0	8.0	0.0	0.0	0.0	0.0	102	40	0	0.0
72+50	6	6	8.0	8.0	0.0	0.0	0.0	0.0	102	40	0	0.0
73+25		6	0.0	8.0	0.0	0.0	0.0	0.0	54	20	0	0.0
75+00	6	6	8.0	8.0	0.0	0.0	0.0	0.0	102	40	0	0.0
76+50	6	6	8.0	8.0	0.0	0.0	0.0	0.0	102	40	0	0.0
78+00	6		8.0	0.0	0.0	0.0	0.0	0.0	54	20	0	0.0
81+75	6		8.0	0.0	0.0	0.0	0.0	0.0	54	20	0	0.0
89+00		20	0.0	0.0	0.0	0.0	0.0	26.7	96	20	9	26.7
91+50	6	6	8.0	8.0	0.0	0.0	0.0	0.0	102	40	0	0.0
92+00	6		8.0	0.0	0.0	0.0	0.0	0.0	54	20	0	0.0
96+00	6	6	8.0	8.0	0.0	0.0	0.0	0.0	102	40	0	0.0
96+75	10	10	13.3	13.3	0.0	0.0	0.0	0.0	122	40	0	0.0
99+50	6		8.0	0.0	0.0	0.0	0.0	0.0	54	20	0	0.0
100+00	6		8.0	0.0	0.0	0.0	0.0	0.0	54	20	0	0.0
<b>WESTBOUND</b>												
54+50	6	0	8.0	0.0	0.0	0.0	0.0	0.0	54	20	0	0.0
55+00	6		8.0	0.0	0.0	0.0	0.0	0.0	54	20	0	0.0
57+50	6		8.0	0.0	0.0	0.0	0.0	0.0	54	20	0	0.0
58+00	6	8	8.0	10.7	0.0	0.0	0.0	0.0	108	40	0	0.0
59+00	50	50	0.0	0.0	0.0	0.0	66.7	66.7	322	40	24	133.3
60+00	6	6	8.0	8.0	0.0	0.0	0.0	0.0	102	40	0	0.0
61+00	6	6	8.0	8.0	0.0	0.0	0.0	0.0	102	40	0	0.0
63+75	6	6	8.0	8.0	0.0	0.0	0.0	0.0	102	40	0	0.0
64+00	40	40	0.0	0.0	0.0	0.0	53.3	53.3	272	40	19	106.7
66+00	6	6	8.0	8.0	0.0	0.0	0.0	0.0	102	40	0	0.0
67+00	6	6	8.0	8.0	0.0	0.0	0.0	0.0	102	40	0	0.0
69+50	6	6	8.0	8.0	0.0	0.0	0.0	0.0	102	40	0	0.0
75+50	6	6	8.0	8.0	0.0	0.0	0.0	0.0	102	40	0	0.0
76+25	6	6	8.0	8.0	0.0	0.0	0.0	0.0	102	40	0	0.0
76+50	6	6	8.0	8.0	0.0	0.0	0.0	0.0	102	40	0	0.0
79+50	6	0	8.0	0.0	0.0	0.0	0.0	0.0	54	20	0	0.0
82+25	6	6	8.0	8.0	0.0	0.0	0.0	0.0	102	40	0	0.0
83+00	6	6	8.0	8.0	0.0	0.0	0.0	0.0	102	40	0	0.0
85+50	6	6	8.0	8.0	0.0	0.0	0.0	0.0	102	40	0	0.0
86+25	15	15	0.0	0.0	20.0	20.0	0.0	0.0	147	40	0	40.0
87+00	6	6	8.0	8.0	0.0	0.0	0.0	0.0	102	40	0	0.0
88+00	6	6	8.0	8.0	0.0	0.0	0.0	0.0	102	40	0	0.0
88+50	6	6	8.0	8.0	0.0	0.0	0.0	0.0	102	40	0	0.0
94+00	6	6	8.0	8.0	0.0	0.0	0.0	0.0	102	40	0	0.0
94+75	6	6	8.0	8.0	0.0	0.0	0.0	0.0	102	40	0	0.0
95+50	6	6	8.0	8.0	0.0	0.0	0.0	0.0	102	40	0	0.0
96+00	6		8.0	0.0	0.0	0.0	0.0	0.0	54	20	0	0.0
<b>MEDIAN</b>												
64+87	69+09		0.0	0.0	0.0	0.0	187.6	0.0	0	0	422	187.6
70+01	72+93		0.0	0.0	0.0	0.0	129.8	0.0	0	0	292	129.8
72+93	75+48		0.0	0.0	0.0	0.0	113.1	0.0	0	0	255	113.1
<b>Total</b>			<b>386.7</b>	<b>272.0</b>	<b>40.0</b>	<b>60.0</b>	<b>590.4</b>	<b>186.7</b>	<b>5447</b>	<b>1840</b>	<b>1035</b>	<b>877</b>
			<b>659</b>		<b>100</b>		<b>777</b>					

USER NAME = cushmarbw	DESIGNED -	REVISED -
	DRAWN -	REVISED -
PLOT SCALE = 100,0000' / in.	CHECKED -	REVISED -
PLOT DATE = Jun-25-2021 06:26:10 AM	DATE -	REVISED -

**STATE OF ILLINOIS  
DEPARTMENT OF TRANSPORTATION**

**PATCHING SCHEDULE**

SCALE: SHEET OF SHEETS STA. TO STA.

F.A.P. RTE.	SECTION	COUNTY	TOTAL SHEETS	SHEET NO.
301	43RS	JO DAVIESS	33	14
CONTRACT NO. 64N63				
ILLINOIS FED. AID PROJECT				

MODEL: Default  
 FILE NAME: p:\pub\mranon.dwt\illinois.gov\PWIDOT\Documents\IDOT\_Offices\District 2\Projects\616\63\Program\_Development\Studies & Plans\Design\CADD\CAD\Sheet\02-64N63-15-S00.dgn

Station	Side	Common Name of Sign	Sign Code	Size Hor (in)	Size Ver (in)	72000100	72000200	72400310	72800100	72800100	73000100	Notes
						SIGN PANEL TYPE 1 (SQ.FT)	SIGN PANEL TYPE 2 (SQ.FT)	REMOVE SIGN PANEL Type 1 (SQ.FT)	TELESCOPING STEEL SIGN SUPPORT (FOOT) (2 in)	TELESCOPING STEEL SIGN SUPPORT (FOOT) (2 1/4 in)	WOOD SIGN SUPPORT (FOOT)	
47+10	Right	TWO WAY LEFT TURN ONLY	R3-9b	24	36	6.00				9.0	5.0	
49+53	Left	STOP	R1-1	36	36	9.00		6.25				
50+76	Left	TWO WAY TRAFFIC	W6-3	36	36	9.00		9.00	9.0	5.0		
55+91	Right	SPEED LIMIT 40	R2-1	30	36	7.50		7.50				
57+48	Left	LEFT LANE ENDS	W4-2L					9.00				
61+01	Right	DIVIDED HIGHWAY	W6-1					9.00				
61+74	Left	TWO WAY LEFT TURN ONLY	R3-9b	24	36	6.00						
		LEFT LANE ENDS	W9-1L					9.00				
63+13	Left	STOP	R1-1	36	36	9.00		6.25				
		DIVIDED HIGHWAY	R6-3A					5.00				
70+10	Left	DIVIDED HIGHWAY ENDS	W6-2					9.00				
75+43	CL	KEEP RIGHT	R4-7	24	30	5.00			9.0	5.0		
85+62	Left	RIGHT LANE ENDS	W4-2R	48	48		16.00				18.0	
87+02	CL	OBJECT MARKER	OM-3L	12	36	3.00			9.0	5.0		
87+19	Left	DIVIDED HIGHWAY	R6-3A					5.00				
87+98	CL	KEEP RIGHT	R4-7	24	30	5.00			9.0	5.0		
		OBJECT MARKER	OM-3L	12	36	3.00						
89+18	Left	RIGHT LANE ENDS	W9-1R	48	48		16.00				18.0	
<b>Total</b>						<b>63</b>	<b>32</b>	<b>75</b>	<b>45</b>	<b>25</b>	<b>36</b>	

USER NAME = cushmarbw	DESIGNED -	REVISED -
	DRAWN -	REVISED -
PLOT SCALE = 100,0000' / in.	CHECKED -	REVISED -
PLOT DATE = Jun-25-2021 06:25:47 AM	DATE -	REVISED -

**STATE OF ILLINOIS  
DEPARTMENT OF TRANSPORTATION**

**SIGN SCHEDULE**

SCALE: SHEET OF SHEETS STA. TO STA.

F.A.P. RTE.	SECTION	COUNTY	TOTAL SHEETS	SHEET NO.
301	43R5	JO DAVIESS	33	15
CONTRACT NO. 64N63				
ILLINOIS FED. AID PROJECT				

PROJECT BEGINS STA. 47+17

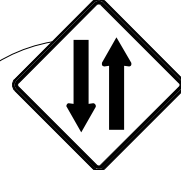
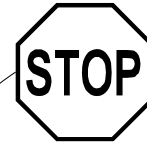
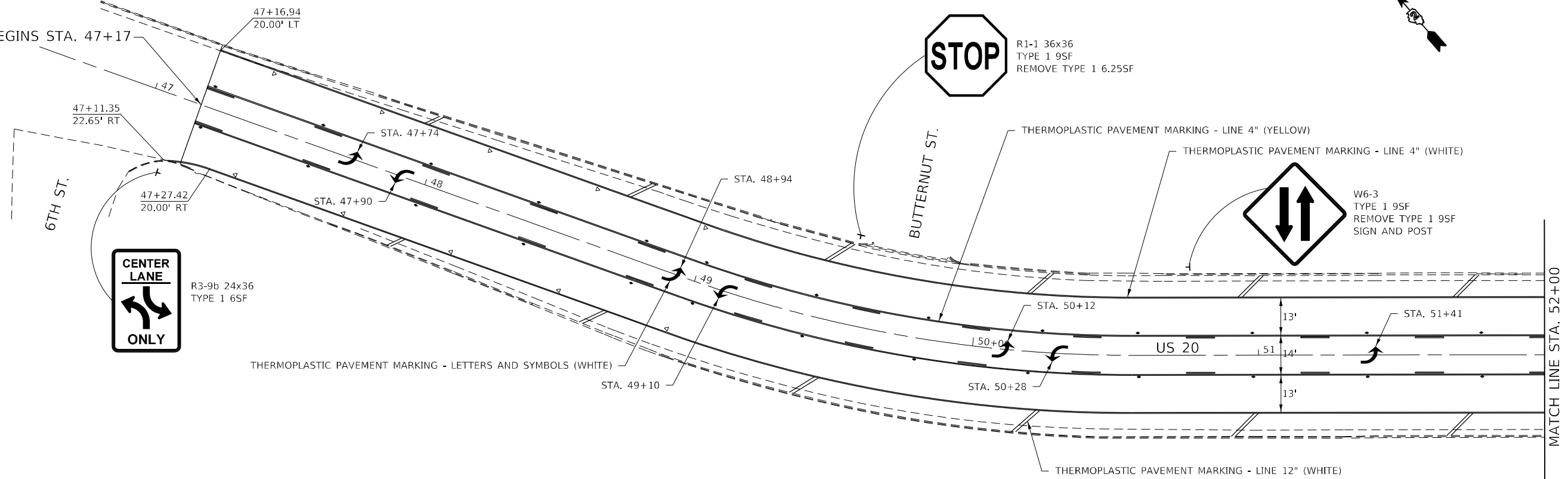

R3-9b 24x36  
TYPE 1 6SF

R1-1 36x36  
TYPE 1 9SF  
REMOVE TYPE 1 6.25SF

W6-3  
TYPE 1 9SF  
REMOVE TYPE 1 9SF  
SIGN AND POST

MODEL: Default  
FILE NAME: p:\pub\amr\room.dwg  
PROJECT: 64N63-Program Development Studies & Plans Design\CADD\CAD\Sheet\02\_64N63-pavementmarking.dwg

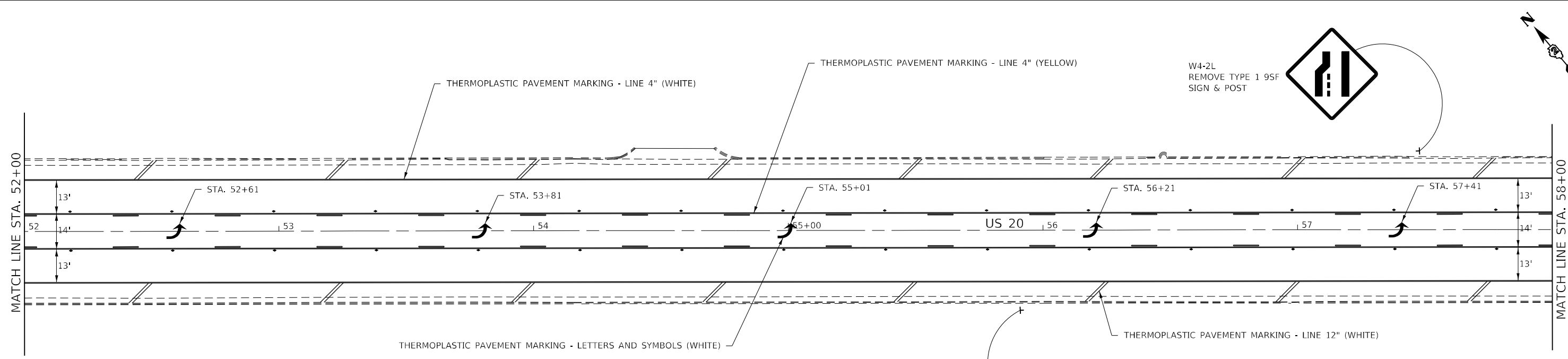

W4-2L  
REMOVE TYPE 1 9SF  
SIGN & POST

**LEGEND**

	ONE-WAY CRYSTAL
	TWO-WAY AMBER

USER NAME = cushmarbw PLOT SCALE 1"=20' PLOT DATE = Jul-25-2021 06:43:40 AM	DESIGNED - DRAWN - CHECKED - DATE -	REVISED - REVISED - REVISED - REVISED -	<b>STATE OF ILLINOIS DEPARTMENT OF TRANSPORTATION</b>	<b>SIGNING &amp; PAVEMENT MARKING</b>			F.A.P. RTE. 301 SECTION 43RS COUNTY JO DAVIESS CONTRACT NO. 64N63	TOTAL SHEETS 33 SHEET NO. 16
	SCALE: 1"=20'    SHEET 1 OF 6 SHEETS    STA. 47+17 TO STA. 58+00			ILLINOIS FED. AID PROJECT				





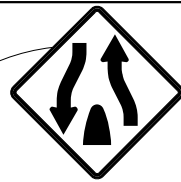

W6-2  
REMOVE TYPE 1 9SF  
(SIGN & POST)

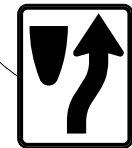
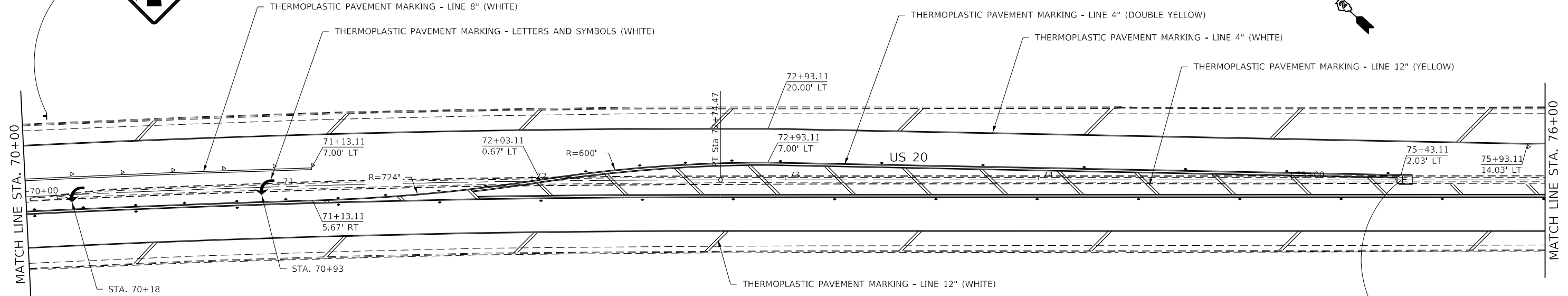
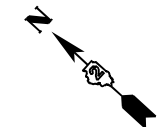

R4-7  
24x30  
TYPE 1 5SF  
TELESCOPING STEEL POST  
9FT  
5FT

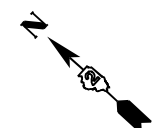
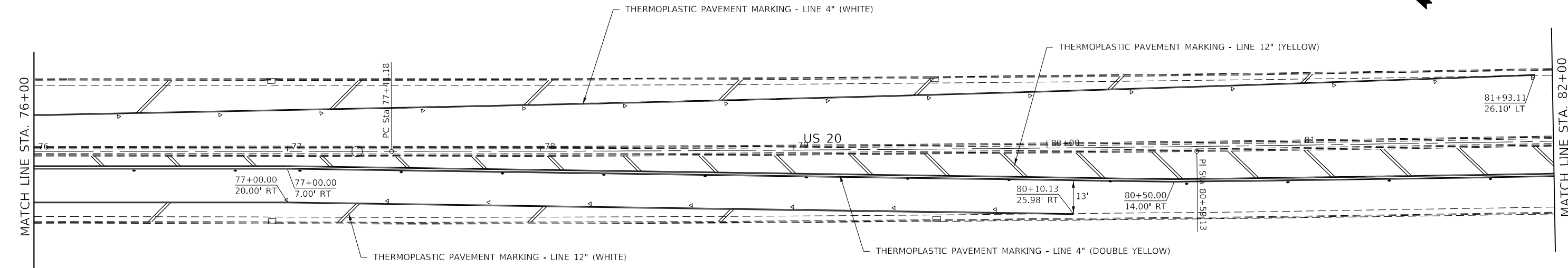

**LEGEND**

	ONE-WAY CRYSTAL
	TWO-WAY AMBER

MODEL: Default  
 FILE NAME: p:\planningroom\dot\illinois\dot\pww\dot\Documents\DOT\_Offices\District 2\Projects\64N63\Program\_Development\Studies & Plans\Design\CADD\CAD\Sheet\02\_64N63\pavementmarking.dwg

USER NAME = cushmarbw	DESIGNED -	REVISED -
PLOT SCALE 1"=20'	DRAWN -	REVISED -
PLOT DATE = Jun-25-2021 06:44:06 AM	CHECKED -	REVISED -
	DATE -	REVISED -

**STATE OF ILLINOIS  
DEPARTMENT OF TRANSPORTATION**

**SIGNING & PAVEMENT MARKING**

SCALE: 1"=20'    SHEET 3 OF 6 SHEETS    STA. 70+00 TO STA. 82+00

F.A.P. RTE.	SECTION	COUNTY	TOTAL SHEETS	SHEET NO.
301	43RS	JO DAVIESS	33	18
CONTRACT NO. 64N63				
ILLINOIS FED. AID PROJECT				

MODEL: Default  
 FILE NAME: p:\pub\amr\room.dwg  
 PROJECT: I:\GIS\DOT\Documents\DOT - Office\District 2\Projects\US163\Program Development\Studies & Plans\Design\CADD\CAD\Sheet\02\_64N63-pavement-marking.dwg

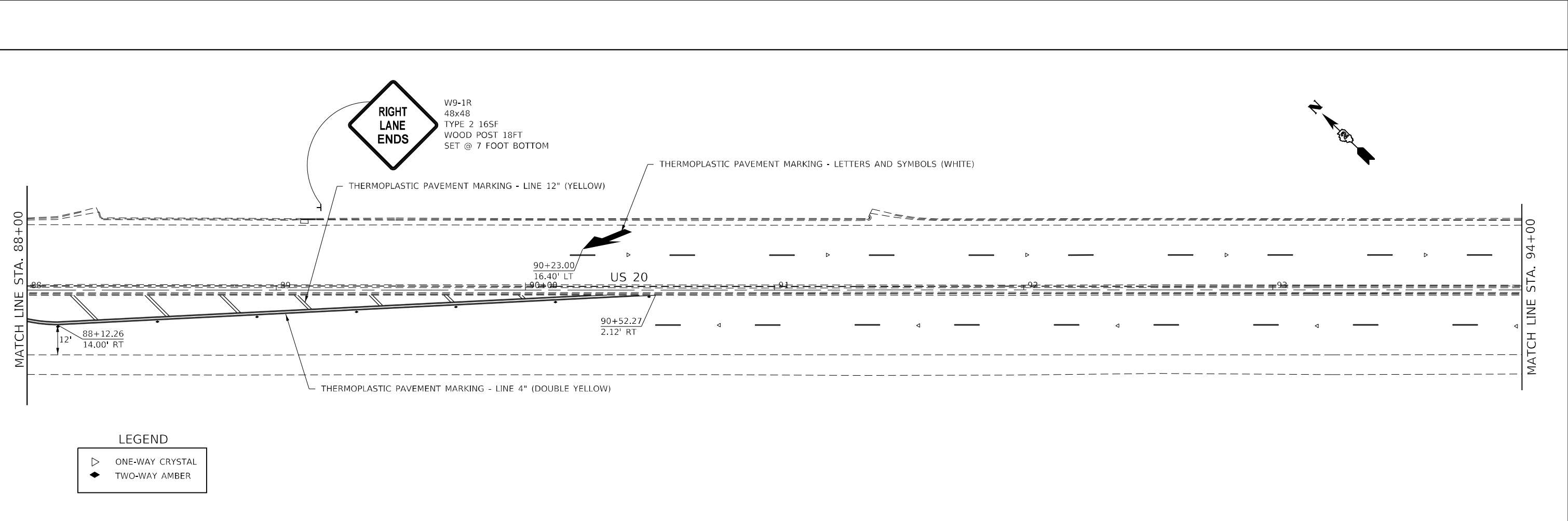
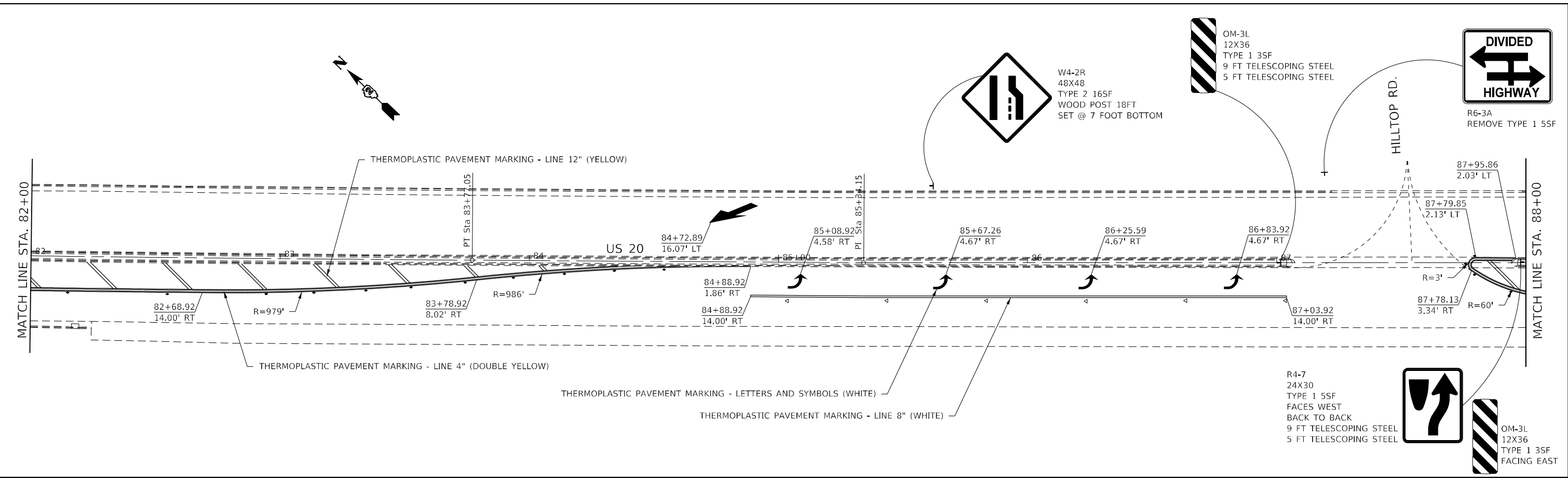

**LEGEND**

	ONE-WAY CRYSTAL
	TWO-WAY AMBER

USER NAME = cushmarbw	DESIGNED -	REVISED -
PLOT SCALE 1"=20'	DRAWN -	REVISED -
PLOT DATE = Jun-25-2021 08:06:40 AM	CHECKED -	REVISED -
	DATE -	REVISED -

**STATE OF ILLINOIS**  
**DEPARTMENT OF TRANSPORTATION**

**SIGNING & PAVEMENT MARKING**

SCALE: 1"=20'	SHEET 4 OF 6 SHEETS	STA. 82+00 TO STA. 94+00
---------------	---------------------	--------------------------

F.A.P. RTE.	SECTION	COUNTY	TOTAL SHEETS	SHEET NO.
301	43RS	JO DAVIESS	33	19
CONTRACT NO. 64N63				
ILLINOIS FED. AID PROJECT				

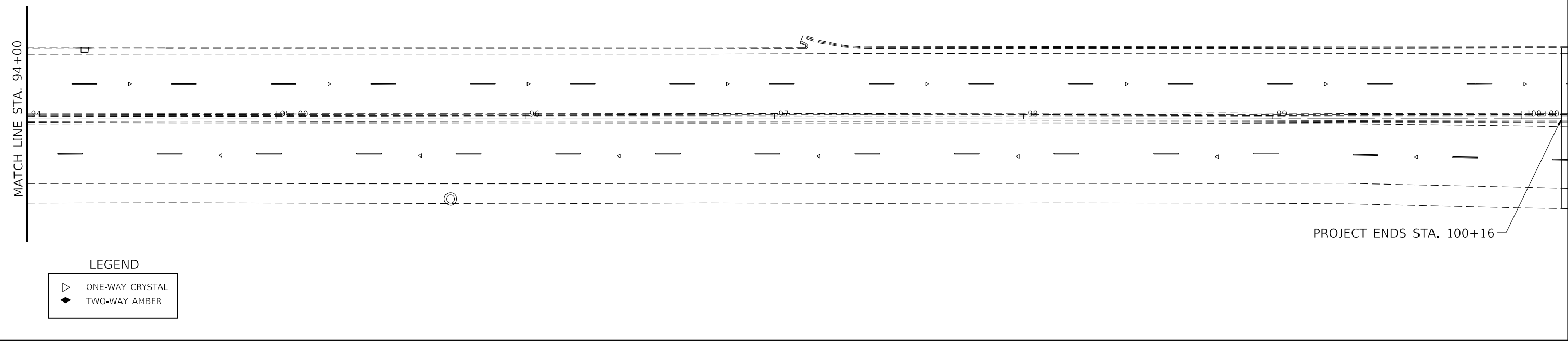
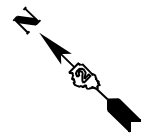

LEGEND

	ONE-WAY CRYSTAL
	TWO-WAY AMBER

MODEL: Default  
 FILE NAME: p:\pub\mroom.dwt\illinois.gov\PWIDOT\Documents\IDOT\_Offices\District 2\Projects\616\63\Program\_Development\Studies & Plans\Design\CADD\CADDsheet\02\_64N63-pavement-marking.dwg

USER NAME = cushmarbw	DESIGNED -	REVISED -
PLOT SCALE 1"=20'	DRAWN -	REVISED -
PLOT DATE = Jun-25-2021 06:44:32 AM	CHECKED -	REVISED -
	DATE -	REVISED -

**STATE OF ILLINOIS**  
**DEPARTMENT OF TRANSPORTATION**

**SIGNING & PAVEMENT MARKING**  
 SCALE: 1"=20'    SHEET 5 OF 6 SHEETS    STA. 94+00 TO STA. 106+00

F.A.P. RTE.	SECTION	COUNTY	TOTAL SHEETS	SHEET NO.
301	43RS	JO DAVIESS	33	20
CONTRACT NO. 64N63				
ILLINOIS FED. AID PROJECT				

# CATCH BASIN OR INLETS TO BE ADJUSTED OR RECONSTRUCTED (DETAILS FOR CURB & GUTTER REPLACEMENT)

CONCRETE CURB AND GUTTER SHALL BE CONSTRUCTED IN ACCORDANCE WITH SECTION 606 OF THE STANDARD SPECIFICATIONS, SUPPLEMENTAL SPECIFICATIONS, STANDARD 606001 AND THIS DRAWING.

CLASS SI CONCRETE SHALL BE USED THROUGHOUT. A HOLE 1-1/2 IN DIAMETER AND 9 DEEP SHALL BE DRILLED IN THE EXISTING CONCRETE CURB AS SHOWN. A 1-1/4 X 18 SMOOTH DOWEL BAR SHALL BE GROUTED IN THE HOLE LONGITUDINALLY.

JOINTS OF A TYPE SIMILAR TO THAT IN THE UNDERLYING PAVEMENT (EXPANSION OR CONTRACTION) SHALL BE INSTALLED IN THE CONCRETE CURB IN ALIGNMENT WITH THE JOINTS IN THE PAVEMENT.

THE PROPOSED CONFIGURATION OF THE CURB AND GUTTER SHALL MATCH THAT REMOVED.

THE LOCATION OF THE DOWEL BAR SHALL BE DETERMINED BY THE ENGINEER.

ALL EXISTING TIE BARS IN EDGE OF PAVEMENT SLAB THRU REPLACEMENT AREA SHALL BE CUT OFF.

THE WORK SHALL BE DONE IN ACCORDANCE WITH SECTION 602 OF THE STANDARD SPECIFICATIONS AND INCLUDES THE REMOVAL AND REPLACEMENT OF SOD, CONCRETE PAVEMENT AND/OR CURB AND GUTTER ADJACENT TO CATCH BASINS OR INLETS TO BE ADJUSTED OR RECONSTRUCTED AND SHALL BE INCLUDED IN THE PAY ITEM OF CATCH BASINS OR INLETS TO BE ADJUSTED OR RECONSTRUCTED AS SPECIFIED.

REVISED - 9-30-11

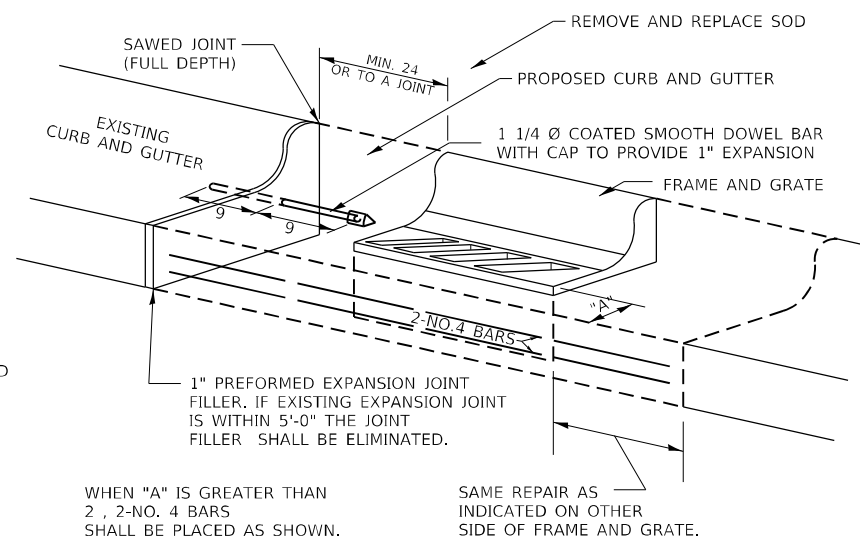

ALL DIMENSIONS ARE IN INCHES UNLESS OTHERWISE NOTED.

## CATCH BASIN OR INLETS TO BE ADJUSTED OR RECONSTRUCTED 17.4

FILE NAME: p:\work\projects\161463\program Development\Studies & Plans\Design\CADD\CADDsheets\02\_64N63-s1-detail.dwg  
PLOT DATE: 10/22/2021 09:42:22 AM

REVISED -	<b>REGION 2 / DISTRICT 2 STANDARD</b>	F.A.P. RTE.	SECTION	COUNTY	TOTAL SHEETS	SHEET NO.
REVISED -		301	43R5	JO DAVIESS	33	21
REVISED -		CONTRACT NO. 64N63				
REVISED -		SCALE: 100,0000 ' / 1" SHEET	OF	SHEETS	STA.	TO STA.

# WORK ZONE SIGN DETAILS

**ILLINOIS STANDARD G20-I100**

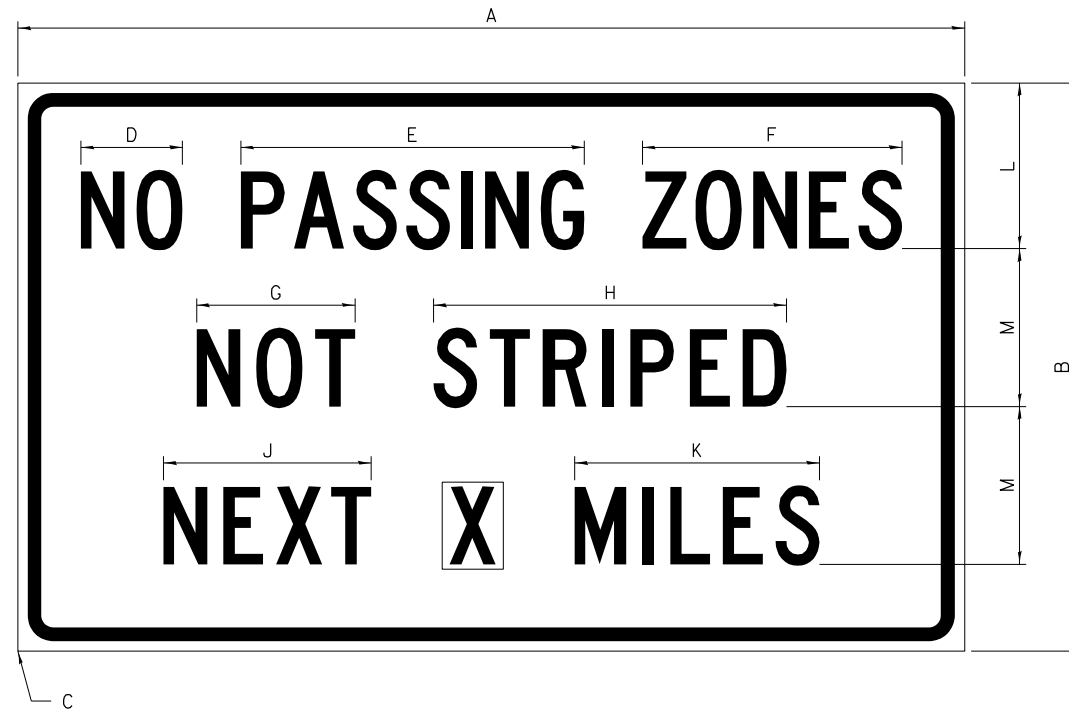

COLOR LEGEND AND BORDER BACKGROUND BLACK ORANGE NON-REFLECTORIZED REFLECTORIZED

SIGN SIZE	DIMENSIONS											
	A	B	C	D	E	F	G	H	J	K	L	M
60 x 36	60.00	36.00	2.25	6.4	21.80	16.40	10.00	22.40	13.20	15.50	10.50	10.00

SIGN SIZE	SERIES BY LINE			MARGIN	BORDER
	1	2	3		
60 x 36	5C	5C	5C	0.625	0.875

Sign not to scale

**ILLINOIS STANDARD W8-I107**

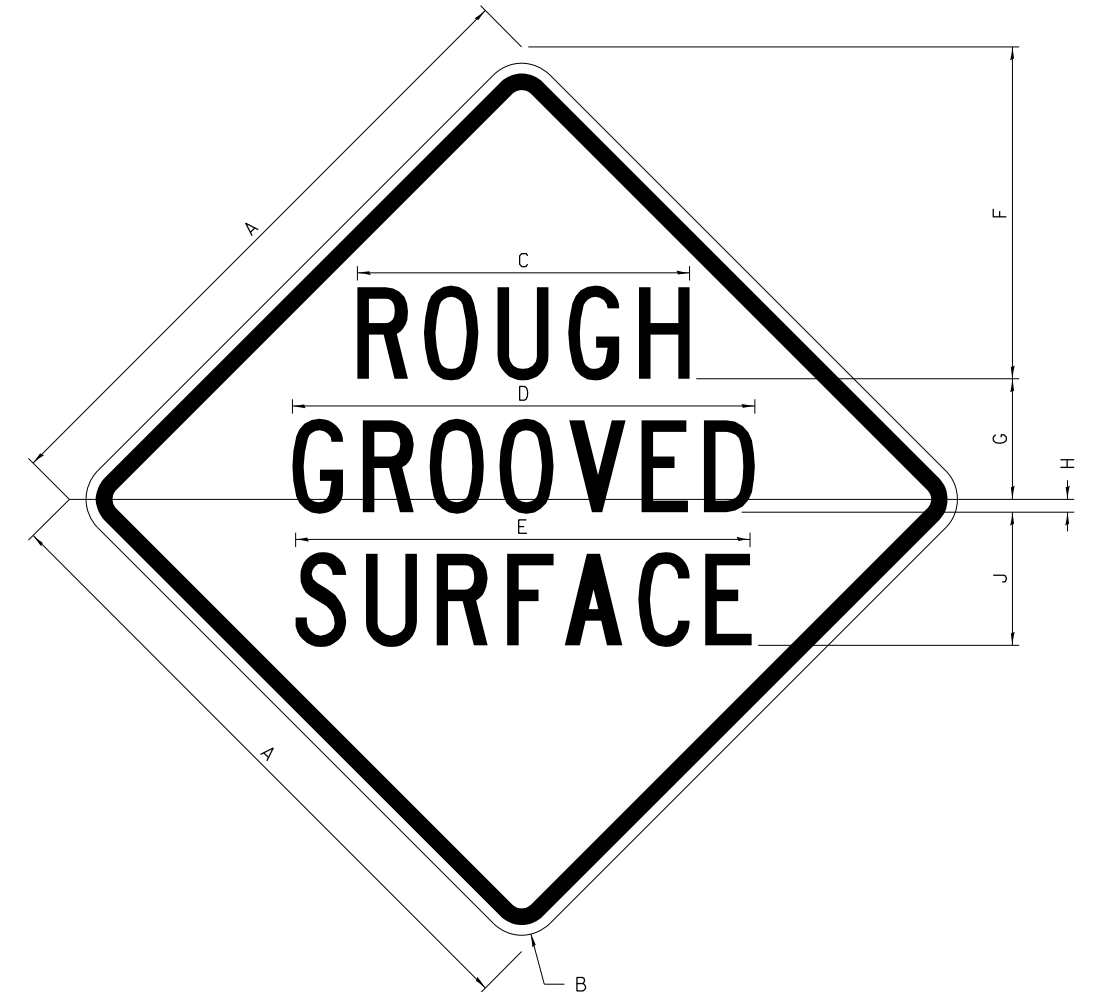

COLOR LEGEND AND BORDER BACKGROUND BLACK ORANGE NON-REFLECTORIZED REFLECTORIZED

SIGN SIZE	DIMENSIONS								
	A	B	C	D	E	F	G	H	J
48 x 48	48.00	3.00	25.00	34.80	34.20	24.94	9.00	1.00	10.00

SIGN SIZE	SERIES BY LINE			MARGIN	BORDER
	1	2	3		
48 x 48	7C	7C	7C	1.250	0.750

Sign not to scale

**GENERAL NOTES**

All work to furnish and install these signs shall be included in the cost of the specified traffic control standards and shall not be paid separately.

All Illinois Standard signs shall conform to the latest edition of the "Illinois Standard Highway Signs Book" in effect on the date of invitation for bids.

Signs shall meet the applicable portions of Sections 701 and 720 of the Standard Specifications.

All dimensions are in inches unless otherwise noted.

FILE NAME =	USER NAME = cushmenbw	DESIGNED -	REVISED - 3-02-16
pw:\planroom.dot.illinois.gov\PIDOT\Documents\IDOT Offices\District 2\Projects\64N63\DRAWN Development\Studies & Plans\Design\Revised\02.64N63-sht-details.dgn		CHECKED -	REVISED -
		DATE -	REVISED -

**STATE OF ILLINOIS  
DEPARTMENT OF TRANSPORTATION**

**REGION 2 / DISTRICT 2 STANDARD**

SCALE: SHEET NO. OF SHEETS STA. TO STA.

F.A.P. RTE.	SECTION	COUNTY	TOTAL SHEETS	SHEET NO.
301	43RS	JO DAVIESS	33	22
CONTRACT NO. 64N63				
FED. ROAD DIST. NO. ILLINOIS FED. AID PROJECT				

# WORK ZONE SIGN DETAILS

## ILLINOIS STANDARD W12-I102

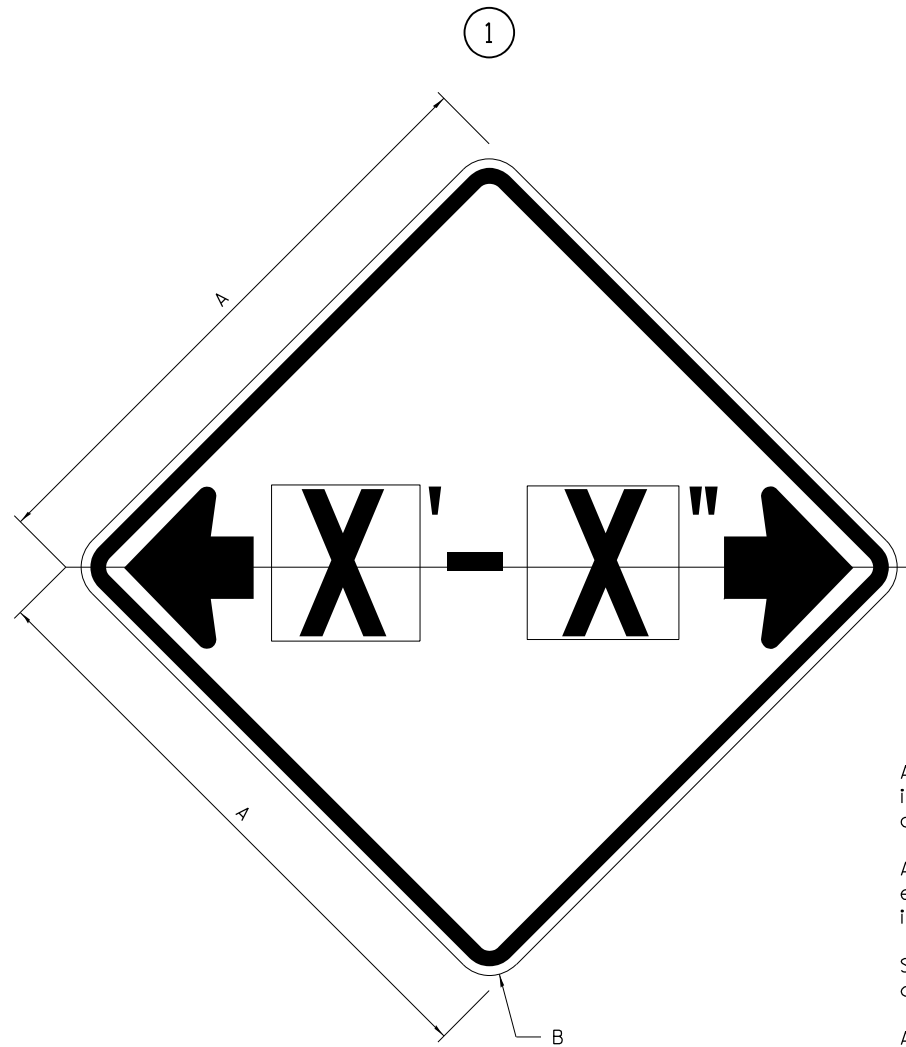

## ILLINOIS STANDARD W12-I103

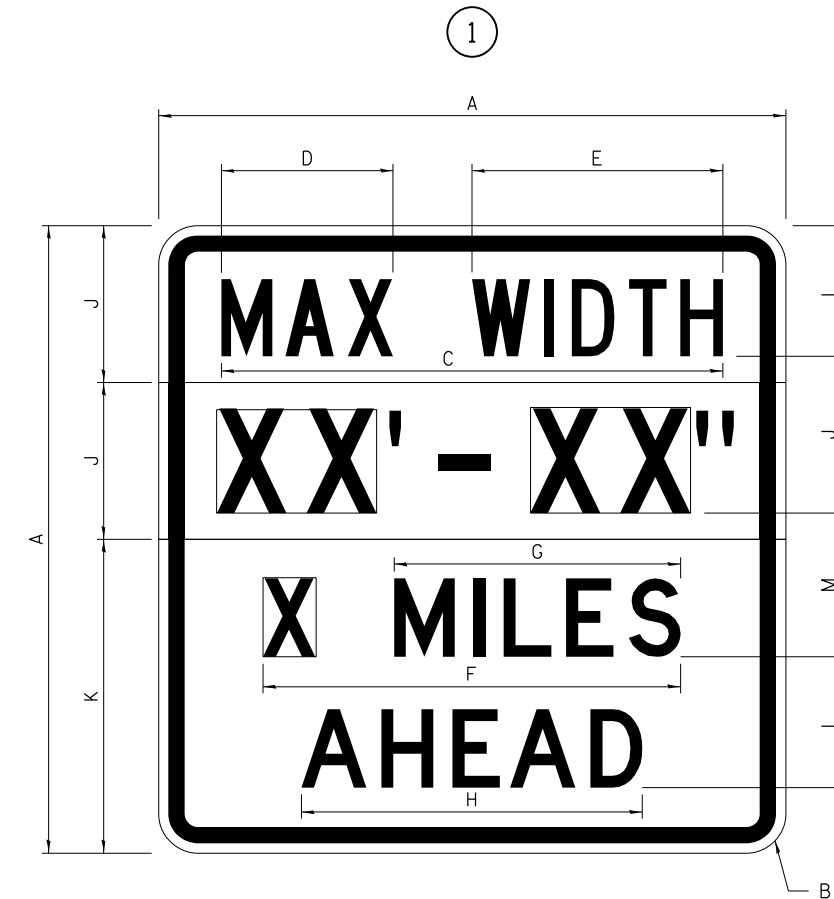

### GENERAL NOTES

All work to furnish and install these signs shall be included in the cost of the specified traffic control standards and shall not be paid separately.

All Illinois Standard signs shall conform to the latest edition of the "Illinois Standard Highway Signs Book" in effect on the date of invitation for bids.

Signs shall meet the applicable portions of Sections 701 and 720 of the Standard Specifications.

All dimensions are in inches unless otherwise noted.

COLOR LEGEND AND BORDER BACKGROUND BLACK FL ORANGE NON-REFLECTORIZED REFLECTORIZED

SIGN SIZE	DIMENSIONS	
	A	B
48 x 48	48.00	3.00

① Illinois Standard signs W12-I102 and W12-I103 shall be used as described in the special provisions.

SIGN SIZE	SERIES BY LINE	MARGIN	BORDER
	1		
48 x 48	12C	0.750	1.250

Sign not to scale

COLOR LEGEND AND BORDER BACKGROUND (WIDTH) BLACK WHITE FL ORANGE NON-REFLECTORIZED REFLECTORIZED REFLECTORIZED

SIGN SIZE	DIMENSIONS											
	A	B	C	D	E	F	G	H	J	K	L	M
48 x 48	48.00	3.00	38.40	13.20	19.20	32.00	22.00	26.20	12.00	24.00	10.00	11.00

SIGN SIZE	SERIES BY LINE				MARGIN	BORDER
	1	2	3	4		
48 x 48	6C	8D	6D	6D	0.750	1.250

Sign not to scale

XX'-XX" WIDTH AND X MILES ARE VARIABLE TOP AND BOTTOM OF BACKGROUND WHITE

FILE NAME =	USER NAME = cushmenbw	DESIGNED -	REVISED - 3-02-16
pw:\planroom.dot.illinois.gov\PIDOT\Documents\IDOT Offices\District 2\Projects\64N63\DRAWN Development\Studies & Plans\Design\64N63-shd-details.dgn		CHECKED -	REVISED -
		DATE -	REVISED -

STATE OF ILLINOIS  
DEPARTMENT OF TRANSPORTATION

REGION 2 / DISTRICT 2 STANDARD

SCALE: SHEET NO. OF SHEETS STA. TO STA.

F.A.P. RTE.	SECTION	COUNTY	TOTAL SHEETS	SHEET NO.
301	43RS	JO DAVIESS	33	23
CONTRACT NO. 64N63				
FED. ROAD DIST. NO. ILLINOIS FED. AID PROJECT				

# WORK ZONE SIGN DETAILS

## ROAD CLOSED TO OVERSIZED LOADS

## STOP LINE SIGN FOR TEMPORARY SIGNALS

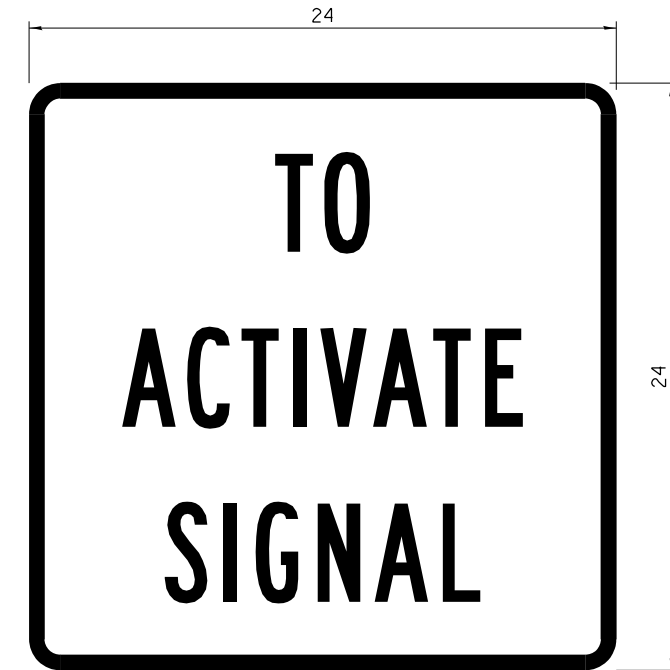
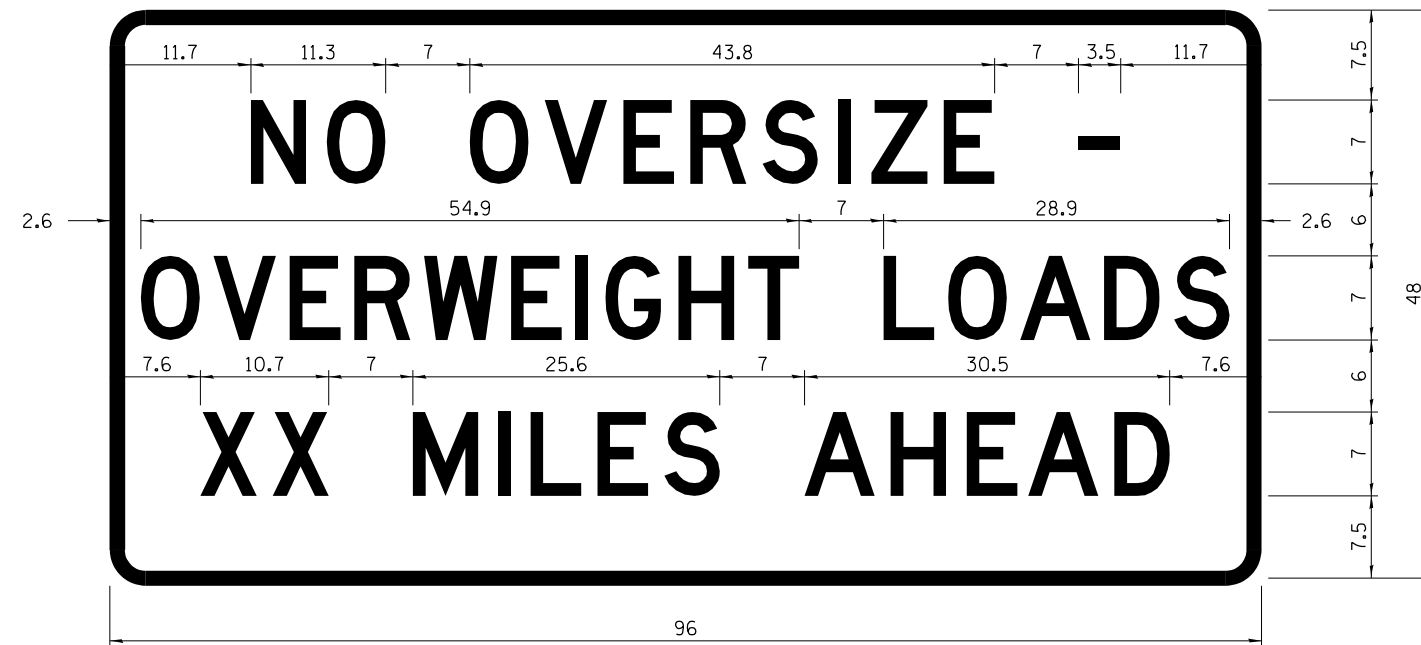

COLOR LEGEND AND BORDER BACKGROUND BLACK ORANGE NON-REFLECTORIZED REFLECTORIZED

COLOR LEGEND AND BORDER BACKGROUND BLACK WHITE NON-REFLECTORIZED REFLECTORIZED

Permit Loads - Loads Over 13 Feet; 3.0" Radius, 1.3" Border; [NO OVERSIZE -] D; [OVERWEIGHT LOADS] D 85% spacing; [XX MILES AHEAD] D; Table of letter and object lefts.

SIGN SIZE	SERIES BY LINE		
	1	2	3
24 x 24	4C	4C	4C

Sign not to scale

N	O	O	V	E	R	S	I	Z	E	-
11.7	18.1	30.0	36.2	42.8	48.4	54.4	60.7	63.5	69.5	80.8

O	V	E	R	W	E	I	G	H	T	L	O	A	D	S
2.6	8.6	15.0	20.4	26.2	33.4	38.8	41.3	47.4	53.2	64.5	69.9	75.9	82.9	88.7

X	X	M	I	L	E	S	A	H	E	A	D
7.6	13.6	25.3	32.3	35.1	40.6	46.2	57.9	65.1	71.4	76.6	83.7

Sign not to scale

### GENERAL NOTES

All work to furnish and install these signs shall be included in the cost of the specified traffic control standards and shall not be paid separately.

All Illinois Standard signs shall conform to the latest edition of the "Illinois Standard Highway Signs Book" in effect on the date of invitation for bids.

Signs shall meet the applicable portions of Sections 701 and 720 of the Standard Specifications.

All dimensions are in inches unless otherwise noted.

FILE NAME =	USER NAME = cushmenbw	DESIGNED -	REVISED - 3-02-16	STATE OF ILLINOIS DEPARTMENT OF TRANSPORTATION	REGION 2 / DISTRICT 2 STANDARD	F.A.P. RTE.	SECTION	COUNTY	TOTAL SHEETS	SHEET NO.
pw:\planroom.dot.illinois.gov\PIDOT\Documents\IDOT Offices\District 2\Projects\64N63\Drawn Development\Studies & Plans\Design Sheets\02.64N63-sht-details.dgn	DRAWN	CHECKED -	REVISED -			301	43RS	JO DAVIESS	33	24
PLOT SCALE = 100.0000' / in.	DATE -	REVISED -	REVISED -			CONTRACT NO. 64N63				
PLOT DATE = Jun-25-2021 06:49:08 AM	DATE -	REVISED -	REVISED -	SCALE:	SHEET NO. OF SHEETS STA. TO STA.	FED. ROAD DIST. NO.	ILLINOIS FED. AID PROJECT			



**ENTRANCE SIGN FOR USE  
WITH TEMPORARY SIGNALS**

**WORK ZONE SIGN DETAILS**

②

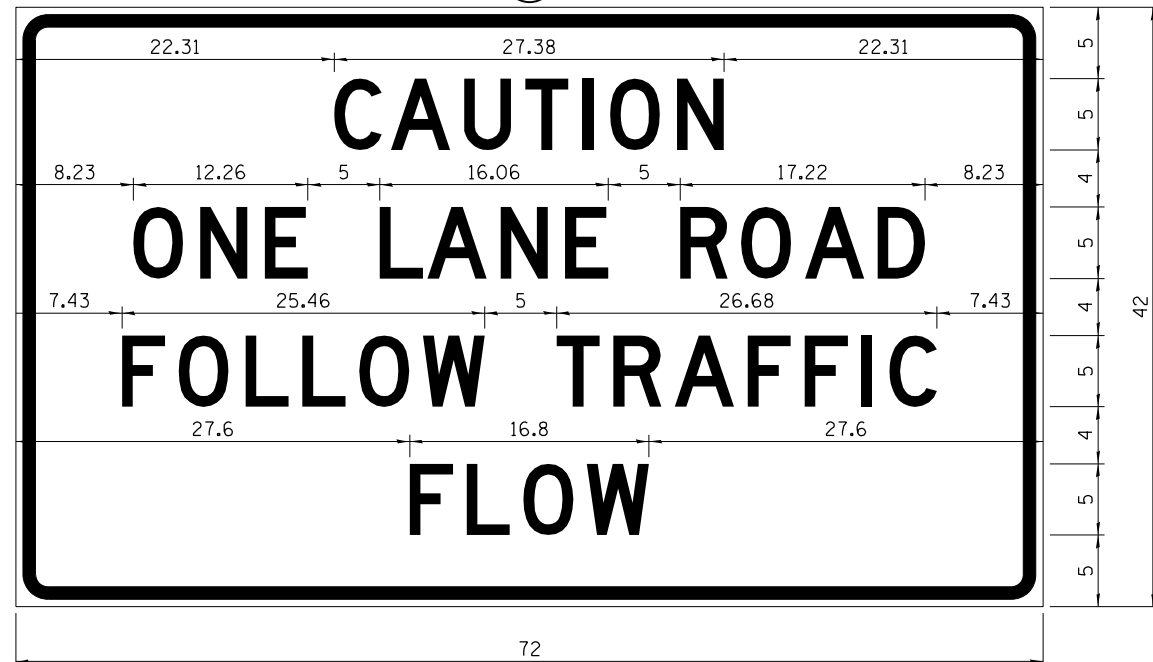

COLOR LEGEND AND BORDER BACKGROUND BLACK ORANGE NON-REFLECTORIZED REFLECTORIZED

2.25" Radius, 0.88" Border, 0.50" Indent;  
[CAUTION] D; [ONE LANE ROAD] D;  
[FOLLOW TRAFFIC] D; [FLOW] D

② This sign shall be installed at entrances located between the temporary signals as shown in the staging plans.

**Table Of Widths And Spaces**

22.31	C	A	U	T	I	O	N	22.31						
3.36	3.36	0.62	4.18	0.94	3.36	0.94	3.04	0.94	0.78	1.17	3.52	1.17	3.36	22.31

8.23	O	N	E	
3.51	1.17	3.36	1.18	3.04

5.00	L	A	N	E		
3.05	0.31	4.18	0.94	3.36	1.17	3.05

5.00	R	O	A	D	8.23		
3.36	0.93	3.52	0.94	4.18	0.93	3.36	8.23

7.43	F	O	L	L	O	W				
3.04	0.94	3.52	1.17	3.04	0.94	3.05	0.94	3.51	0.94	4.37

5.00	T	R	A	F	F	I	C	7.43					
3.05	0.94	3.36	0.94	4.18	0.93	3.05	0.94	3.04	0.94	0.78	1.18	3.35	7.43

27.60	F	L	O	W	27.60		
3.05	0.94	3.04	0.94	3.52	0.93	4.38	27.60

Sign not to scale

**STAY IN YOUR LANE**

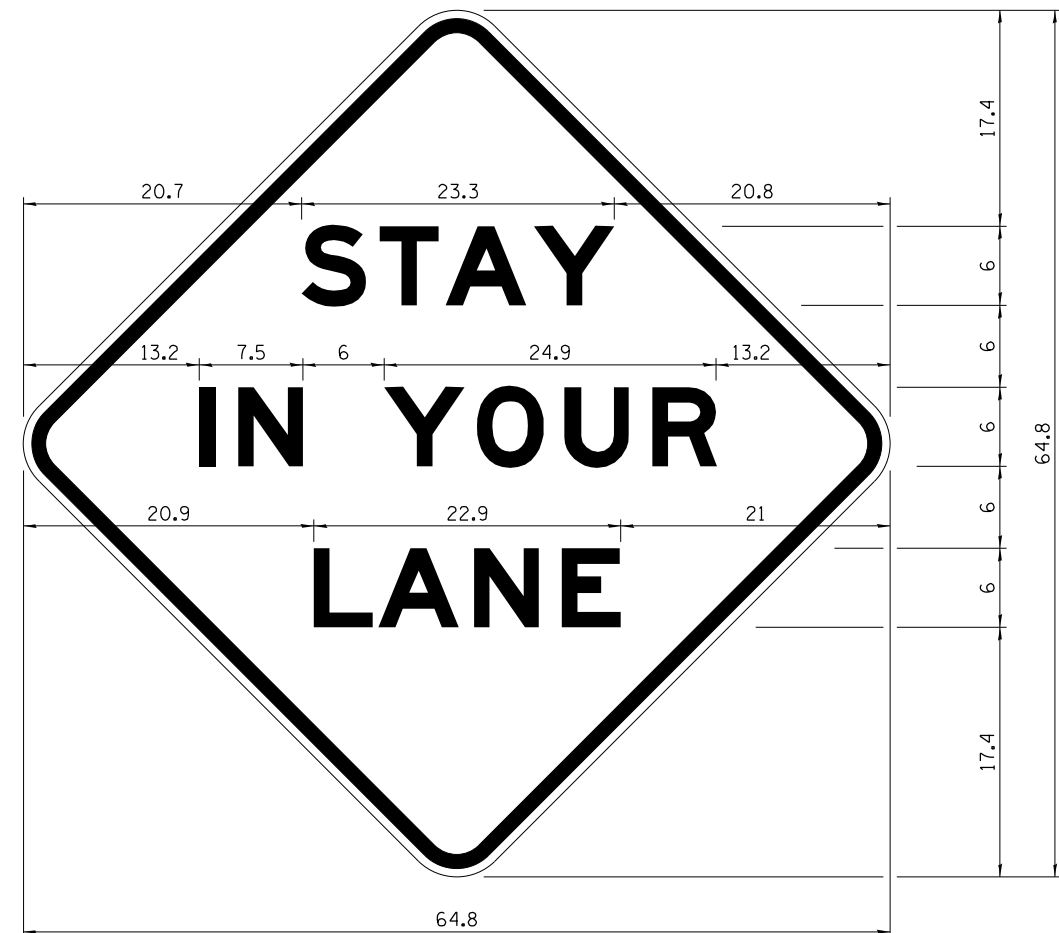

COLOR LEGEND AND BORDER BACKGROUND BLACK ORANGE NON-REFLECTORIZED REFLECTORIZED

48.0" across sides 3.8" Radius, 1.0" Border, 0.6" Indent;  
"STAY" E Mod; "IN YOUR" E Mod; "LANE" E Mod;

**Table of Letter and Object Lefts**

S	T	A	Y
20.7	26.8	31.6	38.0

I	N	Y	O	U	R
13.2	15.9	26.7	33.9	40.5	46.8

L	A	N	E
20.9	25.8	33.1	39.4

Sign not to scale

**GENERAL NOTES**

All work to furnish and install these signs shall be included in the cost of the specified traffic control standards and shall not be paid separately.

All Illinois Standard signs shall conform to the latest edition of the "Illinois Standard Highway Signs Book" in effect on the date of invitation for bids.

Signs shall meet the applicable portions of Sections 701 and 720 of the Standard Specifications.

All dimensions are in inches unless otherwise noted.

FILE NAME =	USER NAME = cushmenbw	DESIGNED -	REVISED - 3-02-16
pw:\planroom.dot\illinois.gov\PIDOT\Documents\IDOT Offices\District 2\Projects\64N63\DRAWN Development\Studies & Plans\Design\ASheets\02.64N63-sht-details.dgn		CHECKED -	REVISED -
		DATE -	REVISED -

**STATE OF ILLINOIS  
DEPARTMENT OF TRANSPORTATION**

**REGION 2 / DISTRICT 2 STANDARD**

SCALE: SHEET NO. OF SHEETS STA. TO STA.

F.A.P. RTE.	SECTION	COUNTY	TOTAL SHEETS	SHEET NO.
301	43RS	JO DAVIESS	33	25
CONTRACT NO. 64N63				
FED. ROAD DIST. NO. ILLINOIS FED. AID PROJECT				

# TRAFFIC CONTROL FOR TRANSITION AREAS

## CASE 1

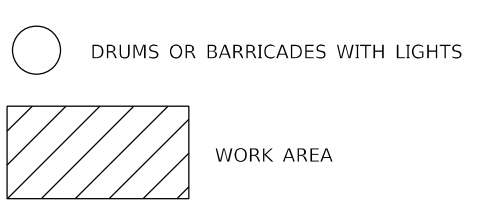
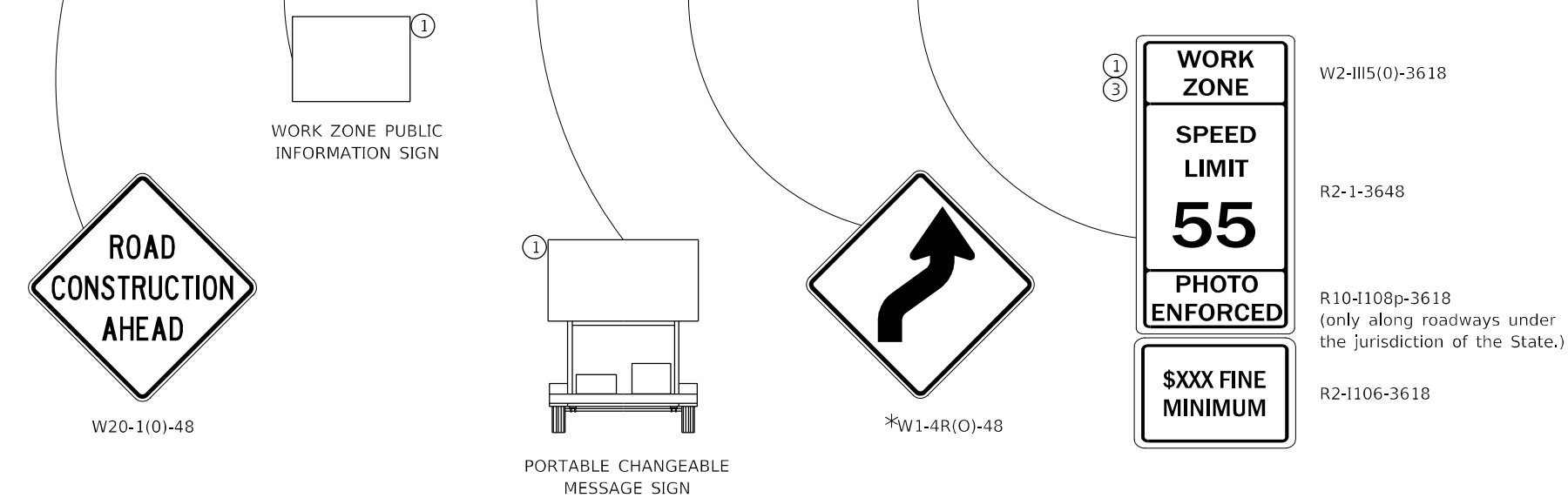
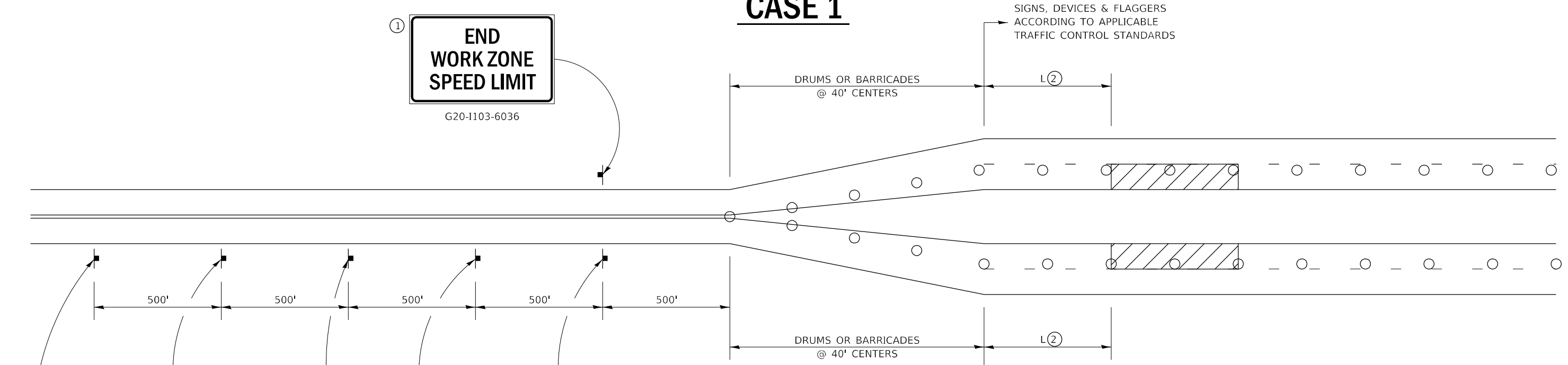

NOTE: STANDARDS 701301 AND 701306 SHALL NOT BE USED WITHIN 500 FEET OF THE TRANSITION.

\*DEPENDS ON GEOMETRICS OF THE TRANSITION. MAY SWITCH THE "STAY IN YOUR LANE" AND "WEAVE SIGNS"

**GENERAL NOTES**  
THIS DETAIL IS TO BE USED IN CONJUNCTION WITH THE APPLICABLE MULTILANE TRAFFIC CONTROL AND PROTECTION STANDARD.

1. If applicable, Use if shown on applicable multilane Traffic Control and Protection Standard being used.
2. If the work is within 2500 feet of the transition when the speed is > 40 mph, or 1500 feet for all other speeds, the detail shall be used.
3. WORK ZONE SPEED LIMIT 55 SIGN ASSEMBLY shall be replaced with WORK ZONE SPEED LIMIT 45 SIGN ASSEMBLY where the workers are within 500 feet of the transition.

THIS TRAFFIC CONTROL DETAIL SHALL BE INCLUDED IN THE COST OF SPECIFIED TRAFFIC CONTROL STANDARDS OR ITEMS.

FILE NAME: pwc\planroom\dot\illinois.gov\PWIDOT	USER NAME = cushmanbw	DESIGNED -	REVISED - 4-20-17	STATE OF ILLINOIS DEPARTMENT OF TRANSPORTATION	REGION 2 / DISTRICT 2 STANDARD	F.A.P. RTE.	SECTION	COUNTY	TOTAL SHEETS	SHEET NO.
	Documents\DOT Offices\District 2\Projects\64N63\Program Development\Studies & Plans\Design\CADD\CAD	CHECKED -	REVISED - 8-27-13			301	43RS	JO DAVIESS	33	26
	PLOT SCALE = 100,000' / in.	DATE -	REVISED - 1-16-13			CONTRACT NO. 64N63				
	PLOT DATE = Jun-25-2021 06:49:40 AM			SCALE:	SHEET 1 OF 4 SHEETS	STA.	TO STA.	ILLINOIS FED. AID PROJECT		

# TRAFFIC CONTROL FOR TRANSITION AREAS

## CASE 2

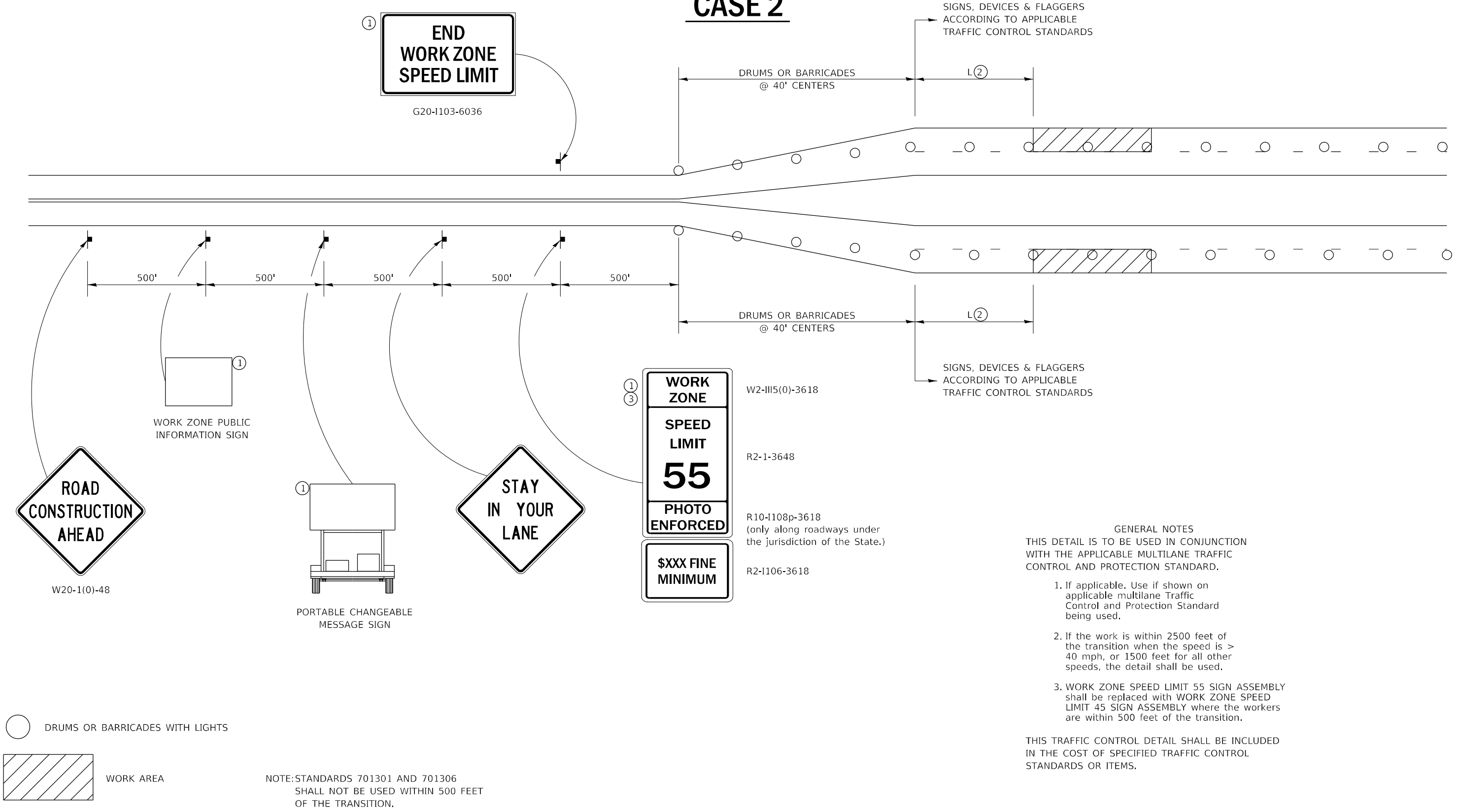

**GENERAL NOTES**  
 THIS DETAIL IS TO BE USED IN CONJUNCTION WITH THE APPLICABLE MULTILANE TRAFFIC CONTROL AND PROTECTION STANDARD.

1. If applicable, Use if shown on applicable multilane Traffic Control and Protection Standard being used.
2. If the work is within 2500 feet of the transition when the speed is > 40 mph, or 1500 feet for all other speeds, the detail shall be used.
3. WORK ZONE SPEED LIMIT 55 SIGN ASSEMBLY shall be replaced with WORK ZONE SPEED LIMIT 45 SIGN ASSEMBLY where the workers are within 500 feet of the transition.

THIS TRAFFIC CONTROL DETAIL SHALL BE INCLUDED IN THE COST OF SPECIFIED TRAFFIC CONTROL STANDARDS OR ITEMS.

FILE NAME: pwc\planroom\dot\illinois.gov\PWIDOT Documents\DOT Offices\District 2\Projects\64N63\Program Development\Studies & Plans\Design\CADD\CAD\64N63-shr-del-110916	USER NAME = cushmanbw	DESIGNED -	REVISED - 4-20-17	STATE OF ILLINOIS DEPARTMENT OF TRANSPORTATION	REGION 2 / DISTRICT 2 STANDARD	F.A.P. RTE.	SECTION	COUNTY	TOTAL SHEETS	SHEET NO.
	PLOT SCALE = 100,0000' / in.	CHECKED -	REVISED - 8-27-13			301	43RS	JO DAVIESS	33	27
PLOT DATE = Jun-25-2021 06:49:55 AM	DATE -	REVISED - 1-16-13		SCALE:	SHEET 2 OF 4 SHEETS	STA.	TO STA.	ILLINOIS FED. AID PROJECT CONTRACT NO. 64N63		

# TRAFFIC CONTROL FOR TRANSITION AREAS

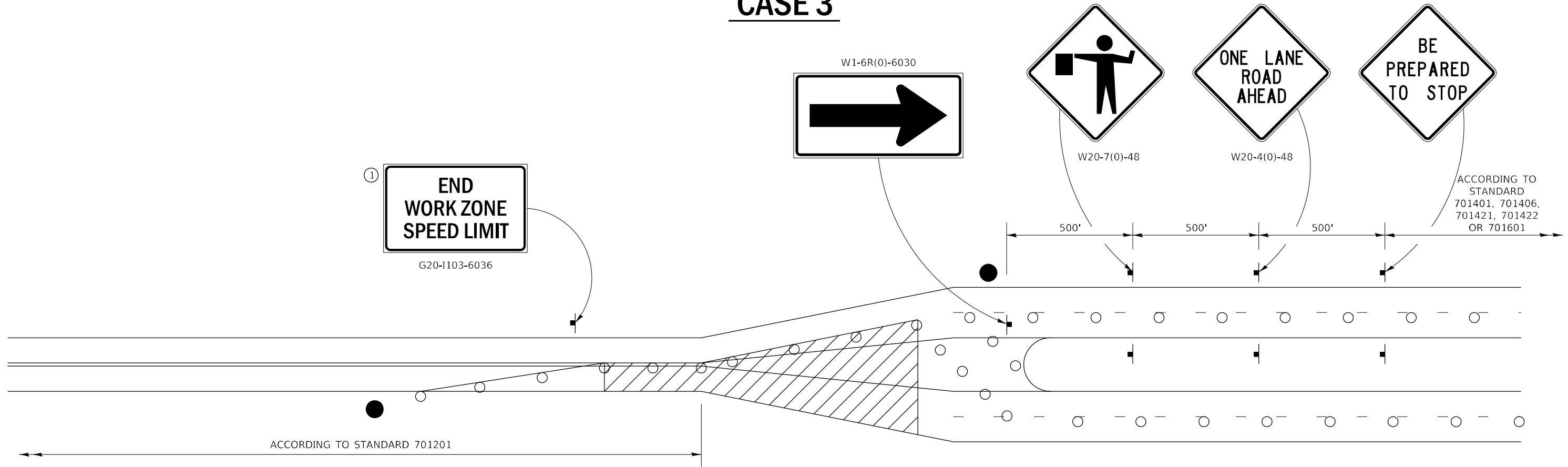

## CASE 3



GENERAL NOTES  
 THIS DETAIL IS TO BE USED IN CONJUNCTION WITH THE APPLICABLE MULTILANE TRAFFIC CONTROL AND PROTECTION STANDARD.

1. If applicable. Use if shown on applicable multilane Traffic Control and Protection Standard being used.
2. If the work is within 2500 feet of the transition when the speed is > 40 mph, or 1500 feet for all other speeds, the detail shall be used.
3. WORK ZONE SPEED LIMIT 55 SIGN ASSEMBLY shall be replaced with WORK ZONE SPEED LIMIT 45 SIGN ASSEMBLY where the workers are within 500 feet of the transition.

THIS TRAFFIC CONTROL DETAIL SHALL BE INCLUDED IN THE COST OF SPECIFIED TRAFFIC CONTROL STANDARDS OR ITEMS.

-  FLAGGER WITH TRAFFIC CONTROL SIGN
-  DRUMS OR BARRICADES WITH LIGHTS
-  WORK AREA

NOTE: STANDARDS 701301 AND 701306 SHALL NOT BE USED WITHIN 500 FEET OF THE TRANSITION.

FILE NAME: p:\planroom\dot\illinois.gov\PWIDOT\Documents\DOT Offices\District 2\Projects\64N63\Program\Drawings\Studies & Plans\Design\CADD\CAD\64N63-std-del-189-16	USER NAME = cushmanbw	DESIGNED -	REVISED - 4-20-17	<b>STATE OF ILLINOIS DEPARTMENT OF TRANSPORTATION</b>	<b>REGION 2 / DISTRICT 2 STANDARD</b>		F.A.P. RTE.	SECTION	COUNTY	TOTAL SHEETS	SHEET NO.
	PLOT SCALE = 100,0000' / in.	CHECKED -	REVISED - 8-27-13				301	43RS	JO DAVIESS	33	28
PLOT DATE = Jun-25-2021 06:50:11 AM	DATE -	REVISED - 3-05-12		SCALE:	SHEET 3 OF 4 SHEETS	STA. TO STA.	ILLINOIS FED. AID PROJECT CONTRACT NO. 64N63				

# TRAFFIC CONTROL FOR TRANSITION AREAS

## CASE 4

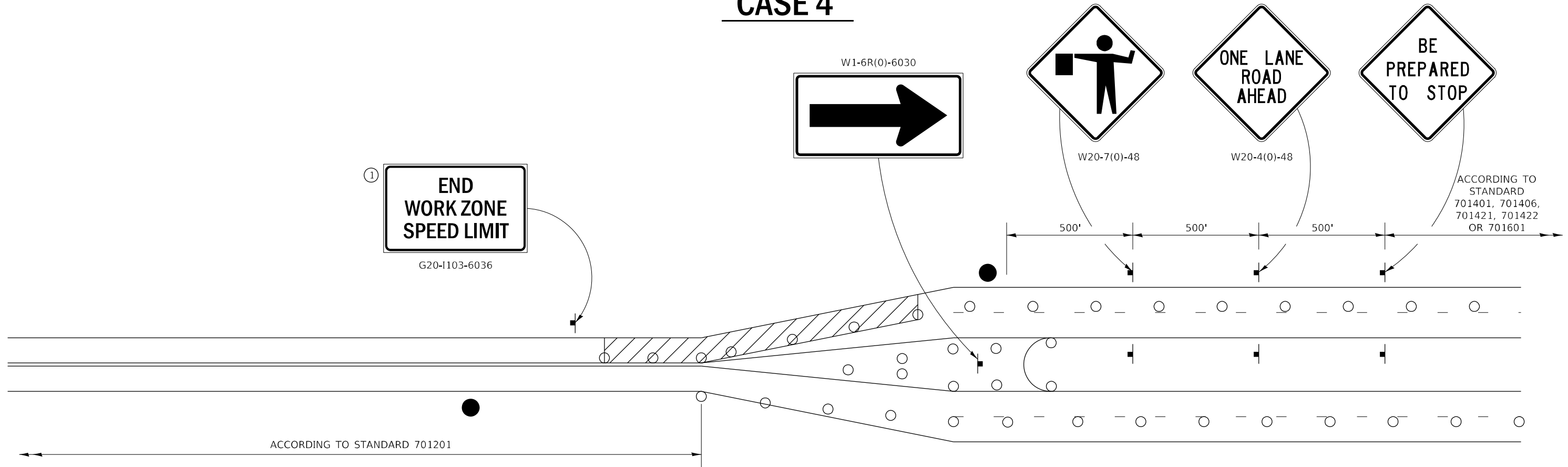

**GENERAL NOTES**  
 THIS DETAIL IS TO BE USED IN CONJUNCTION WITH THE APPLICABLE MULTILANE TRAFFIC CONTROL AND PROTECTION STANDARD.

1. If applicable. Use if shown on applicable multilane Traffic Control and Protection Standard being used.
2. If the work is within 2500 feet of the transition when the speed is > 40 mph, or 1500 feet for all other speeds, the detail shall be used.
3. WORK ZONE SPEED LIMIT 55 SIGN ASSEMBLY shall be replaced with WORK ZONE SPEED LIMIT 45 SIGN ASSEMBLY where the workers are within 500 feet of the transition.

THIS TRAFFIC CONTROL DETAIL SHALL BE INCLUDED IN THE COST OF SPECIFIED TRAFFIC CONTROL STANDARDS OR ITEMS.

- FLAGGER WITH TRAFFIC CONTROL SIGN
- DRUMS OR BARRICADES WITH LIGHTS
- WORK AREA

NOTE: STANDARDS 701301 AND 701306 SHALL NOT BE USED WITHIN 500 FEET OF THE TRANSITION.

FILE NAME: pwc\planroom\dot\illinois.gov\PWIDOT\Documents\DOT Offices\District 2\Projects\64N63\Program\Drawings\Studies & Plans\Design\CADD\CAD\64N63-std-del-18916	USER NAME = cushmanbw	DESIGNED -	REVISED - 4-20-17	<b>STATE OF ILLINOIS DEPARTMENT OF TRANSPORTATION</b>	<b>REGION 2 / DISTRICT 2 STANDARD</b>			F.A.P. RTE.	SECTION	COUNTY	TOTAL SHEETS	SHEET NO.
	PLOT SCALE = 100,0000' / in.	CHECKED -	REVISED - 8-27-13					301	43RS	JO DAVIESS	33	29
PLOT DATE = Jun-25-2021 06:50:27 AM	DATE -	REVISED - 3-05-12		SCALE:	SHEET 4	OF 4	SHEETS	STA.	TO STA.	ILLINOIS FED. AID PROJECT CONTRACT NO. 64N63		

# TRAFFIC CONTROL TYPICAL WEAVE

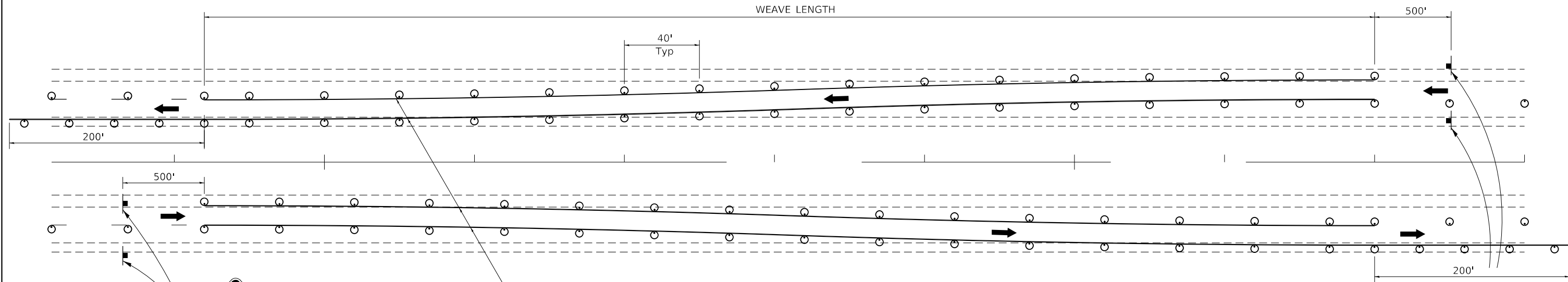

Temporary Pavement Marking required if Typical Weave is used for 14 days or more.

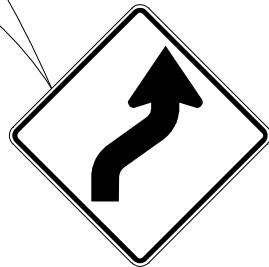

W1-4R(O)-48



W1-4L(O)-48

## SYMBOLS

○ DRUM WITH STEADY BURN MONO-DIRECTIONAL LIGHT

■ SIGN

## GENERAL NOTES:

USE ON LONG 4-LANE PROJECTS WHERE THE CONTRACTOR MAY CHANGE A PORTION OF THE WORK TO THE OPPOSITE LANE.

USE WHERE THE PROJECT IS ADJACENT TO ANOTHER AND THE CONTRACTOR COULD BE WORKING ON DIFFERENT LANES.

TEMPORARY PAVEMENT MARKING SHALL BE USED WHEN TYPICAL WEAVE IS USED FOR 14 DAYS OR MORE.

TRAFFIC CONTROL TYPICAL WEAVE SHALL BE INCLUDED IN THE COST OF THE SPECIFIC TRAFFIC CONTROL STANDARDS OF ITEMS.

## STANDARD WEAVE CONDITIONS FOR DIFFERENT SPEED LIMITS

POSTED SPEED LIMIT	WEAVE LENGTH
65 MPH OR HIGHER	780 FT.
55 MPH	660 FT.
45 MPH	540 FT.

ALL DIMENSIONS ARE IN INCHES UNLESS OTHERWISE NOTED.

USER NAME = cushmanbw	DESIGNED -	REVISED - 1-05-16
FILE NAME: pwc\planroom\dot\illinois.gov\PWIDOT\Documents\DOT Offices\District 2\Projects\64N63\Program\Drawings\Studies & Plans\Design\CADD\CAD\64N63\64N63.dwg	DRAWN -	REVISED - 6-27-14
PLOT SCALE = 100,0000' / in.	CHECKED -	REVISED - 8-27-13
PLOT DATE = Jun-25-2021 06:50:41 AM	DATE -	REVISED - 10-17-11

STATE OF ILLINOIS  
DEPARTMENT OF TRANSPORTATION

REGION 2 / DISTRICT 2 STANDARD

SCALE: SHEET OF SHEETS STA. TO STA.

F.A.P. RTE.	SECTION	COUNTY	TOTAL SHEETS	SHEET NO.
301	43RS	JO DAVIESS	33	30
CONTRACT NO. 64N63				
ILLINOIS FED. AID PROJECT				

# TYPICAL PAVEMENT MARKINGS

## TYPICAL PAVEMENT MARKING FOR FLUSH MEDIAN AT LEFT TURN LANE

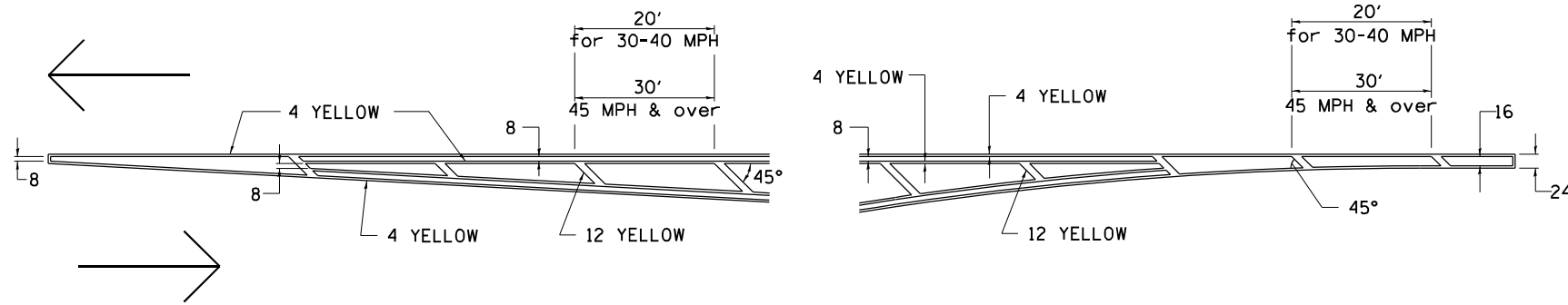

## MEDIAN PAVEMENT MARKING

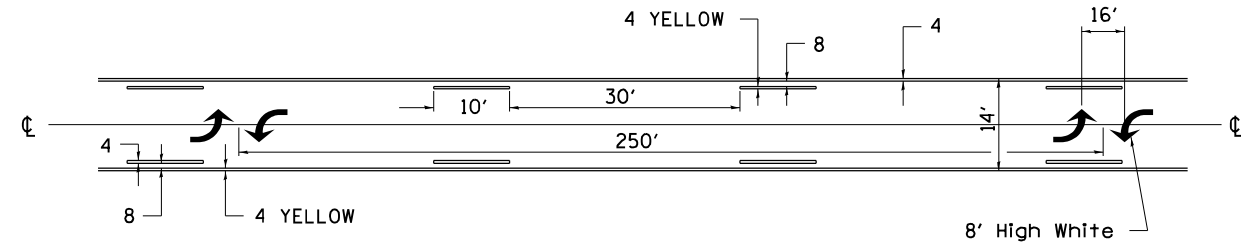

•• ALL DIMENSIONS ARE IN INCHES UNLESS OTHERWISE NOTED.

## TYPICAL ISLAND OFFSET SHOULDER WIDTH

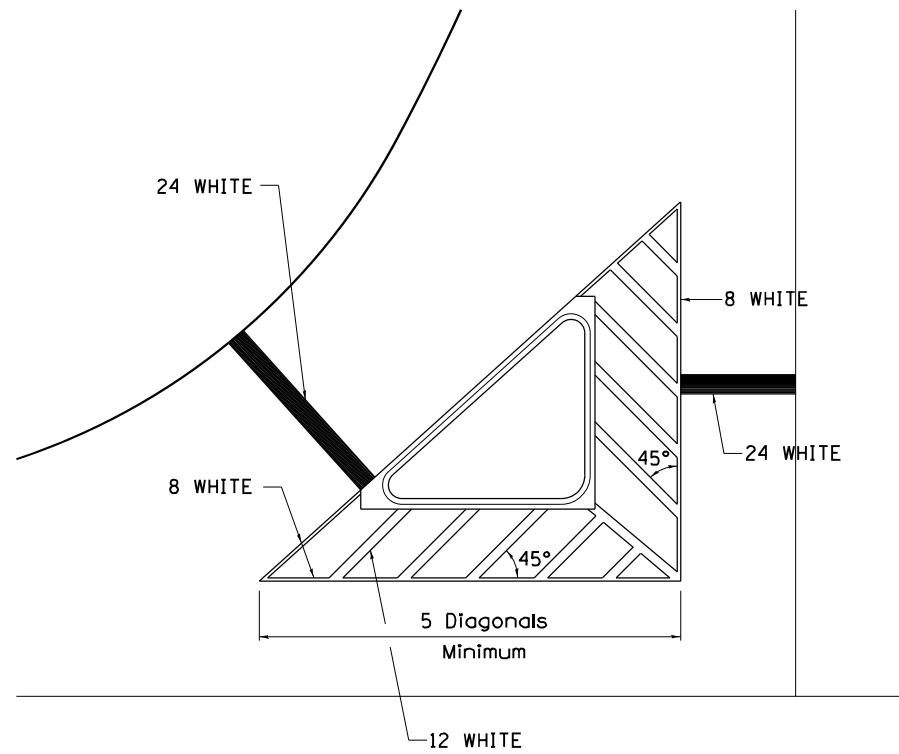

## TYPICAL MARKING FOR PAINTED ISLANDS

NOTE:  
\* 45° TO LOCAL TAN.

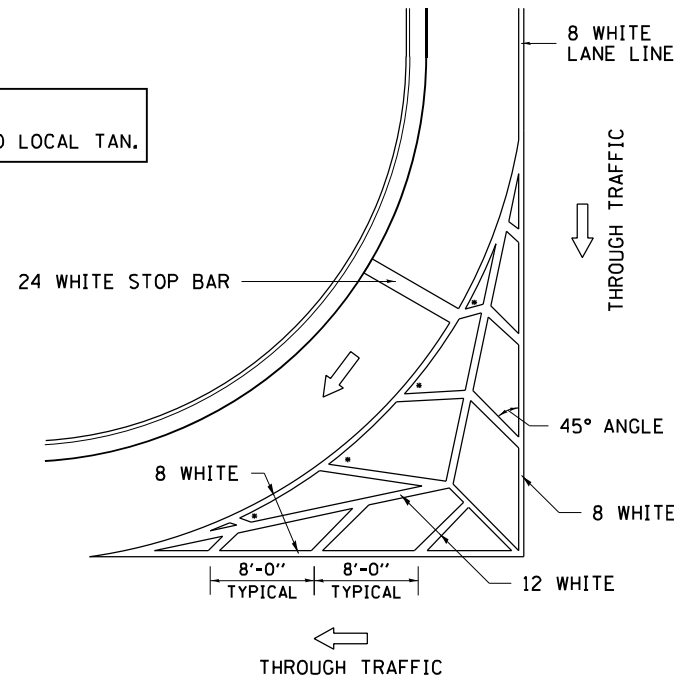

## STANDARD CROSSWALK MARKING

See Schedules for Locations

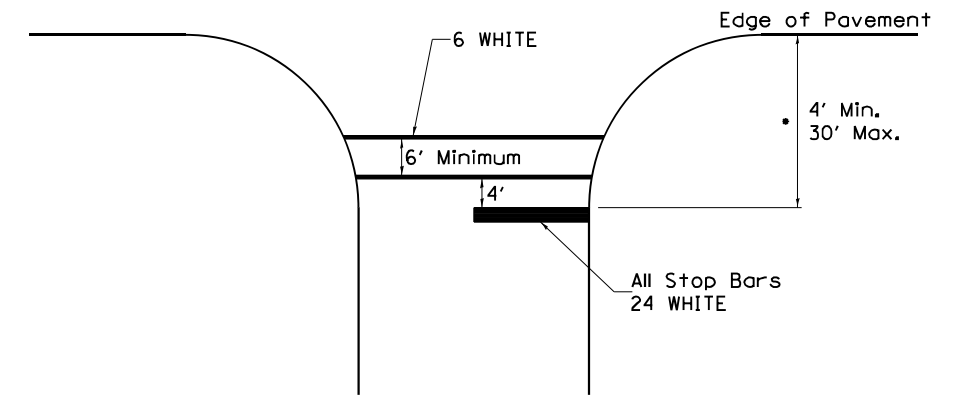

• Distance to the nearest edge of the intersecting roadway in the absence of a marked crosswalk.

FILE NAME =	USER NAME = cushmenbw	DESIGNED -	REVISED - 6-27-14
p:\planroom.dot\illinois.gov\PWIDOT\Documents\IDOT Offices\District 2\Projects\64N63\Drawn Development\Studies & Plans\Design\Revised\Asheets\301-113-sht-details.dgn		DRAWN	REVISED
PLOT SCALE = 100.0000' / in.	CHECKED -	REVISOR -	DATE -
PLOT DATE = Jun-25-2021 06:50:55 AM	DATE -	REVISOR -	DATE -

STATE OF ILLINOIS  
DEPARTMENT OF TRANSPORTATION

REGION 2 / DISTRICT 2 STANDARD

SCALE: SHEET NO. OF SHEETS STA. TO STA.

F.A.P. RTE.	SECTION	COUNTY	TOTAL SHEETS	SHEET NO.
301	43RS	JO DAVIESS	33	31
CONTRACT NO. 64N63				
FED. ROAD DIST. NO. ILLINOIS FED. AID PROJECT				

# TYPICAL PAVEMENT MARKINGS

## ARROW LAYOUT

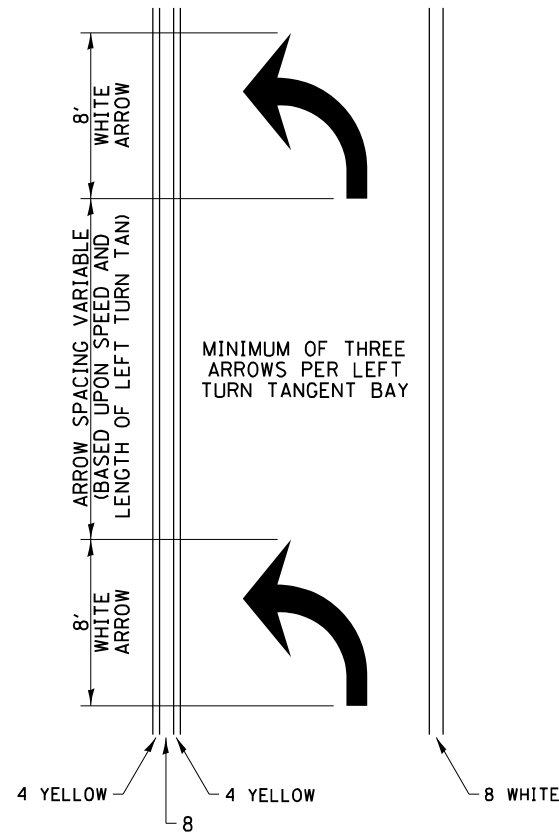

- ◀ ONE-WAY AMBER MARKER
- ◁ ONE-WAY CRYSTAL MARKER
- ◆ TWO-WAY AMBER MARKER

ALL DIMENSIONS ARE IN INCHES UNLESS OTHERWISE NOTED.

## TYPICAL PAVEMENT MARKING FOR FLUSH MEDIAN

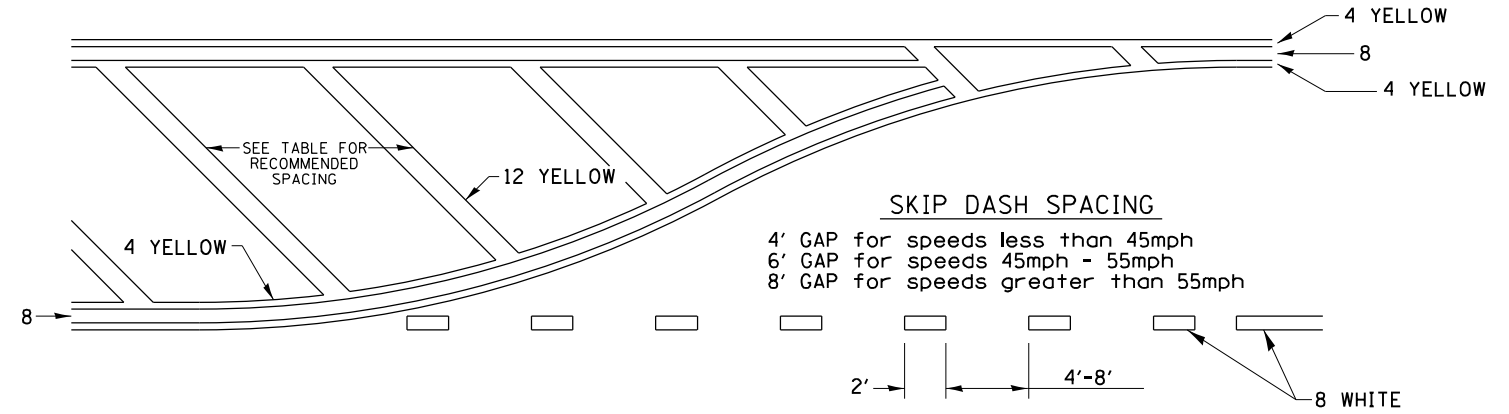

### RECOMMENDED SPACING BETWEEN DIAGONALS (IN FEET)

Speed Limit Range	Continuous Median Area	Intersection Channelization	Objects (Islands)
less than 30MPH	50'	15'	10'
30-40MPH	75'	20'	15'
45MPH & over	75'	30'	20'

NOTE: if the spacing recommended in the Table does not permit at least five diagonal lines in the area being marked, the spacing from the next lowest speed range should be used. The recommended spacing is measured parallel to the pavement center line.

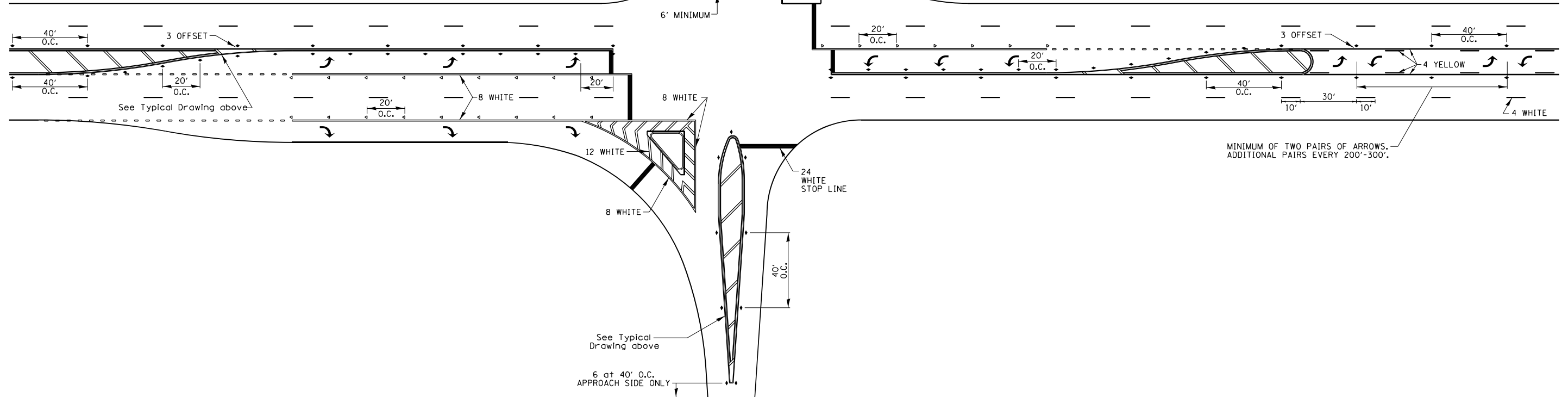

FILE NAME =	USER NAME = cushmanbw	DESIGNED -	REVISED - 6-27-14
pw:\planroom.dot\illinois.gov\PIDOT\Documents\IDOT Offices\District 2\Projects\64N63\DRAWN Development\Studies & Plans\Design\REVISED\ASheets\32054183-sht-details.dgn		CHECKED -	REVISED -
		DATE -	REVISED -

STATE OF ILLINOIS  
DEPARTMENT OF TRANSPORTATION

REGION 2 / DISTRICT 2 STANDARD

SCALE: SHEET NO. OF SHEETS STA. TO STA.

F.A.P. RTE.	SECTION	COUNTY	TOTAL SHEETS	SHEET NO.
301	43RS	JO DAVIESS	33	32
CONTRACT NO. 64N63				
FED. ROAD DIST. NO. ILLINOIS FED. AID PROJECT				



# TYPICAL PAVEMENT MARKINGS

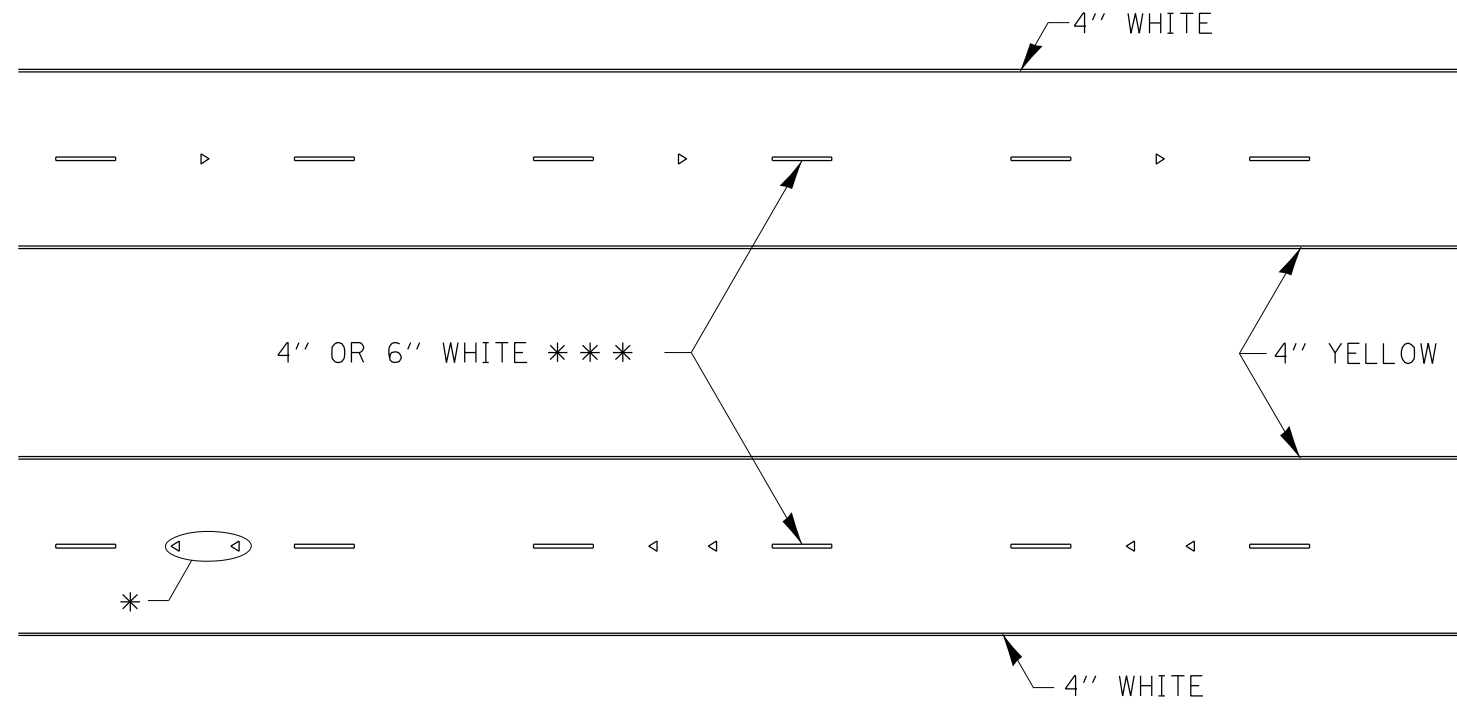

\* SEE HIGHWAY STANDARD 781001 FOR SPACING DETAILS.  
USE DOUBLE MARKERS WHEN ADT > 20,000.

## MULTI-LANE / DIVIDED

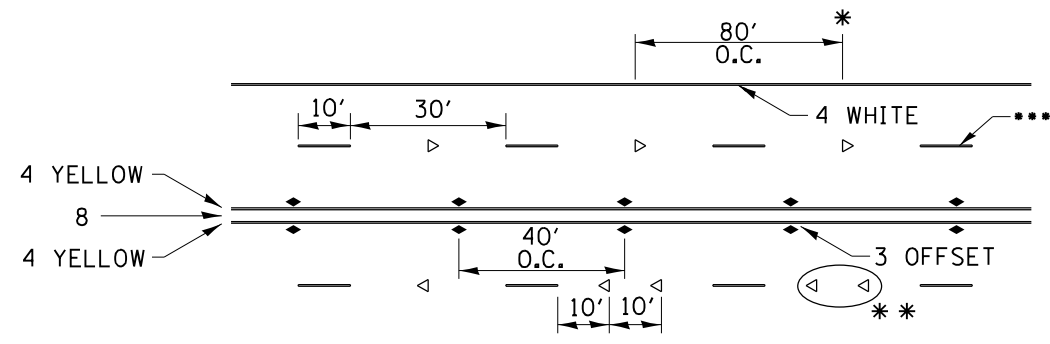

\* REDUCE TO 40' O.C. ON CURVES WHERE ADVISORY SPEEDS ARE 10 MPH LOWER THAN POSTED SPEEDS.

\*\* USE DOUBLE MARKERS WHEN ADT ≥ 20,000

\*\*\* CENTERLINE SKIP DASH PAVEMENT MARKING SPEED LIMIT LESS THAN 40 MPH USE 4" LINE. SPEED LIMIT 40 MPH AND OVER USE 6" LINE.

## MULTI-LANE / UNDIVIDED & ONE WAY

(FOR MULTI-LANE UNDIVIDED HIGHWAYS USE THIS DETAIL NOT HIGHWAY STANDARD 781001)

## TYPICAL PARKING SPACING

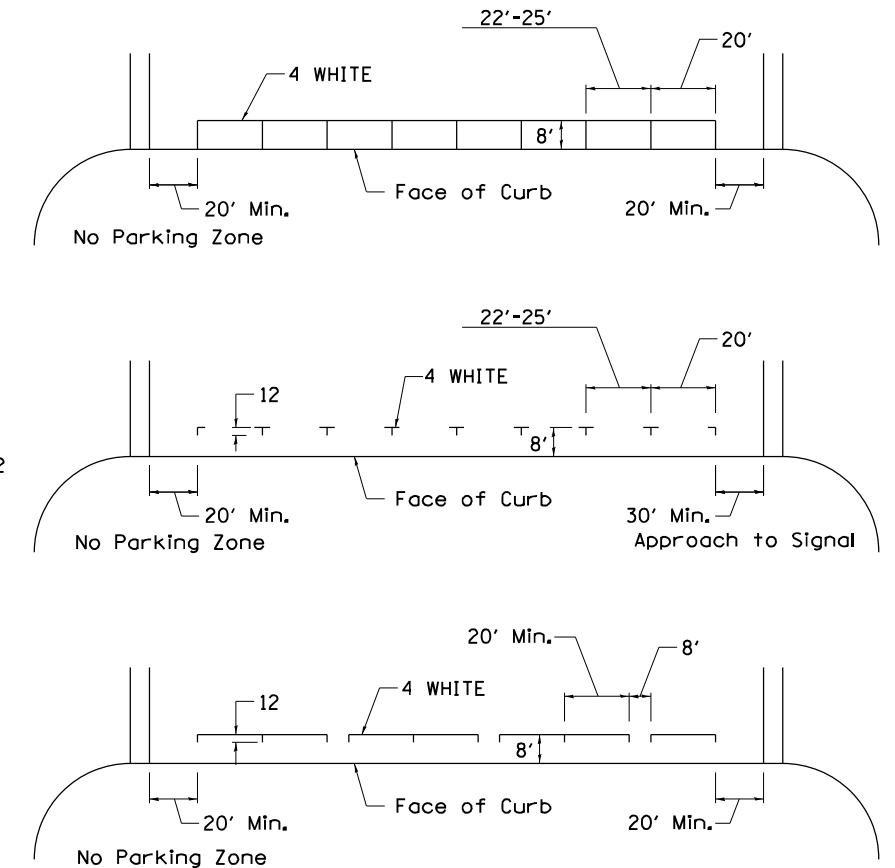

## TYPICAL PAVEMENT MARKING FOR TWO LANE SECTION – NO PASSING ZONES

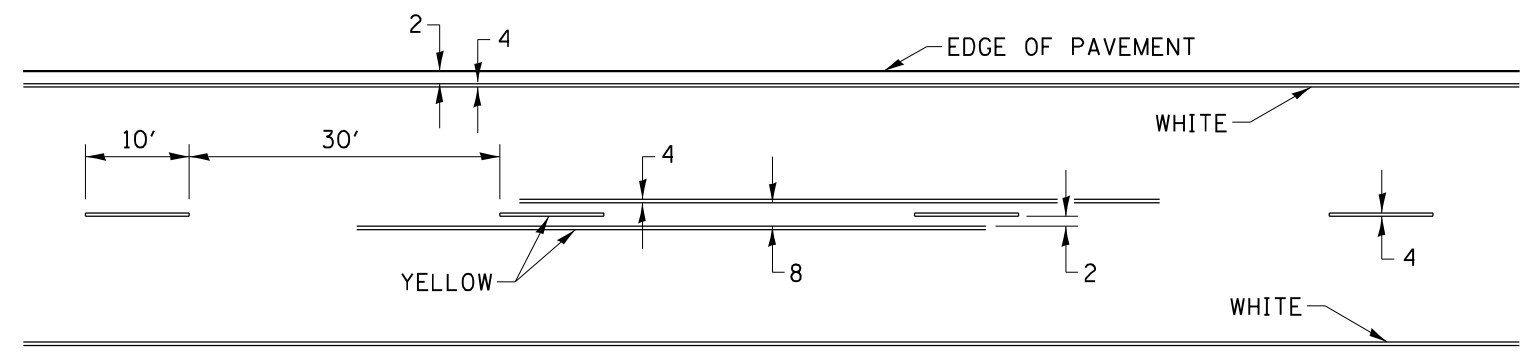

## SYMBOLS

FILE NAME =	USER NAME = cushmenbw	DESIGNED -	REVISED - 6-27-14
pw:\planroom.dot\illinois.gov\PIDOT\Documents\IDOT Offices\District 2\Projects\64N63\Drawn Development\Studies & Plans\Design\ASDsheets\8274183-sht-details.dgn		DRAWN	REVISED - 11-28-12
	PLOT SCALE = 100.0000' / in.	CHECKED -	REVISED -
	PLOT DATE = Jun-25-2021 06:51:27 AM	DATE -	REVISED -

STATE OF ILLINOIS  
DEPARTMENT OF TRANSPORTATION

REGION 2 / DISTRICT 2 STANDARD

SCALE: SHEET NO. OF SHEETS STA. TO STA.

F.A.P. RTE.	SECTION	COUNTY	TOTAL SHEETS	SHEET NO.
301	43RS	JO DAVIESS	33	33
CONTRACT NO. 64N63				
FED. ROAD DIST. NO. ILLINOIS FED. AID PROJECT				