

STATE OF ILLINOIS
DEPARTMENT OF TRANSPORTATION

F.A.P. RTE.	SECTION	COUNTY	TOTAL SHEETS	SHEET NO.
840	(136)CLV	IROQUOIS	7	1
		ILLINOIS	CONTRACT NO. 66L97	

INDEX OF SHEETS

- 1. COVER SHEET
- 2. GENERAL NOTES
- 3 - 4. SUMMARY OF QUANTITIES
- 5. TYPICAL SECTION
- 6. PLAN DETAILS
- 7. TEMPORARY INFORMATION SIGNING

STANDARDS

- 000001-08 STANDARD SYMBOLS, ABBREVIATIONS AND PATTERNS
- 001006 DECIMAL OF AN INCH AND OF A FOOT
- 420001-09 PAVEMENT JOINTS
- 442201-03 CLASS C AND D PATCHES
- 542301-03 PRECAST REINFORCED CONCRETE FLARED END SECTION
- 602011-02 CATCH BASIN, TYPE C
- 602406-11 PRECAST MANHOLE, TYPE A, 6' (1.8 m) DIAMETER
- 602701-02 MANHOLE STEPS
- 604001-05 FRAME AND LIDS, TYPE 1
- 604036-03 GRATE, TYPE 8
- 701001-02 OFF-ROAD OPERATIONS 2L, 2W, MORE THAN 15' (4.5 m) AWAY
- 701006-05 OFF-ROAD OPERATIONS 2L, 2W, 15' (4.5 m) TO 24" (600 mm) FROM PAVEMENT EDGE
- 701201-05 LANE CLOSURE, 2L, 2W, DAY ONLY, FOR SPEEDS \geq 45 MPH
- 701206-05 LANE CLOSURE, 2L, 2W, NIGHT ONLY, FOR SPEEDS \geq 45 MPH
- 701301-04 LANE CLOSURE, 2L, 2W, SHORT TIME OPERATIONS
- 701901-08 TRAFFIC CONTROL DEVICES

**PROPOSED
HIGHWAY PLANS**

**F.A.P. ROUTE 840 (IL 49)
SECTION (136)CLV
PIPE CULVERT REPLACEMENT
IROQUOIS COUNTY**

C-93-099-21

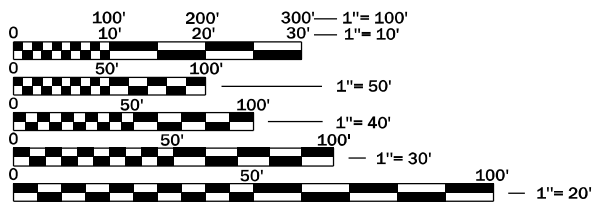
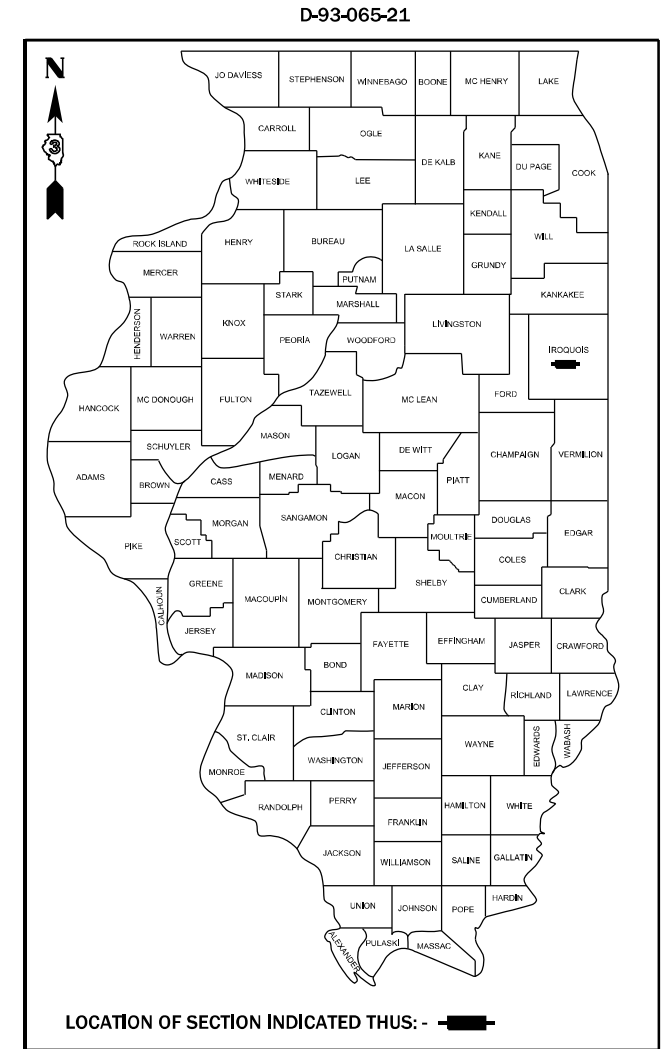

FULL SIZE PLANS HAVE BEEN PREPARED USING STANDARD ENGINEERING SCALES. REDUCED SIZED PLANS WILL NOT CONFORM TO STANDARD SCALES. IN MAKING MEASUREMENTS ON REDUCED PLANS, THE ABOVE SCALES MAY BE USED.

J.U.L.I.E.
JOINT UTILITY LOCATION INFORMATION FOR EXCAVATION
1-800-892-0123
OR 811

PROJECT ENGINEER: YOGESH PATEL P.E.
UNIT CHIEF: RON WOODSHANK
DISTRICT 3 NO. (815) 434-6131
CONTRACT NO. 66L97

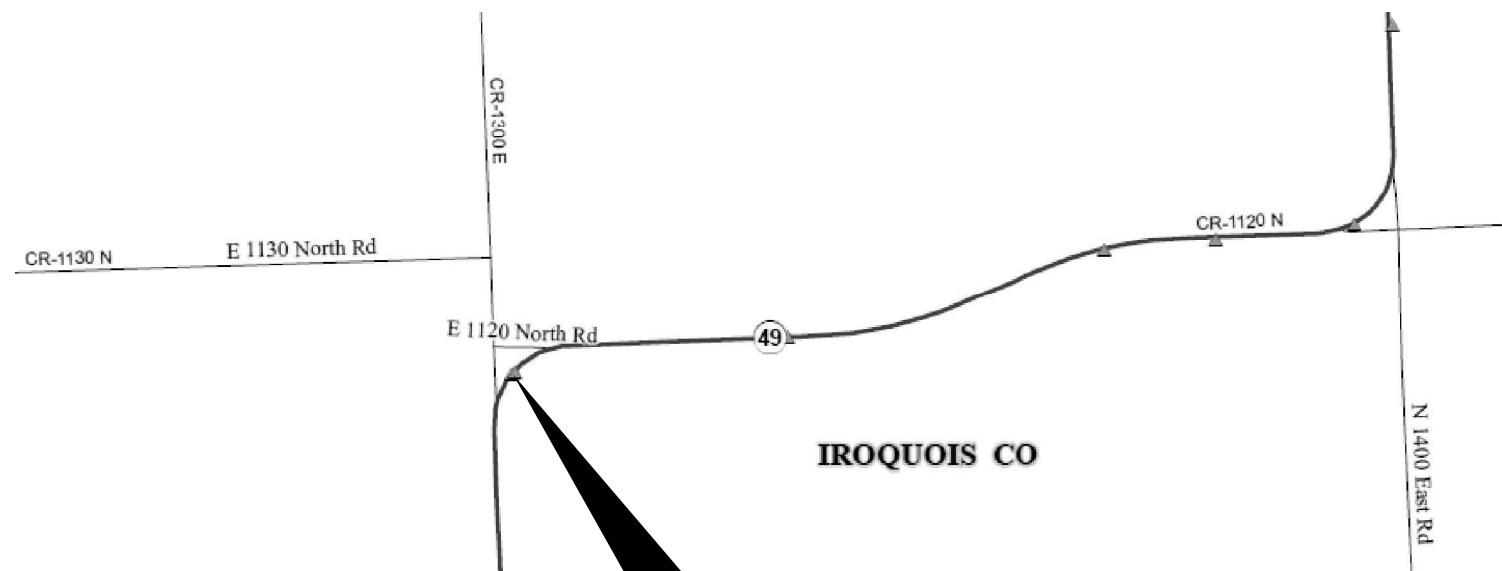

IROQUOIS CO

PROJECT LOCATION

EXISTING 48" \emptyset CMP STORM SEWER
STA. 391+00
CARRYING IL ROUTE 49 (1120N RD.)
OVER A DRAINAGE DITCH
8.9 MILES SOUTH OF US 24 (CRESENT CITY)

FUNCTIONAL CLASSIFICATION
RURAL MINOR ARTERIAL
F.A.P. ROUTE 840 (IL 49)
2019 ADT = 1350
P.V. 82.2 % S.U. 5.2 % M.U. 12.6 %

STATE OF ILLINOIS
DEPARTMENT OF TRANSPORTATION

SUBMITTED June 29, 2021
[Signature] REGIONAL ENGINEER

August 13, 2021
[Signature] ENGINEER OF DESIGN AND ENVIRONMENT

August 13, 2021
[Signature] DIRECTOR OF HIGHWAYS PROJECT IMPLEMENTATION

**PRINTED BY THE AUTHORITY
OF THE STATE OF ILLINOIS**

GENERAL NOTES

PLAN DIMENSIONS AND DETAILS RELATIVE TO EXISTING PLANS ARE SUBJECT TO NOMINAL CONSTRUCTION VARIATIONS. THE CONTRACTOR SHALL FIELD VERIFY EXISTING DIMENSIONS AND DETAILS AFFECTING NEW CONSTRUCTION AND MAKE NECESSARY APPROVED ADJUSTMENTS PRIOR TO CONSTRUCTION OR ORDERING OF MATERIALS. SUCH VARIATIONS SHALL NOT BE CAUSE FOR ADDITIONAL COMPENSATION FOR A CHANGE IN SCOPE OF WORK; HOWEVER, THE CONTRACTOR WILL BE PAID FOR THE QUANTITY ACTUALLY FURNISHED AT THE UNIT PRICE BID FOR THE WORK.

EXCEPT AS NOTED ON THE PLANS, PAVEMENT GRADES SHOWN ARE AT THE TOP OF PAVEMENT SURFACES.

BEFORE ORDERING PIPE CULVERTS OR PIPE DRAINS, THE CONTRACTOR SHALL CONSULT THE ENGINEER FOR EXACT LENGTHS.

THE FINISHED EARTHWORK SHALL HAVE A VEGETATION SUSTAINING SOIL COVERING THE TOP FOUR INCHES IN AREAS TO BE SEEDED OR SODDED THE VEGETATION SUSTAINING SOIL REQUIRED WILL NOT BE PAID FOR SEPARATELY BUT WILL BE INCLUDED IN THE COST OF RELATED STORM SEWER CONSTRUCTION ITEMS.

ON EXISTING PAVEMENT WHICH MAY BE SUPERELEVATED, THE NEW PCC PAVEMENT SHALL BE BUILT WITH THE SAME SUPERELEVATION UNLESS NEW SUPERELEVATION RATES ARE GIVEN ON THE PLANS.

THE FOLLOWING RATES OF APPLICATION HAVE BEEN USED IN CALCULATING PLAN QUANTITIES:

GRANULAR MATERIALS	2.05	TONS / CU YD
--------------------	------	--------------

THE WORK REQUIRED TO CONNECT ANY PIPE TO AN EXISTING DRAINAGE STRUCTURE OR PIPE WILL NOT BE PAID FOR SEPARATELY, BUT WILL BE CONSIDERED AS INCLUDED IN THE CONTRACT UNIT PRICE BID FOR THE PIPE CULVERT ITEMS.

MEMBERS OF JULIE KNOWN TO BE WITHIN THE LIMITS OF THE IMPROVEMENT ARE:
EASTERN ILLINI ELECTRIC COOP
FRONTIER

COMMITMENTS

STATE OF ILLINOIS
DEPARTMENT OF TRANSPORTATION
DISTRICT THREE
AS BUILT INFORMATION

SUPERVISING CONSTRUCTION FIELD ENGINEER

RESIDENT ENGINEER / TECHNICIAN

START & END DATES
OF CONSTRUCTION:

INSPECTORS:

STATE OF ILLINOIS
DEPARTMENT OF TRANSPORTATION
DISTRICT THREE

PREPARED BY: _____
DISTRICT STUDIES & PLANS ENGINEER

DATE: _____

EXAMINED BY: _____
DISTRICT CONSTRUCTION ENGINEER

DISTRICT MATERIALS ENGINEER

DISTRICT OPERATIONS ENGINEER

**STATE OF ILLINOIS
DEPARTMENT OF TRANSPORTATION**

GENERAL NOTES

SCALE: SHEET 1 OF 1 SHEETS STA. TO STA.

F.A.P. RTE.	SECTION	COUNTY	TOTAL SHEETS	SHEET NO.
840	(135)CLV	IROQUOIS	7	2
			CONTRACT NO. 66L97	
		ILLINOIS	FED. AID PROJECT	

CODE NO.	ITEM	UNIT	TOTAL QUANTITY	CONSTRUCTION CODE	
				CONTRACT MAINTENANCE	
				100% STATE	
				UTILITY	RURAL
				0043	
44201439	CLASS C PATCHES, TYPE III, 17 INCH	SQ YD	34		34
54213693	PRECAST REINFORCED CONCRETE FLARED END SECTIONS 48"	EACH	1		1
550A0190	STORM SEWERS, CLASS A, TYPE 1 48"	FOOT	60		60
550B0070	STORM SEWERS, CLASS B, TYPE 1 15"	FOOT	12		12
55100500	STORM SEWER REMOVAL 12"	FOOT	12		12
55101900	STORM SEWER REMOVAL 48"	FOOT	64		64
59300100	CONTROLLED LOW-STRENGTH MATERIAL	CU YD	52		52
60207605	CATCH BASINS, TYPE C, TYPE 8 GRATE	EACH	1		1
60223800	MANHOLES, TYPE A, 6'-DIAMETER, TYPE 1 FRAME, CLOSED LID	EACH	1		1
60500040	REMOVING MANHOLES	EACH	1		1
60500050	REMOVING CATCH BASINS	EACH	1		1
67100100	MOBILIZATION	L SUM	1		1
70100450	TRAFFIC CONTROL AND PROTECTION, STANDARD 701201	L SUM	1		1
70100455	TRAFFIC CONTROL AND PROTECTION, STANDARD 701206	L SUM	1		1

MODEL: Default
 FILE NAME: p:\pub\mroom.dwt
 ILLINOIS DOT
 PROJECT: I3566L97
 CADD DATA: I3566L97_PLAN_SET.dwg

USER NAME = woodshank1	DESIGNED - RW	REVISED -
	DRAWN - RW	REVISED -
PLOT SCALE = 100,0000 ' / in.	CHECKED - YP	REVISED -
PLOT DATE = 6/29/2021	DATE - 5/31/2021	REVISED -

STATE OF ILLINOIS
DEPARTMENT OF TRANSPORTATION

SUMMARY OF QUANTITIES			
SCALE:	SHEET 1 OF 2 SHEETS	STA.	TO STA.

F.A.P. RTE.	SECTION	COUNTY	TOTAL SHEETS	SHEET NO.
840	(135)CLV	IROQUOIS	7	3
			CONTRACT NO. 66L97	
		ILLINOIS	FED. AID PROJECT	

CODE NO.	ITEM	UNIT	TOTAL QUANTITY	CONSTRUCTION CODE	
				CONTRACT MAINTENANCE 100% STATE	UTILITY
				0043	
				RURAL	
70200100	NIGHTTIME WORK ZONE LIGHTING	L SUM	1		1
Z0030850	TEMPORARY INFORMATION SIGNING	SQ FT	42		42

MODEL: Default
 FILE NAME: p:\pub\mroom.dwg
 PROJECT: P:\DOT\Documents\DOT_Offices\District 3\Projects\0366L97\CADD\0366L97_PLN1.SET.dwg

USER NAME = woodshank1	DESIGNED - RW	REVISED -
	DRAWN - RW	REVISED -
PLOT SCALE = 100,0000' / in.	CHECKED - YP	REVISED -
PLOT DATE = 6/29/2021	DATE - 5/31/2021	REVISED -

**STATE OF ILLINOIS
DEPARTMENT OF TRANSPORTATION**

SUMMARY OF QUANTITIES

SCALE: SHEET 2 OF 2 SHEETS STA. TO STA.

F.A.P. RTE.	SECTION	COUNTY	TOTAL SHEETS	SHEET NO.
840	(135)CLV	IROQUOIS	7	4
			CONTRACT NO. 66L97	
			ILLINOIS FED. AID PROJECT	

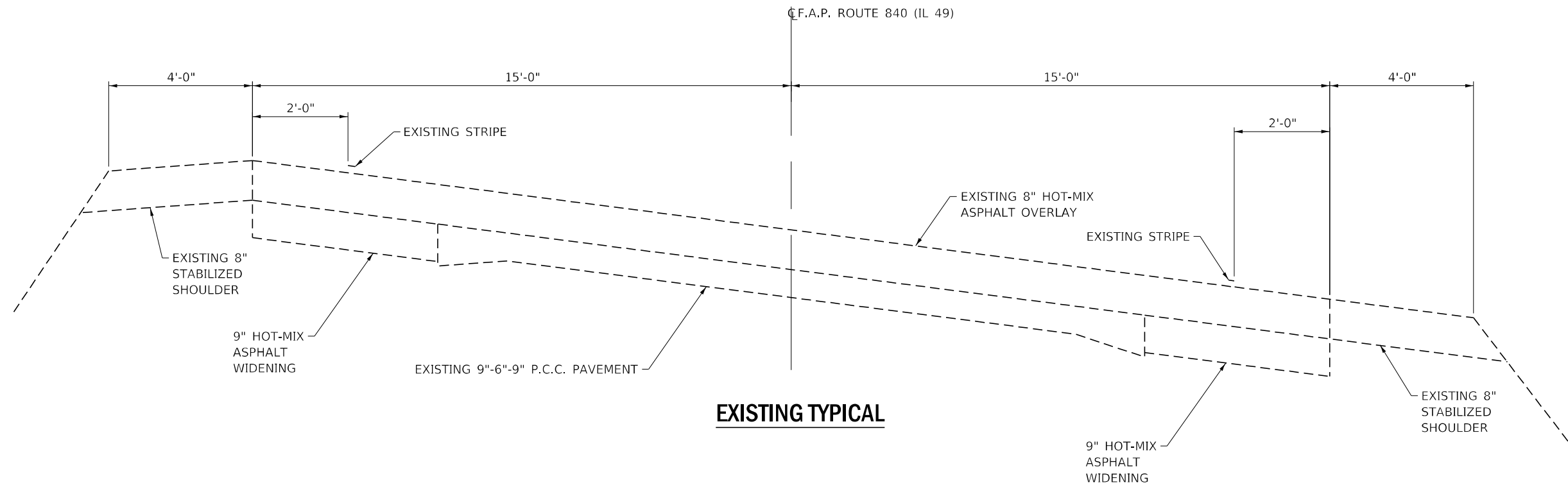

EXISTING TYPICAL

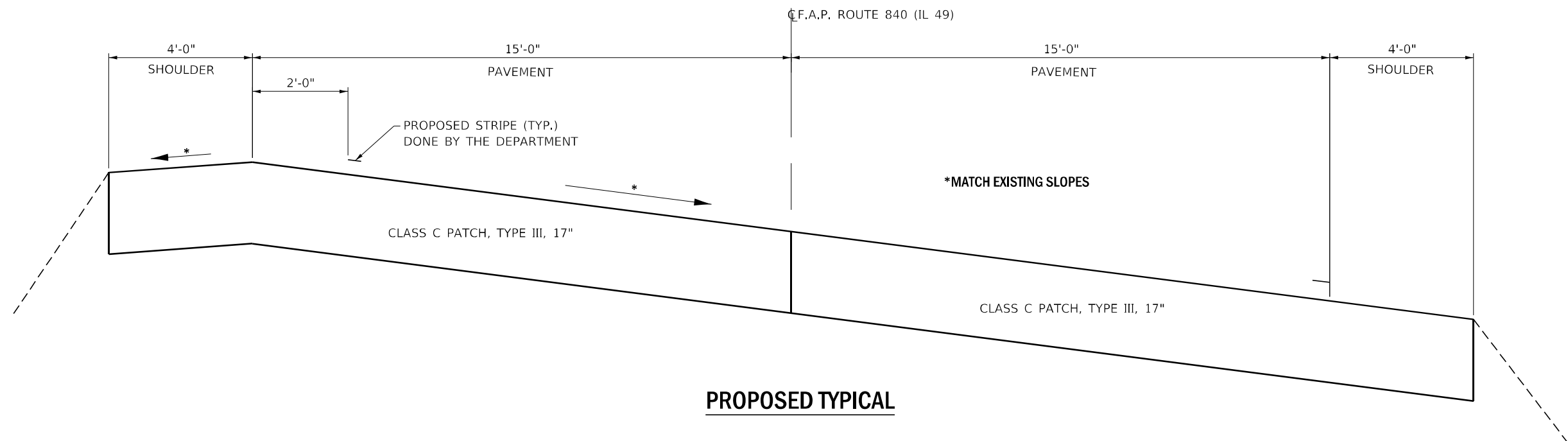

PROPOSED TYPICAL

MODEL: Default
 FILE NAME: p:\pub\harronm.dwt\illinois.gov\PWIDOT\Documents\DOT_Offices\District 3\Projects\0366L97\CADD\0366L97_PLN1.SET.dgn

USER NAME = woodshank1	DESIGNED - RW	REVISED -
	DRAWN - RW	REVISED -
PLOT SCALE = 100,0000' / in.	CHECKED - YP	REVISED -
PLOT DATE = 6/29/2021	DATE - 5/31/2021	REVISED -

**STATE OF ILLINOIS
DEPARTMENT OF TRANSPORTATION**

TYPICAL SECTION

SCALE: SHEET 1 OF 1 SHEETS STA. TO STA.

F.A.P. RTE. 840	SECTION (135)CLV	COUNTY IROQUOIS	TOTAL SHEETS 7	SHEET NO. 5
			CONTRACT NO. 66L97	
ILLINOIS FED. AID PROJECT				

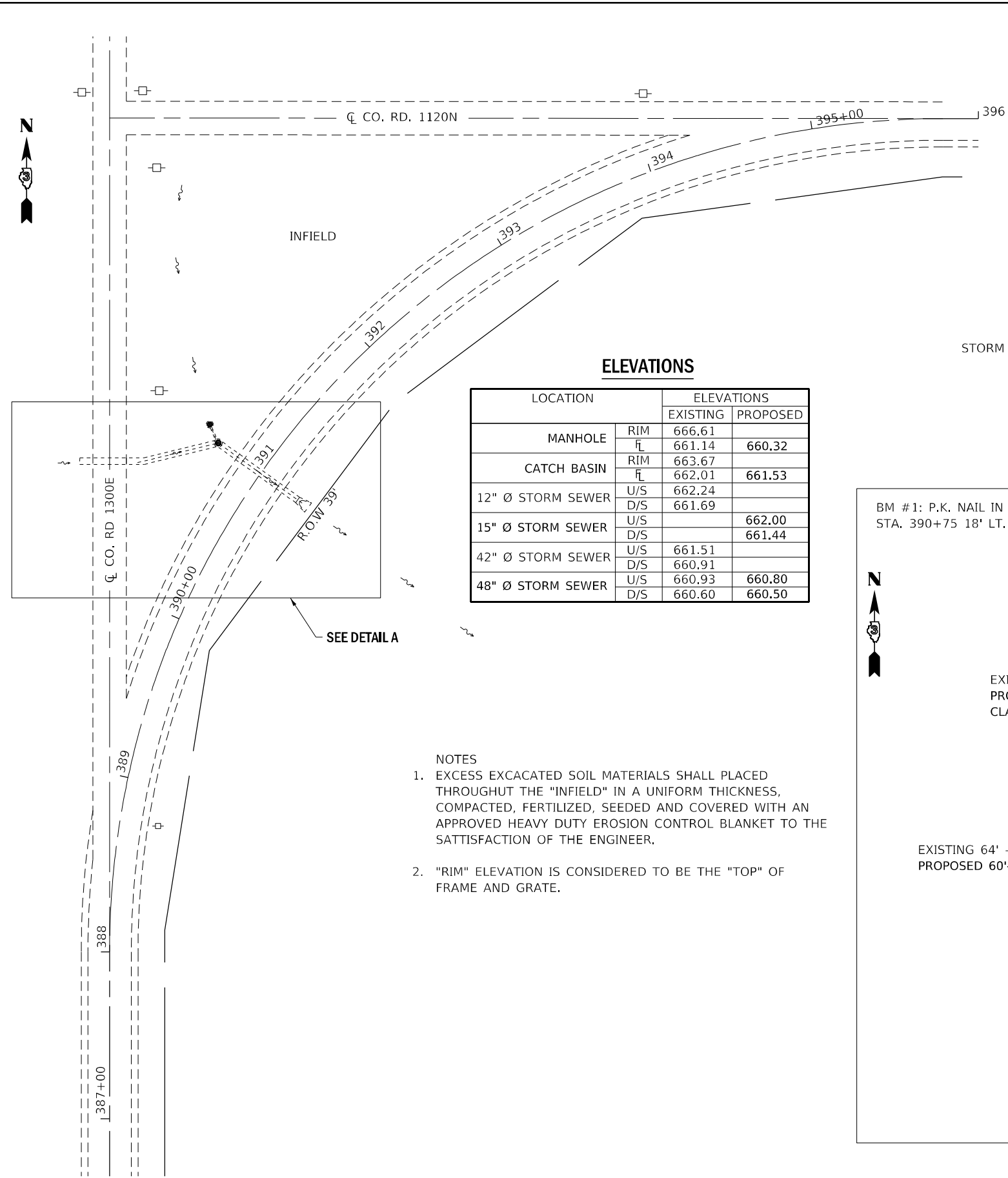

ELEVATIONS

LOCATION	ELEVATIONS		
		EXISTING	PROPOSED
MANHOLE	RIM	666.61	
	FL	661.14	660.32
CATCH BASIN	RIM	663.67	
	FL	662.01	661.53
12" Ø STORM SEWER	U/S	662.24	
	D/S	661.69	
15" Ø STORM SEWER	U/S		662.00
	D/S		661.44
42" Ø STORM SEWER	U/S	661.51	
	D/S	660.91	
48" Ø STORM SEWER	U/S	660.93	660.80
	D/S	660.60	660.50

NOTES

- EXCESS EXCAVATED SOIL MATERIALS SHALL BE PLACED THROUGHOUT THE "INFIELD" IN A UNIFORM THICKNESS, COMPACTED, FERTILIZED, SEEDING AND COVERED WITH AN APPROVED HEAVY DUTY EROSION CONTROL BLANKET TO THE SATISFACTION OF THE ENGINEER.
- "RIM" ELEVATION IS CONSIDERED TO BE THE "TOP" OF FRAME AND GRATE.

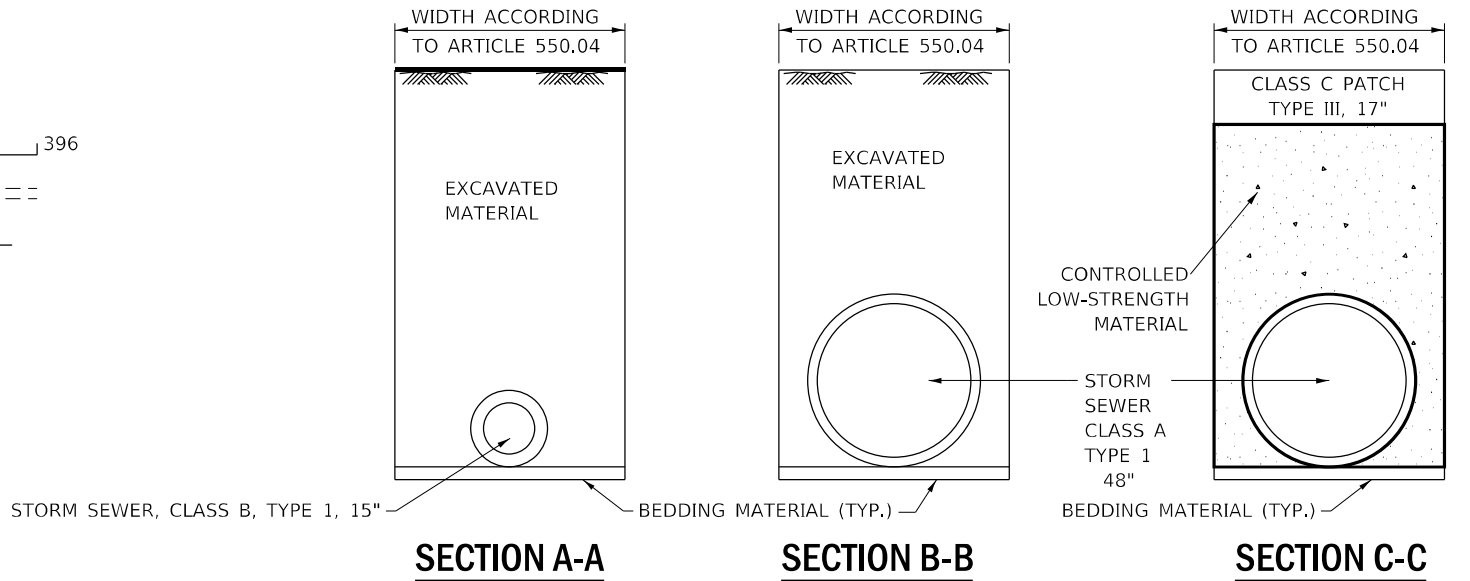

*BEDDING MATERIAL ACCORDING TO ARTICLE 550.4
 BEDDING MATERIAL SHALL NOT BE PAID FOR SEPARATELY
 BUT SHALL BE INCLUDED IN THE COST OF THE STORM SEWER.

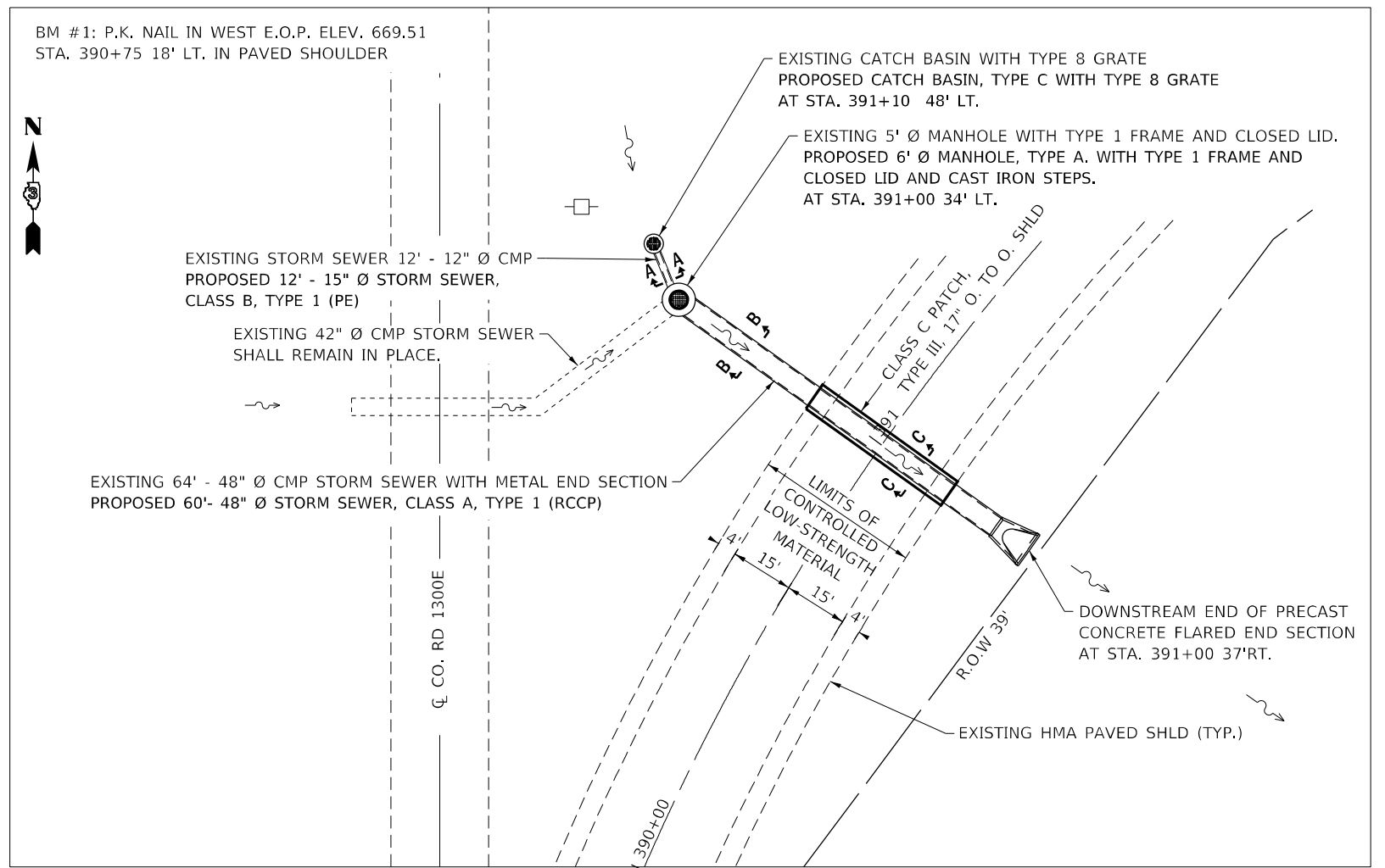

DETAIL A

MODEL: Default
 FILE NAME: p:\pub\mroom.dwg
 PROJECT: I:\projects\1300E\1300E.dwg
 USER: woodshank1

USER NAME = woodshank1	DESIGNED - RW	REVISED -
PLOT SCALE = 100,000' / in.	DRAWN - RW	REVISED -
PLOT DATE = 6/29/2021	CHECKED - YP	REVISED -
	DATE - 5/31/2021	REVISED -

**STATE OF ILLINOIS
 DEPARTMENT OF TRANSPORTATION**

PLAN DETAILS	
SCALE:	SHEET 1 OF 1 SHEETS STA. TO STA.

F.A.P. RTE.	SECTION	COUNTY	TOTAL SHEETS	SHEET NO.
840	(135)CLV	IROQUOIS	7	6
CONTRACT NO. 66L97			ILLINOIS FED. AID PROJECT	

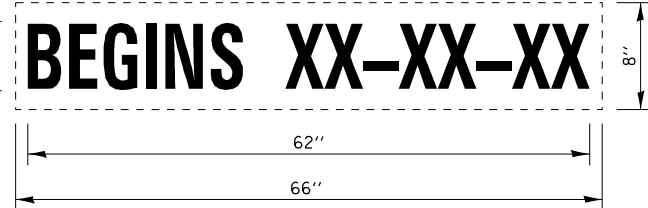
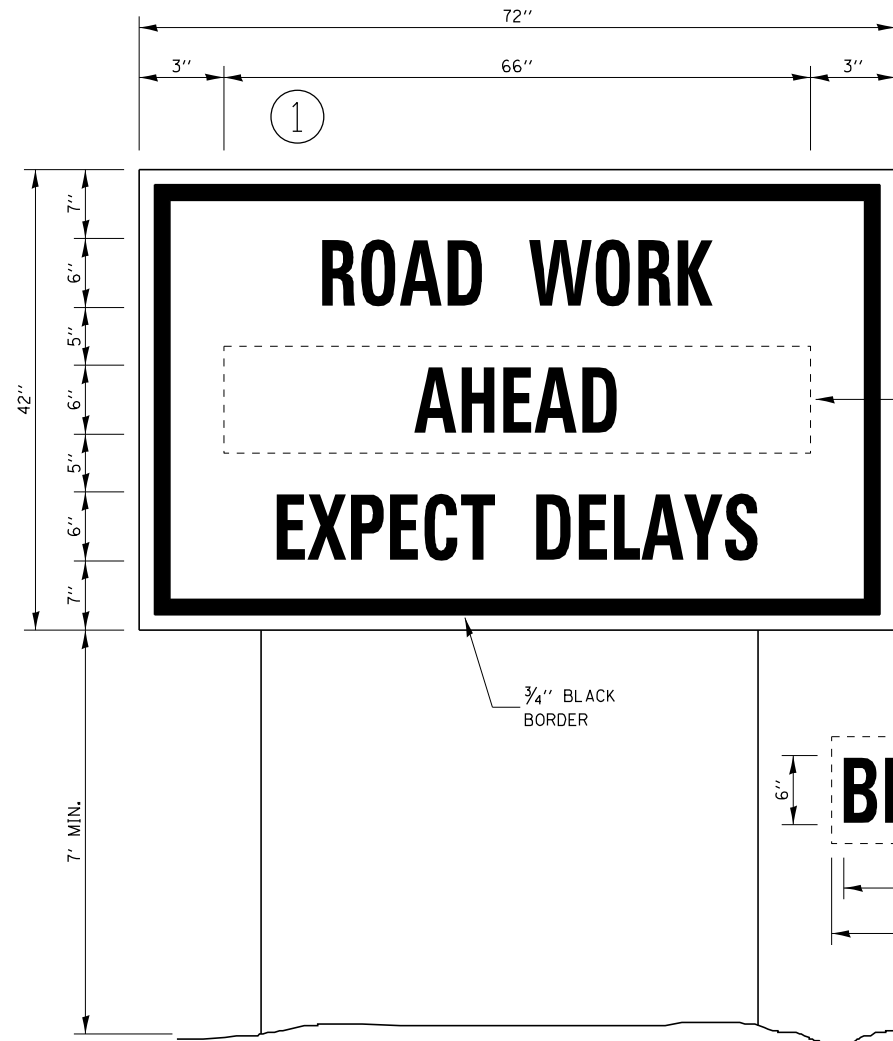

TEMPORARY INFORMATION SIGNING

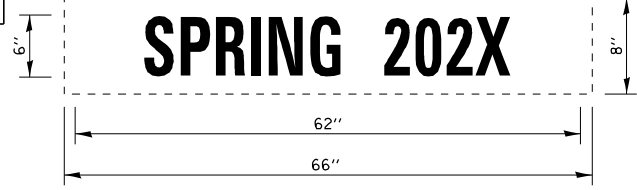
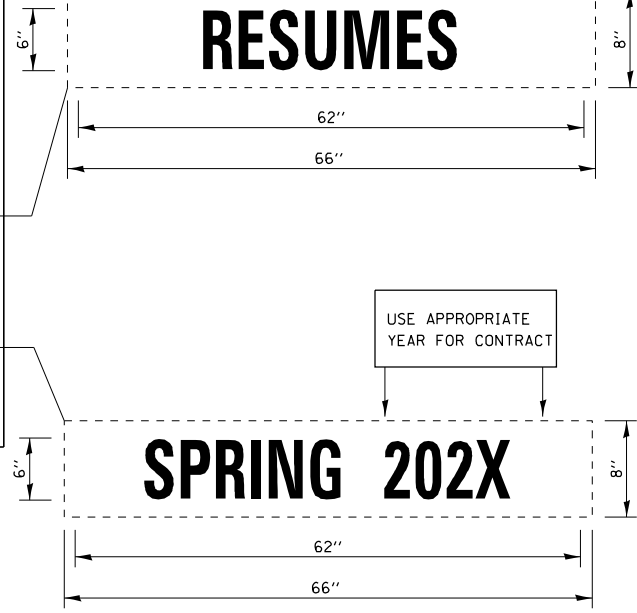
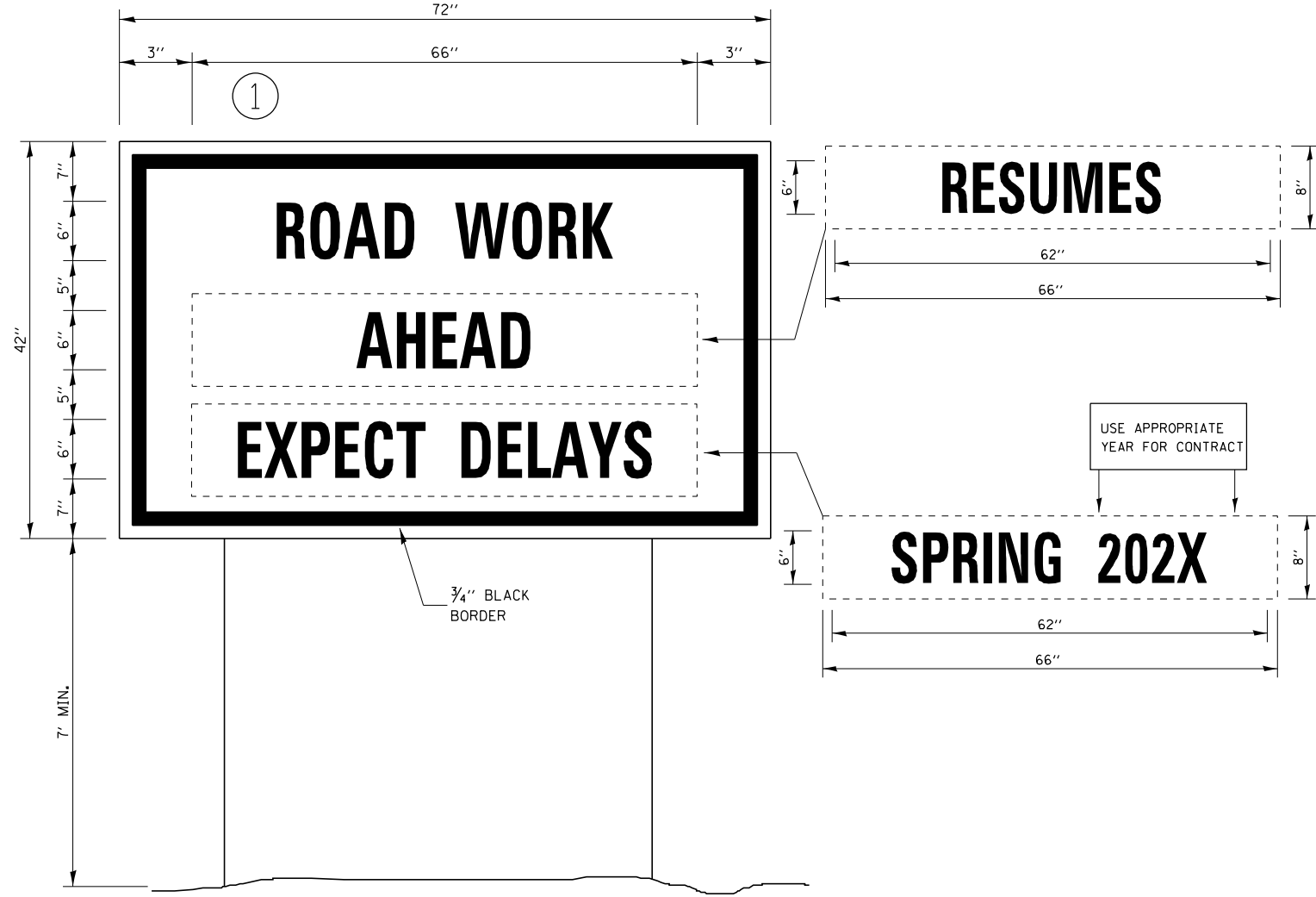

WINTER SHUT DOWN SIGNING

NOTES:

1. USE 6" D BLACK LETTERING ON FLOURESENT ORANGE BACKGROUND.
2. ERECT SIGNS AT LOCATIONS IN ADVANCE OF THE "ROAD CONSTRUCTION AHEAD" SIGNS AS DIRECTED BY THE ENGINEER.
3. ERECT SIGN ① WITH INSTALLED PANEL ② A MINIMUM OF ONE WEEK PRIOR TO THE START OF THE LANE CLOSURE.
4. REMOVE PANEL ② ON THAT DATE.
5. SEE SPECIAL PROVISION "TEMPORARY INFORMATION SIGNING" FOR ADDITIONAL INFORMATION.
6. WILL BE PAID FOR PER SQ FT AS "TEMPORARY INFORMATION SIGNING". EACH SIGN = 21 SQ FT AND THE DATE PANEL ② WILL NOT BE MEASURED SEPARATELY FOR PAYMENT.

MODEL: Default
FILE NAME: p:\pub\lhammon.dwt\illinois.gov\PIWDOT\Documents\IBDOT_Offices\District 3\Projects\ID366L97\CADD\Bids\ID366L97_PL41.SET.dgn

USER NAME = woodshank1	DESIGNED - RW	REVISED -
PLOT SCALE = 100,0000' / in.	DRAWN - RW	REVISED -
PLOT DATE = 6/29/2021	CHECKED - YP	REVISED -
	DATE - 5/31/2021	REVISED -

**STATE OF ILLINOIS
DEPARTMENT OF TRANSPORTATION**

TEMPORARY INFORMATION SIGNING

SCALE: SHEET 1 OF 1 SHEETS STA. TO STA.

F.A.P. RTE.	SECTION	COUNTY	TOTAL SHEETS	SHEET NO.
840	(135)CLV	IROQUOIS	7	7
			CONTRACT NO. 66L97	
ILLINOIS FED. AID PROJECT				