

* Existing Reinforcement Bars to be cleaned and incorporated into the New Construction. Cut 2'-0" From Edge of Construction.

NOTE:
Bars Indicated Thus 6x2-#6 etc., Indicates 6 Lines of Bars with 2 Lengths Per Line.

NOTES:
See Sht's. S9 thru S15 for Transverse Joint Reconstruction Details.
For Section A-A See Sht. S7.
Work this Sheet with Sht. S7.

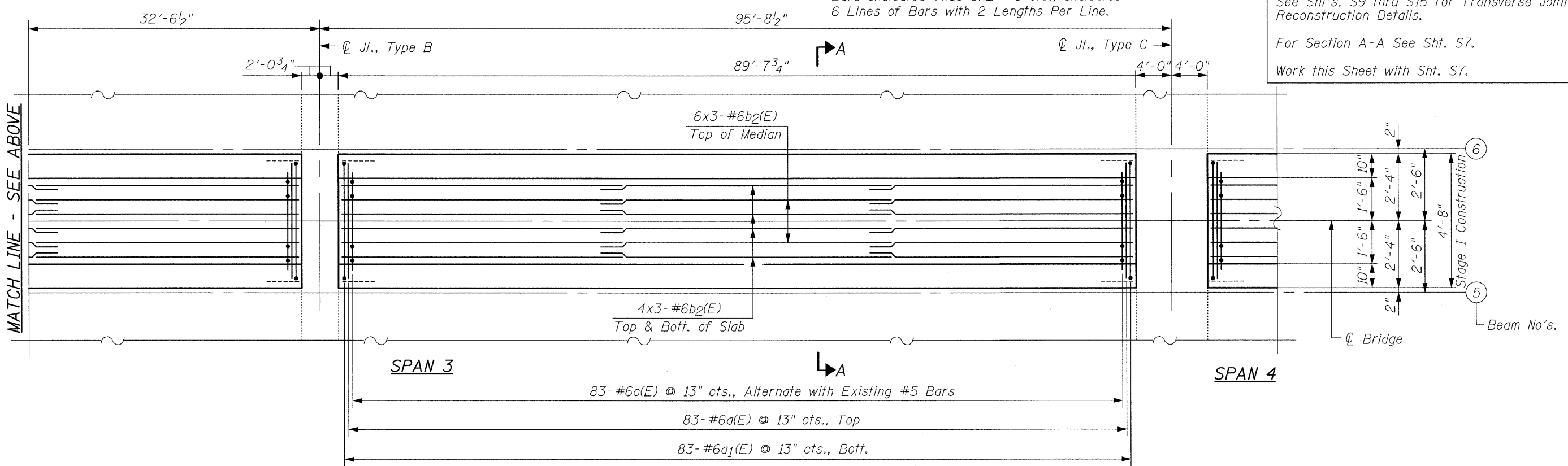

PROPOSED PLAN OF LONGITUDINAL JOINT CLOSURE

FILE NAME = longitudinal_jt-span_3.dgn PLOT DATE = 7/8/2009	CHRISTIAN-ROGE & ASSOCIATES, INC. ENGINEERS-PLANNERS-SURVEYORS 211 WEST WACKER DRIVE CHICAGO, ILLINOIS 60606 PHONE: (312)372-2023 FAX: (312)372-5274	DESIGNED - B.N.S./J.C.N.	REVISED -	STATE OF ILLINOIS DEPARTMENT OF TRANSPORTATION	LONGITUDINAL JOINT CLOSURE - II KEDZIE AVENUE OVER CAL-SAG CHANNEL S.N.016-0762	F.A.U. RTE. 2831	SECTION 1313, 1-I-2	COUNTY COOK	TOTAL SHEETS 41	SHEET NO. 17
		DRAWN - D.L./R.E.S./F.M.	REVISED -			SCALE:	SHEET NO. S8 OF S29 SHEETS	STA. TO STA.	FED. ROAD DIST. NO. 1 ILLINOIS FED. AID PROJECT CONTRACT NO. 60D75	