

STATE OF ILLINOIS  
DEPARTMENT OF TRANSPORTATION

**GENERAL NOTES**

Existing Structure: Sta. 29+01.09 (At Tollway) FAI-80 built under section 1818-809HB in 1964. Repaired and concrete overlay added in 1990 under section 1818-809HB-BR-1-DL. Structure No. 016-2132. Structure consists of a reinforced concrete deck supported by welded steel plate girders on pile bent abutments and pile supported piers. 482'-0<sup>3</sup>/<sub>4</sub>" back-to-back of abutments, 29'-3" out-to-out of deck. Traffic to be maintained using stage construction.

Scope of work: Partial and full depth deck patching, and installation of Permanent Protective Shield over Tollway & I-80.

Plan dimensions and details relative to existing plans are subject to nominal construction variations. The Contractor shall field verify existing dimensions and details affecting new construction and make necessary approved adjustments prior to construction or ordering of materials. Such variations shall not be cause for additional compensation for a change in scope of the work, however, the Contractor will be paid for the quantity actually furnished at the unit price bid for the work.

Location and size of the deck repair shall be determined in the field by the Engineer.

See roadway plans for traffic control details.

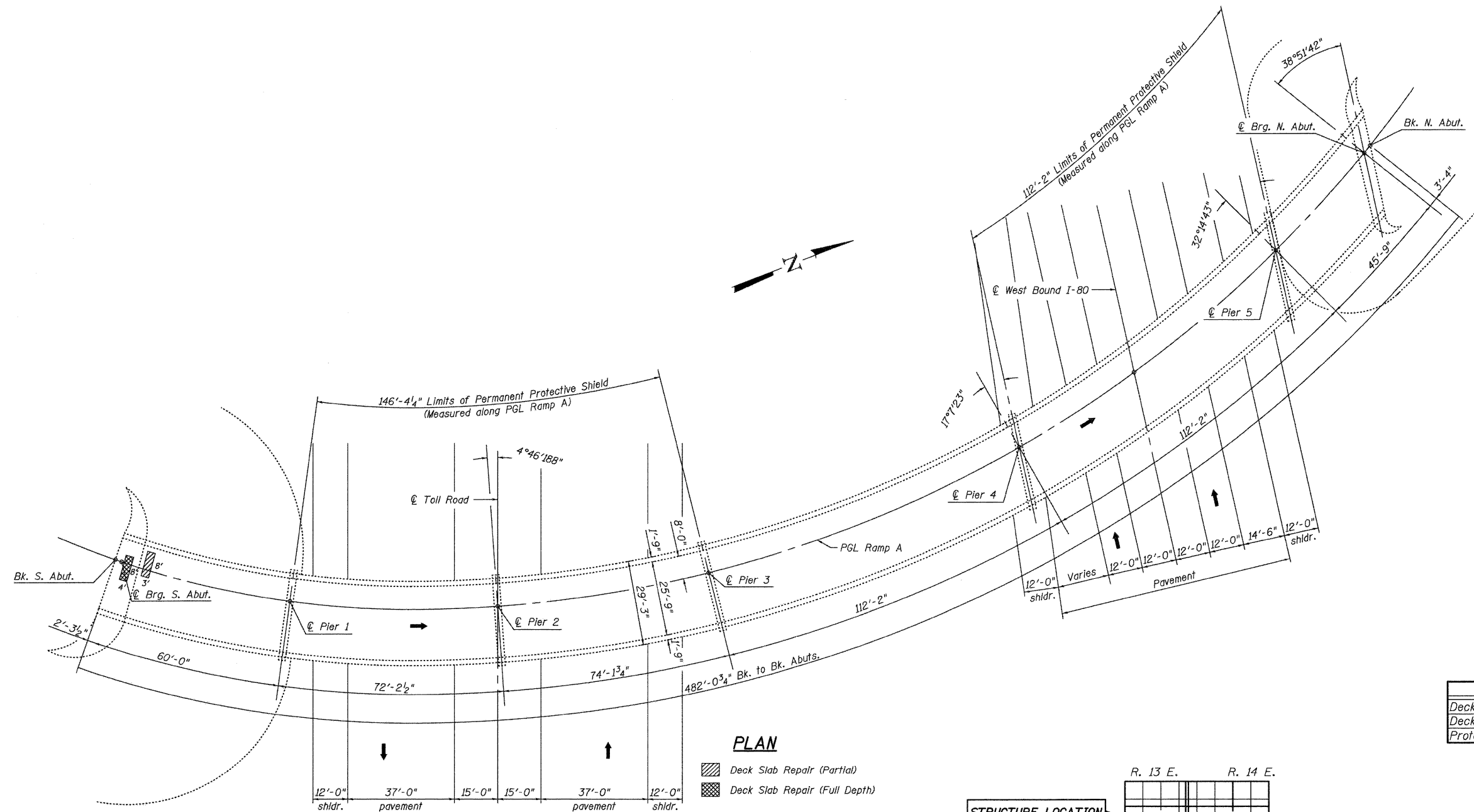

**PLAN**

- Deck Slab Repair (Partial)
- Deck Slab Repair (Full Depth)

STRUCTURE LOCATION

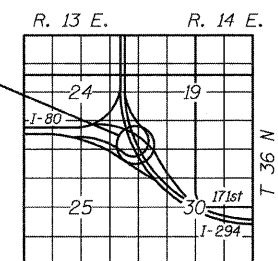

**LOCATION SKETCH**



Expires: 11/30/2010

*Scott D. Sanford*

**TOTAL BILL OF MATERIAL**

ITEM	UNIT	QUANTITY
Deck Slab Repair (Full Depth, Type II)	Sq. Yd.	4
Deck Slab Repair (Partial)	Sq. Yd.	3
Protective Shield (Permanent)	Sq. Yd.	711

**BRIDGE REPAIR  
FAI-80 EB RAMP TO I-294**

\*Section (95-5-1, ETC, 189-824)RS-1

DESIGNED - CMV
CHECKED - SDS
DRAWN - DLH
CHECKED - CMV

**WHKS & CO.**  
ENGINEERING

7018 KINGSMILL CT.,  
SPRINGFIELD, IL  
(217) 483-9457  
DESIGN FIRM #184001036

SHEET NO.	F.A.I. RTE.	SECTION	COUNTY	TOTAL SHEETS	SHEET NO.
1	80	*	COOK	80	45
2 SHEETS	SN 016-2132		CONTRACT NO. 60F61		
FED. ROAD DIST. NO. - ILLINOIS FED. AID PROJECT					