

PLAN	SURVEYED	BY	DATE
	ALIGNED		
	CHECKED		
	NOTE BOOK		
	NO.		
	CADD FILE NAME		

PROFILE	SURVEYED	BY	DATE
	PLotted		
	CHECKED		
	NOTE BOOK		
	NO.		
	STRUCTURE NOTATIONS CHECKED		

NOTE:
 - BENCHMARK #1 - CUT "□" IN TOP OF NORTHWEST WINGWALL ASSUMED ELEVATION = 100.00'

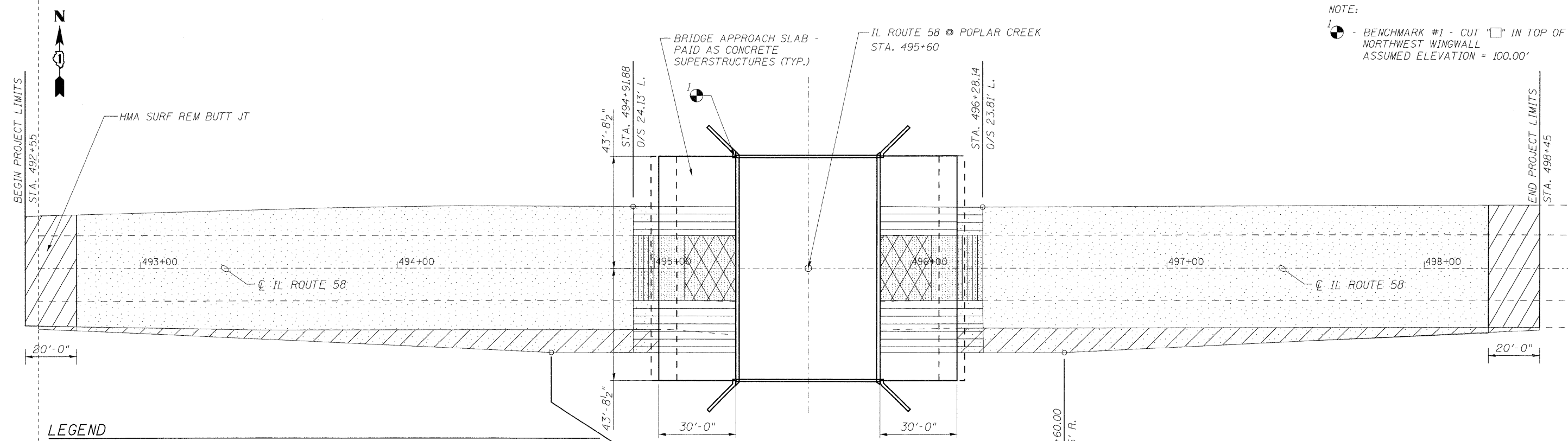

LEGEND

- HOT-MIX ASPHALT SURFACE REMOVAL, 1 1/2" W/ BITUMINOUS MATERIALS (PRIME COAT), HOT-MIX ASPHALT SURFACE COURSE, MIX "D", N70, 1 1/2" & LEVELING BINDER (MACHINE METHOD), N70, 3/4"
- PAVEMENT REM
- BR APPR PVT CON (FLX)
- PAVED SHLD REMOVAL
- HMA SURF REM BUTT JT
- APPROACH SLAB REMOVAL 2 @ 24'-0" BY 20'-0"
- HOT-MIX ASPHALT BASE COURSE WIDENING, 7"

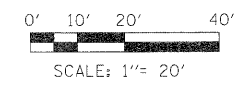

NOTES:

1. THE CONTRACTOR IS TO PROTECT AND MAINTAIN ALL EXISTING UTILITIES. THIS WORK WILL NOT BE PAID FOR SEPARATELY, THE COST OF PROTECTING AND MAINTAINING UTILITIES SHALL BE INCLUDED WITH CONCRETE SUPERSTRUCTURES.
2. THE CONTRACTOR IS TO PROTECT AND MAINTAIN ALL TREES WITHIN AND ADJACENT TO THE WORK ZONE FOR THIS PROJECT. THIS WORK WILL NOT BE PAID FOR SEPARATELY, BUT SHALL BE INCLUDED WITH CONCRETE SUPERSTRUCTURES.

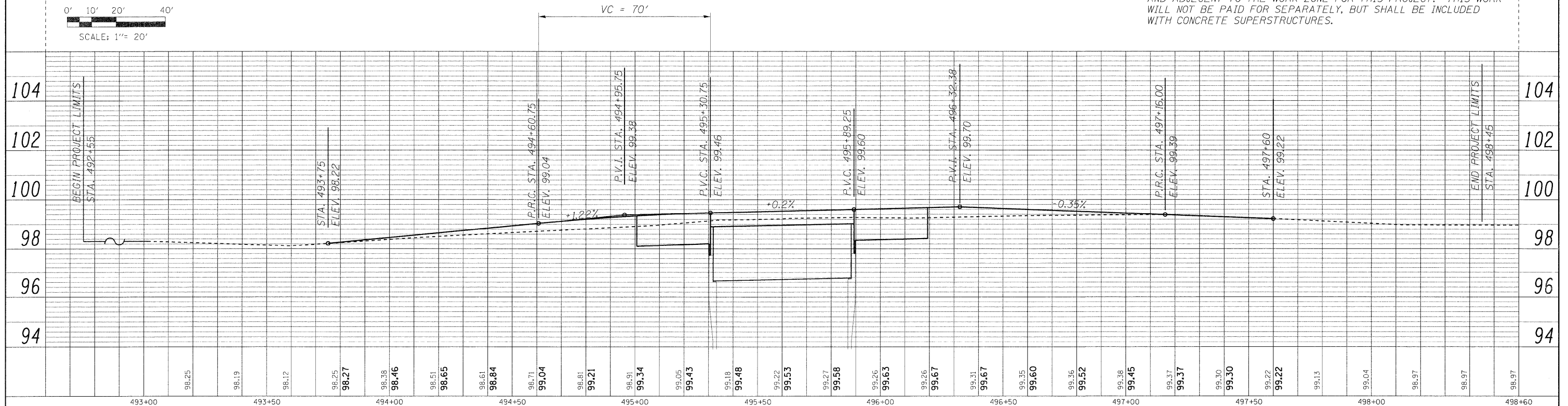

LONGO INC.
 CONSULTING ENGINEERS
 1560 WALL ST, SUITE 222
 NAPERVILLE, ILLINOIS 60563 PH: 630/577-9100

DESIGNED	- MJJ	REVISED	-
DRAWN	- ST	REVISED	-
CHECKED	- MJJ	REVISED	-
DATE	- 07/08/2009	REVISED	-

**STATE OF ILLINOIS
 DEPARTMENT OF TRANSPORTATION**

**PLAN AND PROFILE
 IL ROUTE 58 (GOLF ROAD)**

SCALE: 1" = 20' SHEET NO. 9 OF 33 SHEETS STA. 492+55 TO STA. 498+45

F.A.U. RTE.	SECTION	COUNTY	TOTAL SHEETS	SHEET NO.
1320	581 B-1	COOK	33	9
D-91-215-09			CONTRACT NO. 60F91	
FED. ROAD DIST. NO.		ILLINOIS FED. AID PROJECT		