

QUANTITY  
 4 (100) LINE = 64.1 ft. (19.7 m)  
 21.1 sq. ft. (1.97 sq. m)

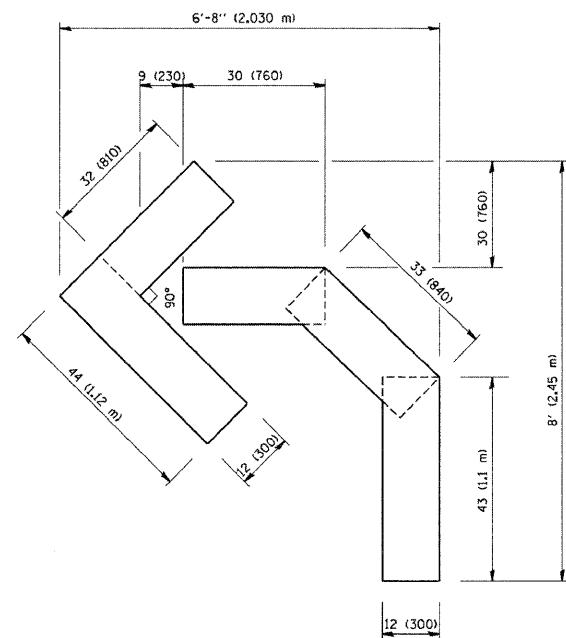

QUANTITY  
 4 (100) LINE = 45.5 ft. (13.9 m)  
 15.2 sq. ft. (1.39 sq. m)

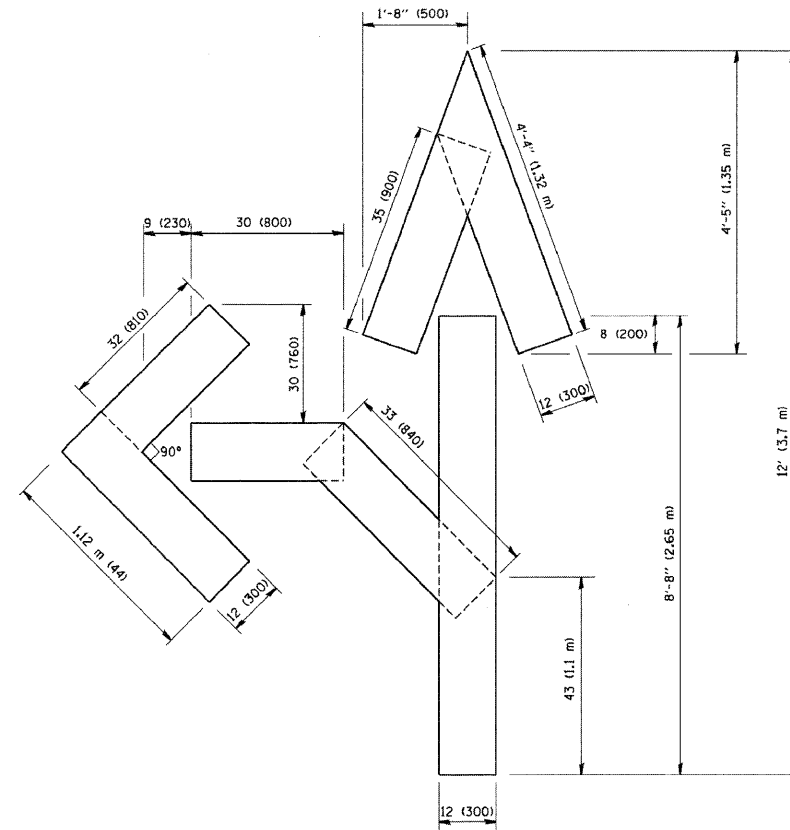

QUANTITY  
 4 (100) LINE = 82.5 ft. (25.3 m)  
 27.5 sq. ft. (2.53 sq. m)

All dimensions are in inches (millimeters) unless otherwise shown.

### DISTRICT ONE TYPICAL PAVEMENT MARKINGS

**LOCO, INC.**  
 CONSULTING ENGINEERS  
 1560 WALL ST., SUITE 222  
 NAPERVILLE, ILLINOIS 60563 Ph: (630) 577-9100

USER NAME = #USER#	DESIGNED - MJY	REVISED -
DRAWN - RJG	CHECKED - MJY	REVISED -
DATE - 07/08/2009		

STATE OF ILLINOIS  
 DEPARTMENT OF TRANSPORTATION

DISTRICT ONE DETAIL SHEETS  
 IL ROUTE 58 (GOLF ROAD)

SCALE: NONE SHEET NO. 31 OF 33 SHEETS STA. 492+55 TO STA. 498+45

F.A.U. RTE.	SECTION	COUNTY	TOTAL SHEETS	SHEET NO.
1320	581 B-1	COOK	33	32
D-91-288-09			CONTRACT NO. 60F91	
FED. ROAD DIST. NO.		ILLINOIS FED. AID PROJECT		