

INDEX OF SHEETS

STATE STANDARDS

GENERAL NOTES

<u>SHEET NO.</u>	<u>DESCRIPTION</u>	<u>STANDARD NO.</u>	<u>DESCRIPTION</u>
1	TITLE SHEET	000001-05	TYPICAL SYMBOLS, ABBREVIATIONS AND PATTERNS
2	INDEX OF SHEETS, STATE STANDARDS & GENERAL NOTES	442201-03	CLASS C AND D PATCHES
3	SUMMARY OF QUANTITIES	604001-03	FRAME AND LIDS, TYPE 1
4-5	EXISTING AND PROPOSED TYPICAL SECTIONS	604086-02	FRAME AND GRATE, TYPE 23
6-9	ROADWAY AND PAVEMENT MARKING PLANS	604091-02	FRAME AND GRATE, TYPE 24
10-15	DETECTOR LOOP REPLACEMENT PLANS	606001-04	CONCRETE CURB AND COMBINATION CONCRETE CURB AND GUTTER
16	DETAILS FOR FRAME AND LIDS ADJUSTMENT WITH MILLING	701426-03	LANE CLOSURE, MULTILANE, INTERMITTENT OR MOVING OPERATIONS
17	PAVEMENT PATCHING FOR HMA SURFACED PAVEMENT	701602-04	URBAN LANE CLOSURE, MULTILANE, 2W WITH BIDIRECTIONAL LEFT TURN LANE
18	CURB OR CURB AND GUTTER REMOVAL AND REPLACEMENT	701606-06	URBAN LANE CLOSURE, MULTILANE 2W WITH MOUNTABLE MEDIAN
19	BUTT JOINT AND HMA TAPER	701701-06	URBAN LANE CLOSURE, MULTILANE INTERSECTION
20	TRAFFIC CONTROL AND PROTECTION FOR SIDE ROADS, INTERSECTIONS AND DRIVEWAYS	701901-01	TRAFFIC CONTROL DEVICES
21	TYPICAL APPLICATIONS: RAISED REFLECTIVE PAVEMENT MARKERS (SNOW-PLOW RESISTANT)	886001-01	DETECTOR LOOP INSTALLATION
22	DISTRICT ONE TYPICAL PAVEMENT MARKINGS	886006-01	TYPICAL LAYOUT FOR DETECTION LOOPS
23	TRAFFIC CONTROL AND PROTECTION OF TURN BAYS (TO REMAIN OPEN TO TRAFFIC)		
24	PAVEMENT MARKING LETTERS AND SYMBOLS FOR TRAFFIC STAGING		
25	ARTERIAL INFORMATION SIGNING		
26	DISTRICT ONE STANDARD TRAFFIC SIGNAL DESIGN		
27	DISTRICT 1 DETECTOR LOOP INSTALLATION DETAILS FOR ROADWAY RESURFACING		

BEFORE STARTING ANY EXCAVATION, THE CONTRACTOR SHALL CALL "JULIE" AT (800) 892-0123 OR 811 FOR FIELD LOCATIONS OF BURIED ELECTRIC, TELEPHONE, AND GAS FACILITIES. (48 HOUR NOTIFICATION REQUIRED)

THE CONTRACTOR WILL NOT BE ABLE TO SET UP A YARD OR FIELD OFFICE ON STATE PROPERTY WITHOUT THE WRITTEN PERMISSION OF THE DEPARTMENT.

BUTT JOINTS WILL BE INSTALLED AT THE ENDS OF RESURFACING (WHERE RESURFACING MEETS EXISTING PAVEMENT) IN ACCORDANCE WITH THE "BUTT JOINT AND HMA TAPER DETAILS" SHEET INCLUDED IN THE PLANS UNLESS OTHERWISE SPECIFIED.

WHEN MILLED PAVEMENT IS OPEN TO TRAFFIC, THE MAXIMUM GRADE DIFFERENTIAL BETWEEN PASSES OF THE MILLING MACHINE SHALL NOT EXCEED 1 1/2 INCHES WHERE THE SPEED LIMIT IS 45 MPH OR LESS, AND 1 INCH WHERE THE SPEED LIMIT IS OVER 45 MPH. WITH WRITTEN APPROVAL FROM THE RESIDENT ENGINEER, A MAXIMUM GRADE DIFFERENTIAL OF 3 INCHES MAY BE ALLOWED IF THE EDGE OF THE MILLING IS SLOPED A MINIMUM OF 1:3 (V:H).

WHEN ARTIFICIAL LIGHTING IS UTILIZED IN NIGHT OPERATIONS, THE CONTRACTOR SHALL EXERCISE THE UTMOST PRECAUTIONS IN PREVENTING ADVERSE VISIBILITY TO THE MOTORING PUBLIC AND ADJOINING RESIDENTIAL AREAS.

ALL PAVEMENT PATCHING LOCATIONS WILL BE DETERMINED IN THE FIELD BY THE ENGINEER.

BEFORE BEGINNING ANY WORK, THE CONTRACTOR SHALL RETAIN AND RECORD FOR FUTURE REFERENCE, ALL EXISTING PAVEMENT MARKING LINES (AND RAISED REFLECTIVE PAVEMENT MARKERS) IN ORDER THAT THESE LOCATIONS CAN BE RE-ESTABLISHED FOR STRIPING. EXACT LOCATIONS OF ALL PAVEMENT MARKINGS SHALL BE AS DIRECTED BY THE ENGINEER.

DOUBLE LANE MARKERS ARE TO BE USED AS SHOWN ON THE DISTRICT ONE DETAIL "TYPICAL APPLICATIONS - RAISED REFLECTIVE PAVEMENT MARKERS (SNOW-PLOW RESISTANT)" SHOWN IN THE PLANS.

THE RESIDENT ENGINEER SHALL CONTACT MR. DON CHIARUGI, AREA TRAFFIC FIELD ENGINEER, AT (847) 741-9857 A MINIMUM OF 2 WEEKS PRIOR TO PLACEMENT OF FINAL PAVEMENT MARKINGS.

THE RESIDENT ENGINEER SHALL CONTACT THE TRAFFIC CONTROL SUPERVISOR AT (847) 705-4470 A MINIMUM OF 72 HOURS PRIOR TO THE INSTALLATION OF ANY TEMPORARY TRAFFIC CONTROL DEVICES.

THE CONTRACTOR SHALL COORDINATE CONSTRUCTION ACTIVITIES WITH UTILITY COMPANIES AND THE CITY OF NAPERVILLE.

FILE NAME =	USER NAME = smthkl	DESIGNED -	REVISED - 8/5/09 K.S.	STATE OF ILLINOIS DEPARTMENT OF TRANSPORTATION	US 34 (OGDEN AVE.) EXISTING AND PROPOSED TYPICAL SECTIONS	Rev. Sheet 8-26-09			
or\pe_work\pavdo\name\142804\0176299-shit-plan.dgn	DRAWN -	REVISED -	F.A.P. RTE.			SECTION	COUNTY	TOTAL SHEETS	SHEET NO.
PLDT SCALE = 50.0000 ' / IN.	CHECKED -	REVISED -	311			652 (X & X-1) RS-5	DUPAGE	27	2
PLDT DATE = 8/4/2009	DATE -	REVISED -	CONTRACT NO. 60H64				ILLINOIS FED. AID PROJECT		
				SCALE:		SHEET NO. OF SHEETS STA. TO STA.			

SUMMARY OF QUANTITIES			URBAN 100% FED.	CONSTRUCTION TYPE CODE					SUMMARY OF QUANTITIES			URBAN 100% FED.	CONSTRUCTION TYPE CODE				
CODE NO	ITEM	UNIT	TOTAL QUANTITIES	ROADWAY 1000					CODE NO	ITEM	UNIT	TOTAL QUANTITIES	ROADWAY 1000				
20201006	GRADING AND SHAPING SHOULDERS	UNIT	85	85					70300220	TEMPORARY PAVEMENT MARKING - LINE 4"	FOOT	43615	43615				
21400100	GRADING AND SHAPING DITCHES	FOOT	945	945					70300240	TEMPORARY PAVEMENT MARKING - LINE 6"	FOOT	4630	4630				
40600200	BITUMINOUS MATERIALS (PRIME COAT)	TON	62	62					70300250	TEMPORARY PAVEMENT MARKING - LINE 8"	FOOT	470	470				
40600300	AGGREGATE (PRIME COAT)	TON	309	309					70300260	TEMPORARY PAVEMENT MARKING - LINE 12"	FOOT	1680	1680				
40600400	MIXTURE FOR CRACKS, JOINTS, AND FLANGEWAYS	TON	39	39					70300280	TEMPORARY PAVEMENT MARKING - LINE 24"	FOOT	650	650				
40600895	CONSTRUCTING TEST STRIP	EACH	2	2					70301000	WORK ZONE PAVEMENT MARKING REMOVAL	SO FT	5650	5650				
40600982	HOT-MIX ASPHALT SURFACE REMOVAL - BUTT JOINT	SO YD	370	370					* 78000100	THERMOPLASTIC PAVEMENT MARKING - LETTERS AND SYMBOLS	SO FT	830	830				
40603595	POLYMERIZED HOT-MIX ASPHALT SURFACE COURSE, MIX "F", N90	TON	7560	7560					* 78000200	THERMOPLASTIC PAVEMENT MARKING - LINE 4"	FOOT	43615	43615				
42001300	PROTECTIVE COAT	SO YD	10	10					* 78000400	THERMOPLASTIC PAVEMENT MARKING - LINE 6"	FOOT	4630	4630				
44000159	HOT-MIX ASPHALT SURFACE REMOVAL, 2 1/2"	SO YD	77110	77110					* 78000500	THERMOPLASTIC PAVEMENT MARKING - LINE 8"	FOOT	470	470				
44001700	COMBINATION CONCRETE CURB AND GUTTER REMOVAL AND REPLACEMENT	FOOT	400	400					* 78000600	THERMOPLASTIC PAVEMENT MARKING - LINE 12"	FOOT	1680	1680				
44201789	CLASS D PATCHES, TYPE II, 12 INCH	SO YD	355	355					* 78000650	THERMOPLASTIC PAVEMENT MARKING - LINE 24"	FOOT	650	650				
44201794	CLASS D PATCHES, TYPE III, 12 INCH	SO YD	160	160					* 78100100	RAISED REFLECTIVE PAVEMENT MARKER	EACH	1060	1060				
44201796	CLASS D PATCHES, TYPE IV, 12 INCH	SO YD	900	900					78300200	RAISED REFLECTIVE PAVEMENT MARKER REMOVAL	EACH	1010	1010				
48102100	AGGREGATE WEDGE SHOULDER, TYPE B	TON	170	170					* 88600600	DETECTOR LOOP REPLACEMENT	FOOT	4287	4287				
NP 55039700	STORM SEWERS TO BE CLEANED	FOOT	500	500					X0322256	TEMPORARY INFORMATION SIGNING	SO FT	51.4	51.4				
60250200	CATCH BASINS TO BE ADJUSTED	EACH	5	5					X4067107	POLYMERIZED LEVELING BINDER (MACHINE METHOD), IL-4.75, N50	TON	3040	3040				
60252800	CATCH BASINS TO BE RECONSTRUCTED	EACH	5	5					NP Z0018500	DRAINAGE STRUCTURES TO BE CLEANED	EACH	52	52				
60260100	INLETS TO BE ADJUSTED	EACH	5	5					Z0048665	RAILROAD PROTECTIVE LIABILITY INSURANCE	L SUM	1	1				
60262700	INLETS TO BE RECONSTRUCTED	EACH	5	5					© 20070600	TRAINEES	HOUR	500	500				
60300105	FRAMES AND GRATES TO BE ADJUSTED	EACH	10	10													
60300310	FRAMES AND LIDS TO BE ADJUSTED (SPECIAL)	EACH	15	15													
60404940	FRAMES AND GRATES, TYPE 23	EACH	6	6													
60404950	FRAMES AND GRATES, TYPE 24	EACH	10	10													
60406100	FRAMES AND LIDS, TYPE 1, CLOSED LID	EACH	2	2													
67000400	ENGINEER'S FIELD OFFICE, TYPE A	CAL MO	6	6													
67100100	MOBILIZATION	L SUM	1	1													
70100450	TRAFFIC CONTROL AND PROTECTION, STANDARD 701201	L SUM	1	1													
△ 70102622	TRAFFIC CONTROL AND PROTECTION, STANDARD 701602	L SUM	1	1													
70102635	TRAFFIC CONTROL AND PROTECTION, STANDARD 701701	L SUM	1	1													
70300100	SHORT-TERM PAVEMENT MARKING	FOOT	16950	16950													
70300210	TEMPORARY PAVEMENT MARKING - LETTERS AND SYMBOLS	SO FT	830	830													

Rev. B-26-09

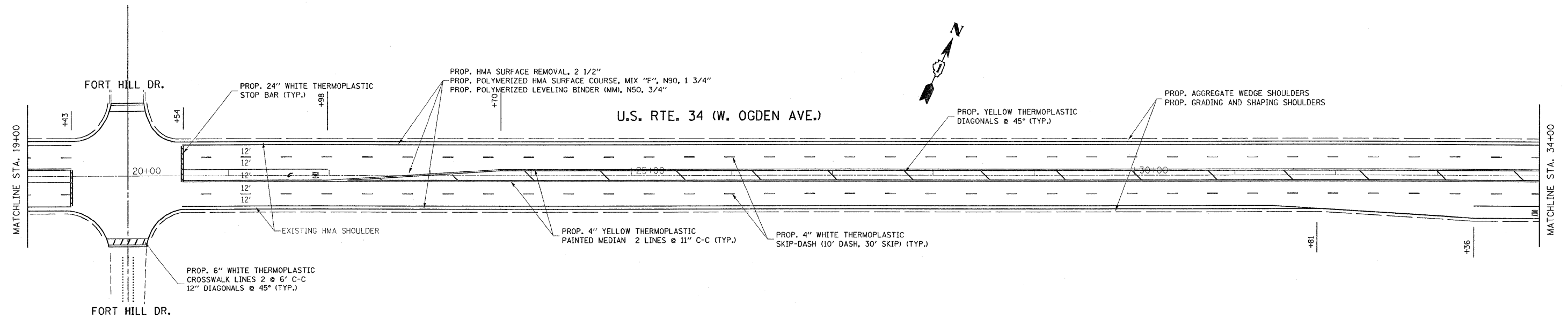
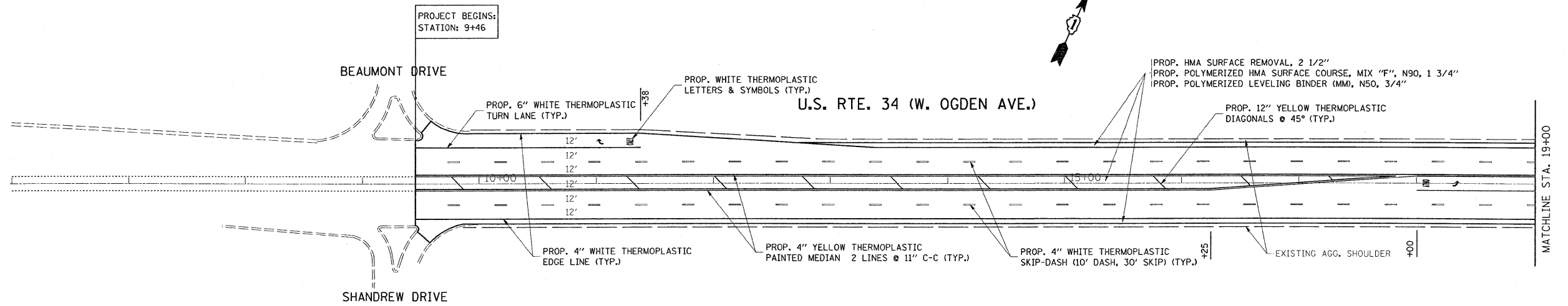

FILE NAME =	USER NAME = smthkl	DESIGNED -	REVISED - 8/5/09 K.S.	STATE OF ILLINOIS DEPARTMENT OF TRANSPORTATION	U.S. ROUTE 34 BEAUMONT DR. TO RAYMOND DR.			F.A.P. RTE.	SECTION	COUNTY	TOTAL SHEETS	SHEET NO.			
ca:\pwwork\pwwork\smthkl\d0142804\0176299-shd-plan.dgn		DRAWN -	REVISED -		SCALE:	SHEET NO.	OF	SHEETS	STA.	TO STA.	311	652 (X & X-1) RS-5	DUPAGE	27	6
PLOT SCALE = 50,000 / IN.		CHECKED -	REVISED -		CONTRACT NO. 60H64										
PLOT DATE = 8/4/2009		DATE -	REVISED -		ILLINOIS FED. AID PROJECT										

Rev. Sheet 8-26-09

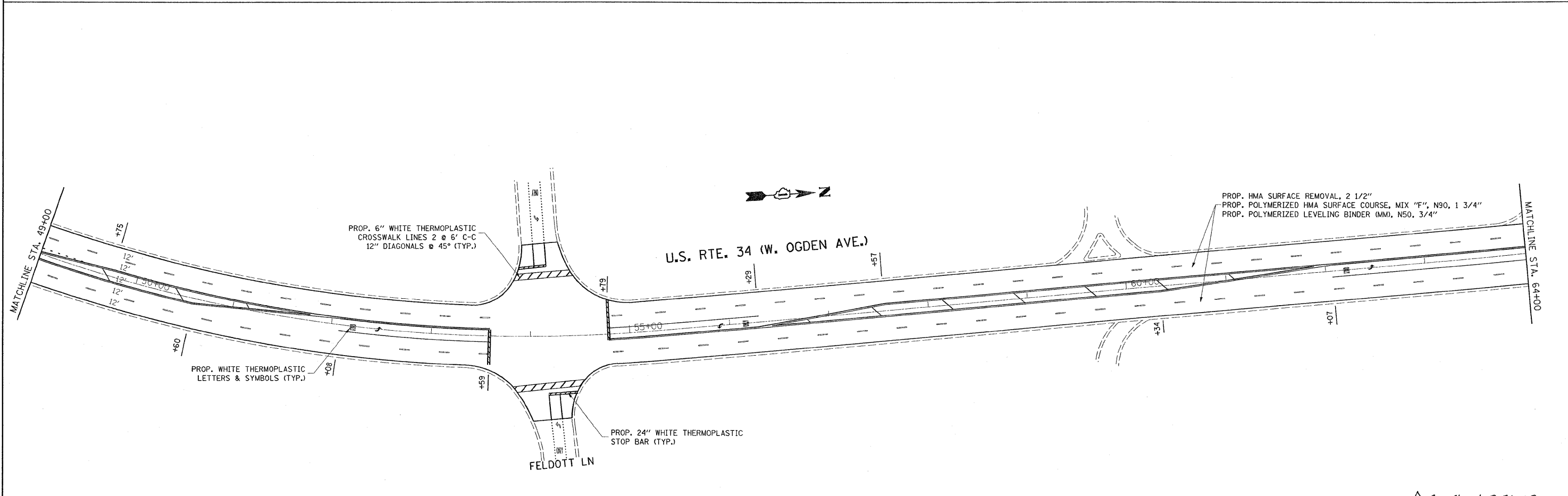
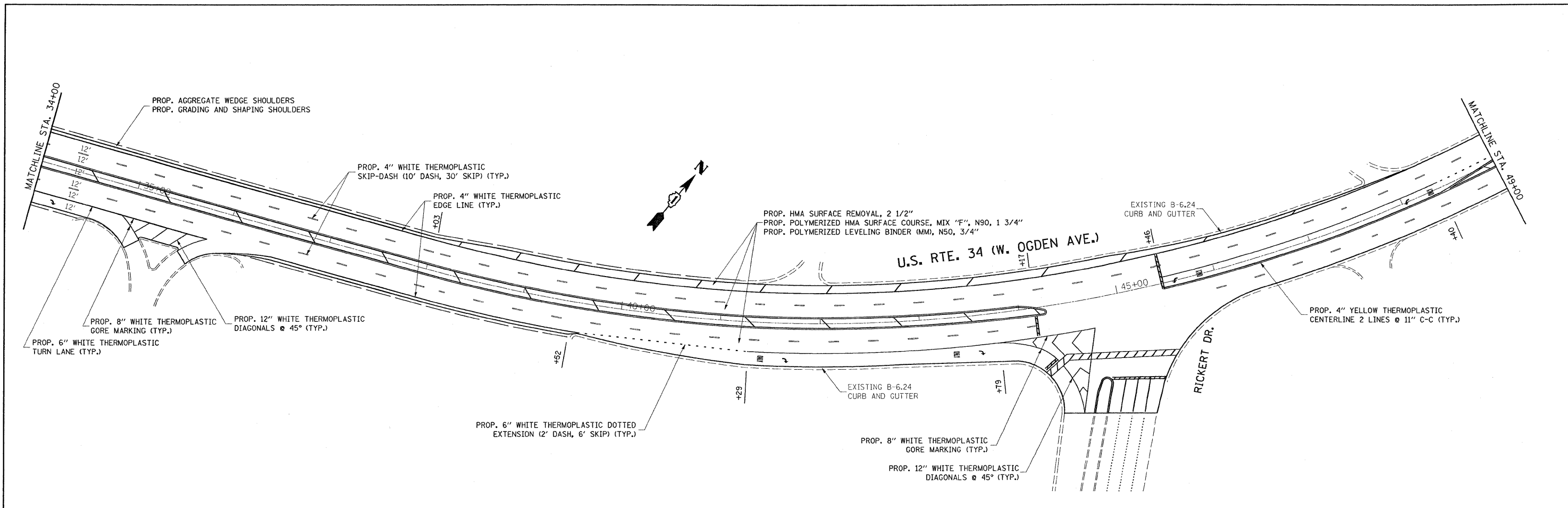

FILE NAME =		USER NAME = smthkl	DESIGNED -	REVISED - 8/5/09 K.S.	STATE OF ILLINOIS DEPARTMENT OF TRANSPORTATION	U.S. ROUTE 34 BEAUMONT DR. TO RAYMOND DR.		F.A.P. RTE.	SECTION	COUNTY	TOTAL SHEETS	SHEET NO.
DRAWN -		CHECKED -	DATE -	REVISED -		311	652 (X & X-1) RS-5	DUPAGE	27	7		
PLOT SCALE = 50,000' / IN.		DATE -	REVISED -	REVISED -		CONTRACT NO. 60H64			ILLINOIS FED. AID PROJECT			
PLOT DATE = 8/4/2009		DATE -	REVISED -	REVISED -		SCALE: SHEET NO. OF SHEETS STA. TO STA.						

Rev-Sheet 8-26-09

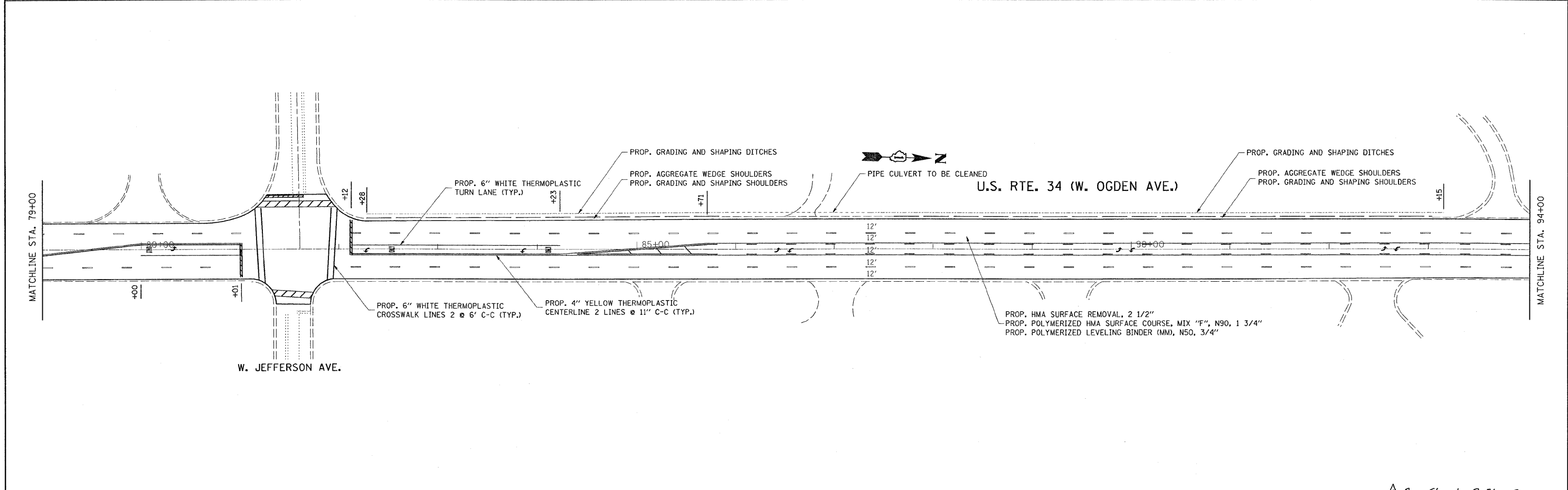
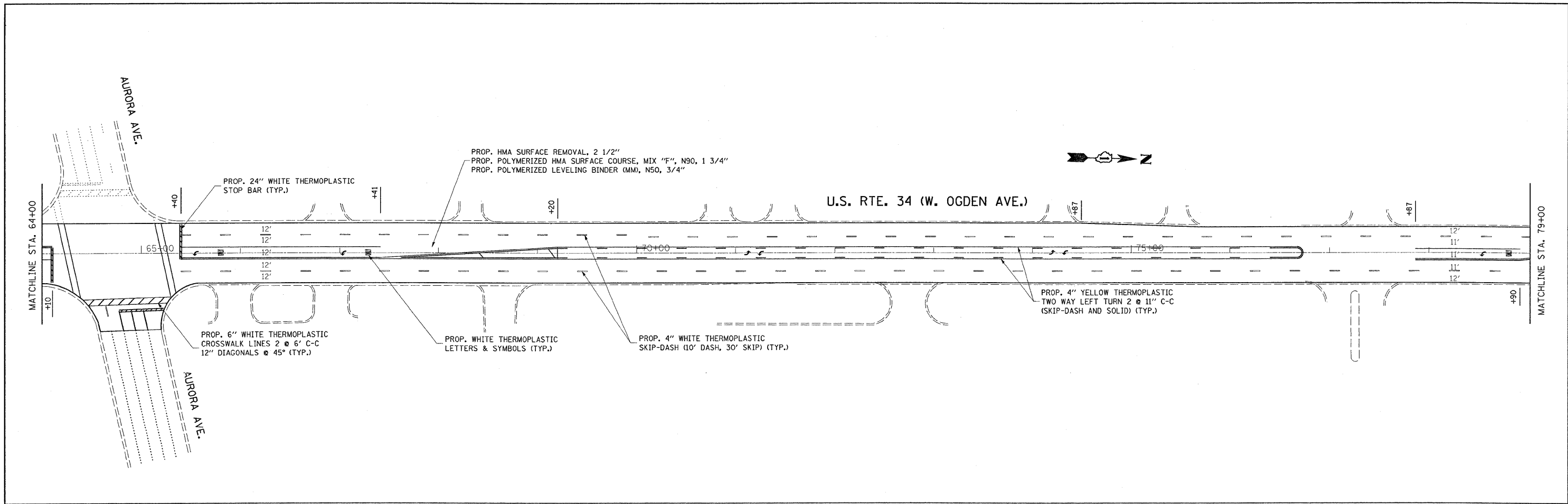

FILE NAME =	USER NAME = smsthkl	DESIGNED -	REVISED - 8/5/09 K.S.	STATE OF ILLINOIS DEPARTMENT OF TRANSPORTATION	U.S. ROUTE 34 BEAUMONT DR. TO RAYMOND DR.	F.A.P. RTE.	SECTION	COUNTY	TOTAL SHEETS	SHEET NO.	
ct:\pwwork\pwwork\smsthkl\08142884\0176291-shr-plan.dgn	PLOT SCALE = 50.0000' / IN.	DRAWN -	REVISED -			311	652 (X & X-1) RS-5	DUPAGE	27	8	
PLOT DATE = 8/4/2009	DATE -	CHECKED -	REVISED -			CONTRACT NO. 60H64					
		DATE -	REVISED -			ILLINOIS FED. AID PROJECT					

Rev. Sheet 8-26-09

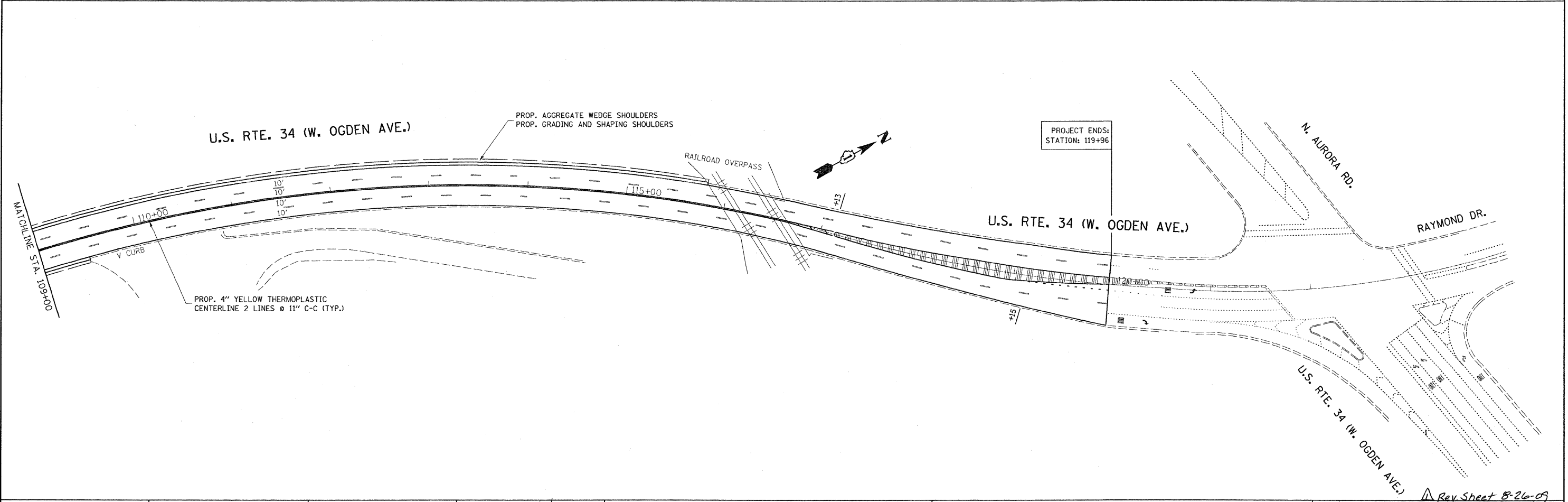
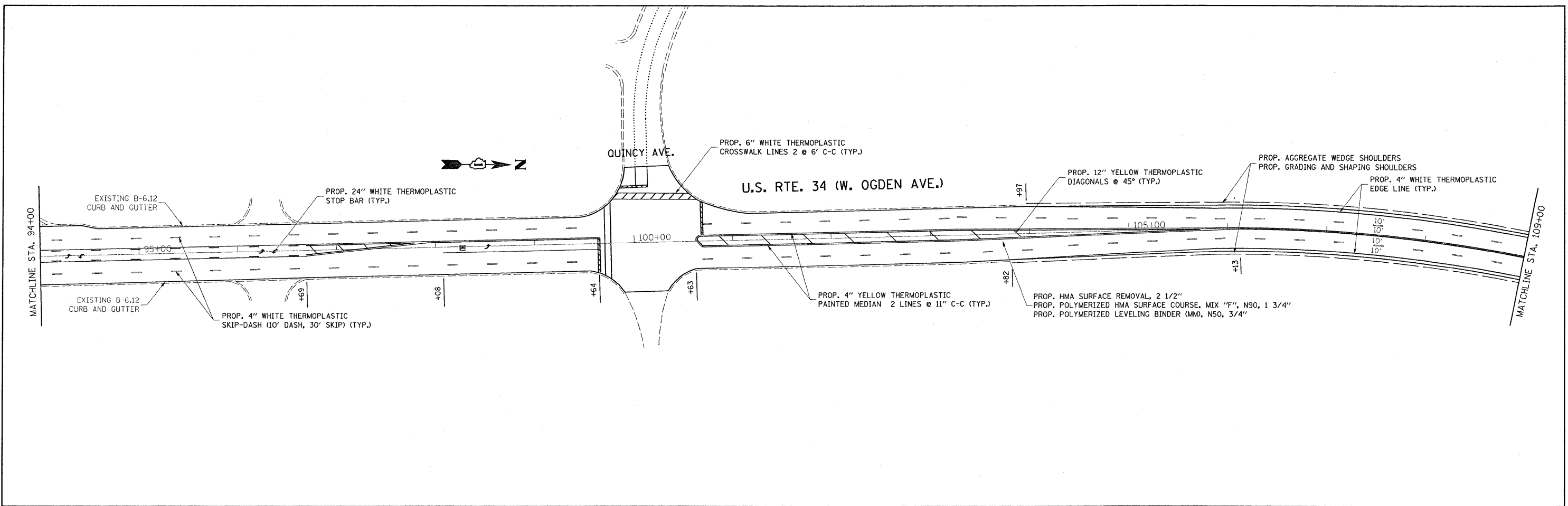

FILE NAME =	USER NAME = smthkl	DESIGNED -	REVISED - 8/5/09 K.S.	STATE OF ILLINOIS DEPARTMENT OF TRANSPORTATION	U.S. ROUTE 34 BEAUMONT DR. TO RAYMOND DR.			F.A.P. RTE. 311	SECTION 652 (X & X-1) RS-5	COUNTY DUPAGE	TOTAL SHEETS 27	SHEET NO. 9	
CONTRACT NO. 60H64	PLOT SCALE = 50.0000' / IN.	DRAWN -	REVISED -		SCALE:	SHEET NO. OF SHEETS	STA. TO STA.	ILLINOIS FED. AID PROJECT					
	PLOT DATE = 8/4/2009	CHECKED -	REVISED -										
		DATE -	REVISED -										

Rev Sheet 8-26-09