

**TRAFFIC SIGNAL LEGEND**

	PROPOSED	EXISTING
DETECTOR LOOP		
SIGNAL HEAD		
G.S. CONDUIT IN TRENCH OR PUSHED		
SIGNAL HEAD WITH BACKPLATE		
RACEWAY FOR MAGNETIC DETECTOR, TYPE I OR II		
VEHICLE DETECTOR, NON-COMPENSATED MAGNETIC TYPE		

North

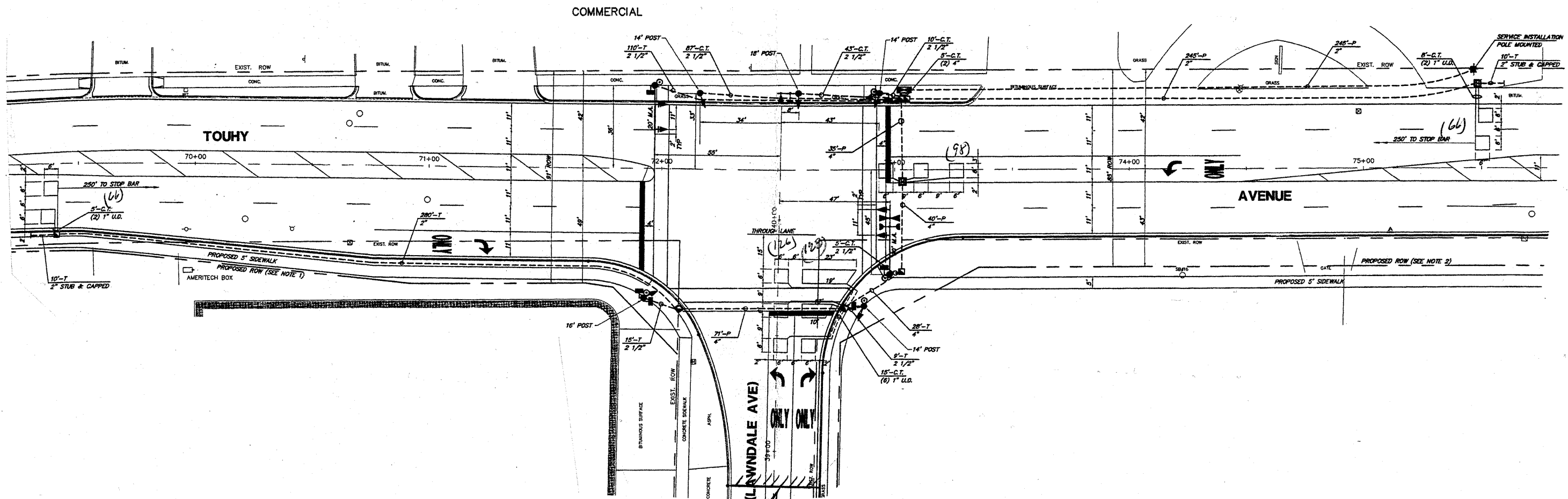

THIS PLAN IS FOR THE SOLE PURPOSE OF DETECTOR LOOP REPLACEMENTS ONLY

REPLACE ALL DETECTOR LOOPS AS SHOWN (WITHIN THE RESURFACING LIMITS)

CODE	QUANTITY	UNIT	ITEM
86600600	484	FOOT	DETECTOR LOOP, REPLACEMENT

FILE NAME =	USER NAME = kanthaphixkeybc	DESIGNED - BCK	REVISED -	<b>STATE OF ILLINOIS DEPARTMENT OF TRANSPORTATION</b>	<b>DISTRICT ONE - DETECTOR LOOP REPLACEMENT TOUHY AVE. @ LAWNDALE AVE.</b>	F.A.H. RTE. 1340	SECTION 2009-063 RS	COUNTY Cook	TOTAL SHEETS 21	SHEET NO. 10	
ot:\pwwork\p\1001\KANTHAPHIXAYBC\d01126	4\traffic.legend.v7.dgn	DRAWN - BCK	REVISED -			SCALE: NONE	SHEET NO. OF SHEETS STA. TO STA.	FED. ROAD DIST. NO.	ILLINOIS FED. AID PROJECT	CONTRACT NO. 60466	
	PLOT SCALE = 3/8" = 1' IN.	CHECKED - OAD	REVISED -								
	PLOT DATE = 4/3/2009	DATE -	REVISED -								