

**LEGEND**

- |  |   |   |
|--|---|---|
| 1 THERMOPLASTIC PAVEMENT MARKING - LINE 4" YELLOW SOLID                              | 5 THERMOPLASTIC PAVEMENT MARKING - LINE 6" WHITE 2' DASH, 6' SKIP                               | 9 THERMOPLASTIC PAVEMENT MARKING - LINE 12" WHITE @ 45 DEGREE |
| 2 THERMOPLASTIC PAVEMENT MARKING - LINE 4" WHITE SOLID                               | 6 THERMOPLASTIC PAVEMENT MARKING - LINE 12" YELLOW @ 45 DEGREE                                  | 10 THERMOPLASTIC PAVEMENT MARKING - LETTERS & SYMBOLS         |
| 3 THERMOPLASTIC PAVEMENT MARKING - LINE 4" YELLOW SKIP DASH - 10' DASH, 30' SKIP     | 7 THERMOPLASTIC PAVEMENT MARKING - LINE 6" WHITE  | 11 THERMOPLASTIC PAVEMENT MARKING - LINE 24" WHITE            |
| 4 THERMOPLASTIC PAVEMENT MARKING - LINE 4" YELLOW, 2 @ 11" C-C W/2 AMBER 2 WAY RPM'S | 8 THERMOPLASTIC PAVEMENT MARKING - LINE 4" (WHITE 10' DASH, 30' SKIP W/ 2 CRYSTAL/OPAQUE RPM'S) | 12 THERMOPLASTIC PAVEMENT MARKING - LINE 8" WHITE             |

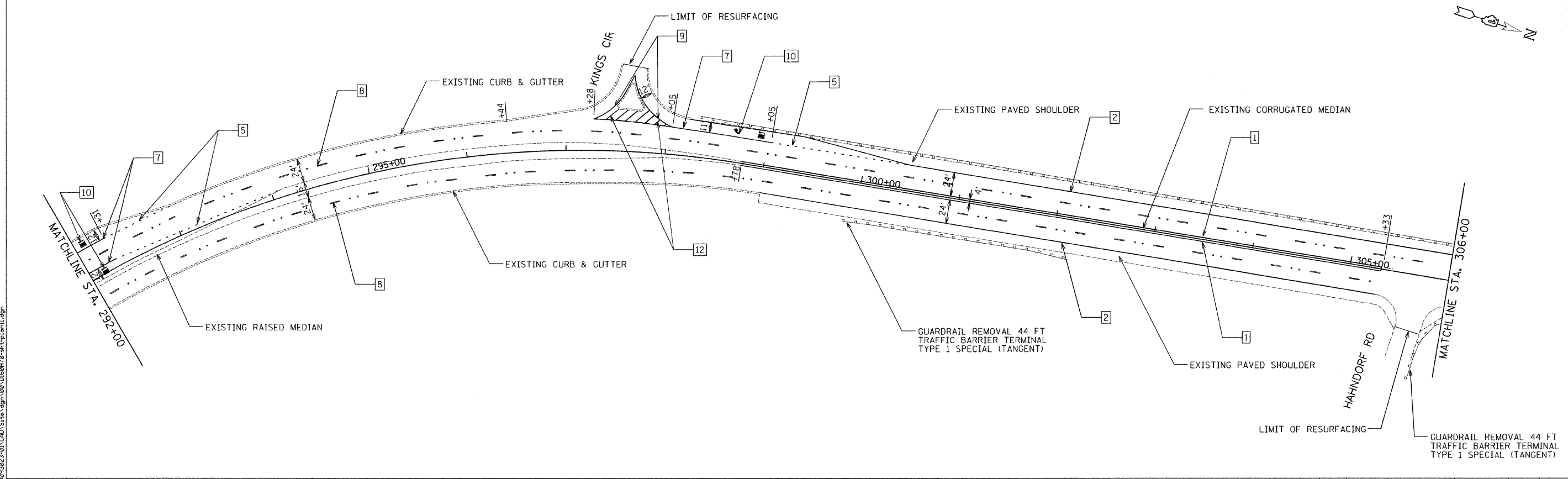

FILE NAME =  
 USER NAME = USER  
 PLOT SCALE = 50.0000' / IN.  
 PLOT DATE = 6/24/2009

DESIGNED -	REVISED -
DRAWN -	REVISED -
CHECKED -	REVISED -
DATE -	REVISED -

**STATE OF ILLINOIS  
 DEPARTMENT OF TRANSPORTATION**

**IL 59 - IL 64 TO BATAVIA ROAD  
 ROADWAY AND PAVEMENT MARKING PLANS**  
 SCALE: 50 SHEET NO. 11 OF 13 SHEETS STA. 278+00 TO STA. 306+00

F.A.P. RTE.	SECTION	COUNTY	TOTAL SHEETS	SHEET NO.
338	(111 & 112) RS-8	DUPAGE	42	18
CONTRACT NO. 60H70				
ILLINOIS FED. AID PROJECT				