

IL. 7 (LARKIN AVE)

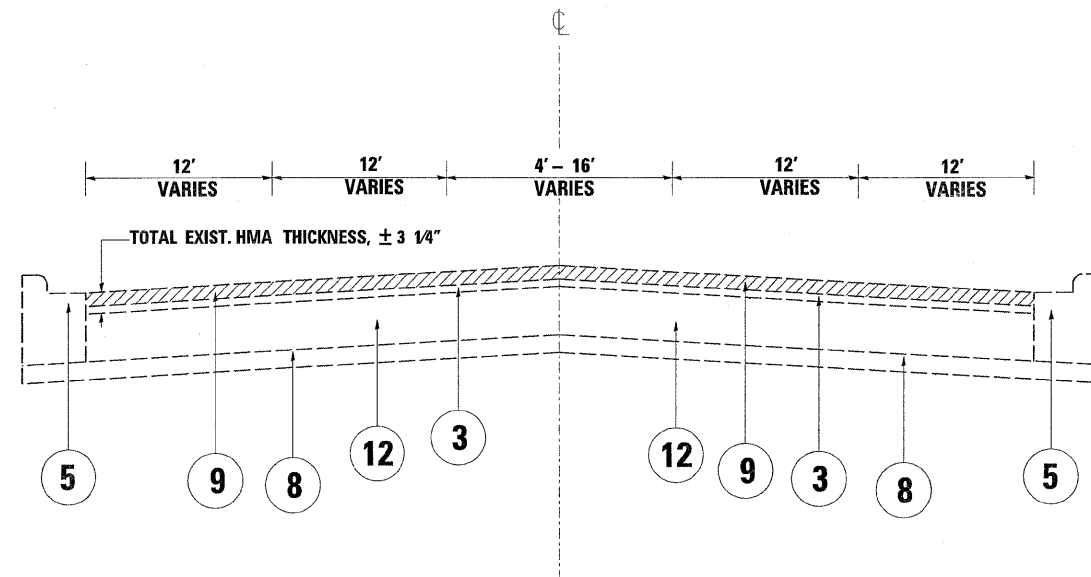

EXIST. TYPICAL SECTION

IL. 7  
STA. 127+00 TO 149+37

IL. 7 (LARKIN AVE)

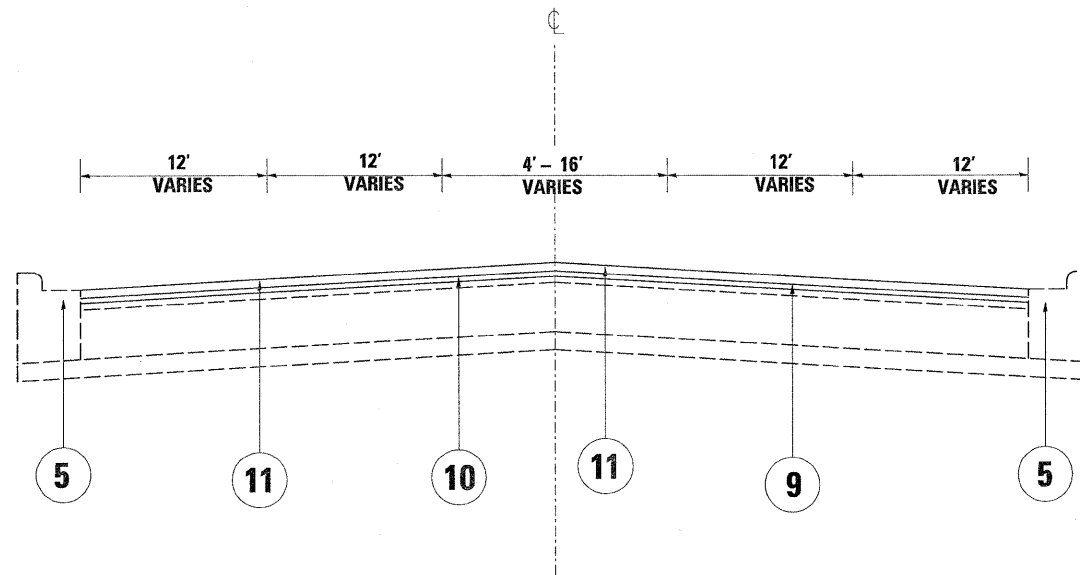

PROP. TYPICAL SECTION

IL. 7  
STA. 127+00 TO 149+37

**LEGEND**

- ① EXISTING PCC BASE COURSE, ± 9"
- ② EXISTING PCC BASE COURSE, ± 9"
- ③ EXISTING HOT-MIX ASPHALT AFTER MILLING, ± 3/4"
- ④ EXISTING HOT-MIX ASPHALT AFTER MILLING, ± 4 3/4"
- ⑤ EXISTING COMB. CURB AND GUTTER
- ⑥ EXISTING PCC BASE
- ⑦ EXISTING BARRIER MEDIAN
- ⑧ EXISTING SUB-BASE GRANULAR MATERIAL
- ⑨ PROP. HMA SURFACE REMOVAL, 2 1/2"
- ⑩ PROP. POLY. LEVELING BINDER (MACHINE METHOD), IL-4.75, N50, 3/4"
- ⑪ PROP. POLY. HOT-MIX ASPHALT SURFACE COURSE, MIX "F", N90, 1 3/4"
- ⑫ EXISTING PCC BASE COURSE, ± 10"

**NOTE:**

THE CONTRACTOR SHALL PATCH FIRST BEFORE MILLING

FILE NAME =	USER NAME = estunoblek	DESIGNED -	REVISED -	<b>STATE OF ILLINOIS DEPARTMENT OF TRANSPORTATION</b>	<b>IL 7 (LARKIN AVE.) [HILLCREST SHOPPING CENTER TO MCDONOUGH] EXISTING AND PROPOSED TYPICAL SECTIONS</b>	F.A.P. RTE.	SECTION	COUNTY	TOTAL SHEETS	SHEET NO.
ca\pwwork\VPW1001\ESTIMABLE\K\d0145897\178209-shr-plan.dgn	PLDT SCALE = 50.0000' / IN.	DRAWN -	REVISED -			856	28X-3 RS-1	WILL	28	6
PLDT DATE = 6/25/2009	DATE -	CHECKED -	REVISED -			SCALE: SHEET NO. 3 OF 3 SHEETS STA. 127+00 TO STA. 149+37		CONTRACT NO. 60H74		
						ILLINOIS FED. AID PROJECT				