

TRAFFIC SIGNAL LEGEND

	PROPOSED	EXISTING
DETECTOR LOOP	□	□
SIGNAL HEAD	—	→
G.S. CONDUIT IN TRENCH OR PUSHED	---	---
SIGNAL HEAD WITH BACKPLATE	—	→
RACEWAY FOR MAGNETIC DETECTOR, TYPE I OR II	—	→
VEHICLE DETECTOR, NON-COMPENSATED MAGNETIC TYPE	—	→

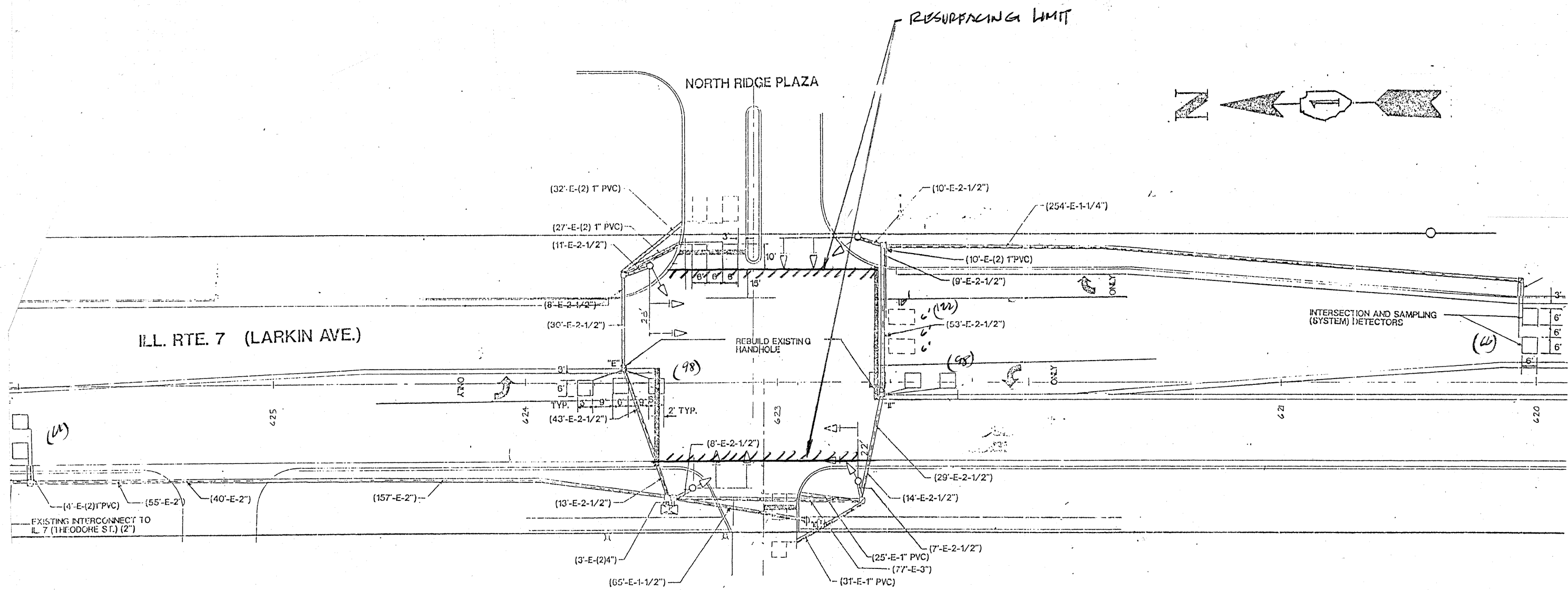

THIS PLAN IS FOR THE SOLE PURPOSE OF DETECTOR LOOP REPLACEMENTS ONLY

REPLACE ALL DETECTOR LOOPS AS SHOWN (WITHIN THE RESURFACING LIMITS)

CODE	QUANTITY	UNIT	ITEM
86600600	450	FOOT	DETECTOR LOOP, REPLACEMENT

STATE OF ILLINOIS
DEPARTMENT OF TRANSPORTATION

DISTRICT ONE - DETECTOR LOOP REPLACEMENT
ILL. ROUTE 7 @ N. RIDGE PLAZA

FILE NAME =	USER NAME = kanthaphixaybc	DESIGNED - BCK	REVISED -	DISTRICT ONE - DETECTOR LOOP REPLACEMENT ILL. ROUTE 7 @ N. RIDGE PLAZA SCALE: NONE SHEET NO. 2 OF 7 SHEETS STA. TO STA.	F.A.P. RTE.	SECTION	COUNTY	TOTAL SHEETS	SHEET NO.	
cd:\pwork\pwork\WIDOT\KANTHAPHIXAYBC\01126	4\tr\ofic\legend.v7.dgn	DRAWN - BCK	REVISED -		856	28X-3	45-1	will	28	13
	PLOT SCALE = 3/4" = 1' IN.	CHECKED - DAD	REVISED -		CONTRACT NO.					
	PLOT DATE = 4/3/2009	DATE -	REVISED -		FED. ROAD DIST. NO. [ILLINOIS] FED. AID PROJECT					