

TRAFFIC SIGNAL LEGEND

	PROPOSED	EXISTING
DETECTOR LOOP		
SIGNAL HEAD		
G.S. CONDUIT IN TRENCH OR PUSHED		
SIGNAL HEAD WITH BACKPLATE		
RACEWAY FOR MAGNETIC DETECTOR, TYPE I OR II		
VEHICLE DETECTOR, NON-COMPENSATED MAGNETIC TYPE		

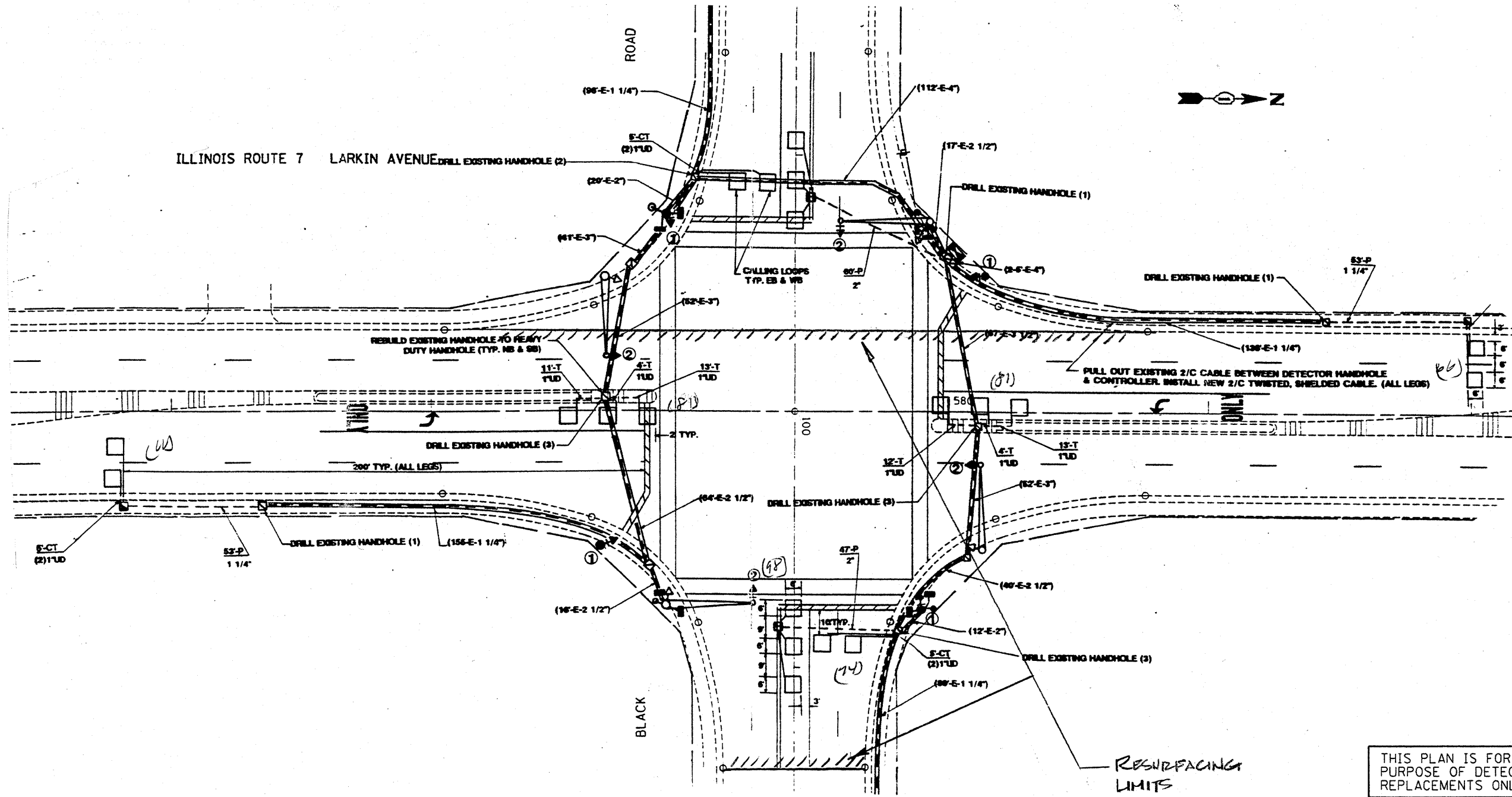

THIS PLAN IS FOR THE SOLE PURPOSE OF DETECTOR LOOP REPLACEMENTS ONLY

REPLACE ALL DETECTOR LOOPS AS SHOWN (WITHIN THE RESURFACING LIMITS)

CODE	QUANTITY	UNIT	ITEM
86600600	466	FOOT	DETECTOR LOOP, REPLACEMENT

FILE NAME =	USER NAME = kanthaphixaybc	DESIGNED - BCK	REVISED -	STATE OF ILLINOIS DEPARTMENT OF TRANSPORTATION	DISTRICT ONE - DETECTOR LOOP REPLACEMENT ILL. ROUTE 7 @ BLACK ROAD	F.A. RTE. =	SECTION =	COUNTY =	TOTAL SHEETS =	SHEET NO. =	
es:\p\work\PIWIDOT\KANTHAPHIXAYBC\d01126	4\traffic\legend.v7.dgn	DRAWN - BCK	REVISED -			856	28A-3	RS-1	will	28	16
PLOT SCALE = 39.9368' / 1" IN.	CHECKED - DAD	REVISED -	REVISED -			CONTRACT NO.					
PLOT DATE = 4/3/2009	DATE -	REVISED -	REVISED -			FED. ROAD DIST. NO. ILLINOIS FED. AID PROJECT					