

**EXISTING EQUIPMENT TO BE REMOVED**

- ◀ EXISTING TRAFFIC SIGNAL HEAD TO BE REMOVED
- "E" ■ EXISTING SERVICE INSTALLATION TO BE REMOVED
- "E" ○ EXISTING SIGNAL POST AND FOUNDATION TO BE REMOVED
- ◀ EXISTING ALUMINUM MAST ARM POLE AND FOUNDATION TO BE REMOVED
- ⊠ EXISTING CONTROLLER AND FOUNDATION TO BE REMOVED
- "E" □ EXISTING HANDHOLE TO BE REMOVED
- EXISTING PEDESTRIAN SIGNAL HEAD TO BE REMOVED
- EXISTING PEDESTRIAN PUSHBUTTON TO BE REMOVED
- ▶ EXISTING EMERGENCY VEHICLE LIGHT DETECTOR TO BE REMOVED
- ◀ EXISTING CONFIRMATION BEACON TO BE REMOVED
- "E" ■ EXISTING HEAVY-DUTY HANDHOLE TO BE REMOVED
- ◀ EXISTING STEEL MAST ARM POLE AND FOUNDATION TO BE REMOVED
- ▨ SIDEWALK TO BE REMOVED
- ▨ BRICK PAVER REMOVAL
- ▨ COMBINATION CURB AND GUTTER REMOVAL

**Restoration of Work Area.** Restoration of the traffic signal work area shall be incidental to the related pay items such as foundation, conduit, handhole, trench and backfill, etc., and no extra compensation shall be allowed. All roadway surfaces such as shoulders, medians, sidewalks, pavement, etc. shall be replaced in kind. All damage to mowed lawns shall be replaced with an approved sod, and all damage to unmowed fields shall be seeded in accordance with Standard Specifications 252 and 250 respectively.

NOTE:  
THE EXISTING CONTROLLER IS AN EAGLE EPAC 300 IN AN IDOT TYPE IV CABINET (IDOT SYSTEM 2K)

**NOTES FOR TEMPORARY TRAFFIC SIGNALS**

1. ALL CONTROL EQUIPMENT INCLUDING EMERGENCY PRE-EMPTION AND COMMUNICATION DEVICES FOR THE TEMPORARY TRAFFIC SIGNAL(S) SHALL BE FURNISHED BY THE CONTRACTOR.
2. ONLY CONTROLLERS SUPPLIED BY ONE OF THE DISTRICT APPROVED CLOSED LOOP EQUIPMENT MANUFACTURERS WILL BE APPROVED FOR USE AT TEMPORARY SIGNAL LOCATIONS. ALL CONTROLLERS USED FOR TEMPORARY TRAFFIC SIGNALS SHALL BE FULLY ACTUATED NEMA MICROPROCESSOR BASED WITH RS232 DATA ENTRY PORTS COMPATIBLE WITH EXISTING MONITORING SOFTWARE APPROVED BY IDOT DISTRICT 1, INSTALLED IN A NEMA TS1 OR TS2 CABINET. ONLY ONE BRAND OF CONTROLLER WILL BE ACCEPTED FOR ANY ONE CONTRACT.
3. ALL TRAFFIC SIGNAL SECTIONS AND PEDESTRIAN SIGNAL SECTIONS SHALL BE 12". HEADS SHALL BE PLACED AS INDICATED ON THE TEMPORARY TRAFFIC SIGNAL PLAN OR AS DIRECTED BY THE ENGINEER. THE CONTRACTOR SHALL FURNISH ENOUGH CABLE SLACK TO RELOCATE HEADS TO ANY POSITION ON THE SPAN WIRE OR AT LOCATIONS ILLUSTRATED ON THE PLANS FOR CONSTRUCTION STAGING. THE TEMPORARY TRAFFIC SIGNAL SHALL REMAIN IN OPERATION DURING ALL SIGNAL HEAD RELOCATIONS. EACH TEMPORARY TRAFFIC SIGNAL HEAD SHALL HAVE ITS OWN CABLE FROM THE CONTROLLER CABINET TO THE SIGNAL HEAD.
4. ALL EXISTING STREET NAME AND INTERSECTION REGULATORY SIGNS SHALL BE REMOVED FROM EXISTING POLES, RELOCATED AND SECURELY FASTENED TO THE SIGNAL SPAN WIRE OR WOOD POLE AS DIRECTED BY THE ENGINEER.
5. ANY TEMPORARY SIGNAL WITHIN AN EXISTING CLOSED LOOP TRAFFIC SIGNAL SYSTEM SHALL BE INTERCONNECTED TO THAT SYSTEM USING SIMILAR BRAND CONTROL EQUIPMENT.
6. THE TEMPORARY TRAFFIC SIGNAL SHALL HAVE THE SIGNAL HEAD DISPLAYS, SIGNAL HEAD PLACEMENTS AND CONTROLLER PHASING MATCH THE EXISTING TRAFFIC SIGNAL, AT THE TIME OF THE TURN ON, IF NO TRAFFIC STAGING IS IN PLACE OR WILL NOT BE STAGED ON THE DAY OF THE TURN ON.

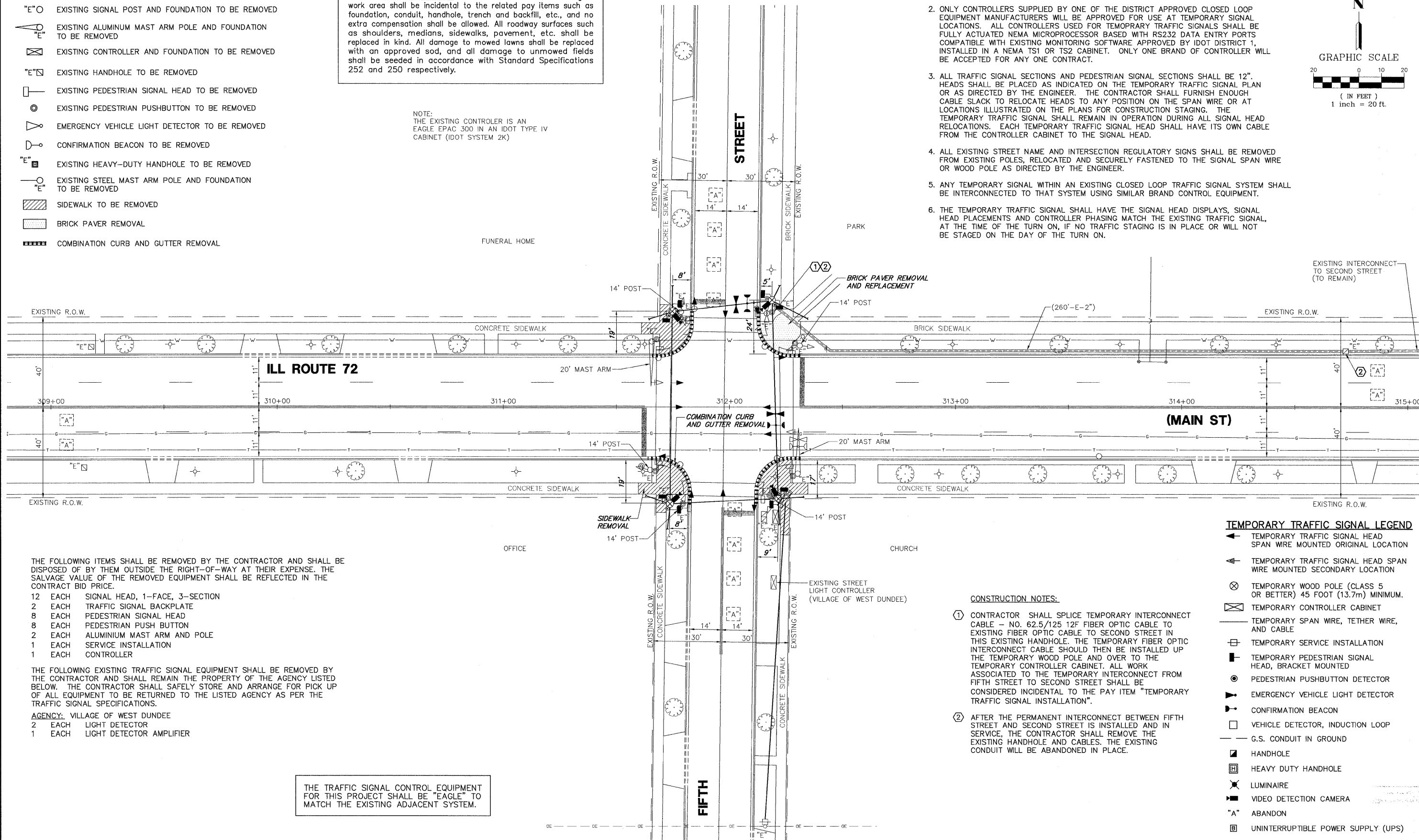
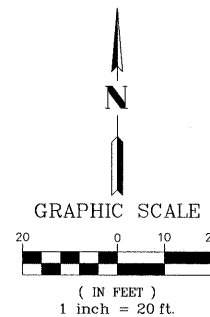

THE FOLLOWING ITEMS SHALL BE REMOVED BY THE CONTRACTOR AND SHALL BE DISPOSED OF BY THEM OUTSIDE THE RIGHT-OF-WAY AT THEIR EXPENSE. THE SALVAGE VALUE OF THE REMOVED EQUIPMENT SHALL BE REFLECTED IN THE CONTRACT BID PRICE.

- 12 EACH SIGNAL HEAD, 1-FACE, 3-SECTION
- 2 EACH TRAFFIC SIGNAL BACKPLATE
- 8 EACH PEDESTRIAN SIGNAL HEAD
- 8 EACH PEDESTRIAN PUSH BUTTON
- 2 EACH ALUMINIUM MAST ARM AND POLE
- 1 EACH SERVICE INSTALLATION
- 1 EACH CONTROLLER

THE FOLLOWING EXISTING TRAFFIC SIGNAL EQUIPMENT SHALL BE REMOVED BY THE CONTRACTOR AND SHALL REMAIN THE PROPERTY OF THE AGENCY LISTED BELOW. THE CONTRACTOR SHALL SAFELY STORE AND ARRANGE FOR PICK UP OF ALL EQUIPMENT TO BE RETURNED TO THE LISTED AGENCY AS PER THE TRAFFIC SIGNAL SPECIFICATIONS.

- AGENCY: VILLAGE OF WEST DUNDEE
- 2 EACH LIGHT DETECTOR
  - 1 EACH LIGHT DETECTOR AMPLIFIER

THE TRAFFIC SIGNAL CONTROL EQUIPMENT FOR THIS PROJECT SHALL BE "EAGLE" TO MATCH THE EXISTING ADJACENT SYSTEM.

**TEMPORARY TRAFFIC SIGNAL LEGEND**

- ◀ TEMPORARY TRAFFIC SIGNAL HEAD SPAN WIRE MOUNTED ORIGINAL LOCATION
- ◀ TEMPORARY TRAFFIC SIGNAL HEAD SPAN WIRE MOUNTED SECONDARY LOCATION
- ⊗ TEMPORARY WOOD POLE (CLASS 5 OR BETTER) 45 FOOT (13.7m) MINIMUM.
- ⊠ TEMPORARY CONTROLLER CABINET
- TEMPORARY SPAN WIRE, TETHER WIRE, AND CABLE
- TEMPORARY SERVICE INSTALLATION
- TEMPORARY PEDESTRIAN SIGNAL HEAD, BRACKET MOUNTED
- PEDESTRIAN PUSHBUTTON DETECTOR
- ▶ EMERGENCY VEHICLE LIGHT DETECTOR
- ◀ CONFIRMATION BEACON
- VEHICLE DETECTOR, INDUCTION LOOP
- G.S. CONDUIT IN GROUND
- ◻ HANDHOLE
- ◻ HEAVY DUTY HANDHOLE
- ⊗ LUMINAIRE
- VIDEO DETECTION CAMERA
- "A" ABANDON
- ◻ UNINTERRUPTIBLE POWER SUPPLY (UPS)

**CONSTRUCTION NOTES:**

- ① CONTRACTOR SHALL SPLICE TEMPORARY INTERCONNECT CABLE - NO. 62.5/125 12F FIBER OPTIC CABLE TO EXISTING FIBER OPTIC CABLE TO SECOND STREET IN THIS EXISTING HANDHOLE. THE TEMPORARY FIBER OPTIC INTERCONNECT CABLE SHOULD THEN BE INSTALLED UP THE TEMPORARY WOOD POLE AND OVER TO THE TEMPORARY CONTROLLER CABINET. ALL WORK ASSOCIATED TO THE TEMPORARY INTERCONNECT FROM FIFTH STREET TO SECOND STREET SHALL BE CONSIDERED INCIDENTAL TO THE PAY ITEM "TEMPORARY TRAFFIC SIGNAL INSTALLATION".
- ② AFTER THE PERMANENT INTERCONNECT BETWEEN FIFTH STREET AND SECOND STREET IS INSTALLED AND IN SERVICE, THE CONTRACTOR SHALL REMOVE THE EXISTING HANDHOLE AND CABLES. THE EXISTING CONDUIT WILL BE ABANDONED IN PLACE.

|                                 |                  |                |           |   |  |                           |                          |                |                       |                   |  |  |
|---------------------------------|------------------|----------------|-----------|---|--|---------------------------|--------------------------|----------------|-----------------------|-------------------|--|--|
| FILE NAME =<br>4085.850-TR1.dwg | USER NAME =      | DESIGNED - JRD | REVISED - | <b>STATE OF ILLINOIS<br/>DEPARTMENT OF TRANSPORTATION</b> | <b>TEMPORARY TRAFFIC SIGNAL INSTALLATION PLAN AND<br/>REMOVAL OF EXISTING TRAFFIC SIGNAL EQUIPMENT<br/>ILL ROUTE 72 (MAIN ST) AND FIFTH STREET</b> | F.A.P.<br>RTE. 341        | SECTION<br>2009-081TS    | COUNTY<br>KANE | TOTAL<br>SHEETS<br>13 | SHEET<br>NO.<br>7 |  |  |
| PLOT SCALE =                    | DATE - 6-24-2009 | DRAWN - PJS    | REVISED - |   |  | SCALE: 1"=20'             | SHEET NO. 7 OF 13 SHEETS | STA.           | TO STA.               | CONTRACT # 60120  |  |  |
| CHECKED - KLB                   |                  | CHECKED -      | REVISED - |   |  | ILLINOIS FED. AID PROJECT |                          |                |                       |                   |  |  |
| PLOT DATE =                     |                  | DATE -         | REVISED - |   |  |                           |                          |                |                       |                   |  |  |