

**TRAFFIC MAINTENANCE NOTES:**

1. THE CONTRACTOR SHALL MAINTAIN ONE LANE OF TRAFFIC FLOW IN EACH DIRECTION THROUGHOUT THE DURATION OF THE CONTRACT.
2. THE CONTRACTOR SHALL MAINTAIN TRAFFIC IN ACCORDANCE WITH THE SPECIAL PROVISION AND AS DIRECTED BY THE ENGINEER.
3. THE ENGINEER SHALL BE INFORMED 48 HOURS IN ADVANCE OF ANY CHANGE IN CONSTRUCTION STAGING.
4. BARRICADES OR DRUMS SHALL BE EQUIPPED WITH MONO-DIRECTIONAL STEADY BURN LIGHTS AND SHALL BE PLACED AT A MAXIMUM OF 30.0 FT INTERVALS ALONG THE PROPOSED WORK ZONE AS INDICATED ON THE PLANS OR AS DIRECTED BY THE ENGINEER.
5. THE CONTRACTOR SHALL BE REQUIRED TO REMOVE ALL PAVEMENT MARKINGS WHICH CONFLICT WITH THE DESIGNATED TRAFFIC CONTROL PLAN. THIS WORK SHALL BE PAID FOR AS PAVEMENT MARKING REMOVAL.
6. THE CONTRACTOR SHALL MAKE A SOLID EDGE LINE AT EACH SIDE OF ROADWAY DURING STAGE I, II, AND III TRAFFIC OPERATIONS. THIS WORK SHALL BE PAID FOR AT THE CONTRACT UNIT PRICE FOR PAVEMENT MARKING TAPE, TYPE III.
7. SIGN LOCATIONS PLACEMENT ARE APPROXIMATE & SUBJECT TO LOCATION ADJUSTMENT DURING CONSTRUCTION AS DIRECTED BY THE ENGINEER AT NO ADDITIONAL COST.
8. ALL SIGNS/BARRICADES SHALL BE ACCORDING TO LATEST ILL. MUTCD.
9. THE FURNISHING, INSTALLING AND RELOCATION OF ALL TRAFFIC SIGNS SHALL BE IN ACCORDANCE WITH THE MANUAL ON UNIFORM TRAFFIC CONTROL DEVICES AND THE STANDARD SPECIFICATIONS. THIS WORK SHALL BE INCLUDED IN THE COST FOR TRAFFIC CONTROL AND PROTECTION.
10. ALL CONFLICTING TRAFFIC SIGNS SHALL BE COVERED AS DIRECTED BY THE ENGINEER. THIS SHALL BE INCLUDED TO THE COST OF TRAFFIC CONTROL AND PROTECTION.
11. TEMPORARY CONCRETE BARRIER SHALL HAVE THE BASE OF THE WALL PAINTED WITH REFLECTIVE YELLOW OR WHITE PAINT AS NOTED. THIS WORK SHALL NOT BE PAID FOR SEPARATELY BUT SHALL BE INCLUDED IN THE CONTRACT UNIT PRICE FOR INSTALL AND REMOVE TEMPORARY CONCRETE BARRIER.
12. THE TEMPORARY PAVEMENT MARKINGS SHALL BE WET REFLECTIVE PAVEMENT MARKINGS, TYPE III TAPE. THE APPLICABLE LOCATIONS FOR THE USE OF TAPE SHALL BE GOVERNED BY THE STANDARD SPECIFICATIONS.

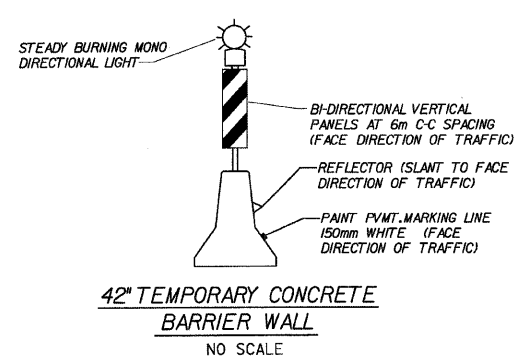

**RME** Rubinos & Messia Engineers, Inc.  
200 S. Michigan Ave, Suite 1900 Chicago IL 60604-2462  
T> 312 670 6600 F> 312 663 1473

REVISIONS		ILLINOIS DEPARTMENT OF TRANSPORTATION F.A.U. 2843 DIXIE HIGHWAY OVER BUTTERFIELD CREEK
NAME	DATE	
		MAINTENANCE OF TRAFFIC SECTIONS

SCALE: VERT. NONE  
HORIZ. NONE  
DATE 6-25-09

DRAWN BY AW  
DESIGNED BY AW  
CHECKED BY MF