

QUANTITY
 4 (100) LINE = 64.1 ft. (19.7 m)
 21.1 sq. ft. (1.97 sq. m)

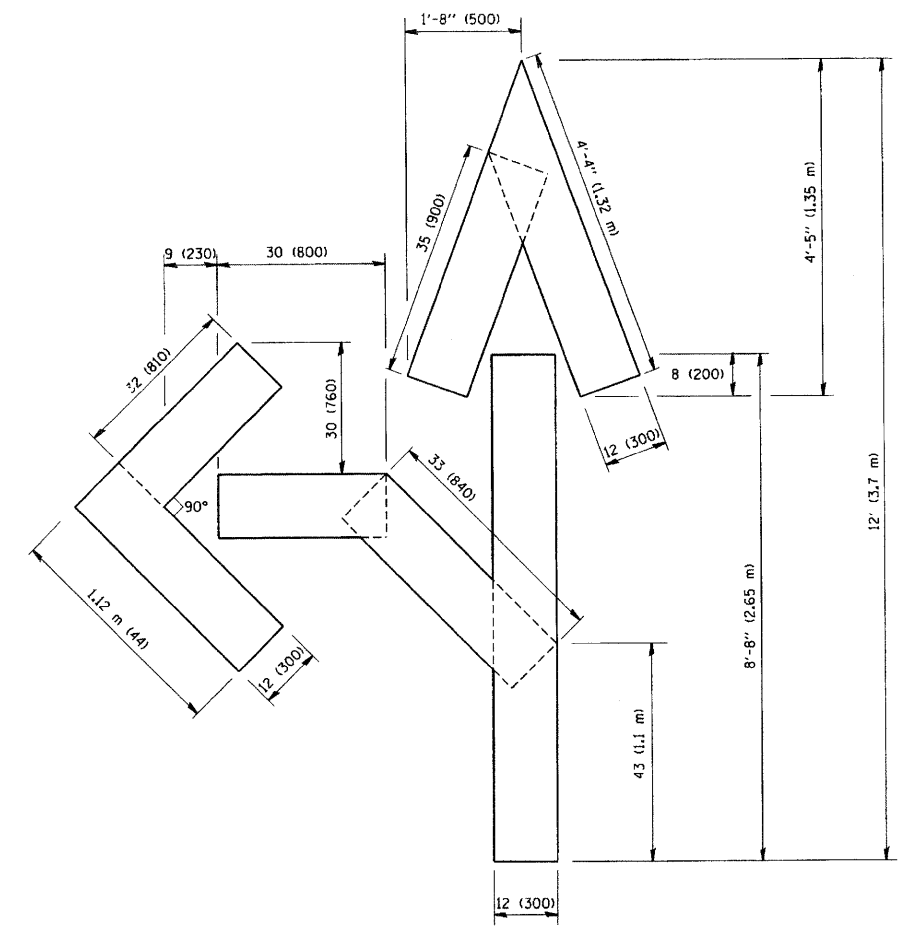

QUANTITY
 4 (100) LINE = 82.5 ft. (25.3 m)
 27.5 sq. ft. (2.53 sq. m)

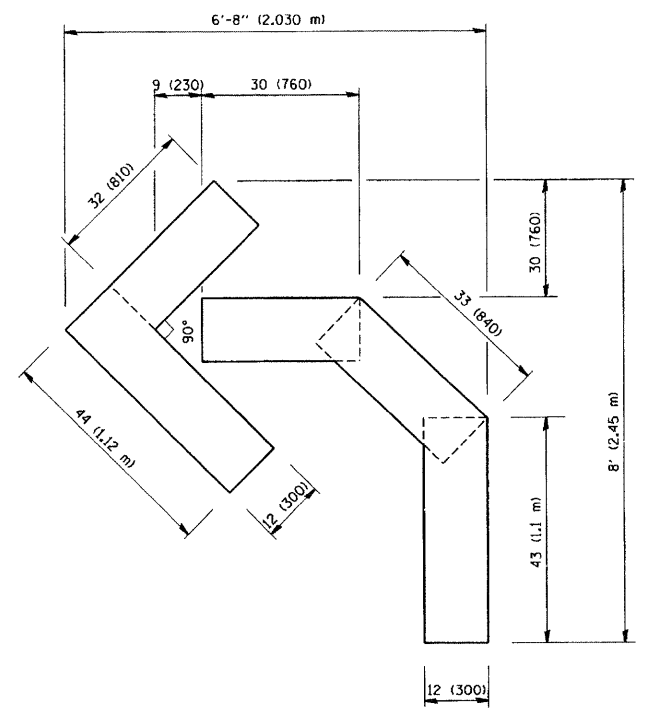

QUANTITY
 4 (100) LINE = 45.5 ft. (13.9 m)
 15.2 sq. ft. (1.39 sq. m)

All dimensions are in inches (millimeters) unless otherwise shown.

FILE NAME = W:\distatd\22x34\tcl6.dgn	USER NAME = gaglienobt	DESIGNED -	REVISED -T. RAMMACHER 06-05-96	STATE OF ILLINOIS DEPARTMENT OF TRANSPORTATION	PAVEMENT MARKING LETTERS AND SYMBOLS FOR TRAFFIC STAGING		F.A.J. RTE. 1238	SECTION (67-31) RS-7	COUNTY LAKE	TOTAL SHEETS 32	SHEET NO. 30
	PLOT SCALE = 50.0000 / IN.	DRAWN -	REVISED -T. RAMMACHER 11-04-97		SCALE: NONE	SHEET NO. 1 OF 1 SHEETS	STA. TO STA.	TC-16 CONTRACT NO. 62662			
PLOT DATE = 1/4/2008	DATE - 09-18-94	CHECKED -	REVISED -T. RAMMACHER 03-02-98				FED. ROAD DIST. NO. 1 ILLINOIS FED. AID PROJECT				
		DATE -	REVISED -E. GOMEZ 08-28-00								