

F.A.U. RTE.	SECTION	COUNTY	TOTAL SHEETS	SHEET NO.
2578	532B-1	DU PAGE	117	25
STA. 149+00		TO STA. 179+00		
FED. ROAD DIST. NO.		ILLINOIS FED. AID PROJECT		

CONTRACT #62881

LEGEND

- TEMPORARY PAVEMENT
- WORK ZONE
- DIRECTION OF TRAFFIC
- TYPE II BARRICADES OR DRUMS WITH STEADY BURNING LIGHTS @ 50 FT CENTERS ALONG ROADWAY (TANGENT), 25 FT CENTERS ALONG TAPERS AND 12 FT CENTERS ALONG RADII
- VERTICAL PANEL WITH STEADY BURNING LIGHT (50 FT C-C) TYPE III BARRICADES WITH FLASHING LIGHTS

NOTE: ALL SIDE STREETS AND ENTRANCES WILL REMAIN OPEN DURING CONSTRUCTION.

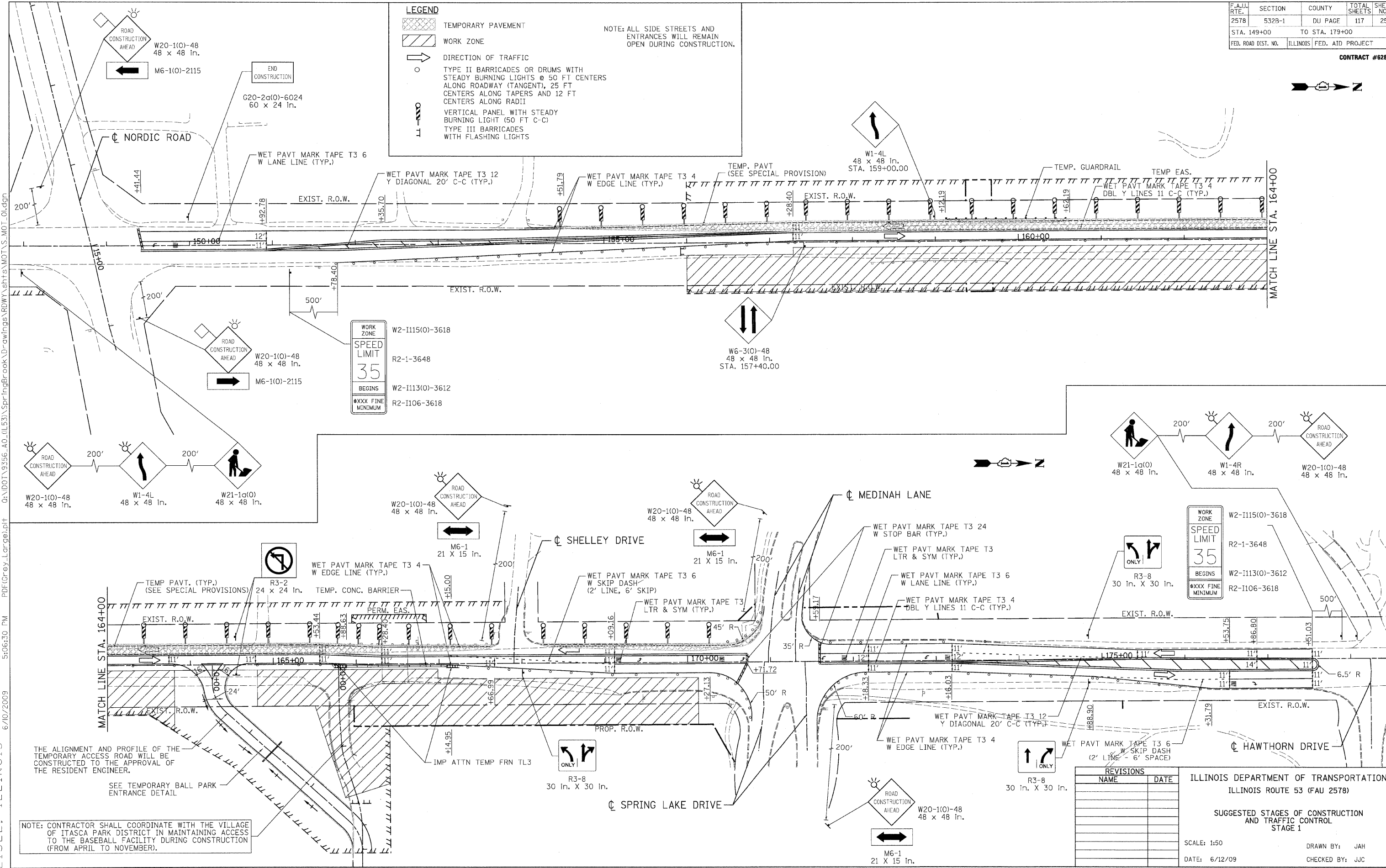

WORK ZONE
SPEED LIMIT
35
BEGINS
#XXX FINE MINIMUM

WORK ZONE
SPEED LIMIT
35
BEGINS
#XXX FINE MINIMUM

THE ALIGNMENT AND PROFILE OF THE TEMPORARY ACCESS ROAD WILL BE CONSTRUCTED TO THE APPROVAL OF THE RESIDENT ENGINEER.

SEE TEMPORARY BALL PARK ENTRANCE DETAIL

NOTE: CONTRACTOR SHALL COORDINATE WITH THE VILLAGE OF ITASCA PARK DISTRICT IN MAINTAINING ACCESS TO THE BASEBALL FACILITY DURING CONSTRUCTION (FROM APRIL TO NOVEMBER).

REVISIONS	
NAME	DATE

ILLINOIS DEPARTMENT OF TRANSPORTATION
ILLINOIS ROUTE 53 (FAU 2578)

SUGGESTED STAGES OF CONSTRUCTION AND TRAFFIC CONTROL
STAGE 1

SCALE: 1:50
DATE: 6/12/09

DRAWN BY: JAH
CHECKED BY: JJC

PATRICK ENGINEERING INC.
LISLE, ILLINOIS

6/10/2009 5:06:30 PM PDF:Grey_Large.plt Q:\DOT\9356_A0_(L53)\Springbrook\Drawings\RDWY\shfts\MOT\S.MOT_01.dgn