

THE CONTRACTOR SHALL REMOVE THE FOLLOWING ITEMS FROM THE EXISTING TEMPORARY TRAFFIC SIGNAL INSTALLATION AND INSTALL THEM ON THE PARTIAL TEMPORARY TRAFFIC SIGNAL INSTALLATION, THE COST OF WHICH SHALL BE INCLUDED IN THE PAY ITEM "TEMPORARY TRAFFIC SIGNAL INSTALLATION".

2 EACH EMERGENCY VEHICLE PRIORITY SYSTEM, DETECTOR UNIT

THE FOLLOWING EXISTING TRAFFIC SIGNAL EQUIPMENT SHALL BE REMOVED BY THE CONTRACTOR, SHALL REMAIN THE PROPERTY OF THE STATE AND SHALL BE DELIVERED BY THE CONTRACTOR TO THE STATE'S TRAFFIC SIGNAL MAINTENANCE CONTRACTOR'S MAIN FACILITY AS PER THE TRAFFIC SIGNAL SPECIFICATIONS.

1 EACH CONTROLLER AND CABINET COMPLETE

THE FOLLOWING EXISTING TRAFFIC SIGNAL EQUIPMENT SHALL BE REMOVED BY THE CONTRACTOR AND SHALL REMAIN THE PROPERTY OF THE AGENCY LISTED BELOW. THE CONTRACTOR SHALL SAFELY STORE AND ARRANGE FOR PICK UP OF ALL EQUIPMENT TO BE RETURNED TO THE LISTED AGENCY AS PER THE TRAFFIC SIGNAL SPECIFICATIONS.

AGENCY: VILLAGE OF ITASCA

1 EACH LIGHT DETECTOR AMPLIFIER  
2 EACH LIGHT DETECTOR

THE FOLLOWING ITEMS SHALL BE REMOVED BY THE CONTRACTOR AND SHALL BE DISPOSED OF BY THEM OUTSIDE THE RIGHT-OF-WAY AT THEIR EXPENSE. THE SALVAGE VALUE OF THE REMOVED EQUIPMENT SHALL BE REFLECTED IN THE CONTRACT BID PRICE.

6 EACH SIGNAL HEAD, 1-FACE, 3-SECTION, SPAN WIRE MOUNTED  
3 EACH SIGNAL HEAD, 1-FACE, 5-SECTION, SPAN WIRE MOUNTED  
2 EACH WOOD POLE  
1 L SUM SPAN WIRE, TETHER WIRE CABLES  
1 L SUM ELECTRIC CABLES

THESE ITEMS SHALL BE REMOVED WHEN THE PARTIAL TEMPORARY TRAFFIC SIGNAL INSTALLATION IS REMOVED AFTER THE CONSTRUCTION ACTIVITIES ARE COMPLETED, AND THE NEW TEMPORARY TRAFFIC SIGNAL INSTALLATION IS IN PLACE AND THE TEMPORARY TRAFFIC SIGNAL INSTALLATION IS NO LONGER NEEDED AND AS DIRECTED BY THE ENGINEER.

**NOTES FOR TEMPORARY TRAFFIC SIGNALS**

- ALL CONTROL EQUIPMENT INCLUDING EMERGENCY PRE-EMPTION AND COMMUNICATION DEVICES FOR THE TEMPORARY TRAFFIC SIGNAL(S) SHALL BE FURNISHED BY THE CONTRACTOR.
- ONLY CONTROLLERS SUPPLIED BY ONE OF THE DISTRICT APPROVED CLOSED LOOP EQUIPMENT MANUFACTURERS WILL BE APPROVED FOR USE AT TEMPORARY SIGNAL LOCATIONS. ALL CONTROLLERS USED FOR TEMPORARY TRAFFIC SIGNALS SHALL BE FULLY ACTUATED NEMA MICROPROCESSOR BASED WITH RS232 DATA ENTRY PORTS COMPATIBLE WITH EXISTING MONITORING SOFTWARE APPROVED BY IDOT DISTRICT 1, INSTALLED IN A NEMA TS1 OR TS2 CABINET. ONLY ONE BRAND OF CONTROLLER WILL BE ACCEPTED FOR ANY ONE CONTRACT.
- ALL TRAFFIC SIGNAL SECTIONS AND PEDESTRIAN SIGNAL SECTIONS SHALL BE 12". HEADS SHALL BE PLACED AS INDICATED ON THE TEMPORARY TRAFFIC SIGNAL PLAN OR AS DIRECTED BY THE ENGINEER. THE CONTRACTOR SHALL FURNISH ENOUGH CABLE SLACK TO RELOCATE HEADS TO ANY POSITION ON THE SPAN WIRE OR AT LOCATIONS ILLUSTRATED ON THE PLANS FOR CONSTRUCTION STAGING. THE TEMPORARY TRAFFIC SIGNAL SHALL REMAIN IN OPERATION DURING ALL SIGNAL HEAD RELOCATIONS. EACH TEMPORARY TRAFFIC SIGNAL HEAD SHALL HAVE ITS OWN CABLE FROM THE CONTROLLER CABINET TO THE SIGNAL HEAD.
- ALL EXISTING STREET NAME AND INTERSECTION REGULATORY SIGNS SHALL BE REMOVED FROM EXISTING POLES, RELOCATED AND SECURELY FASTENED TO THE SIGNAL SPAN WIRE OR WOOD POLE AS DIRECTED BY THE ENGINEER.
- ANY TEMPORARY SIGNAL WITHIN AN EXISTING CLOSED LOOP TRAFFIC SIGNAL SYSTEM SHALL BE INTERCONNECTED TO THAT SYSTEM USING SIMILAR BRAND CONTROL EQUIPMENT.
- THE TEMPORARY TRAFFIC SIGNAL SHALL HAVE THE SIGNAL HEAD DISPLAYS, SIGNAL HEAD PLACEMENTS AND CONTROLLER PHASING MATCH THE EXISTING TRAFFIC SIGNAL, AT THE TIME OF THE TURN ON, IF NO TRAFFIC STAGING IS IN PLACE OR WILL NOT BE STAGED ON THE DAY OF THE TURN ON.

THE DETECTOR LOOPS ON THE SOUTH APPROACH SHALL BE PERFORMED DETECTOR LOOPS AND ON THE WEST APPROACH THEY SHALL BE DETECTOR LOOP, TYPE 1.

**EXISTING EQUIPMENT TO BE REMOVED LEGEND**

- ◀ EXISTING SIGNAL TO BE REMOVED
- "E" EXISTING SERVICE INSTALLATION TO BE REMOVED
- ⊠ "E" EXISTING CONTROLLER AND FOUNDATION TO BE REMOVED
- ⊞ "E" EXISTING HANDHOLE TO BE REMOVED
- ⊞ "E" EXISTING DOUBLE HANDHOLE TO BE REMOVED
- ⊞ "E" EXISTING EMERGENCY VEHICLE LIGHT DETECTOR TO BE REMOVED
- ⊞ "E" EXISTING CONFIRMATION BEACON TO BE REMOVED
- ⊞ "E" EXISTING HEAVY DUTY HANDHOLE TO BE REMOVED
- ⊞ "E" EXISTING WOOD POLE TO BE REMOVED

F.A.U. RTE.	SECTION	COUNTY	TOTAL SHEETS	SHEET NO.
2578	5328-1	DUPAGE	117	41
STA.	TO STA.			
FED. ROAD DIST. NO.	ILLINOIS	FED. AID PROJECT		

CONTRACT # 62881

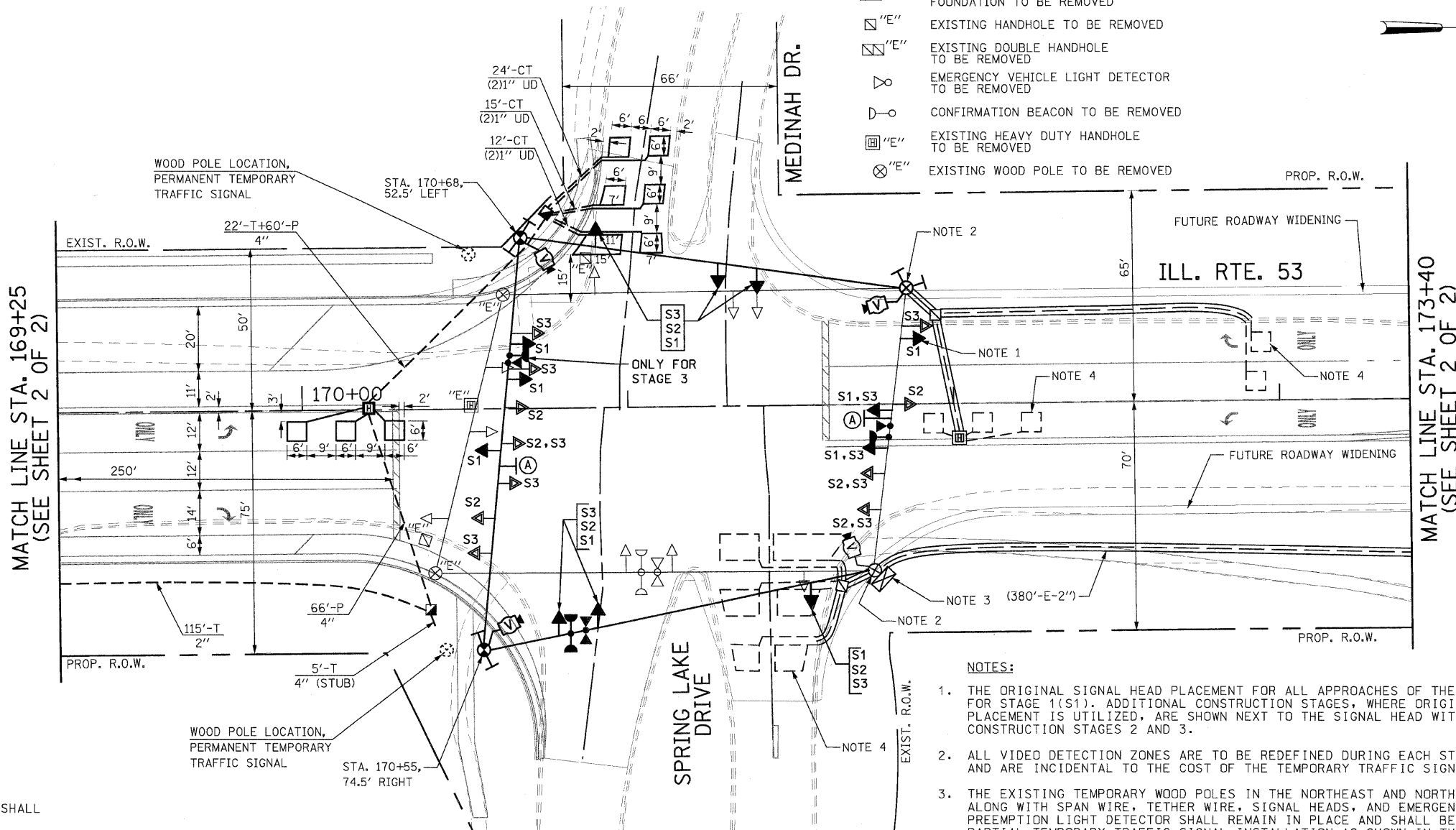

**TEMPORARY TRAFFIC SIGNAL LEGEND**

- | EXISTING | PROPOSED |   |
|----------|----------|---|
| ⊞        | ⊞        | TEMPORARY TRAFFIC SIGNAL HEAD SPAN WIRE MOUNTED ORIGINAL LOCATION |
| ⊞        | ⊞        | TEMPORARY WOOD POLE (CLASS 5 OR BETTER) 60 FOOT (18.3m) MINIMUM   |
| ⊞        | ⊞        | TEMPORARY CONTROLLER CABINET                                      |
| ⊞        | ⊞        | TEMPORARY SPAN WIRE, TETHER WIRE, AND CABLE                       |
| ⊞        | ⊞        | TEMPORARY SERVICE INSTALLATION                                    |
| ⊞        | ⊞        | EMERGENCY VEHICLE LIGHT DETECTOR                                  |
| ⊞        | ⊞        | CONFIRMATION BEACON   |
| ⊞        | ⊞        | G.S. CONDUIT IN GROUND  |
| ⊞        | ⊞        | HANDHOLE  |
| ⊞        | ⊞        | HEAVY DUTY HANDHOLE   |
| ⊞        | ⊞        | DOUBLE HANDHOLE   |
| ⊞        | ⊞        | VIDEO CAMERA ASSEMBLY   |
| ⊞        | ⊞        | VEHICLE DETECTOR, INDUCTION LOOP                                  |

Ⓐ LEFT ON GREEN ARROW ONLY  
R10-5  
24" X 30"  
(ONLY FOR STAGE 3)

**NOTES:**

- THE ORIGINAL SIGNAL HEAD PLACEMENT FOR ALL APPROACHES OF THE INTERSECTION IS FOR STAGE 1(S1). ADDITIONAL CONSTRUCTION STAGES, WHERE ORIGINAL SIGNAL HEAD PLACEMENT IS UTILIZED, ARE SHOWN NEXT TO THE SIGNAL HEAD WITH S2 AND S3 FOR CONSTRUCTION STAGES 2 AND 3.
- ALL VIDEO DETECTION ZONES ARE TO BE REDEFINED DURING EACH STAGE OF CONSTRUCTION AND ARE INCIDENTAL TO THE COST OF THE TEMPORARY TRAFFIC SIGNAL INSTALLATION.
- THE EXISTING TEMPORARY WOOD POLES IN THE NORTHEAST AND NORTHWEST QUADRANTS ALONG WITH SPAN WIRE, TETHER WIRE, SIGNAL HEADS, AND EMERGENCY VEHICLE PREEMPTION LIGHT DETECTOR SHALL REMAIN IN PLACE AND SHALL BE USED AS A PART OF PARTIAL TEMPORARY TRAFFIC SIGNAL INSTALLATION AS SHOWN IN THE PLAN AND AS DIRECTED BY THE ENGINEER. THE EXISTING TEMPORARY TRAFFIC SIGNAL CONTROLLER AND CABINET SHALL REMAIN IN PLACE AND SHALL BE USED FOR THE "PARTIAL TEMPORARY TRAFFIC SIGNAL INSTALLATION". THIS NOTE SHALL TAKE PRECEDENCE OVER THE "NOTES FOR TEMPORARY TRAFFIC SIGNALS".
- THE EXISTING DETECTOR LOOPS ON THE NORTH AND EAST APPROACHES SHALL BE MAINTAINED FOR FUTURE USE BUT SHALL BE DISABLED AT THE CONTROLLER DURING THIS CONSTRUCTION WORK.
- THE PROPOSED DETECTOR LOOPS ON SOUTH AND WEST APPROACHES SHALL BE CONSTRUCTED FOR FUTURE USE AS SHOWN IN THE PLANS AND AS DIRECTED BY THE ENGINEER. THE HANDHOLES AND CONDUITS SHALL BE CONSTRUCTED AS SHOWN IN THE PLAN AND SHALL BE PAID FOR SEPARATELY AS SHOWN IN THE "SCHEDULE OF QUANTITIES". THE LEAD-IN CABLES FOR THE NEW LOOPS SHALL BE INSTALLED AS A PART OF "PERMANENT TEMPORARY TRAFFIC SIGNAL INSTALLATION" AND NO SEPARATE PAYMENT SHALL BE MADE FOR THE LEAD-IN CABLES.

ILLINOIS DEPARTMENT OF TRANSPORTATION  
PARTIAL TEMPORARY TRAFFIC SIGNAL INSTALLATION  
REMOVE EXISTING TRAFFIC SIGNAL EQUIPMENT  
STAGE 1, STAGE 2, AND STAGE 3  
ILLINOIS ROUTE 53 AT  
SPRING LAKE DRIVE/MEDINAH DRIVE  
SHEET 1 OF 2

REVISIONS	
NAME	DATE

SCALE: 1"=20'  
DATE: 05/18/2007

DRAWN BY: KGP/RDP  
DESIGNED BY: PKG  
CHECKED BY:

**GO** GANDHI AND ASSOCIATES, INC.  
ENGINEERS AND PLANNERS  
6035 N. NORTHWEST HIGHWAY  
SUITE 306  
CHICAGO, ILLINOIS 60637 TEL: (773) 774-5900