

**NOTES FOR TEMPORARY TRAFFIC SIGNALS**

1. ALL CONTROL EQUIPMENT INCLUDING EMERGENCY PRE-EMPTION AND COMMUNICATION DEVICES FOR THE TEMPORARY TRAFFIC SIGNAL(S) SHALL BE FURNISHED BY THE CONTRACTOR.
2. ONLY CONTROLLERS SUPPLIED BY ONE OF THE DISTRICT APPROVED CLOSED LOOP EQUIPMENT MANUFACTURERS WILL BE APPROVED FOR USE AT TEMPORARY SIGNAL LOCATIONS. ALL CONTROLLERS USED FOR TEMPORARY TRAFFIC SIGNALS SHALL BE FULLY ACTUATED NEMA MICROPROCESSOR BASED WITH RS232 DATA ENTRY PORTS COMPATIBLE WITH EXISTING MONITORING SOFTWARE APPROVED BY IDOT DISTRICT 1, INSTALLED IN A NEMA TS1 OR TS2 CABINET. ONLY ONE BRAND OF CONTROLLER WILL BE ACCEPTED FOR ANY ONE CONTRACT.
3. ALL TRAFFIC SIGNAL SECTIONS AND PEDESTRIAN SIGNAL SECTIONS SHALL BE 12". HEADS SHALL BE PLACED AS INDICATED ON THE TEMPORARY TRAFFIC SIGNAL PLAN OR AS DIRECTED BY THE ENGINEER. THE CONTRACTOR SHALL FURNISH ENOUGH CABLE SLACK TO RELOCATE HEADS TO ANY POSITION ON THE SPAN WIRE OR AT LOCATIONS ILLUSTRATED ON THE PLANS FOR CONSTRUCTION STAGING. THE TEMPORARY TRAFFIC SIGNAL SHALL REMAIN IN OPERATION DURING ALL SIGNAL HEAD RELOCATIONS. EACH TEMPORARY TRAFFIC SIGNAL HEAD SHALL HAVE ITS OWN CABLE FROM THE CONTROLLER CABINET TO THE SIGNAL HEAD.
4. ALL EXISTING STREET NAME AND INTERSECTION REGULATORY SIGNS SHALL BE REMOVED FROM EXISTING POLES, RELOCATED AND SECURELY FASTENED TO THE SIGNAL SPAN WIRE OR WOOD POLE AS DIRECTED BY THE ENGINEER.
5. ANY TEMPORARY SIGNAL WITHIN AN EXISTING CLOSED LOOP TRAFFIC SIGNAL SYSTEM SHALL BE INTERCONNECTED TO THAT SYSTEM USING SIMILAR BRAND CONTROL EQUIPMENT.
6. THE TEMPORARY TRAFFIC SIGNAL SHALL HAVE THE SIGNAL HEAD DISPLAYS, SIGNAL HEAD PLACEMENTS AND CONTROLLER PHASING MATCH THE EXISTING TRAFFIC SIGNAL, AT THE TIME OF THE TURN ON, IF NO TRAFFIC STAGING IS IN PLACE OR WILL NOT BE STAGED ON THE DAY OF THE TURN ON.

UPON ACCEPTANCE OF THE TEMPORARY TRAFFIC SIGNAL INSTALLATION WORK BY THE STATE, THIS PERMANENT TEMPORARY TRAFFIC SIGNAL INSTALLATION SHALL BECOME THE PROPERTY OF THE STATE AND SHALL REMAIN IN PLACE.

F.A.U. RTE.	SECTION	COUNTY	TOTAL SHEETS	SHEET NO.
2578	5328-1	DUPAGE	117	44
STA.		TO STA.		
FED. ROAD DIST. NO.	ILLINOIS	FED. AID PROJECT		

CONTRACT # 62881

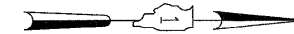

**NOTES:**

1. A UNIT DUCT SHALL BE ATTACHED TO THE WOOD POLE TO A HEIGHT OF 10FT TO PROTECT AND FACILITATE THE INSTALLATION OF AERIAL CABLE (LEAD-IN) IN TO THE CONDUITS AS SHOWN IN THE PLAN AND AS DIRECTED BY THE ENGINEER.
2. THE INSTALLATION OF CONDUITS, CABLES, TRENCH AND BACKFILL, AND DRILL EXISTING HANDHOLE SHALL NOT BE PAID FOR SEPARATELY BUT SHALL BE INCIDENTAL TO THE PERMANENT TEMPORARY TRAFFIC SIGNAL INSTALLATION WORK.

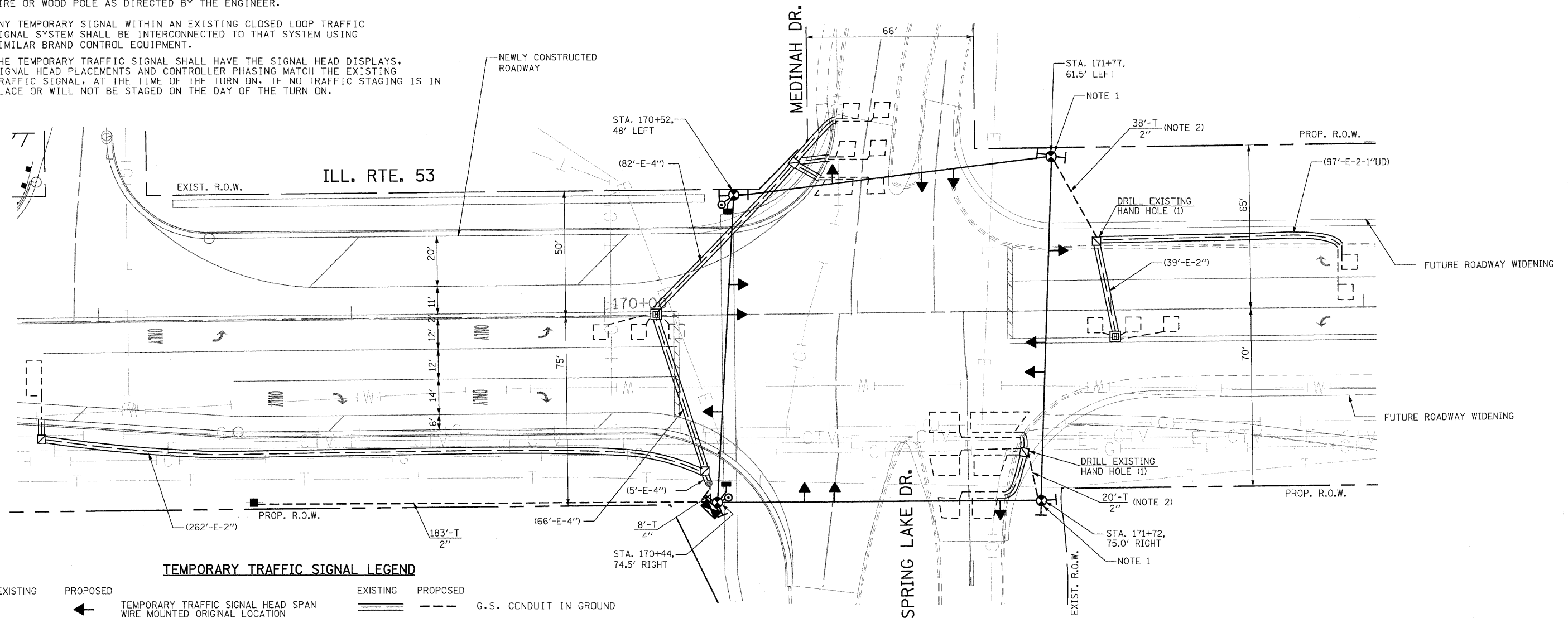

**TEMPORARY TRAFFIC SIGNAL LEGEND**

EXISTING	PROPOSED	EXISTING	PROPOSED

**TEMPORARY TRAFFIC SIGNAL PLAN**

**ga** GANDHI AND ASSOCIATES, INC.  
ENGINEERS AND PLANNERS  
6035 N. NORTHWEST HIGHWAY  
SUITE 306  
CHICAGO, ILLINOIS 60631 TEL. (773) 774-5910

REVISIONS	
NAME	DATE

ILLINOIS DEPARTMENT OF TRANSPORTATION

**PERMANENT TEMPORARY TRAFFIC SIGNAL INSTALLATION  
ILLINOIS ROUTE 53 AT  
SPRING LAKE DRIVE/MEDINAH DRIVE**

SCALE: 1"=20'  
DATE: 05/18/2007

DRAWN BY: KGP/RDP  
DESIGNED BY: PKG  
CHECKED BY: