

F.A.U. RTE.	SECTION	COUNTY	TOTAL SHEETS	SHEET NO.
1503	08-00260-01-PV	KANE	176	93
STA. 40+00		TO STA. 64+00		
FED. ROAD DIST. NO.	ILLINOIS	FED. AID PROJECT		

RESTORATION OF WORK AREA. RESTORATION OF THE TRAFFIC SIGNAL WORK AREA WILL BE INCIDENTAL TO THE RELATED PAY ITEM SUCH AS FOUNDATION, CONDUIT, HANDHOLE, TRENCH AND BACKFILL, ETC., AND NO EXTRA COMPENSATION WILL BE ALLOWED. ALL ROADWAY SURFACES SUCH AS SHOULDERS, MEDIANS, SIDEWALKS, PAVEMENT, ETC. SHALL BE REPLACED IN KIND. ALL DAMAGE TO MOWED LAWNS SHALL BE REPLACED WITH AN APPROVED SOD. AND ALL DAMAGE TO UNMOWED FIELDS SHALL BE SEEDED IN ACCORDANCE WITH STANDARD SPECIFICATIONS 252 AND 250 RESPECTIVELY.

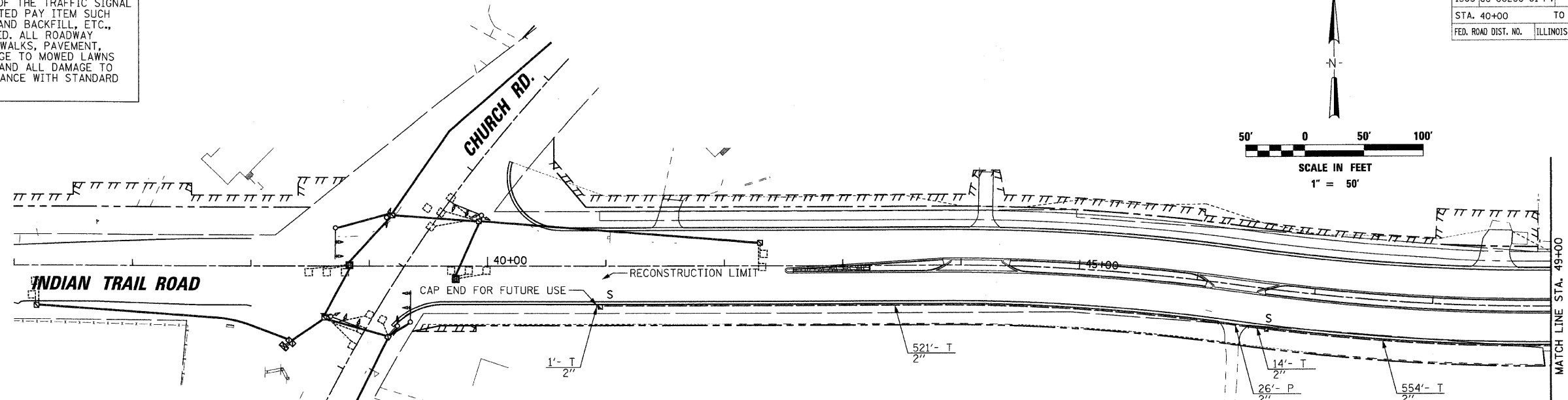
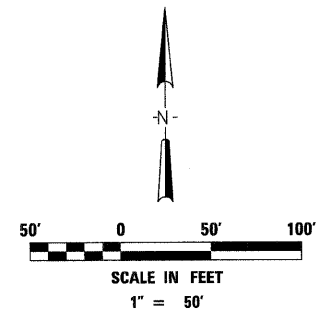

INTERCONNECT PLAN LEGEND

	PROPOSED	EXISTING
CONTROLLER	■	■
HANDHOLE	□	□
HEAVY DUTY HANDHOLE	■	■
DOUBLE HANDHOLE	■	■
CONDUIT	—	—
DETECTOR LOOP	□	□
UNIT DUCT	U.D.	
SYSTEM	S	E.S.
INTERSECTION	IP	I

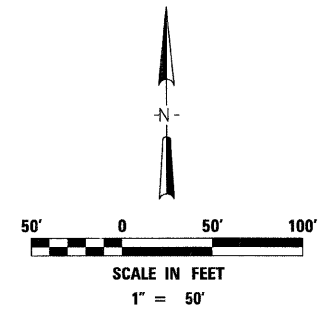
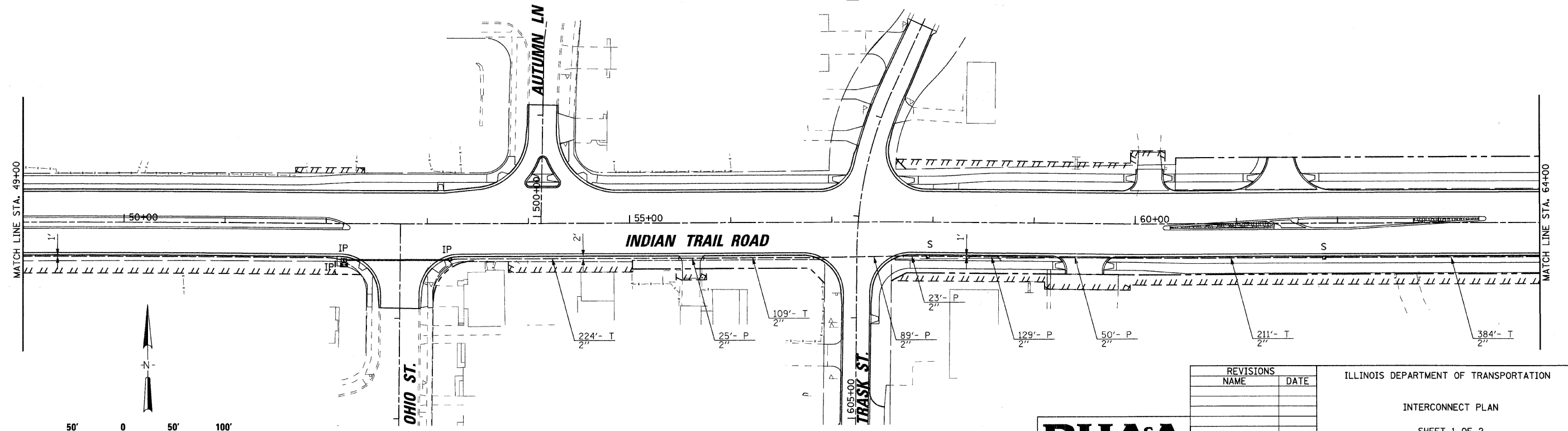

REVISIONS	
NAME	DATE

ILLINOIS DEPARTMENT OF TRANSPORTATION
 INTERCONNECT PLAN
 SHEET 1 OF 2



SCALE: VERT. 1"=50
 DATE 1/7/09
 DRAWN BY KMA
 CHECKED BY TC/SBP

PLOT DATE = 1/5/2009
 FILE NAME = H:\A\08-00260-01-PV\1503\1503-01-PV\SIGNALIC.LDGN
 PLOT SCALE = 1"=50'
 USER NAME = JOEEL