

F.A.U. NO.	SECTION	COUNTY	TOTAL SHEETS	SHEET NO.
1503	08-00260-01-PV	KANE	176	139
STA. 55+60.81		TO STA. 56+00.00		
FED. ROAD DIST. NO.		ILLINOIS	FED. AID PROJECT	

FINAL SURVEY	SURVEYED	BY	DATE
NOTE BOOK	PLOTTED		
NO.	AREAS CHECKED		

ORIGINAL SURVEY	SURVEYED	BY	DATE
NOTE BOOK	PLOTTED		
NO.	AREAS CHECKED		

PLOT DATE = 1/5/2009  
 USER NAME = USER

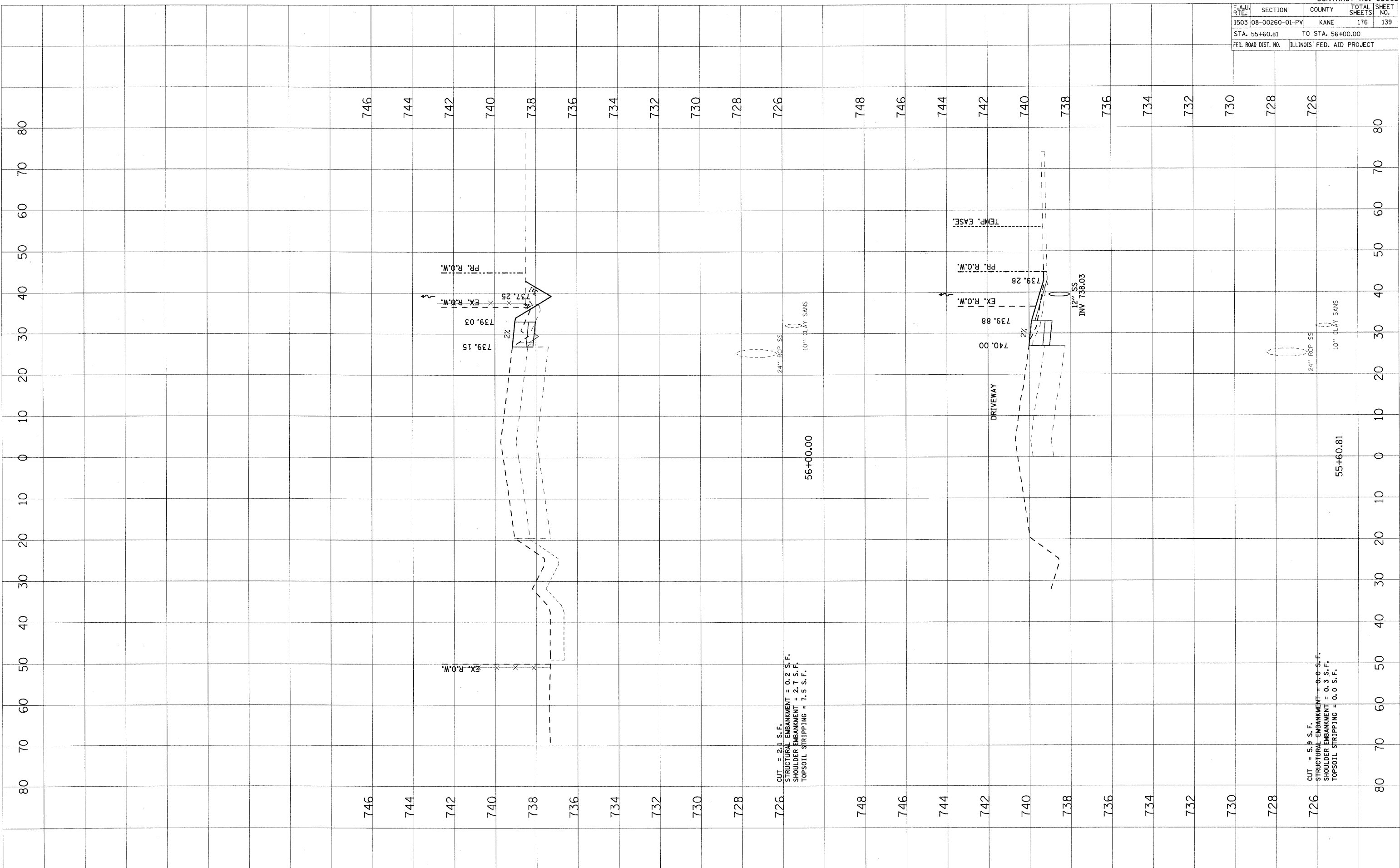

CUT = 2.1 S.F.  
 STRUCTURAL EMBANKMENT = 0.2 S.F.  
 SHOULDER EMBANKMENT = 2.7 S.F.  
 TOPSOIL STRIPPING = 7.5 S.F.

CUT = 5.9 S.F.  
 STRUCTURAL EMBANKMENT = 0.0 S.F.  
 SHOULDER EMBANKMENT = 0.3 S.F.  
 TOPSOIL STRIPPING = 0.0 S.F.