

DATE	BY
REVISIONS	PLANNED
PLANNED	ALIGNED
ALIGNED	CHECKED
CHECKED	NO. _____
NO. _____	FILE NAME

DATE	BY
REVISIONS	PROFILES
PROFILES	GRADES
GRADES	CHECKED
CHECKED	NO. _____
NO. _____	NOTES
NOTES	REVISIONS
REVISIONS	NO. _____
NO. _____	NO. _____

6 STA. 106+38.22, 38.4' LT.
SAN MH TO BE ADJUSTED
EX RIM = 604.44
PR RIM = 603.39

MATCH LINE STA. 105+00
(SEE SHEET NO. 37)

MATCH LINE STA. 109+00
(SEE SHEET NO. 35)

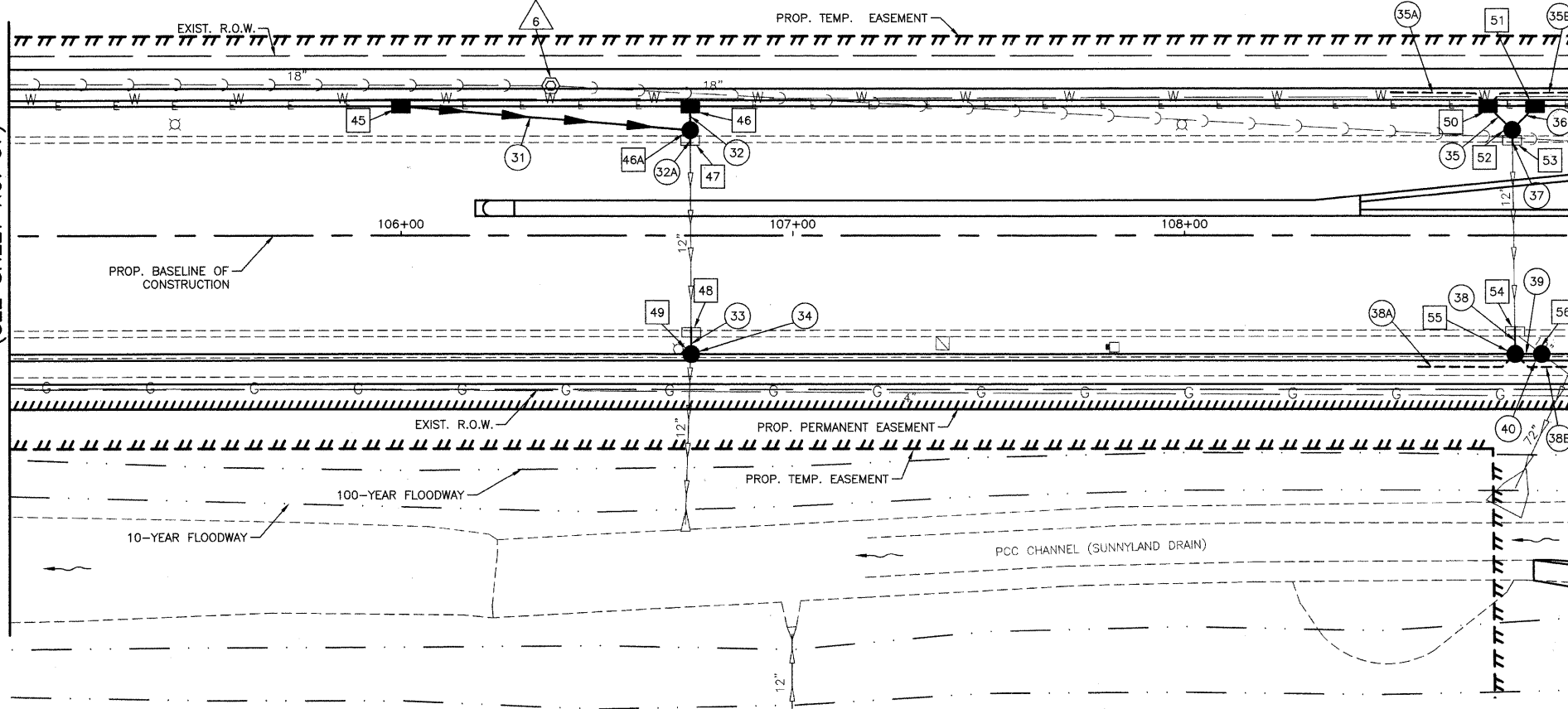

- 48 STA. 106+73.99, 24.6' RT. REMOVING INLET TO MAINTAIN FLOW INV = 598.4 (EX 12" N)
- 49 STA. 106+73.97, 30.0' RT. CB T-A, 4" DIA., T-11 F&G RIM = 602.77 INV = 598.28 (12" N) INV = 597.59 (EX 12" S)
- 50 STA. 108+77.43, 33.0' LT. INLET T-A, T-11 F&G RIM = 601.80 INV = 598.97 (12" SE)
- 51 STA. 108+89.43, 33.0' LT. INLET T-A, T-11 F&G RIM = 601.81 INV = 598.98 (12" SW)
- 52 STA. 108+83.59, 27.0' LT. CB T-A, 4" DIA., T-11 F&G RIM = 601.92 INV = 598.69 (12" NW) INV = 598.74 (12" NE) INV = 598.22 (12" S)
- 53 STA. 108+83.59, 24.3' LT. REMOVING INLET TO MAINTAIN FLOW INV = 598.2 (EX 12" S)
- 54 STA. 108+84.26, 24.4' RT. REMOVING INLET TO MAINTAIN FLOW INV = 597.6 (EX 12" N)
- 45 STA. 106+00.00, 33.0' LT. INLET T-A, T-11 F&G RIM = 603.07 INV = 600.20 (12" E)
- 46 STA. 106+73.83, 33.0' LT. INLET T-A, T-11 F&G RIM = 602.68 INV = 599.50 (12" S)
- 46A STA. 106+73.83, 27.0' LT. CB T-A, 4" DIA., T-11 F&G RIM = 602.80 INV = 599.42 (12" N) INV = 599.32 (12" S) INV = 599.49 (12" W)
- 47 STA. 106+73.80, 24.3' LT. REMOVING INLET TO MAINTAIN FLOW INV = 599.3 (EX 12" S)
- 55 STA. 108+84.26, 30.0' RT. CB T-A, 4" DIA., T-11 F&G RIM = 601.82 INV = 597.52 (12" N & E)
- 56 STA. 108+91.00, 30.0' RT. CB T-A, 4" DIA., T-11 F&G RIM = 601.82 INV = 597.50 (12" W) INV = 597.44 (EX 12" SE)
- 31 71' - 12" SS WMR T-1 @ 1.0% TBF = 9.4 CU. YD.
- 32 4' - 12" SS CL A, T-1 @ 2.0% TBF = 0.6 CU. YD.
- 32A 1' - 12" SS CL A, T-2 @ 2.0% TBF = 0.2 CU. YD.
- 33 6' - 12" SS CL A, T-1 @ 2.0% TBF = 1.3 CU. YD.
- 34 8' - 12" SS REMOVAL
- 35 7' - 12" SS CL A, T-1 @ 4.0% TBF = 1.0 CU. YD.
- 35A 25' - PIPE UNDERDRAIN, 4"
- 35B 25' - PIPE UNDERDRAIN, 4"
- 36 6' - 12" SS CL A, T-1 @ 4.0% TBF = 0.8 CU. YD.
- 37 1' - 12" SS CL A, T-2 @ 2.0% TBF = 0.2 CU. YD.
- 38 6' - 12" SS CL A, T-2 @ 1.3% TBF = 1.2 CU. YD.
- 38A 25' - PIPE UNDERDRAIN, 4"
- 38B 25' - PIPE UNDERDRAIN, 4"
- 39 3' - 12" SS CL A, T-2 @ 1.0% TBF = 0.6 CU. YD.
- 40 10' - 12" SS REMOVAL

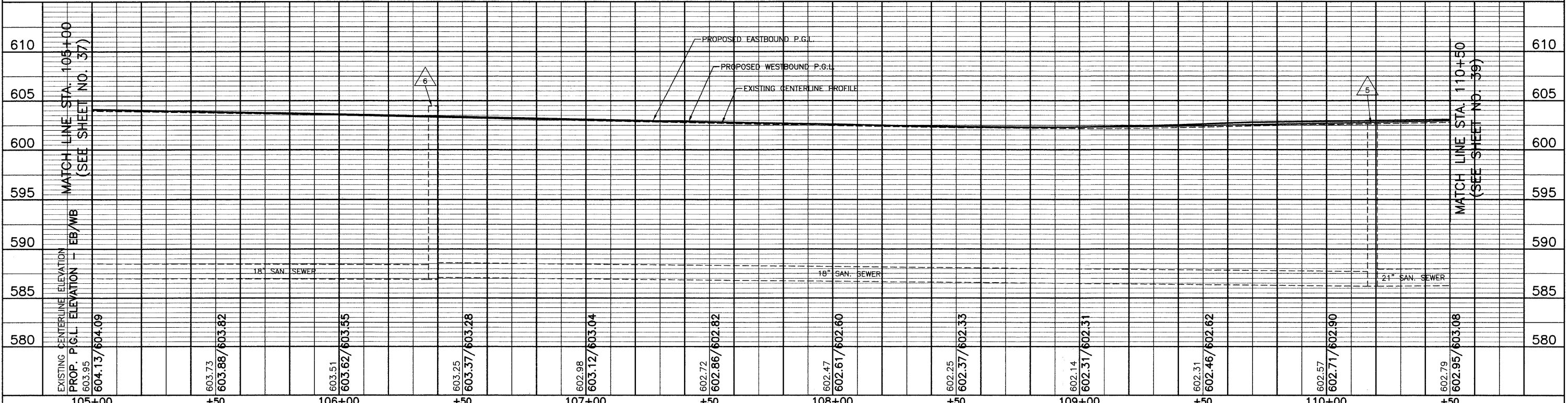
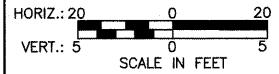

FILE NAME =	USER NAME =	DESIGNED <i>BLG/KRK</i>	REVISED -	STATE OF ILLINOIS DEPARTMENT OF TRANSPORTATION	DRAINAGE & UTILITIES HENNEPIN DRIVE	F.A.U. RTE.	SECTION	COUNTY	TOTAL SHEETS	SHEET NO.	
		DRAWN <i>BLG/KRK</i>	REVISED -			0326	06-00130-00-CH	WILL	116	38	
		CHECKED <i>DJK</i>	REVISED -			CONTRACT NO. 63185					
		DATE <i>5-29-09</i>	REVISED -			FED. ROAD DIST. NO. 7 ILLINOIS FED. AID PROJECT M-8003(654)					