

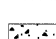

LEGEND

-  3" HOT-MIX ASPHALT SURFACE, MIX "C", N50
-  6" AGGREGATE BASE COURSE, TYPE B
-  7" PORTLAND CEMENT CONCRETE
-  2" AGGREGATE BASE COURSE, TYPE B
-  STRUCTURE TO BE ADJUSTED
-  THERMOPLASTIC PAVEMENT MARKING LINE, 6" (WHITE)
-  DETECTABLE WARNINGS

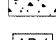
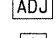
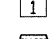

PLAN	SUBMITTED	DATE
NO.	BY	
NO.	BY	
NO.	BY	
NO.	BY	

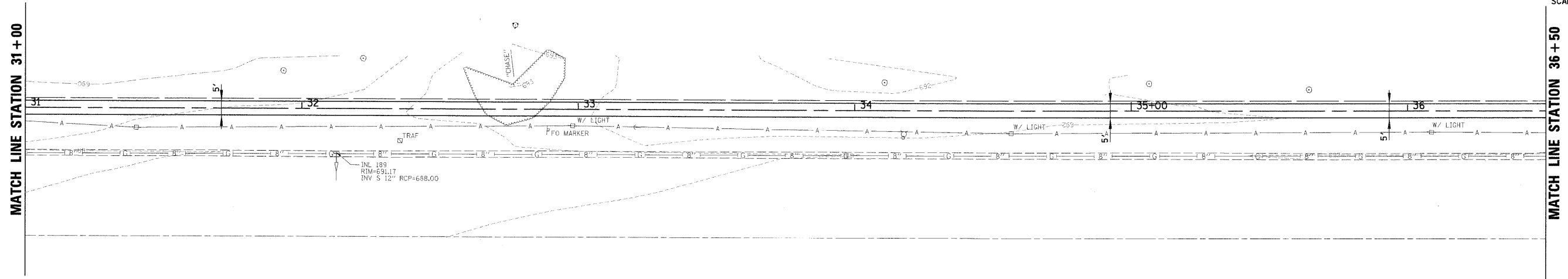
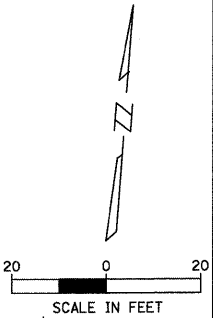
PROFILE	SUBMITTED	DATE
NO.	BY	
NO.	BY	
NO.	BY	
NO.	BY	

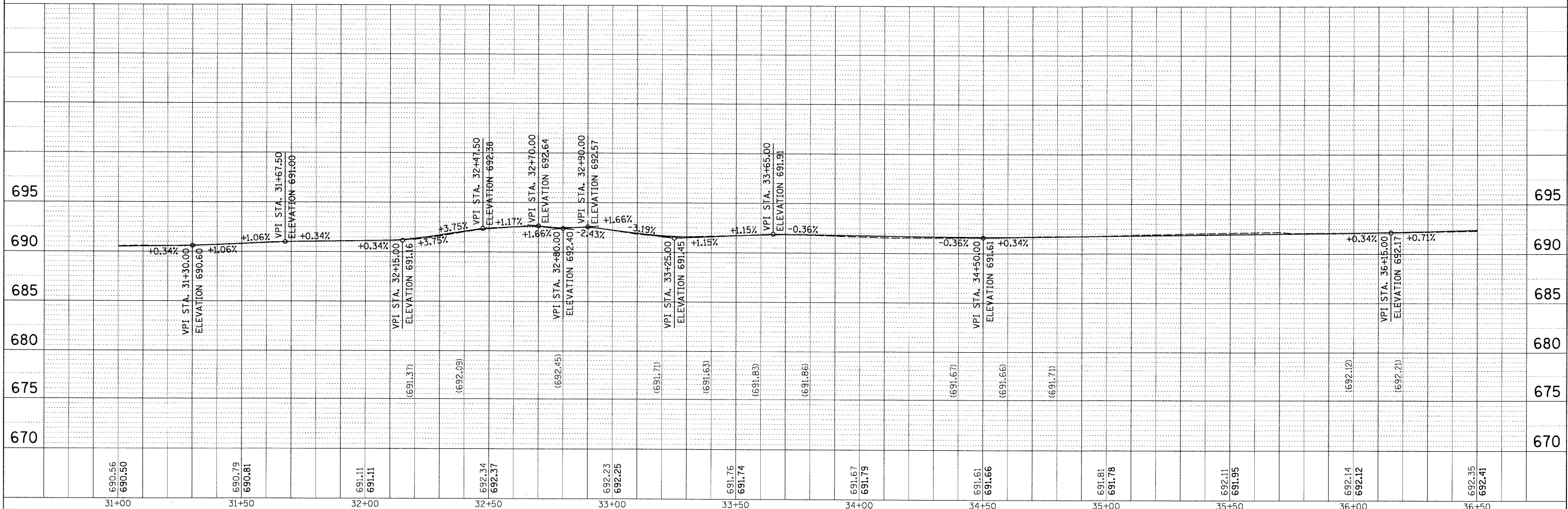

FILE NAME =	USER NAME = MAGOLDEN	DESIGNED -	REVISED -	STATE OF ILLINOIS DEPARTMENT OF TRANSPORTATION	SIDEWALK PLAN AND PROFILE	F.A. RTE.	SECTION	COUNTY	TOTAL SHEETS	SHEET NO.
N:\BENSENVILLE\080659\C\1\1\RPSS.dgn		DRAWN -	REVISED -			08-00086-00-SW	DUPAGE	33	15	
PLOT SCALE = 20'		CHECKED -	REVISED -			CONTRACT NO. 63187				
PLOT DATE = 4/30/2009		DATE -	REVISED -			ILLINOIS FED. AID PROJECT				
SCALE: 20'	SHEET NO.	OF	SHEETS	STA.	TO STA.					