

PLAN	SURVEYED	BY	DATE
	PLOTTED		
	CHECKED		
	REVISIONS		
	NO. OF WAY CHECKED		
	CADD FILE NAME		

PROFILE	SURVEYED	BY	DATE
	PLOTTED		
	CHECKED		
	REVISIONS		
	NOTATIONS		
	STRUCTURE		
	CHKD		

MATCH LINE STA. 421+00  
(SEE SHEET NO. 14)

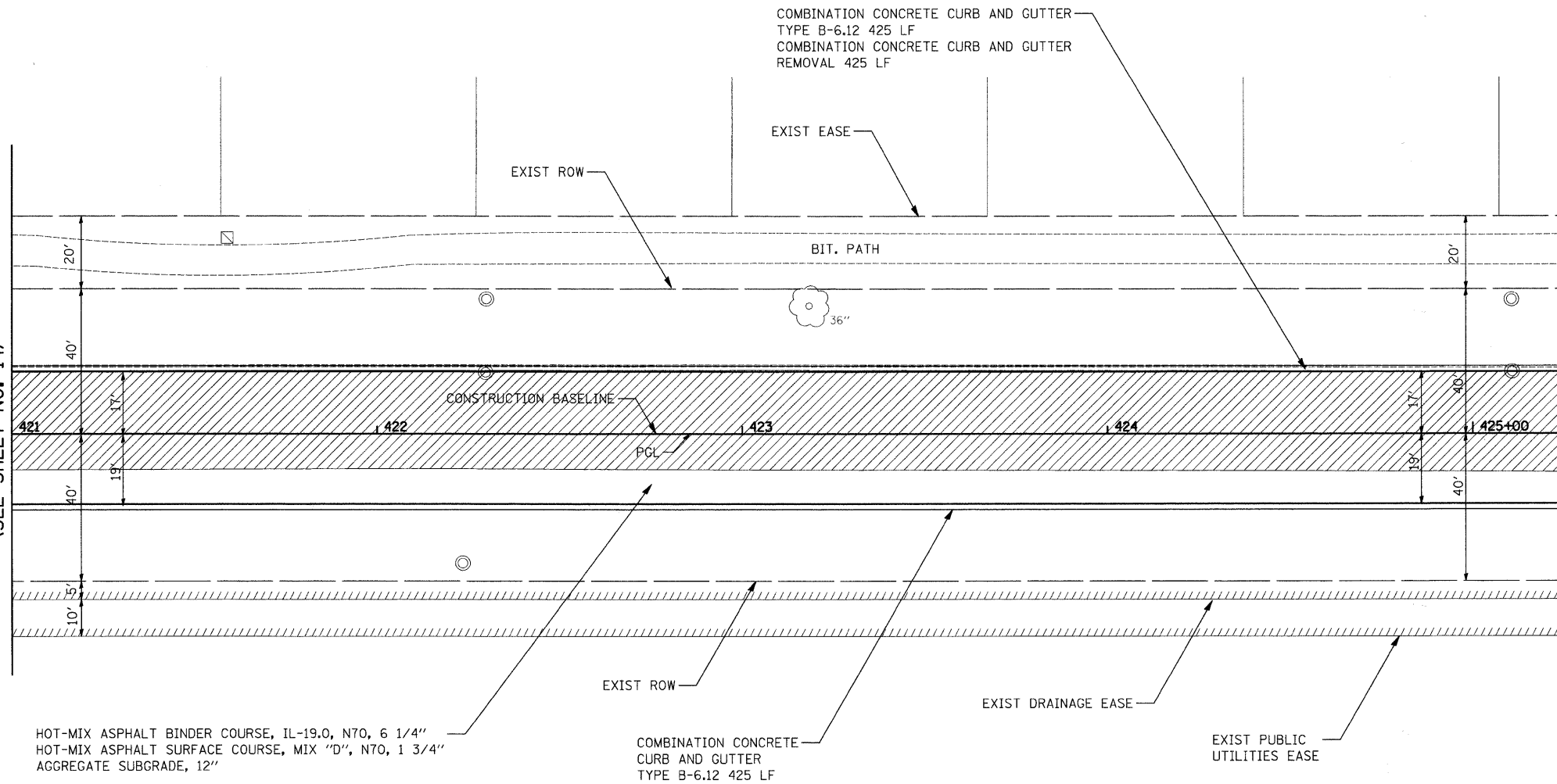

MATCH LINE STA. 425+25  
(SEE SHEET NO. 16)

HOT-MIX ASPHALT BINDER COURSE, IL-19.0, N70, 6 1/4"  
HOT-MIX ASPHALT SURFACE COURSE, MIX "D", N70, 1 3/4"  
AGGREGATE SUBGRADE, 12"

COMBINATION CONCRETE CURB AND GUTTER TYPE B-6.12 425 LF

EXIST DRAINAGE EASE

EXIST PUBLIC UTILITIES EASE

HOT-MIX ASPHALT SURFACE COURSE, MIX "D", N70, 1 3/4"  
 HOT-MIX ASPHALT BINDER COURSE, IL-19.0, N70, 4 1/4" MIN. AND VARIES  
 HOT-MIX ASPHALT SURFACE REMOVAL, 3/4"

REED ROAD

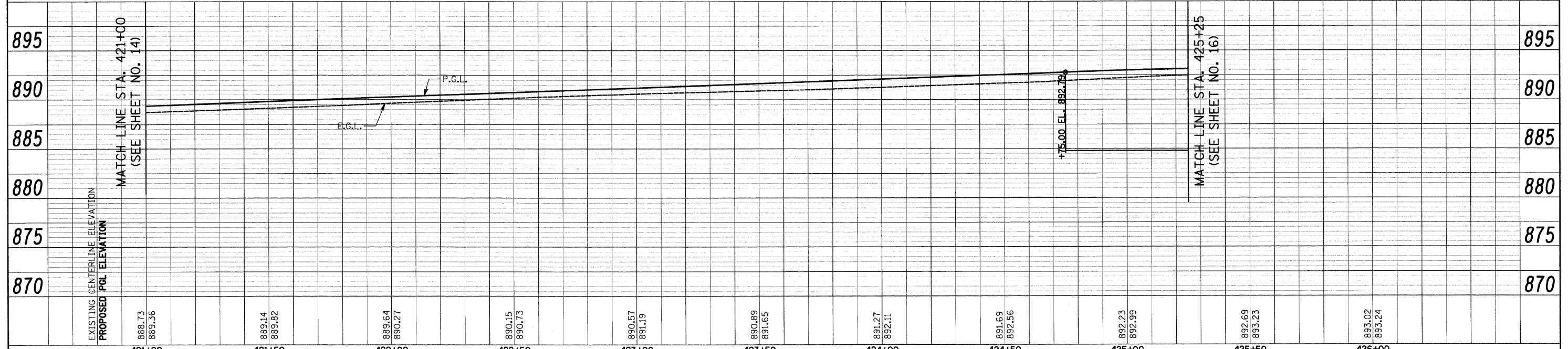

FILE NAME = J:\2213\oad\sheet\2213.P&P_05.dgn	USER NAME = ead	DESIGNED - EAD	REVISED -	<b>STATE OF ILLINOIS DEPARTMENT OF TRANSPORTATION</b>	<b>REED ROAD - PLAN &amp; PROFILE</b>			F.A.U. RTE. 4075	SECTION 08-00032-00-RS	COUNTY MCHENRY	TOTAL SHEETS 49	SHEET NO. 15	
	PLOT SCALE = 20.0000' / IN.	DRAWN - EDS	REVISED -		SCALE 1"=20'	SHEET NO. 5 OF	SHEETS	STA. 421+00	TO STA. 425+25	CONTRACT NO. 63193			
	PLOT DATE = 5/1/2009	CHECKED - DNM	REVISED -		FED. ROAD DIST. NO. ILLINOIS FED. AID PROJECT								
		DATE - 5/1/09	REVISED -										

