

- 21 STA. 412+10, 38.1' RT.  
PRC FLAR END SEC 15"  
INV = 884.30 (15" E)
- 22 STA. 412+45, 37.8' RT.  
PRC FLAR END SEC 15"  
INV = 884.48 (15" W)
- 23 STA. 412+50, 35.7' RT.  
PRC FLAR END SEC 12"  
INV = 884.78 (12" N)
- 24 STA. 412+50, 19.0' RT.  
CB TC T11F&G  
RIM = 887.43  
INV = 884.93 (12" S)
- 25 STA. 412+69.78, 17.52' LT.  
CB ADJUST  
EX RIM = 886.75  
PR RIM = 487.55

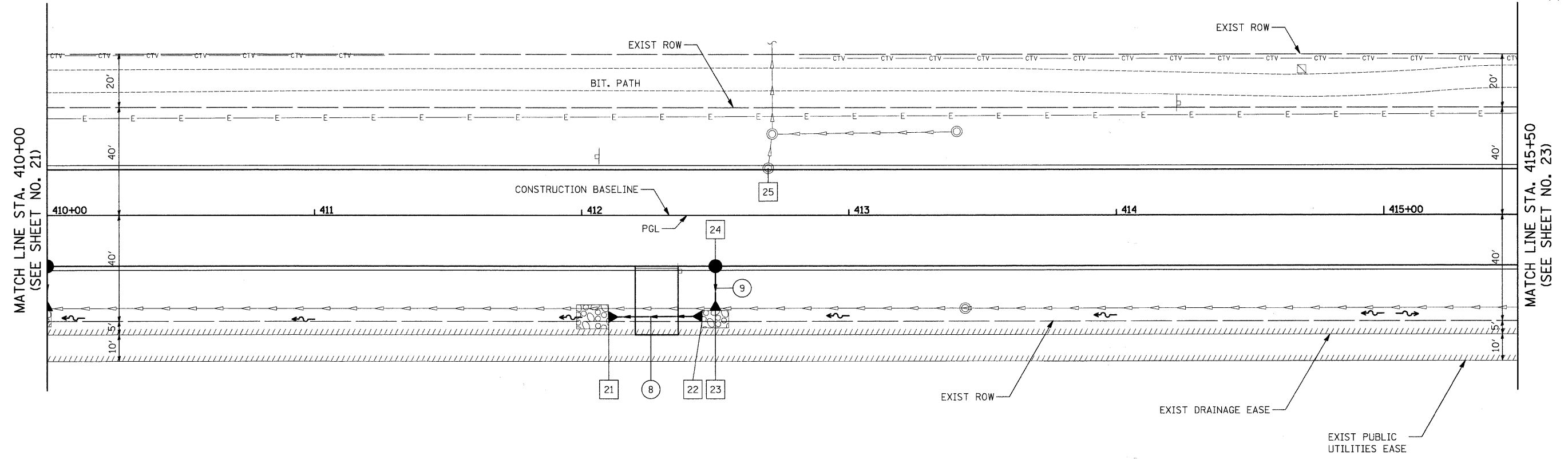

PLAN	SURVEYED	BY	DATE
	PLOTTED		
	CHECKED		
	RT. OF WAY CHECKED		
	NO. _____		
	NOTE BOOK		
	NO. _____		
	CADD FILE NAME		
	NO. _____		



- 8 23' - P CUL CL A 1, 15' @ 0.50%  
T.B.F. = 2.5 CU. YD.
- 9 9' - STORM SEW CL A 1, 12" @ 1.00%  
T.B.F. = 0.3 CU. YD.

PROFILE	SURVEYED	BY	DATE
	PLOTTED		
	CHECKED		
	RT. OF WAY CHECKED		
	NO. _____		
	NOTE BOOK		
	NO. _____		
	STRUCTURE NOTATIONS CHK'D		
	NO. _____		

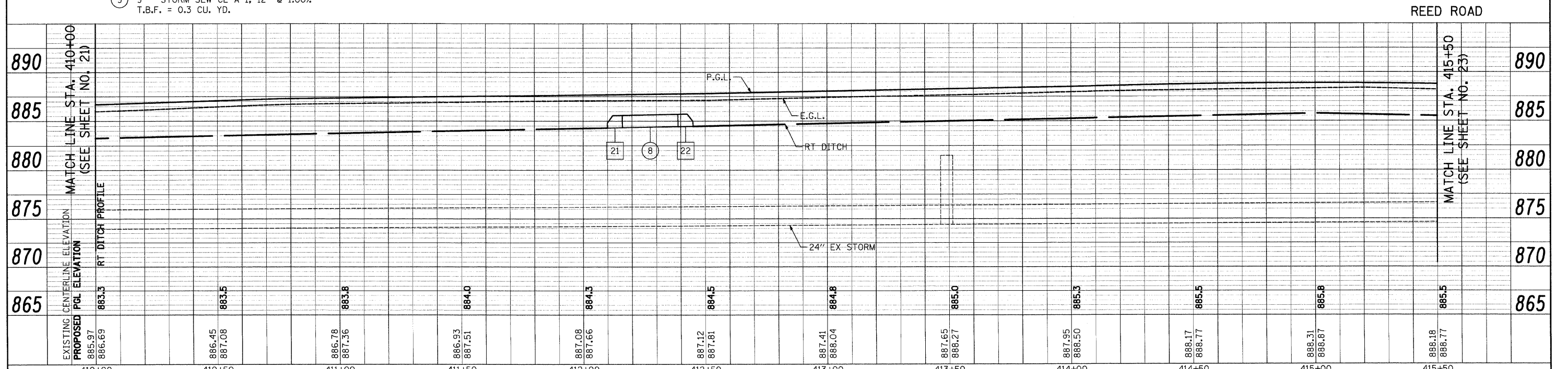

FILE NAME = J:\2213\road\sheet\2213.D&U.03.dgn	USER NAME = ead	DESIGNED - EAD	REVISED -	<b>STATE OF ILLINOIS DEPARTMENT OF TRANSPORTATION</b>	<b>REED ROAD - DRAINAGE AND UTILITIES</b>			F.A.U. RTE. 4075	SECTION 08-00032-00-RS	COUNTY MCHENRY	TOTAL SHEETS 49	SHEET NO. 22
PLOT SCALE = 20.0000' / IN.	CHECKED - DNM	REVISIONS	SCALE 1"=20'					SHEET NO. 3 OF 6 SHEETS	STA. 410+00 TO STA. 415+50	FED. ROAD DIST. NO. ILLINOIS FED. AID PROJECT	CONTRACT NO. 63193	
PLOT DATE = 5/1/2009	DATE - 5/1/09	REVISIONS										