

DATE	
BY	
PLAN	
SURVEYED	
ALIGNED	
NOTED	
RT. OF WAY	
CHECKED	
NO.	
CAID FILE NAME	

DATE	
BY	
PROFILE	
SURVEYED	
GRADES	
NOTED	
STRUCTURE	
NOTATIONS	
CHFD	
NO.	

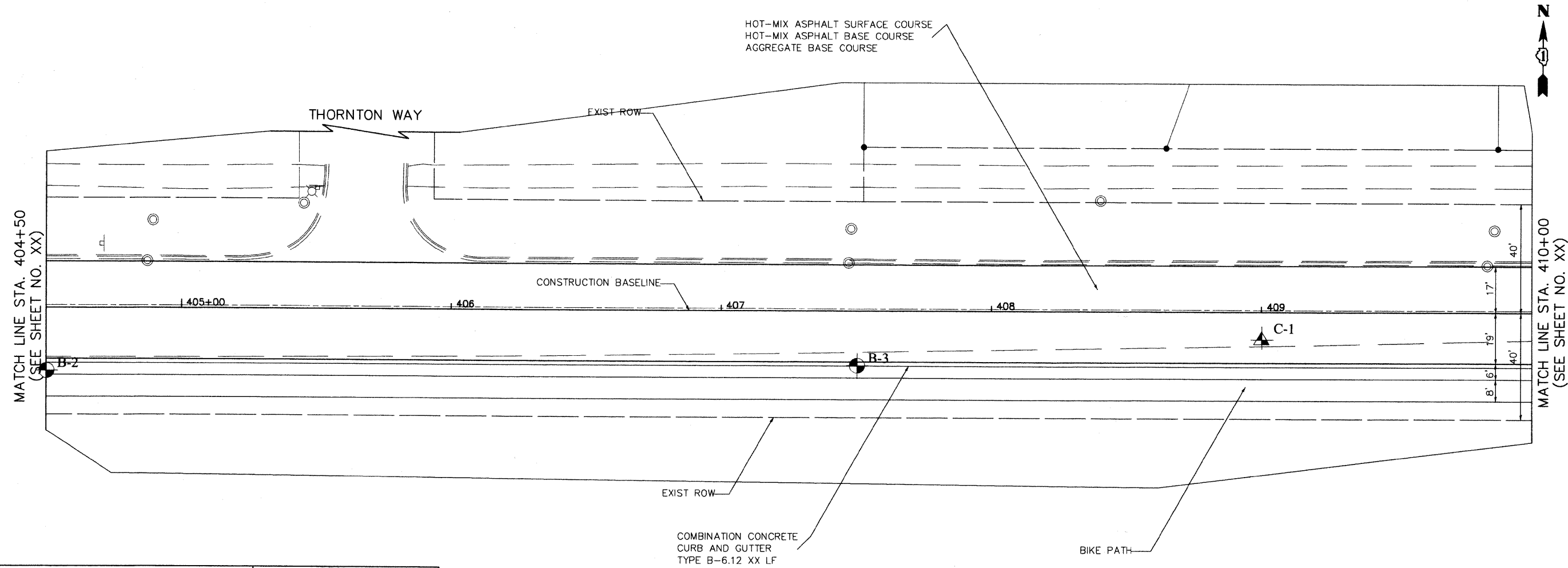

SOIL PROFILE DRAWING
 MIDLAND STANDARD ENGINEERING & TESTING, INC.
 REED ROAD IMPROVEMENTS
 HUNTLEY, ILLINOIS
 MSET PROJECT NO. 88298
 JANUARY 2009

LEGEND

◆ BORING NUMBER	▲ CORE NUMBER
N = Standard Penetration Resistance, blows per foot	
Mc = Moisture Content	
Qu = Unconfined Compressive Strength, tons per square foot (lab)	
Qp = Unconfined Compressive Strength, tons per square foot (field)	
* = Sample tested for Classification	
⊖ = Water Level During Drilling	

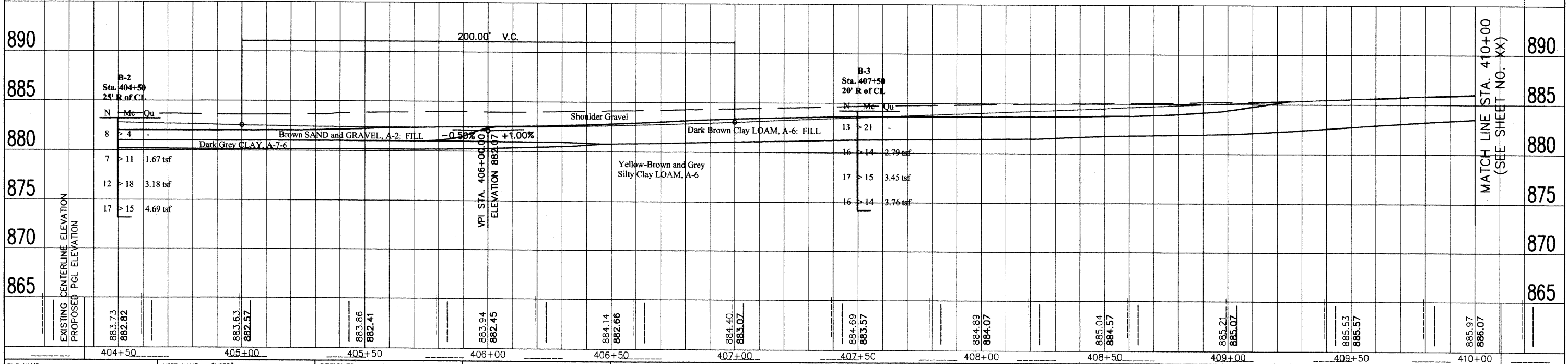

FILE NAME =	USER NAME = \$USER\$	DESIGNED -- EAD	REVISED --	STATE OF ILLINOIS DEPARTMENT OF TRANSPORTATION	REED ROAD -- PLAN & PROFILE	F.A. RTE.	SECTION	COUNTY	TOTAL SHEETS	SHEET NO.
\$FILE\$		DRAWN -- EDS	REVISED --			08-00032-00-RS	MCHENRY	49	28	
		CHECKED -- DNM	REVISED --			CONTRACT NO. 63193				
		DATE -- 5/1/09	REVISED --	SCALE 1"=20'	SHEET NO. 2 OF SHEETS	STA. 404+50 TO STA. 410+00	FED. ROAD DIST. NO. ILLINOIS FED. AID PROJECT			