

LEGEND

WORK AREA	Ⓐ TEMPORARY PAVEMENT MARKING - LINE 4" (DOUBLE YELLOW)
COMPLETED TEMPORARY PAVEMENT	Ⓑ TEMPORARY PAVEMENT MARKING - LINE 4" (SOLID WHITE)
COMPLETED PAVEMENT	Ⓒ TEMPORARY PAVEMENT MARKING - LINE 4" (SOLID YELLOW)
COMPLETED TEMP. RESURFACING	Ⓓ TEMPORARY PAVEMENT MARKING - LINE 6" (SKID-DASH WHITE)
DIRECTION OF TRAFFIC	Ⓔ TEMPORARY PAVEMENT MARKING - LINE 6" (SOLID WHITE)
TRAILER MOUNTED ARROW BOARD	Ⓕ TEMPORARY PAVEMENT MARKING - LINE 6" (2' DASH 6' SKIP, WHITE)
TYPE II BARRICADES WITH STEADY BURN LIGHT	Ⓖ CONSTRUCTION SIGN
TYPE III BARRICADE	▪ VERTICAL PANEL

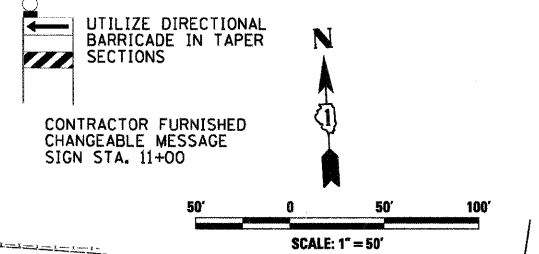

- NOTES**
- ALL STATION/OFFSET CALL-OUTS ARE REFERENCED FROM THE PROPOSED WASHINGTON STREET CENTERLINE UNLESS NOTED WITH AN ASTERISK.
 - REFERENCED FROM EXISTING TRI-STATE PKWY CENTERLINE
 - REFERENCED FROM EXISTING SIX FLAGS DRIVE CENTERLINE
 - ALL EXISTING SPEED LIMIT SIGNS WITHIN THE PROJECT LIMITS ARE TO BE COVERED OR READ "35 MPH."

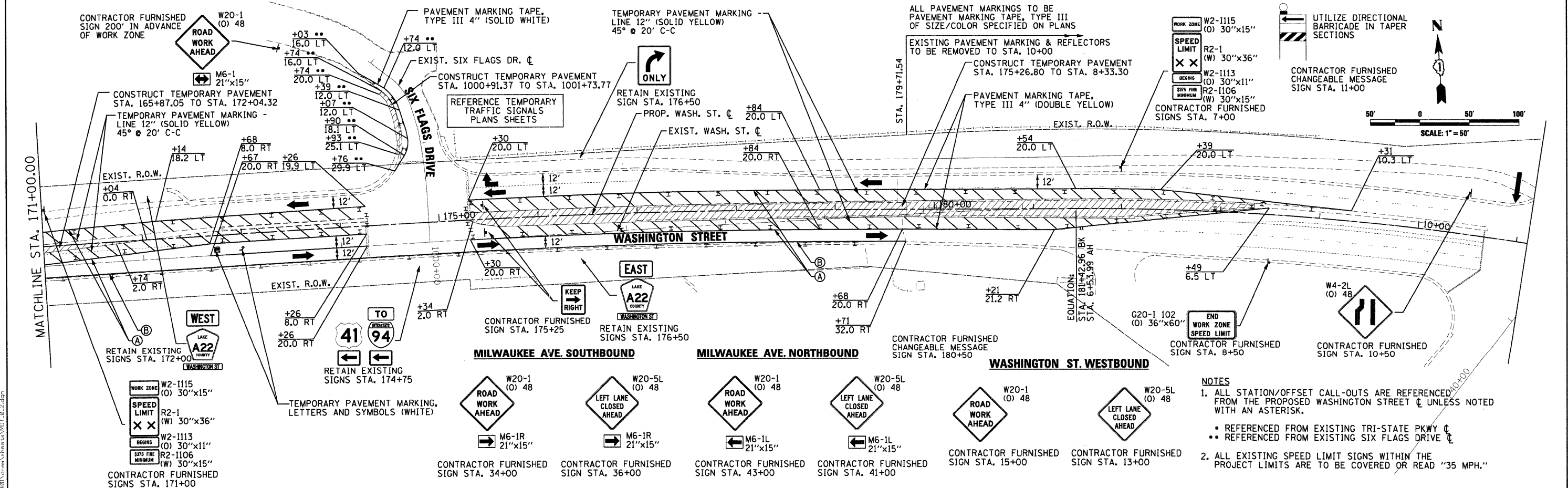
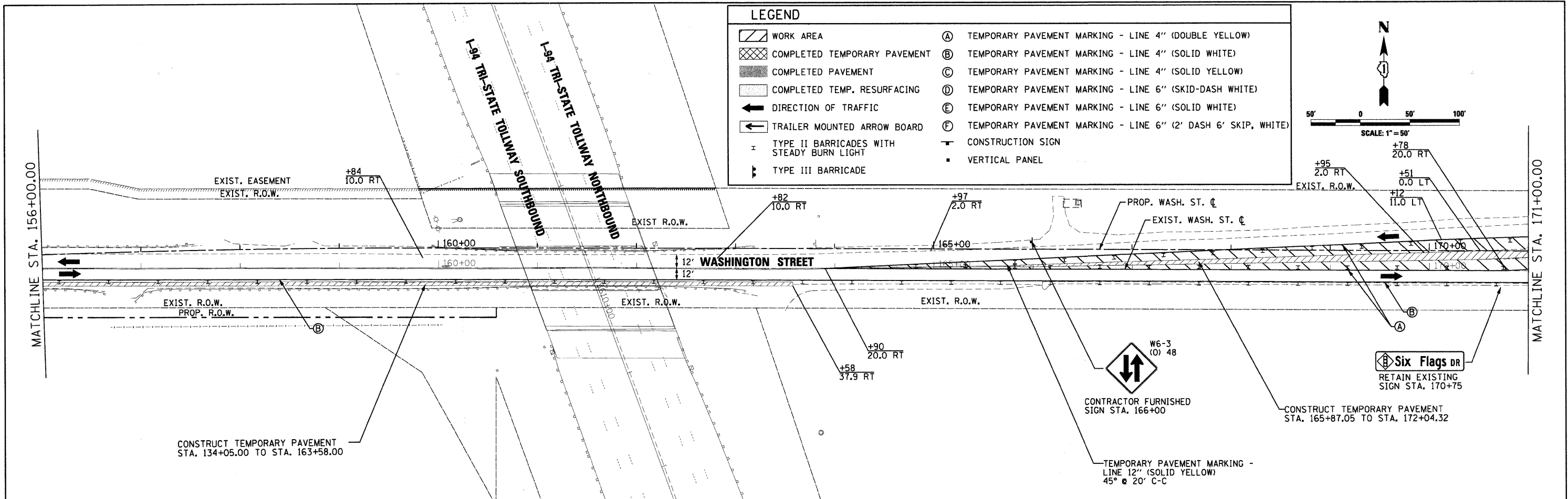
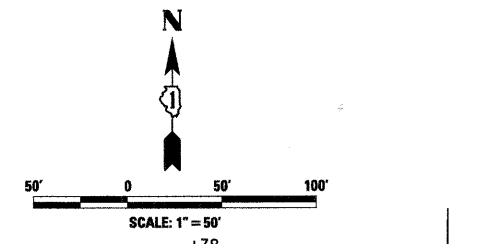

USER NAME = Monica Grinson	DESIGNED - SJP	REVISED -
PLOT SCALE = 5/8" = 1' IN.	DRAWN - SJP	REVISED -
PLOT DATE = 07/15/09	CHECKED - KDN	REVISED -
	DATE - 07/15/09	REVISED -



MAINTENANCE OF TRAFFIC PRE-STAGE PLAN		
SCALE: 50'=1"	SHEET NO. 5 OF 24 SHEETS	STA. 156+00 TO STA. 11+11.03

F.A. RTE.	SECTION	COUNTY	TOTAL SHEETS	SHEET NO.
1016	02-00110-12-WR	LAKE	206	32
FED. ROAD DIST. NO. 1 ILLINOIS FED. AID PROJECT			CONTRACT NO. 63209	