

LEGEND

	WORK AREA	(A)	TEMPORARY PAVEMENT MARKING - LINE 4" (DOUBLE YELLOW)
	COMPLETED TEMPORARY PAVEMENT	(B)	TEMPORARY PAVEMENT MARKING - LINE 4" (SOLID WHITE)
	COMPLETED PAVEMENT	(C)	TEMPORARY PAVEMENT MARKING - LINE 4" (SOLID YELLOW)
	COMPLETED TEMP. RESURFACING	(D)	TEMPORARY PAVEMENT MARKING - LINE 6" (SKID-DASH WHITE)
	DIRECTION OF TRAFFIC	(E)	TEMPORARY PAVEMENT MARKING - LINE 6" (SOLID WHITE)
	TRAILER MOUNTED ARROW BOARD	(F)	TEMPORARY PAVEMENT MARKING - LINE 6" (2' DASH 6' SKIP, WHITE)
	TYPE II BARRICADES WITH STEADY BURN LIGHT		CONSTRUCTION SIGN
	TYPE III BARRICADE		VERTICAL PANEL

W2-1115 (O) 30"x15" WORK ZONE
 R2-1 (W) 30"x36" SPEED LIMIT
 W2-1113 (O) 30"x11" BEGINS
 R2-1106 (W) 30"x15" ENDS
 RETAIN CONTRACTOR FURNISHED SIGN STA. 171+00

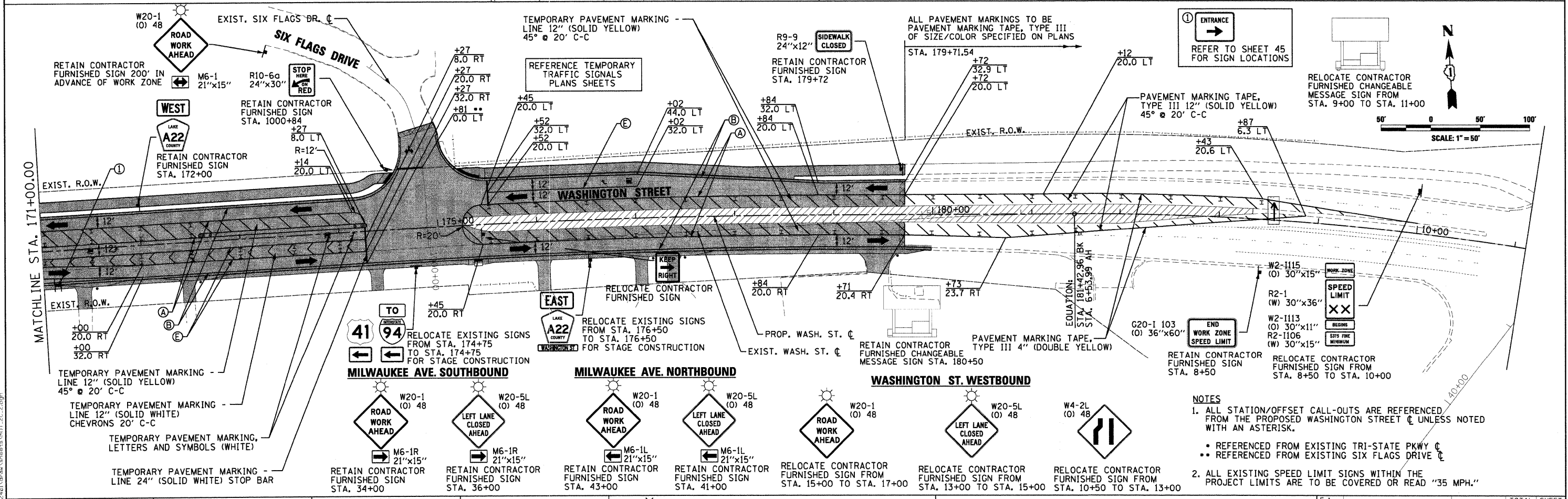
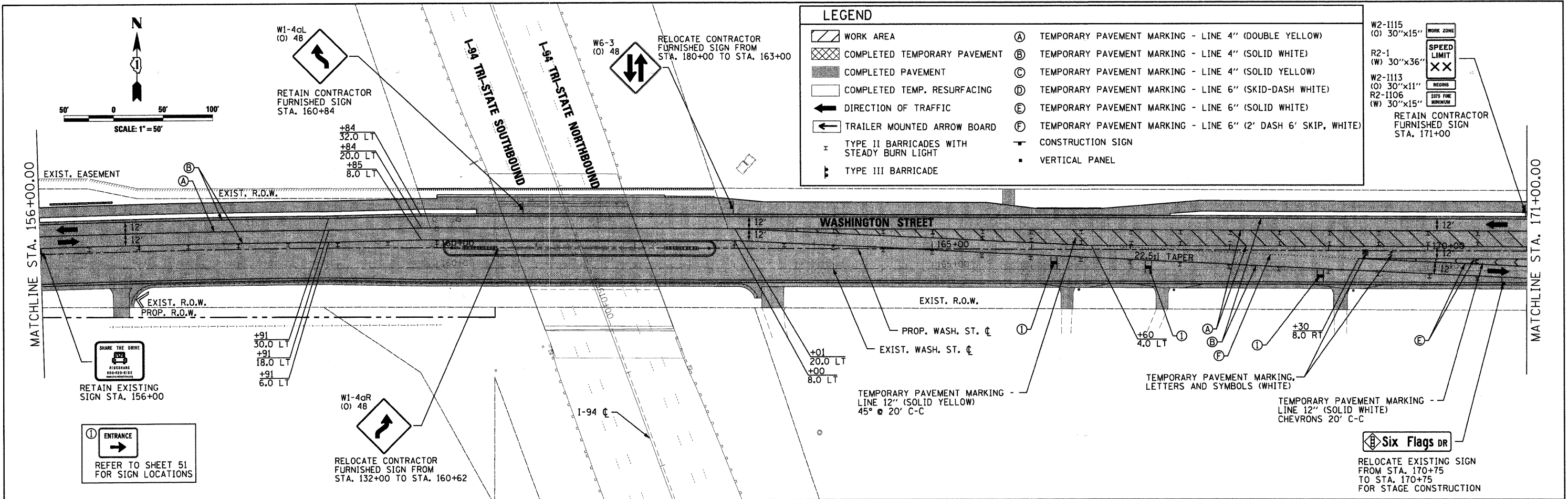

- #### NOTES
- ALL STATION/OFFSET CALL-OUTS ARE REFERENCED FROM THE PROPOSED WASHINGTON STREET C UNLESS NOTED WITH AN ASTERISK.
 - * REFERENCED FROM EXISTING TRI-STATE PKWY C
 - ** REFERENCED FROM EXISTING SIX FLAGS DRIVE C
 - ALL EXISTING SPEED LIMIT SIGNS WITHIN THE PROJECT LIMITS ARE TO BE COVERED OR READ "35 MPH."