

- NOTES:**
1. THE CONTRACTOR SHALL INSTALL TEMPORARY DRAINAGE PIPE TO MAINTAIN DRAINAGE DURING STAGE 1 CONSTRUCTION. COST ASSOCIATED WITH REMOVAL OF TEMPORARY PIPE AND FINAL REPAIR OF TEMPORARY INVERT INTO CATCH BASIN SHALL BE INCLUDED IN THE CONTRACT PRICE FOR THE INSTALLATION OF THE PROPOSED DRAINAGE STRUCTURE AND PIPE PAY ITEMS.
 2. PERMANENT DRAINAGE STRUCTURE SHALL BE PRE-FABRICATED TO ACCOMMODATE THE TEMPORARY PIPE INVERT AS SHOWN ON THIS PLAN SHEET.

LEGEND	
	INLET PROTECTION, SPECIAL
	PERIMETER EROSION BARRIER
	TREE PROTECTION
	TEMPORARY DITCH CHECK
	TEMPORARY PIPE PLUG FOR STAGED CONSTRUCTION
	DITCH FLOW LINE
	STONE RIPRAP WITH FILTER FABRIC (SEE EROSION CONTROL DETAILS)
	GENERAL RESTORATION
	EROSION CONTROL BLANKET
	TEMPORARY PAVEMENT COMPLETED IN PRE-STAGE

PROPOSED TEMPORARY STORM SEWER, CLASS A, TYPE 1, 12" W/ END SECTION (32 LF)
 S. INV.= 708.37
 N. INV.= 707.00
 (SEE NOTE 1 & 2)

STA. 137+15.00
 OFF. 58.00' LT

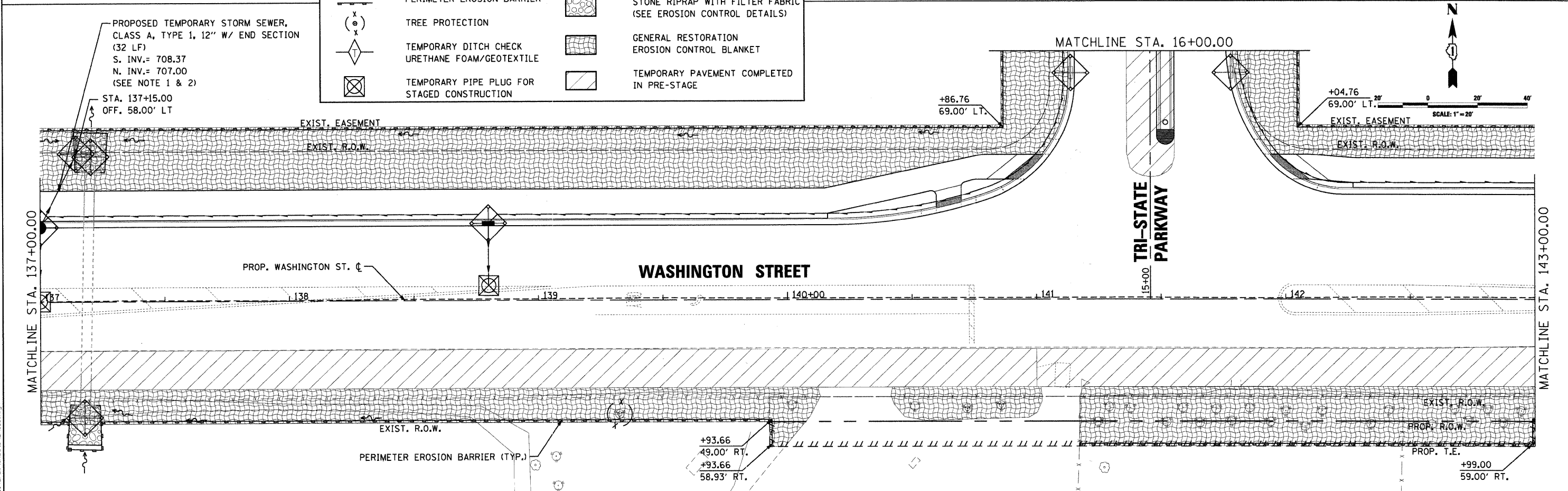

CMT
 CRAWFORD, MURPHY & TILLY, INC.
 CONSULTING ENGINEERS
 License No. 084-000613

USER NAME = Steve Prange	DESIGNED - SJP	REVISED -
PLOT SCALE = 20.0000' / 1" IN.	DRAWN - SJP	REVISED -
PLOT DATE = 05/29/09	CHECKED - KDN	REVISED -
	DATE - 05/29/09	REVISED -



STAGE 1 - EROSION CONTROL PLAN		
SCALE: 20'=1"	SHEET NO. 1 OF 5 SHEETS	STA. 131+00 TO STA. 143+00

F.A. RTE. 1016	SECTION 02-00110-12-WR	COUNTY LAKE	TOTAL SHEETS 206	SHEET NO. 87
CONTRACT NO. 63209				
FED. ROAD DIST. NO. 1 ILLINOIS FED. AID PROJECT				