

- NOTES:**
1. CONTRACTOR SHALL MAINTAIN POSITIVE DRAINAGE FROM THE PROPOSED BOX CULVERT TO EXISTING CULVERT REMAINING DURING STAGE 1 CONSTRUCTION. THE COST TO MAINTAIN POSITIVE DRAINAGE AND PROVIDE THE NECESSARY EROSION CONTROL MEASURES SHALL BE INCLUDED IN THE CONTRACT PRICE FOR MAINTENANCE OF TEMPORARY EROSION CONTROL SYSTEMS.
  2. THE CONTRACTOR SHALL INSTALL TEMPORARY DRAINAGE PIPE TO MAINTAIN DRAINAGE DURING STAGE 1 CONSTRUCTION. COST ASSOCIATED WITH REMOVAL OF TEMPORARY PIPE AND FINAL PLUG/FILL OF TEMPORARY INVERT INTO CATCH BASIN AND INLET SHALL BE INCLUDED IN THE CONTRACT PRICE FOR THE INSTALLATION OF THE PROPOSED DRAINAGE STRUCTURE AND PIPE PAY ITEMS.
  3. PERMANENT DRAINAGE STRUCTURES SHALL BE PRE-FABRICATED TO ACCOMODATE THE TEMPORARY PIPE INVERTS AS SHOWN ON THIS PLAN SHEET.

**LEGEND**

	INLET PROTECTION, SPECIAL		DITCH FLOW LINE
	PERIMETER EROSION BARRIER		STONE RIPRAP WITH FILTER FABRIC (SEE EROSION CONTROL DETAILS)
	TREE PROTECTION		GENERAL RESTORATION EROSION CONTROL BLANKET
	TEMPORARY DITCH CHECK URETHANE FOAM/GEOTEXTILE		TEMPORARY PAVEMENT WIDENING COMPLETED IN PRE-STAGE
	TEMPORARY PIPE PLUG FOR STAGED CONSTRUCTION		

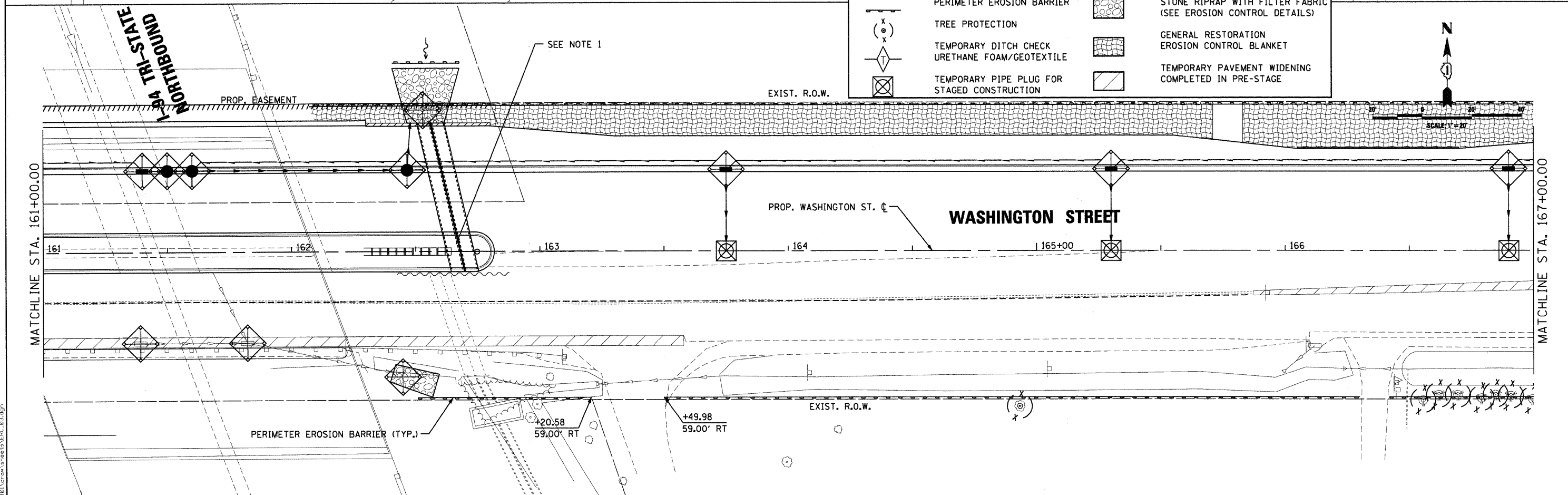

FILE NAME = I:\Projects\02-00110-12-WR\Drawings\Sheet\EROC.dwg

<b>CMT</b> CRAWFORD, MURPHY & TOLLY, INC. CONSULTING ENGINEERS License No. 084-000613	USER NAME = Monica Crislin DESIGNED - SJP DRAWN - SJP CHECKED - KDN DATE = 07/15/09	REVISED - REVISED - REVISED - REVISED -	<b>LakeCounty</b> Division of Transportation	<b>STAGE 1 - EROSION CONTROL PLAN</b>		F.A. RTE. 1016 SECTION 02-00110-12-WR COUNTY LAKE TOTAL SHEETS 206 SHEET NO. 89 CONTRACT NO. 63209
	SCALE: 20'=1" SHEET NO. 3 OF 5 SHEETS STA. 155+00 TO STA. 167+00			FED. ROAD DIST. NO. 1 ILLINOIS FED. AID PROJECT		