

CONSTRUCTION STAGING - PRE STAGE

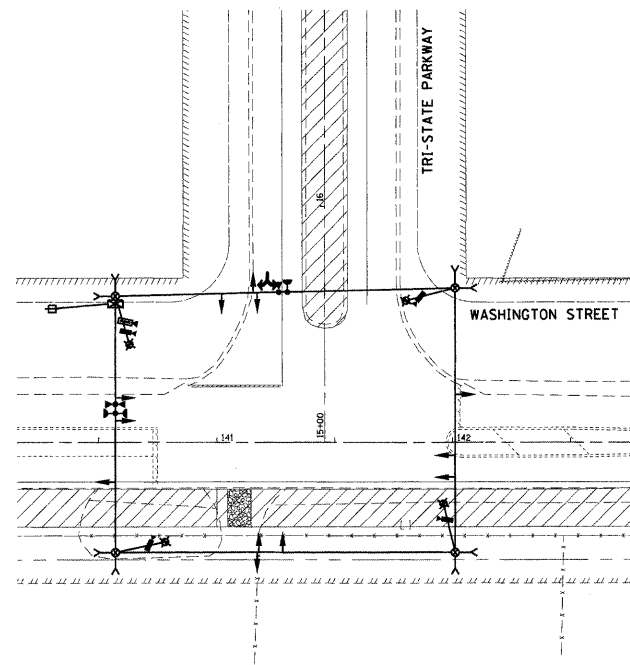

CONSTRUCTION STAGING - STAGE 1A

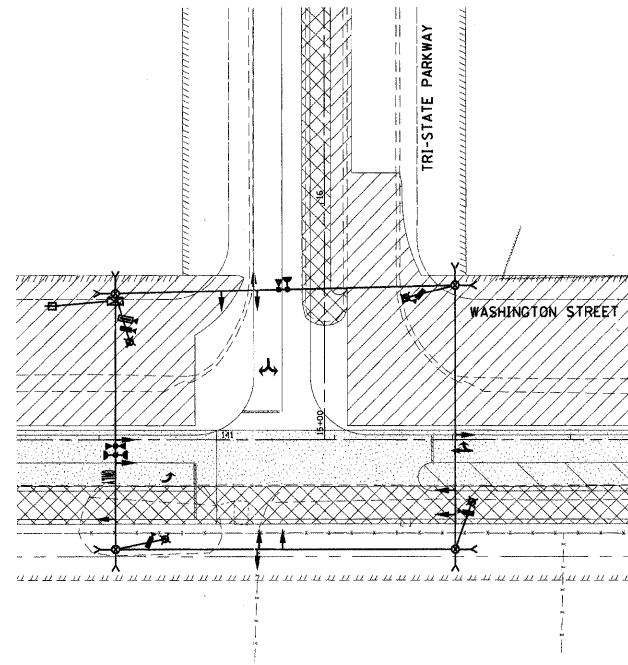

CONSTRUCTION STAGING - STAGE 1B

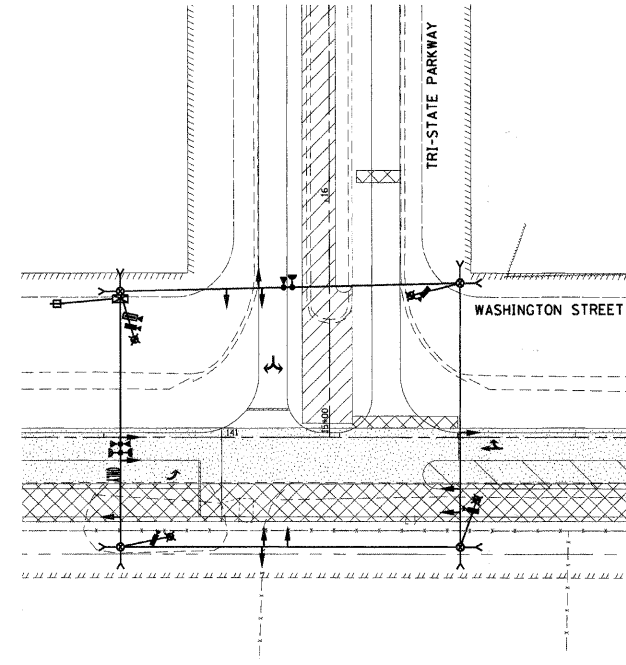

CONSTRUCTION STAGING - STAGE 1C

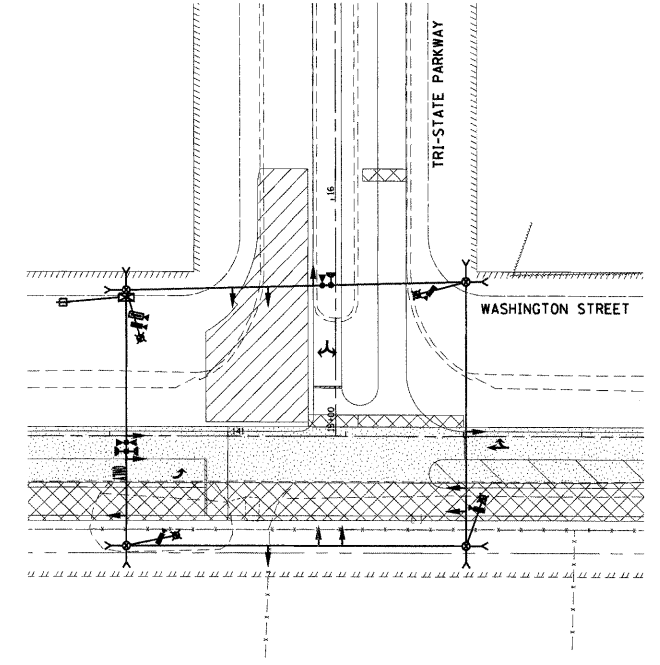

CONSTRUCTION STAGING - STAGE 2A

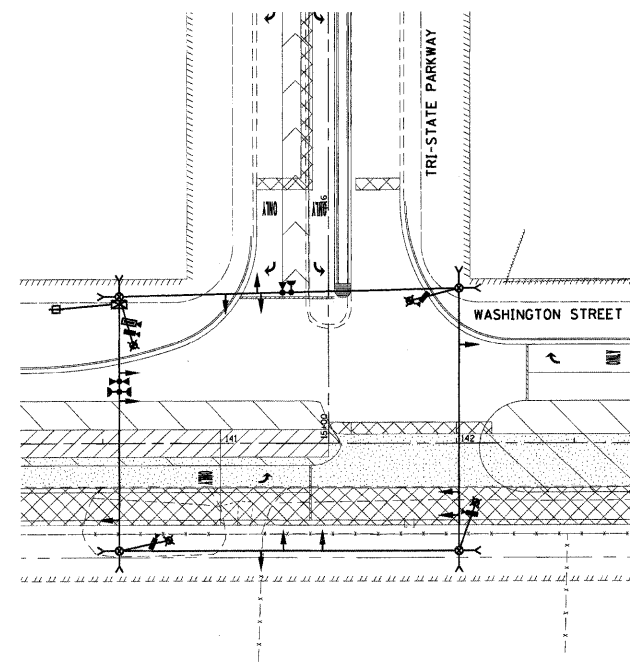

CONSTRUCTION STAGING - STAGE 2B

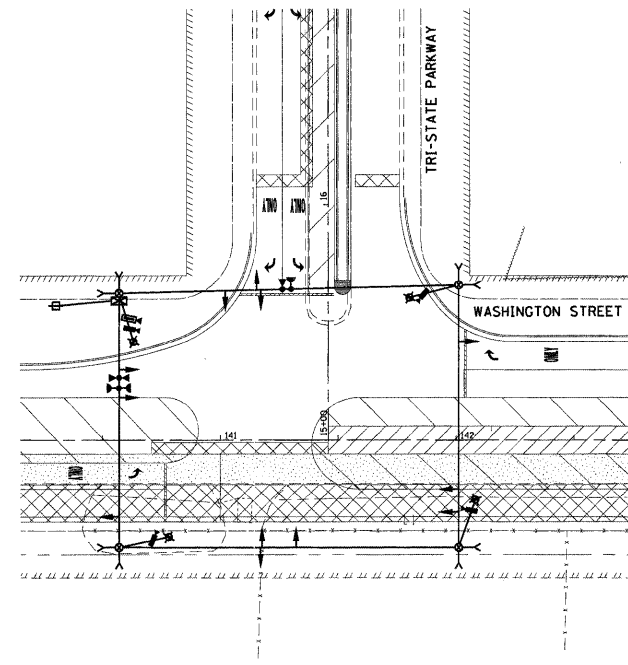

CONSTRUCTION STAGING - STAGE 2C

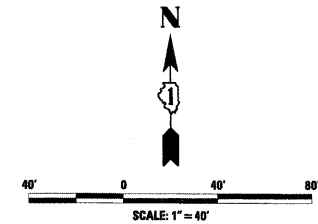
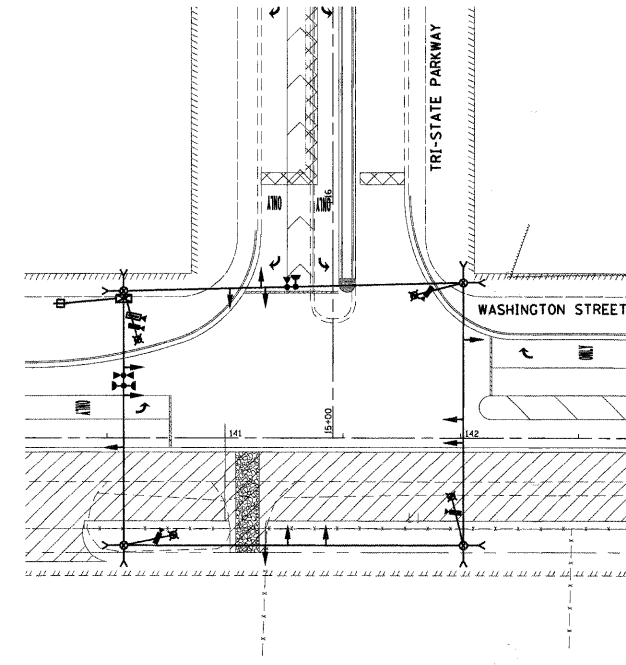

TEMPORARY TRAFFIC SIGNAL LEGEND

- ← TEMPORARY TRAFFIC SIGNAL HEAD SPAN WIRE MOUNTED
- ▶ EMERGENCY VEHICLE LIGHT DETECTOR
- ▶ CONFIRMATION BEACON
- ▶ TEMPORARY PEDESTRIAN SIGNAL HEAD, BRACKET MOUNTED
- PEDESTRIAN PUSH BUTTON DETECTOR
- TEMPORARY WOOD POLE (CLASS 5 OR BETTER) 45 FOOT MINIMUM
- ☒ TEMPORARY CONTROLLER CABINET
- TEMPORARY SPAN WIRE, TETHER WIRE, AND CABLE
- ⊕ TEMPORARY SERVICE INSTALLATION
- ⊗ TEMPORARY LUMINARE AND MAST (MOUNTED ON WOOD POLE)
- IMAGE SENSOR
- DOME PAN/TILT/ZOOM (PTZ) CAMERA
- ▨ WORK AREA
- ▩ TEMPORARY PAVEMENT
- ▧ EXISTING PAVEMENT - MILLED AND RESURFACED

FILE NAME: J:\Lake\63209\63209\_12.dwg  
 USER: Steve Prange  
 PLOT DATE: 05/29/09



USER NAME = Steve Prange	DESIGNED - CMC	REVISED -
PLOT SCALE = 40,0000' / IN.	DRAWN - CMC	REVISED -
PLOT DATE = 05/29/09	CHECKED - KDN	REVISED -
	DATE - 05/29/09	REVISED -



**WASHINGTON STREET - TEMPORARY SIGNAL PLAN**  
**WASHINGTON STREET AT TRI-STATE PARKWAY**

SCALE: SHEET NO. OF SHEETS STA. TO STA.

F.A. RTE.	SECTION	COUNTY	TOTAL SHEETS	SHEET NO.
1016	02-00110-12-WR	LAKE	206	94
FED. ROAD DIST. NO. 1 ILLINOIS FED. AID PROJECT			CONTRACT NO. 63209	