

INTERCONNECT PLAN LEGEND

	PROPOSED	EXISTING
CONTROLLER		
UNIT DUCT	UD	
HANDHOLE		
HEAVY DUTY HANDHOLE		
DOUBLE HANDHOLE		
G.S. CONDUIT	---	===
HANDHOLE TO BE REMOVED		"E"
WOOD POLE - SIGNAL		
WOOD POLE - INTERCONNECT		
TEMPORARY INTERCONNECT - AERIALY INSTALLED	---	

STRUCTURE	STATION	OFFSET	POSSIBLE UTILITY CONFLICTS
WP-1	177+90	64' LT	WATERMAIN, COMED/COMCAST/SBC AERIAL
WP-2	179+89	57' LT	NONE

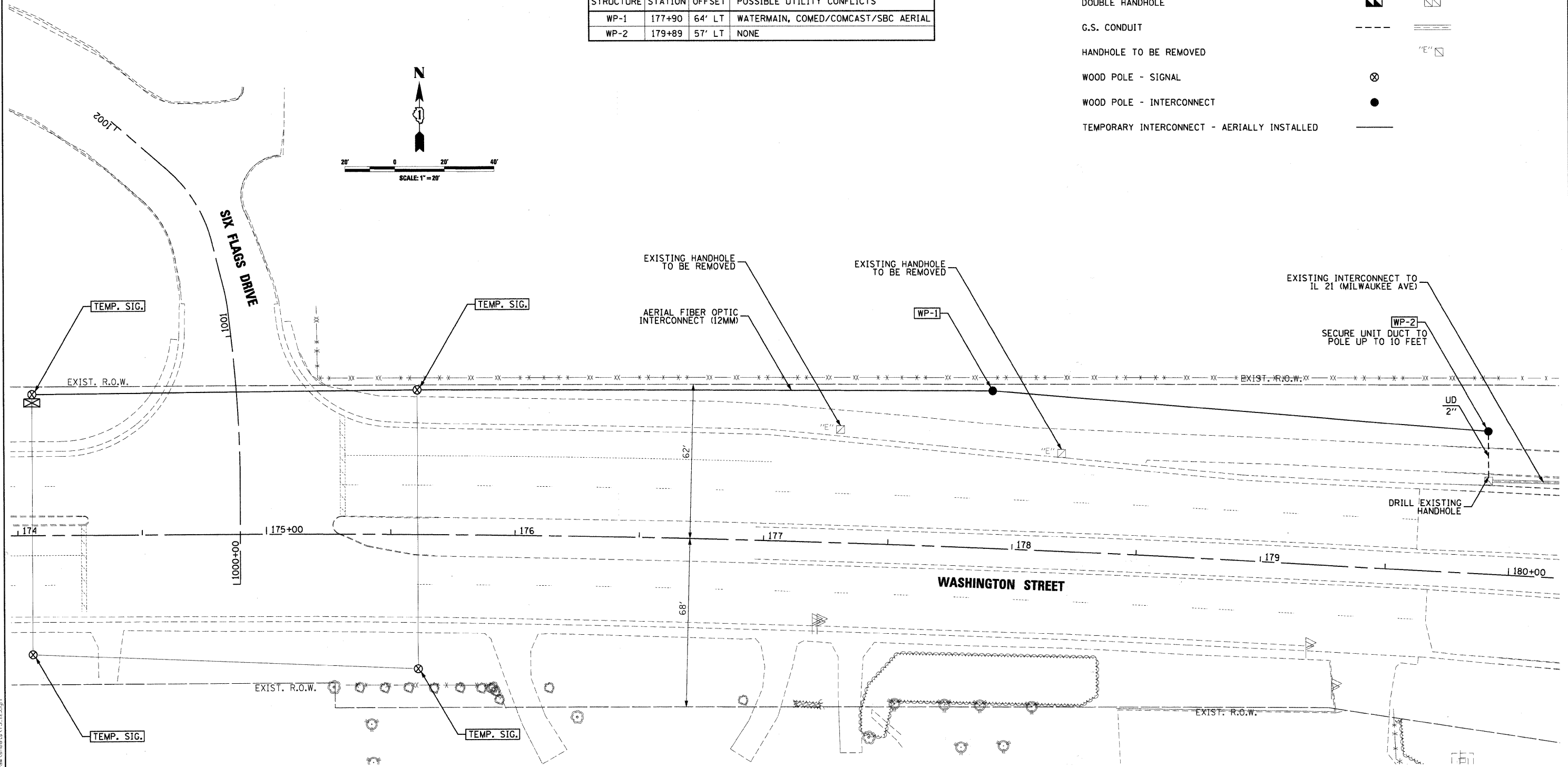
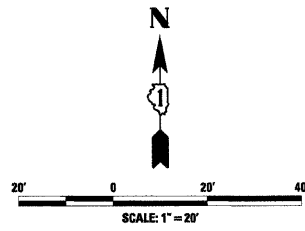

FILE NAME = I:\Lakeco\0822401\Drawn\Interconnect\IS\_12.dgn

<p><b>CMT</b> CRAWFORD, MURPHY &amp; TILLY, INC. CONSULTING ENGINEERS License No. 184-00063</p>	USER NAME = Monica Crinion PLOT SCALE = 20.0000' / IN. PLOT DATE = 07/15/09	DESIGNED - CMC DRAWN - CMC CHECKED - KDN DATE - 07/15/09	REVISED - REVISED - REVISED - REVISED -	<p><b>LakeCounty</b> Division of Transportation</p>	<p><b>WASHINGTON STREET - TEMPORARY INTERCONNECT PLAN</b> <b>WASHINGTON STREET AT SIX FLAGS DRIVE</b></p> SCALE: SHEET NO. OF SHEETS STA. TO STA.	F.A. RTE. 1016 SECTION 02-00110-12-WR COUNTY LAKE TOTAL SHEETS 206 SHEET NO. 104	CONTRACT NO. 63209 FED. ROAD DIST. NO. 1 ILLINOIS FED. AID PROJECT
	WASHINGTON STREET - TEMPORARY INTERCONNECT PLAN WASHINGTON STREET AT SIX FLAGS DRIVE					F.A. RTE. 1016 SECTION 02-00110-12-WR COUNTY LAKE TOTAL SHEETS 206 SHEET NO. 104	