

DATE	
BY	
FINISHED SURVEY	
NOTED	
PLOTTED	
TEMPLATE	
AREAS	
CHECKED	

DATE	
BY	
ORIGINAL SURVEY	
NOTED	
PLOTTED	
TEMPLATE	
AREAS	
CHECKED	

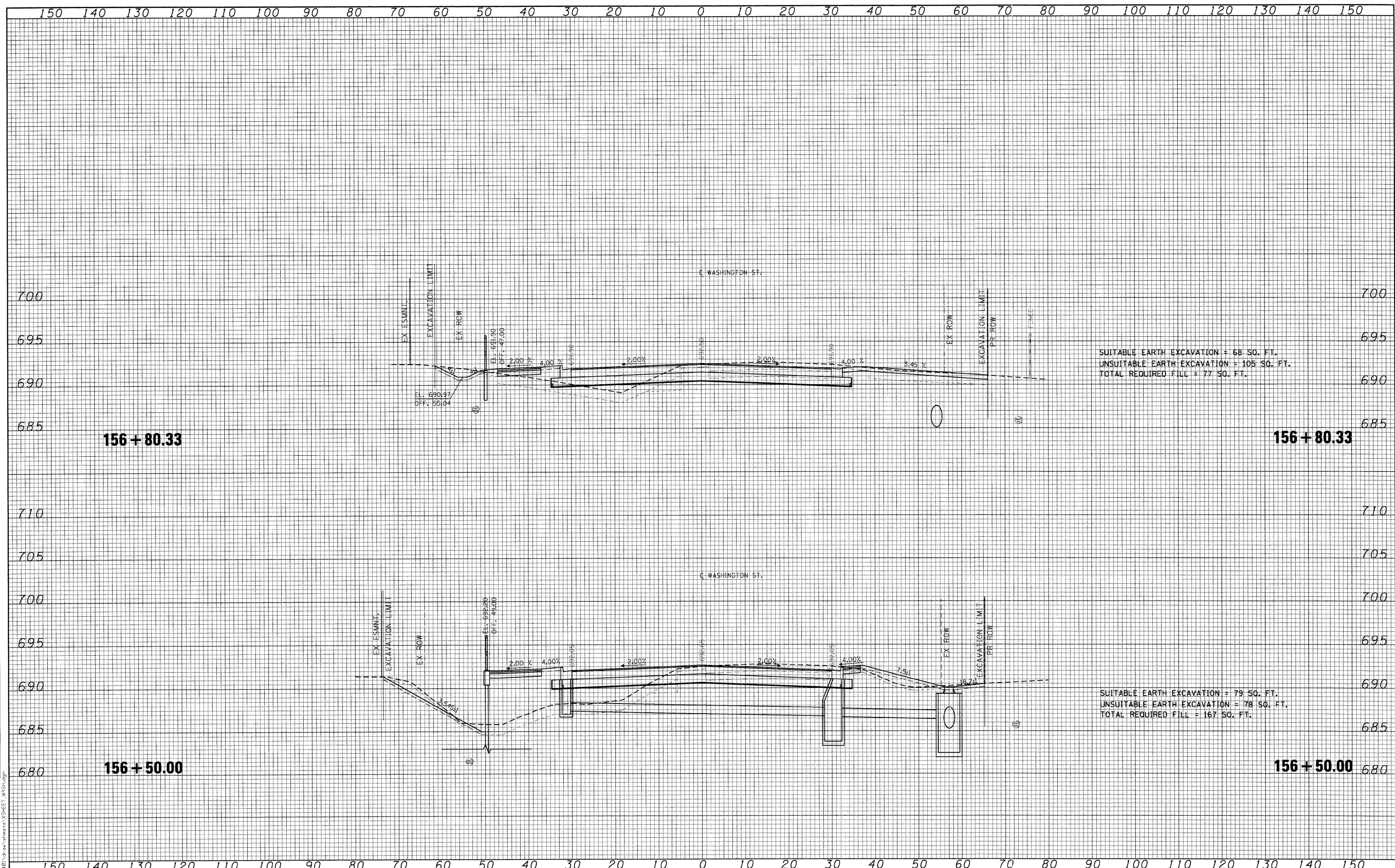

SUITABLE EARTH EXCAVATION = 68 SQ. FT.
 UNSUITABLE EARTH EXCAVATION = 105 SQ. FT.
 TOTAL REQUIRED FILL = 77 SQ. FT.

SUITABLE EARTH EXCAVATION = 79 SQ. FT.
 UNSUITABLE EARTH EXCAVATION = 78 SQ. FT.
 TOTAL REQUIRED FILL = 167 SQ. FT.

FILE NAME = I:\projects\08022401\Drawings\156+50.00\156+50.00.dgn
 CMT CRAWFORD, MURPHY & TILLY, INC.
 CONSULTING ENGINEERS
 License No. 184-000613

USER NAME = Steve Prange	DESIGNED - SJP	REVISED -
PLOT SCALE = 10.0000' / 1"	DRAWN - SJP	REVISED -
PLOT DATE = 05/29/09	CHECKED - KDN	REVISED -
	DATE - 05/29/09	REVISED -

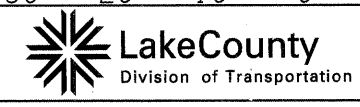

WASHINGTON STREET - CROSS SECTION
 SCALE: 10H:5V SHEET NO. OF SHEETS STA. 156+50.00 TO STA. 156+80.33

F.A. RTE. 1016	SECTION 02-00110-12-WR	COUNTY LAKE	TOTAL SHEETS 206	SHEET NO. 144
FED. ROAD DIST. NO. 1 ILLINOIS FED. AID PROJECT				

CONTRACT NO. 63209