

FAU RTE 1369	SECTION	COUNTY	TOTAL SHEETS	SHEET NO.
SCHICK RD.	09-00057-00-RS	DUPAGE	15	1
F.H.W.A. REG. ILLINOIS	PROJECT NO. ARA-9003(440)			

CONTRACT NO. 63252

STATE OF ILLINOIS DEPARTMENT OF TRANSPORTATION DIVISION OF HIGHWAYS PLANS FOR PROPOSED FEDERAL AID HIGHWAY

SCHICK ROAD (FAU 1369)
[FROM LORRAINE CIRCLE (FAU 2575) TO GARY AVE]
LAPP RESURFACING
PROJECT NO. ARA-9003(440)
SECTION NO. 09-00057-00-RS
VILLAGE OF BLOOMINGDALE
DUPAGE COUNTY
JOB NO. C-91-871-09

INDEX OF SHEETS

- 1) COVER SHEET, INDEX OF SHEETS, LOCATION MAP
- 2) GENERAL NOTES
- 3) TYPICAL SECTIONS
- 4) SUMMARY OF QUANTITIES
- 5) SCHICK ROAD OVERLAY & STORM SEWER PLAN(STA. 5+50 TO 34+89)
- 6) SCHICK ROAD OVERLAY & STORM SEWER PLAN (STA. 34+89 TO 63+75)
- 7) SCHICK ROAD STRIPING PLAN(STA. 5+50 TO 34+89)
- 8) SCHICK ROAD STRIPING PLAN (STA. 34+89 TO 63+75)
- 9) CURB AND GUTTER REMOVAL AND REPLACEMENT
- 10) DISTRICT ONE TYPICAL PAVEMENT MARKINGS
- 11) TRAFFIC CONTROL AND PROTECTION FOR SIDE ROADS INTERSECTIONS AND DRIVEWAYS
- 12) DETAILS FOR FRAMES AND LIDS ADJUSTMENT WITH MILLING
- 13) BUTT JOINT AND HMA TAPER DETAILS
- 14) PAVEMENT MARKING LETTERS AND SYMBOLS
- 15) DISTRICT I - DETECTOR LOOP INSTALLATION

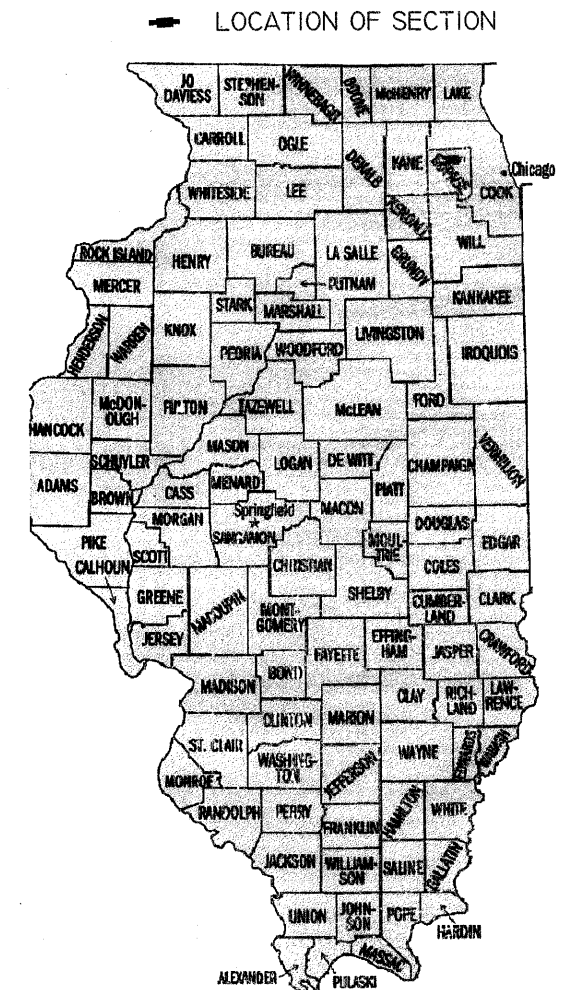

IMPROVEMENT BEGINS
STA. 5+50

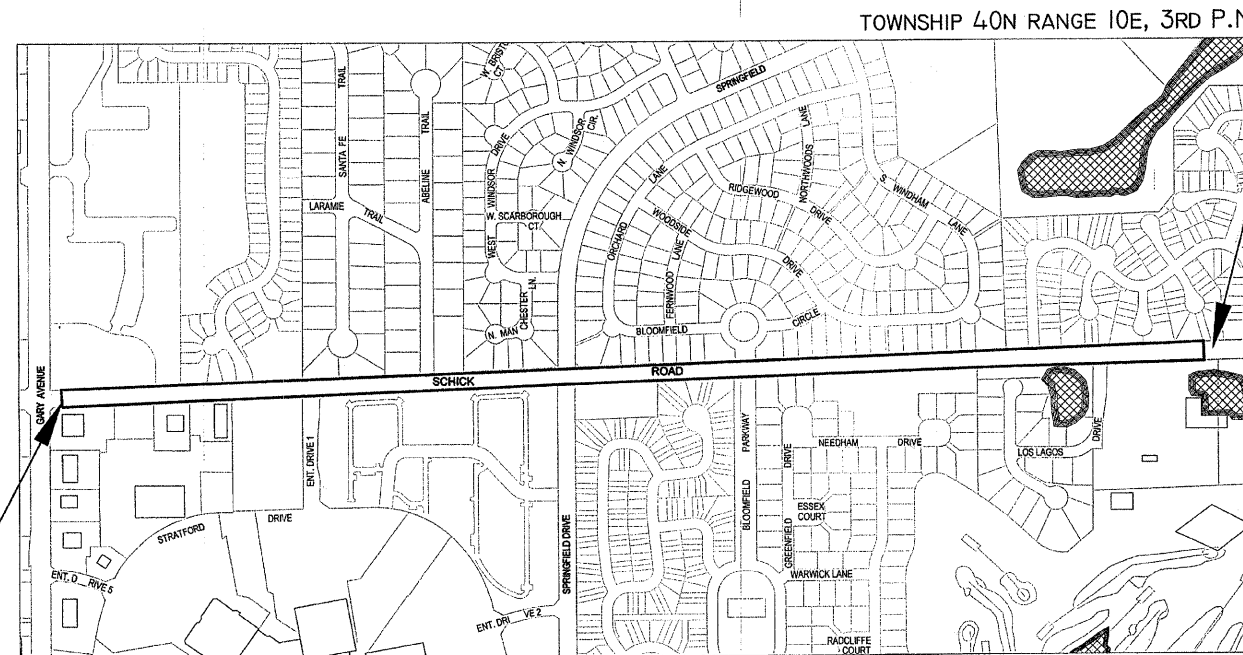

IMPROVEMENT ENDS
STA. 63+75

LOCATION MAP NOT TO SCALE

LENGTH OF IMPROVEMENT
GROSS AND NET = 5922 FT. = 1.12 MILES
2008 ADT = 25,000
DESIGN & POSTED SPEED LIMIT = 35 MPH

FOR UNDERGROUND UTILITY
LOCATIONS CALL
J.U.L.I.E.
TOLL FREE
TEL 1-800-892-0123

REDUCED SIZE PLANS WILL NOT
CONFORM TO STANDARD
SCALES.

CONTRACT NO. 63252

PREPARED BY: **VILLAGE OF BLOOMINGDALE**

201 S. BLOOMINGDALE RD.
BLOOMINGDALE ILLINOIS 60108
(630) 893-7073

ILLINOIS DEPARTMENT OF TRANSPORTATION	
APPROVED	<i>[Signature]</i> VILLAGE OF BLOOMINGDALE
PASSED	July 22, 2009 <i>[Signature]</i> DISTRICT ONE ENGINEER OF LOCAL ROADS AND STREETS
RELEASING FOR BID BASED ON LIMITED REVIEW	July 22, 2009 <i>[Signature]</i> DEPUTY DIRECTOR OF HIGHWAYS, REGION ONE ENGINEER

PROFESSIONAL ENGINEER'S SIGN & SEAL

PRINTED BY THE AUTHORITY OF
THE STATE OF ILLINOIS

FIELD ENGINEER: MARILIN SOLOMON 847-705-4407