

STA. 9+21.7  
BEGIN PROJECT

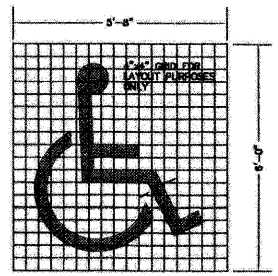

DISABLED SYMBOL DETAIL

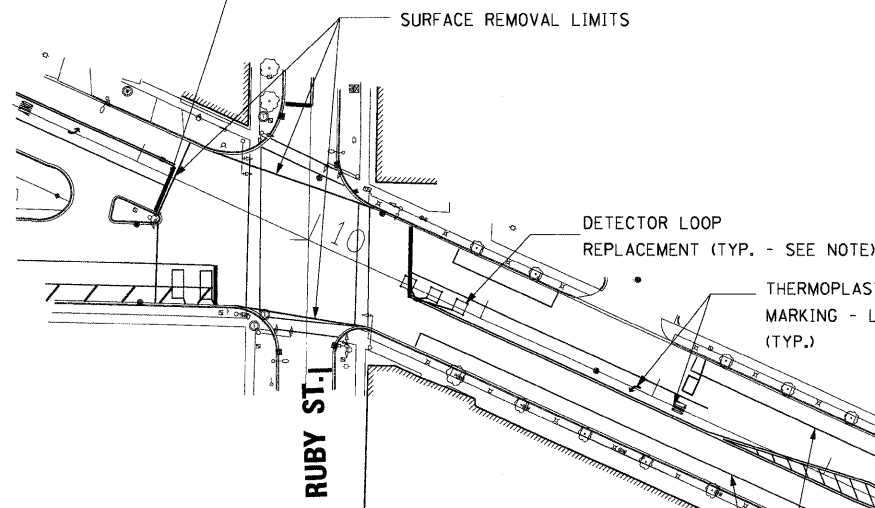
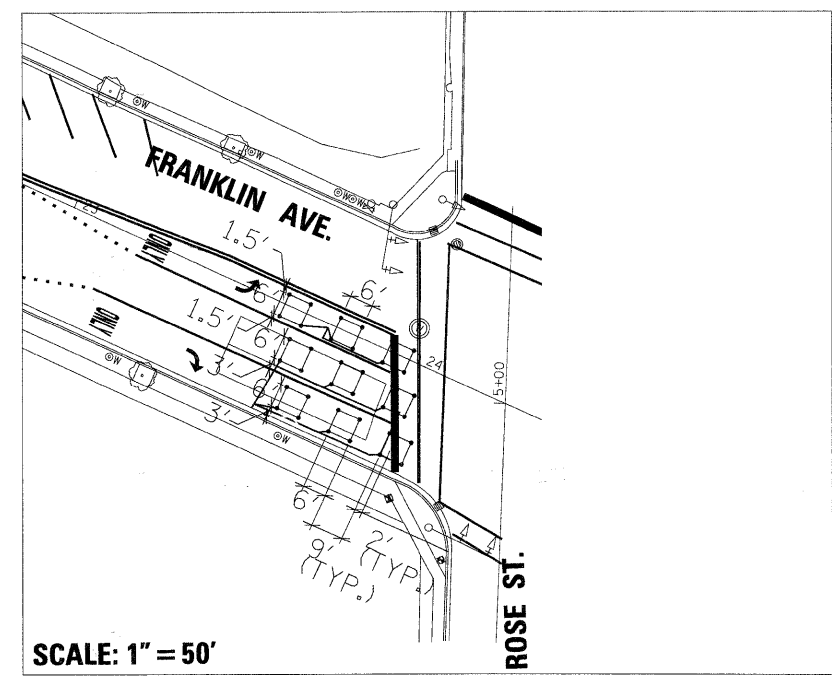

ROSE ST. DETECTOR LOOP DETAIL

SCALE: 1" = 50'

RUBY ST. DETECTOR LOOP DETAIL

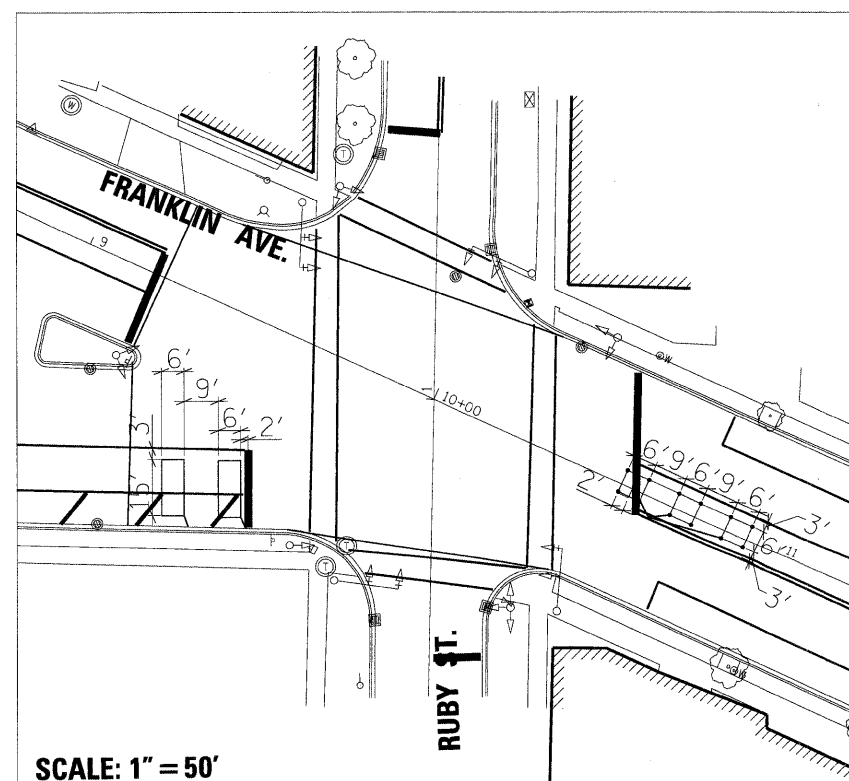

SCALE: 1" = 50'

THERMOPLASTIC PAVEMENT MARKING - LINE 4" (TYP.)  
ATLANTIC ST.  
THERMOPLASTIC PAVEMENT MARKING - LINE 4" (TYP.)  
16 SPACES, 1 DISABLED ON EACH SIDE

THERMOPLASTIC PAVEMENT MARKING - LINE 4" (DOUBLE LINE) (TYP.)  
CALWAGNER ST.

SURFACE REMOVAL LIMITS (TYP.)

THERMOPLASTIC PAVEMENT MARKING - LINE 24" (TYP.)  
14 SPACES, 1 DISABLED

17 SPACES, 1 DISABLED

GUSTAV ST.

17 SPACES

6 SPACES  
THERMOPLASTIC PAVEMENT MARKING - LINE 6" (TYP.)

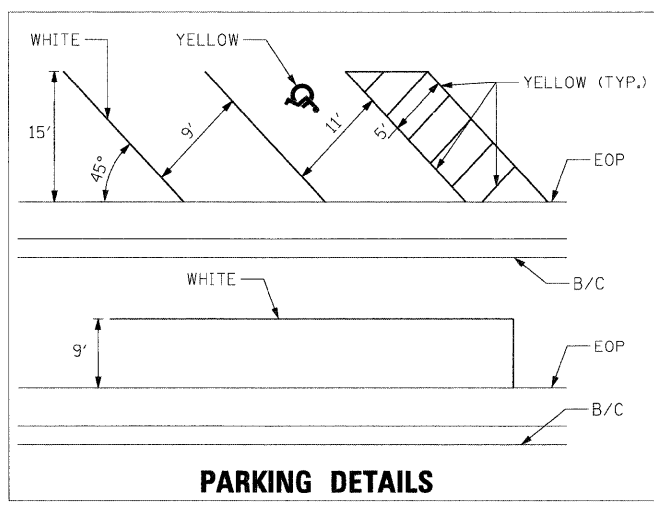

PARKING DETAILS

NOTE: SEE DISTRICT ONE TYPICAL PAVEMENT MARKINGS DETAILS AND DETECTOR LOOP INSTALLATION DETAILS FOR MORE INFORMATION

STA 24+00.0  
END PROJECT

FILE NAME =	USER NAME = #USER#	DESIGNED -	REVISED -	STATE OF ILLINOIS DEPARTMENT OF TRANSPORTATION				FRANKLIN AVENUE PAVEMENT MARKING & DETECTOR LOOP DETAILS		F.A.U. R.T.E. =	SECTION	COUNTY	TOTAL SHEETS	SHEET NO.
pi:\12140450 - franklin ave resurfacing\plans\sheet\F0140450.smp\0101.dgn	PLT SCALE = 50.0000' / IN.	DRAWN -	REVISED -							3533	09-00070-00-RS	COOK	16	9
	PLT DATE = 7/14/2009	CHECKED -	REVISED -	SCALE: 1" = 100'				SHEET NO. 1 OF 1 SHEETS	STA. TO STA.	ILLINOIS		CONTRACT NO. 63254		
		DATE -	REVISED -							FED. AID PROJECT				