

**EXISTING TOPOGRAPHY**

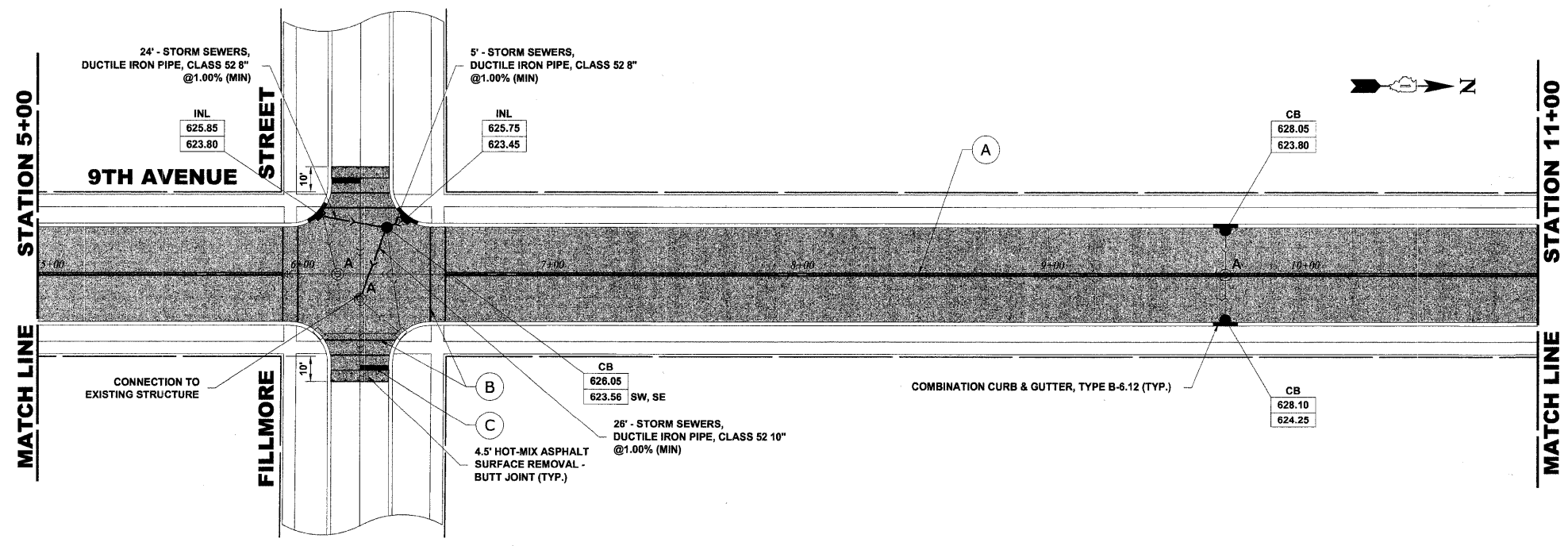

PAVEMENT MARKING LEGEND	
ITEM DESCRIPTION	SYMBOL
THERMOPLASTIC PAVEMENT MARKING LINE 4", DOUBLE @ 11" C-C, YELLOW	(A)
THERMOPLASTIC PAVEMENT MARKING LINE 6", CROSS WALK, WHITE	(B)
THERMOPLASTIC PAVEMENT MARKING LINE 24", STOP BAR, WHITE	(C)
THERMOPLASTIC PAVEMENT MARKING LINE 6", TURN LANE LINE, WHITE	(D)
THERMOPLASTIC PAVEMENT MARKING, LETTERS AND SYMBOLS, WHITE	(E)
THERMOPLASTIC PAVEMENT MARKING LINE 4", PARKING LINE, YELLOW	(F)

**PROPOSED IMPROVEMENTS**

Drawing file: W:\Projects\65509072 - 9TH Avenue\_ABA-LAPP\9thAvenue\_w\_utilities.dwg Jul 20, 2009 - 9:05am

**HANCOCK ENGINEERING**  
 Civil Engineers  
 Municipal Consultants  
 Established 1911

USER NAME	DESIGNED <b>CH</b>	REVISED
	DRAWN <b>MK</b>	REVISED
PLOT SCALE	CHECKED <b>CH</b>	REVISED
PLOT DATE	DATE <b>4-21-09</b>	REVISED

**STATE OF ILLINOIS  
 DEPARTMENT OF TRANSPORTATION**

**PAVING PLAN**

SCALE: 1"=30" SHEET NO. 2 OF 4 SHEETS STA. 5+00 TO STA. 11+00

F.A.U. RTE.	SECTION	COUNTY	TOTAL SHEETS	SHEET NO.
2733	09-00131-00-RS	COOK	17	8
FED. ROAD DIST. NO. 1 ILLINOIS FED. AID PROJECT			CONTRACT NO. 63255	
E.H.E. PROJECT NO. 565-09-07201				