

VERMILION COUNTY

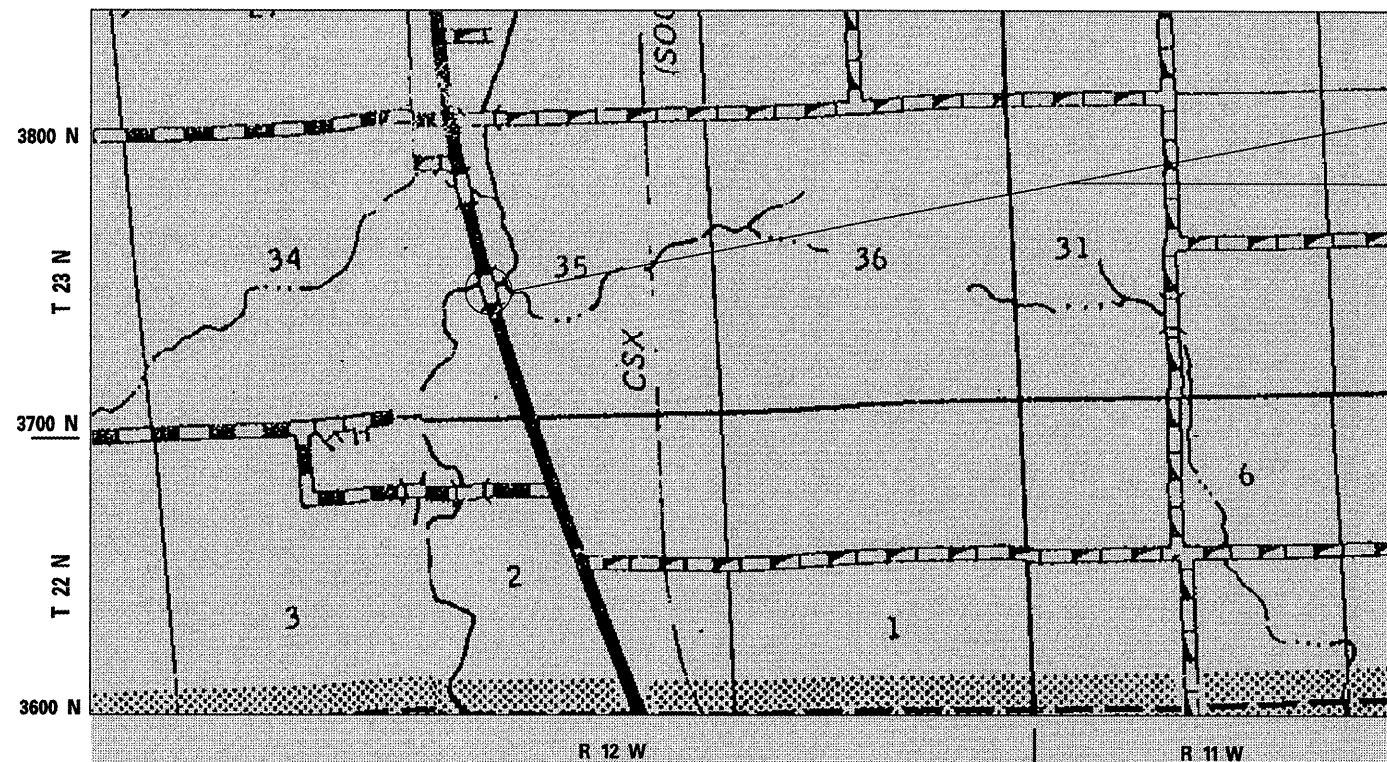

SECTION: D5 SCOUR MITIGATION  
LOCATION #3

S.N. 092-0033  
STATION 909+81.00

VERMILION COUNTY

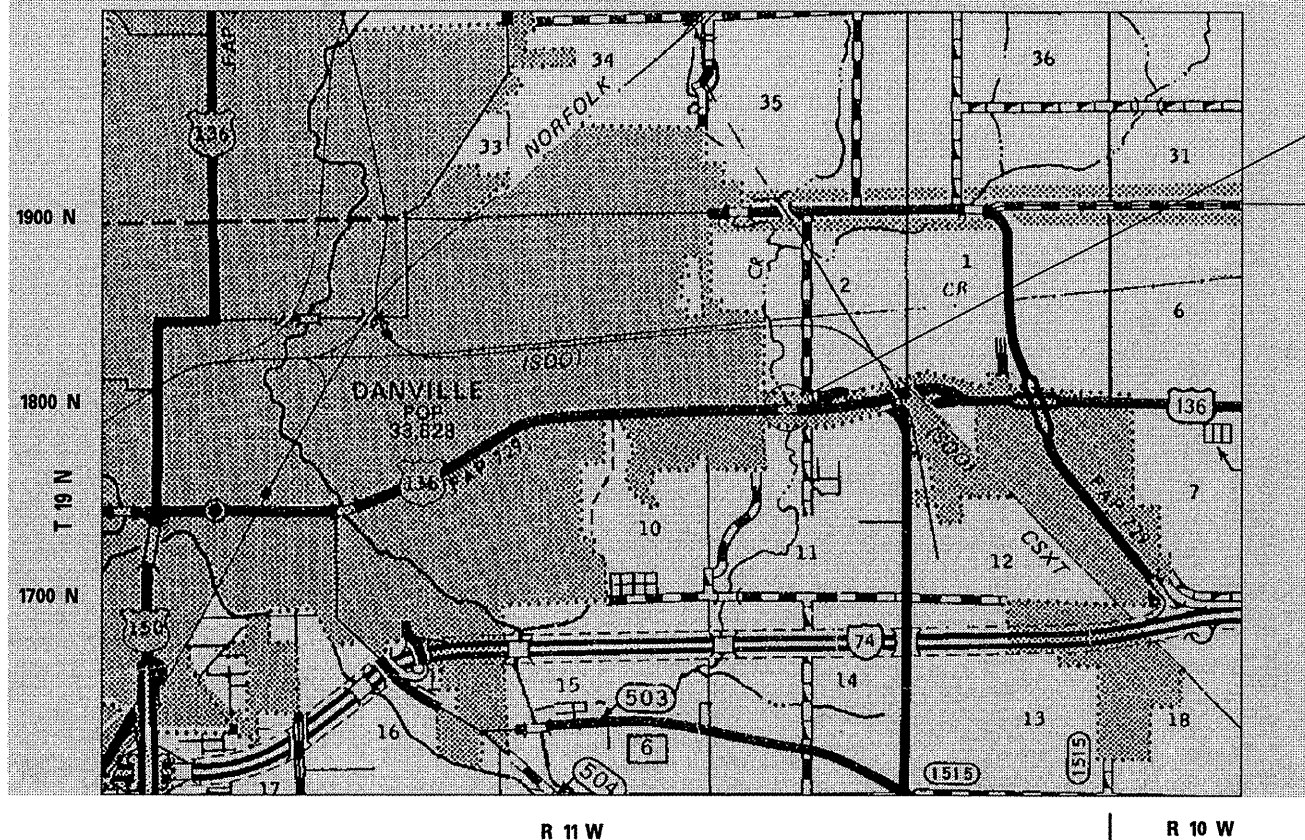

SECTION: D5 SCOUR MITIGATION  
LOCATION #4

S.N. 092-0144  
STATION 8+97.50



- D5 SCOUR MITIGATION 2009-3
- CHAMPAIGN & VERMILION

FILE NAME =	USER NAME = s1smgm	DESIGNED - BJH	REVISED -
c:\pwwork\pwwork\DOT\SIMSOM\0120266\d570	78-plan.dgn	DRAWN - GMS	REVISED -
	PLOT SCALE = 40,0000' / IN.	CHECKED -	REVISED -
	PLOT DATE = 3/18/2009	DATE -	REVISED -

STATE OF ILLINOIS  
DEPARTMENT OF TRANSPORTATION

LOCATION MAP  
(LOCATIONS 3 & 4)

SCALE: SHEET NO. OF SHEETS STA. TO STA.

F.A. RTE.	SECTION	COUNTY	TOTAL SHEETS	SHEET NO.
VAR.	*	**	22	3
CONTRACT NO. 70770			ILLINOIS FED. AID PROJECT	