

STATE OF ILLINOIS
DEPARTMENT OF TRANSPORTATION
DIVISION OF HIGHWAYS

**PROPOSED
HIGHWAY PLANS**

F.A.I.-74/F.A.P.-332/F.A.P.-729 ROUTES I-74/IL-1/U.S.-136
SECTION: D5 SCOUR MITIGATION 2009-3
CHAMPAIGN & VERMILION COUNTIES

C-95-028-09

VARIOUS DISTRICT WIDE SCOUR MITIGATION

S.N. 092-0001 & S.N. 092-0002

F.A.I. 74 (I-74) OVER STONY CREEK
LOCATION #1

S.N. 010-0029 & 010-0030

F.A.I. 74 (I-74) OVER SALT FORK
LOCATION #2

S.N. 092-0033

F.A.P. 332 OVER THE NORTH FORK OF THE VERMILION RIVER
LOCATION #3

S.N. 092-0144

F.A.P. 729 (US-136) OVER LICK CREEK
LOCATION #4

TOTAL LENGTH OF SECTION & PROJECT = N.A.
NET LENGTH OF SECTION & PROJECT = N.A.

F.A. RTE.	SECTION	COUNTY	TOTAL SHEETS	SHEET NO.
VAR.		**	22	1

FEB. ROAD DIST. NO. ILLINOIS CONTRACT NO. 70770

D5 SCOUR MITIGATION 2009-3
CHAMPAIGN & VERMILION
D-95-028-09

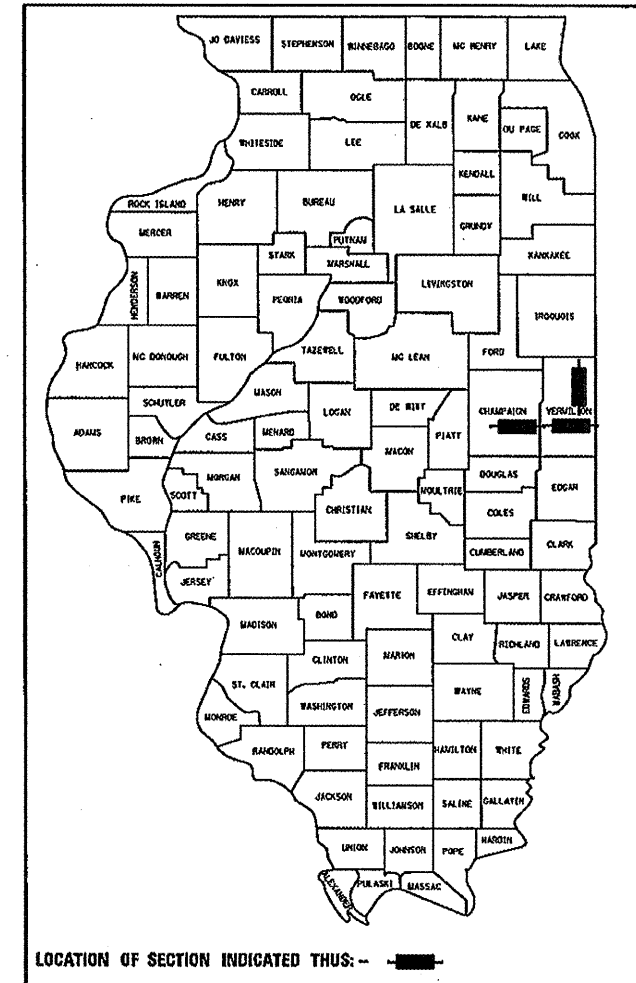

FOR LOCATION MAPS SEE SHEET NO. 2 AND 3
FOR INDEX OF SHEETS, SEE SHEET NO. 4
FOR SUMMARY OF QUANTITIES, SEE SHEET NO. 5

CURRENT ADT / DESIGN ADT

CURRENT ADT: 23,300 (2007)
- LOCATION #1

CURRENT ADT: 30,500 (2007)
- LOCATION #2

CURRENT ADT: 4,600 (2007)
- LOCATION #3

CURRENT ADT: 7,500 (2007)
- LOCATION #4

DESIGN DESIGNATION

N.A.

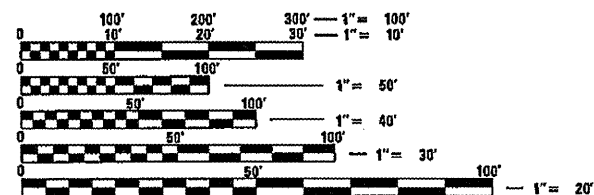

FULL SIZE PLANS HAVE BEEN PREPARED USING STANDARD ENGINEERING SCALES. REDUCED SIZED PLANS WILL NOT CONFORM TO STANDARD SCALES. IN MAKING MEASUREMENTS ON REDUCED PLANS, THE ABOVE SCALES MAY BE USED.

J.U.L.I.E.
JOINT UTILITY LOCATION INFORMATION FOR EXCAVATION
1-800-892-0123
OR 811

PROJECT ENGINEER: TIM BRANDENBURG
SQUAD LEADER: EURNIE D. GARVER
DESIGNER: BRIAN J. HOGAN
CONTRACT NO. 70770

STATE OF ILLINOIS
DEPARTMENT OF TRANSPORTATION
DIVISION OF HIGHWAYS

SUBMITTED MARCH 23, 2009

[Signature]
DEPUTY DIRECTOR OF HIGHWAYS, REGION 3 ENGINEER

May 8, 2009
Charles J. Graessle
ENGINEER OF DESIGN AND ENVIRONMENT

May 8, 2009
Christine M. Reed
DIRECTOR OF HIGHWAYS, CHIEF ENGINEER

PRINTED BY THE AUTHORITY
OF THE STATE OF ILLINOIS

VERMILION COUNTY

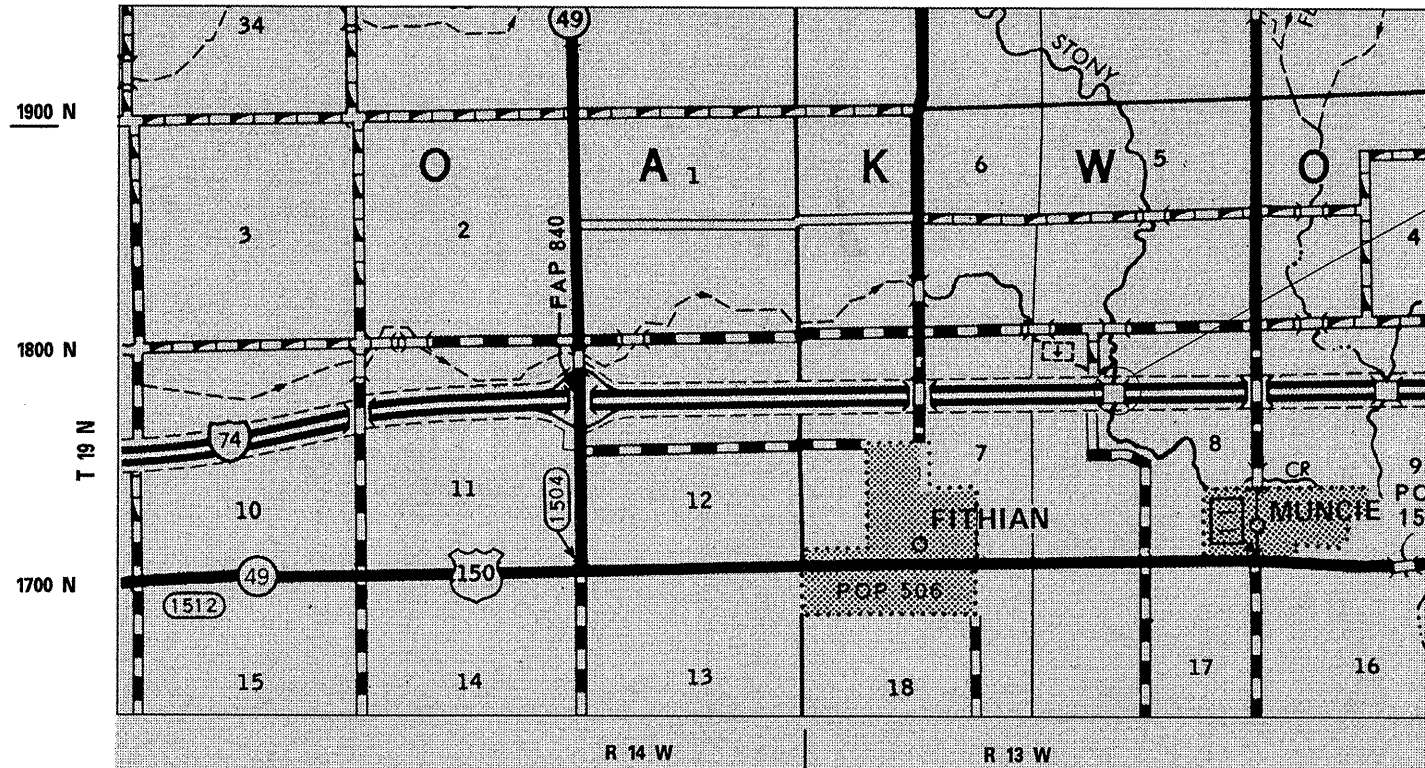

SECTION: D5 SCOUR MITIGATION
LOCATION #1

S.N. 092-0001 (EB) &
S.N. 092-0002 (WB)
STATION 1286+17.00

CHAMPAIGN COUNTY

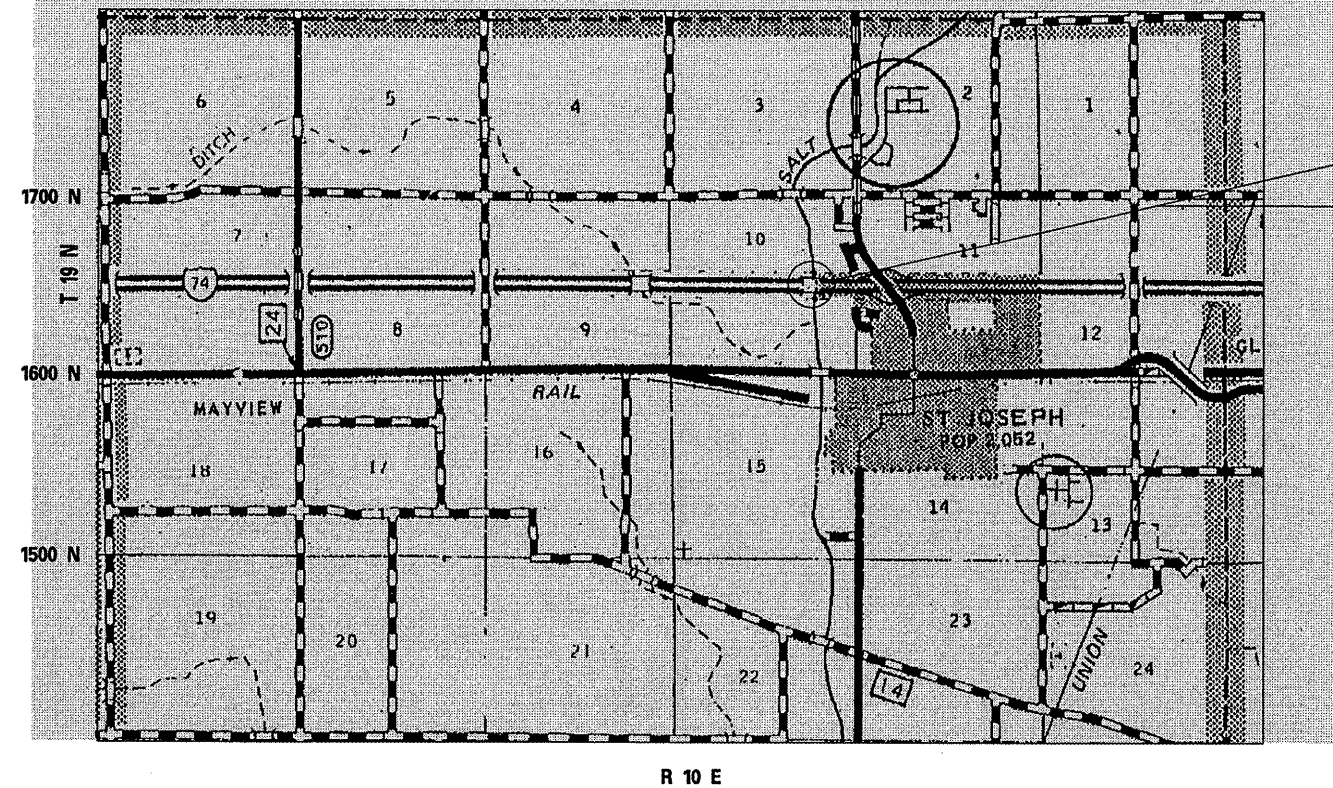

SECTION: D5 SCOUR MITIGATION
LOCATION #2

S.N. 010-0029 (EB) &
S.N. 010-0030 (WB)
STATION 739+22.00



- D5 SCOUR MITIGATION 2009-3
- ** CHAMPAIGN & VERMILION

FILE NAME = c:\pwwork\FWIDOT\SMISGH\d0120266\d570	USER NAME = smisgm 70-plan.dgn	DESIGNED - BJH DRAWN - GMS	REVISED - REVISED - REVISED - REVISED -
PLOT SCALE = 40,0000' / IN.	CHECKED -	DATE -	REVISED -
PLOT DATE = 3/18/2009			

STATE OF ILLINOIS
DEPARTMENT OF TRANSPORTATION

LOCATION MAPS
(LOCATIONS 1 & 2)

SCALE: SHEET NO. OF SHEETS STA. TO STA.

F.A. RTE.	SECTION	COUNTY	TOTAL SHEETS	SHEET NO.
VAR.	*	**	22	2
CONTRACT NO. 70770				
ILLINOIS FED. AID PROJECT				

VERMILION COUNTY

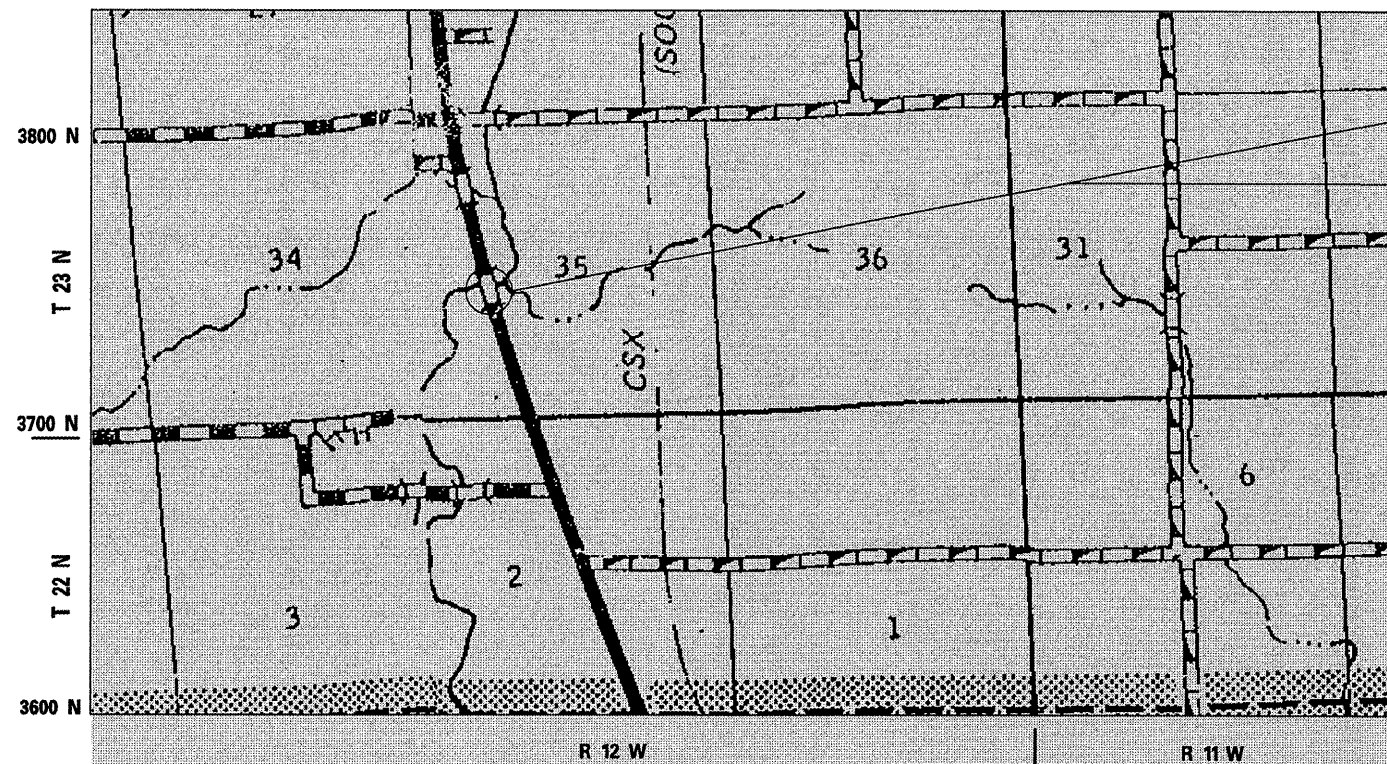

SECTION: D5 SCOUR MITIGATION
LOCATION #3

S.N. 092-0033
STATION 909+81.00

VERMILION COUNTY

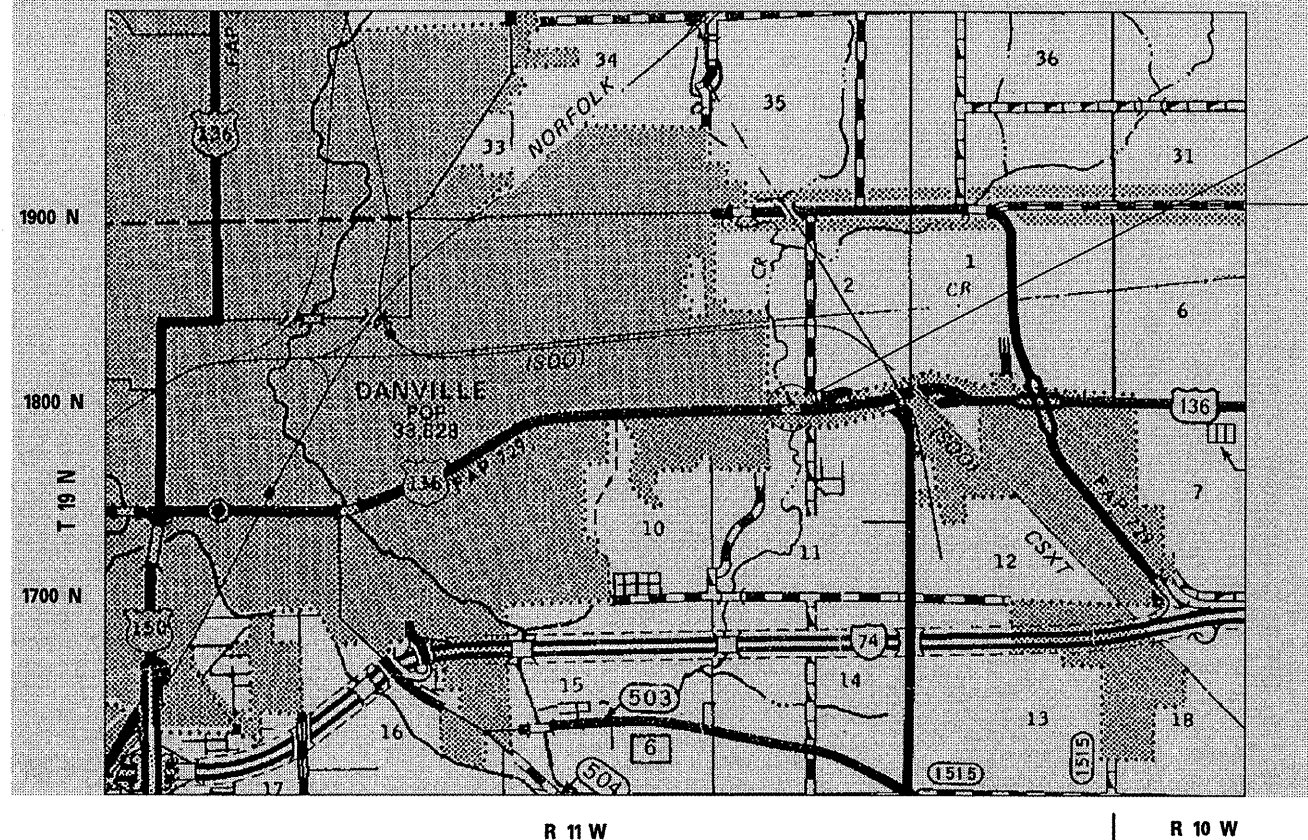

SECTION: D5 SCOUR MITIGATION
LOCATION #4

S.N. 092-0144
STATION 8+97.50



- D5 SCOUR MITIGATION 2009-3
- CHAMPAIGN & VERMILION

FILE NAME =	USER NAME = s1msgm	DESIGNED - BJH	REVISED -
c:\pwwork\pwwid\T\SMSGM\d0120266\d570	78-plan.dgn	DRAWN - GMS	REVISED -
	PLOT SCALE = 40,0000' / IN.	CHECKED -	REVISED -
	PLOT DATE = 3/18/2009	DATE -	REVISED -

STATE OF ILLINOIS
DEPARTMENT OF TRANSPORTATION

LOCATION MAP
(LOCATIONS 3 & 4)

SCALE: SHEET NO. OF SHEETS STA. TO STA.

F.A. RTE.	SECTION	COUNTY	TOTAL SHEETS	SHEET NO.
VAR.	•	••	22	3
CONTRACT NO. 70770			ILLINOIS FED. AID PROJECT	

INDEX OF SHEETS

SHEET NO.	DESCRIPTION
1	COVER SHEET
2	LOCATION MAPS (LOCATIONS 1 & 2)
3	LOCATION MAPS (LOCATIONS 3 & 4)
4	INDEX OF SHEETS
4	LIST OF STANDARDS
4	GENERAL NOTES
5	SUMMARY OF QUANTITIES
6	PLAN SHEET S.N. 092-0001 & S.N. 092-0002
7	PROFILE SHEET S.N. 092-0001 & S.N. 092-0002
8	PLAN SHEET S.N. 010-0029 & S.N. 010-0030
9	PROFILE SHEET S.N. 010-0029 & S.N. 010-0030
10	PLAN SHEET S.N. 092-0033
11	PROFILE SHEET S.N. 092-0033 AT UPSTREAM FACE
12	PROFILE SHEET S.N. 092-0033 UNDER CENTER OF BRIDGE
13	PROFILE SHEET S.N. 092-0033 AT DOWNSTREAM FACE
14	PLAN SHEET S.N. 092-0144
15	PLAN & PROFILE OF STREAM S.N. 092-0144
16	UPSTREAM CROSS SECTIONS S.N. 092-0144
17	CROSS SECTION UPSTREAM BRIDGE OPENING S.N. 092-0144
18	CROSS SECTION DOWNSTREAM BRIDGE OPENING S.N. 092-0144
19	DOWNSTREAM CROSS SECTIONS S.N. 092-0144
20	DETAIL FOR RIPRAP TOE ALONG FL S.N. 010-0029 & 010-0030, 092-0001 & 092-0002
20	DETAIL FOR RIPRAP TOE ALONG FL S.N. 092-0033
21	DETAIL FOR UPSTREAM EDGE OF RIPRAP S.N. 092-0033 & S.N. 092-0144
21	DETAIL FOR UPSTREAM EDGE OF RIPRAP S.N. 010-0029 & 0030, 092-0001 & 0002
22	PROPOSED STONE RIPRAP, CLASS A5 DITCH CROSS SECTION
22	EXISTING PAVED DITCH CROSS SECTION

LIST OF HIGHWAY STANDARDS

STANDARD NO.	DESCRIPTION
000001-05	STANDARD SYMBOLS, ABBREVIATIONS AND PATTERNS
001006	DECIMAL OF AN INCH AND OF A FOOT
665001-02	WOVEN WIRE FENCE
701001-02	OFF-ROAD OPERATIONS, 2L, 2W, MORE THAN 4.5 m (15') AWAY
701006-03	OFF-ROAD OPERATIONS, 2L, 2W, 4.5 m (15') TO 600 mm (24") FROM PAVEMENT EDGE
701201-03	LANE CLOSURE, 2L, 2W, DAY ONLY, FOR SPEEDS GREATER THAN OR EQUAL TO 45 MPH
701101-02	OFF-ROAD OPERATIONS, MULTILANE, 4.5 m (15') TO 600 mm (24") FROM PAVEMENT EDGE
701106-02	OFF-ROAD OPERATIONS, MULTILANE, MORE THAN 4.5 m (15') AWAY
701400-03	APPROACH TO LANE CLOSURE, FREEWAY/EXPRESSWAY
701406-05	LANE CLOSURE, FREEWAY/EXPRESSWAY, DAY OPERATIONS ONLY
701901-01	TRAFFIC CONTROL DEVICES

GENERAL NOTES

GENERAL NOTES

G.N.-100
ENGLISH UNITS OF MEASUREMENT SHALL GOVERN OVER AND SUPERSEDE ANY METRIC UNITS SHOWN IN THIS CONTRACT. WHERE INCLUDED, METRIC UNITS ARE FOR INFORMATION ONLY.

G.N.-105.09A
ALL ELEVATIONS SHOWN IN THE PLANS ARE BASED ON NORTH AMERICAN VERTICAL DATUM OF 1988. (NAVD 88)

G.N.-107.31
UTILITY LINES WERE PLOTTED FROM INFORMATION FURNISHED BY THE VARIOUS UTILITY COMPANIES INVOLVED (QUALITY LEVEL C & OR QUALITY LEVEL D) AND THE ACCURACY SHOULD BE CONSIDERED APPROXIMATE ONLY.

UTILITY COMPANIES MAY BE ADJUSTING THEIR FACILITIES DURING CONSTRUCTION. THE CONTRACTOR SHALL COOPERATE WITH THESE ORGANIZATIONS WHILE THESE ADJUSTMENTS ARE BEING PERFORMED. J.U.L.I.E. - JOINT UTILITY LOCATION INFORMATION FOR EXCAVATORS SYSTEM (800)892-0123 OR 811.

G.N.-201
TREES THAT INTERFERE WITH THE CONSTRUCTION OPERATIONS SHALL BE REMOVED AS DIRECTED BY THE ENGINEER. ANY TREE DUE TO ITS LOCATION AND DEEMED SUITABLE FOR SAVING BY THE ENGINEER SHALL BE PROTECTED DURING CLEARING AND SUBSEQUENT CONSTRUCTION OPERATIONS.

G.N.-281
THE RIPRAP GRADATION SHALL BE IN ACCORDANCE WITH THE GRADATION SPECIFIED IN THE PLANS OR, WITH APPROVAL OF THE ENGINEER, A RIPRAP GRADATION MEETING A D50 GREATER THAN OR EQUAL TO 1.1 FEET FOR A5 RIPRAP AND A RIPRAP GRADATION MEETING A D50 GREATER THAN OR EQUAL TO 0.8 FEET FOR A4 RIPRAP. D50 IS DEFINED AS THE MEAN ROCK SIZE AS DESCRIBED IN THE FHWA HYDRAULIC ENGINEERING CIRCULARS (HEC 11, HEC 14 AND HEC 15).

IF GRAVEL IS USED FOR THE BEDDING MATERIAL UNDER RIPRAP, THE GRAVEL SHALL BE CRUSHED AS ALLOWED UNDER ARTICLE 1005.01.

G.N.-281 (SPECIAL)
RIPRAP TONAGE WAS ESTIMATED USING THE FOLLOWING FORMULA
CU. YD. RIPRAP X 1.5 TON/CY = ESTIMATED TONS
BEDDING TONAGE WAS ESTIMATED USING THE FOLLOWING FORMULA
CU. YD. BEDDING X 1.8 TON/CY = ESTIMATED TONS

* D5 SCOUR MITIGATION 2009-3
** CHAMPAIGN & VERMILION

FILE NAME *	USER NAME * ssmgm	DESIGNED - BJH	REVISED -	STATE OF ILLINOIS DEPARTMENT OF TRANSPORTATION	INDEX OF SHEETS, LIST OF HIGHWAY STANDARDS & GENERAL NOTES				F.A. RTE.	SECTION	COUNTY	TOTAL SHEETS	SHEET NO.
78-plan.dgn	DRAWN - GMS	REVISED -	VAR.				**	22	4				
PLOT SCALE = 40.0000 ' / IN.	CHECKED -	REVISED -	SCALE:		SHEET NO.	OF	SHEETS	STA.	TO	STA.	CONTRACT NO. 70770		
PLOT DATE = 3/18/2009	DATE -	REVISED -											

SUMMARY OF QUANTITIES

I-74 VERMILION CO. RURAL MULTILANE 100% STATE MINOR STRUCTURE REPAIR SFTY-2A S.N. 092-0001 S.N. 092-0002	I-74 CHAMPAIGN CO. RURAL MULTILANE 100% STATE MINOR STRUCTURE REPAIR SFTY-2A S.N. 010-0029 S.N. 010-0030	IL-1 VERMILION CO. RURAL TWO LANE 100% STATE MINOR STRUCTURE REPAIR SFTY-2A S.N. 092-0033	US-136 VERMILION CO. RURAL TWO LANE 100% STATE MINOR STRUCTURE REPAIR SFTY-2A S.N. 092-0144
---------------------------------------------------------------------------------------------------------------------------------------------------	---------------------------------------------------------------------------------------------------------------------------------------------------	---------------------------------------------------------------------------------------------------------------------------------	-----------------------------------------------------------------------------------------------------------------------------------

CODE NO	ITEM	UNIT	TOTAL QUANTITY	LOCATION #1	LOCATION #2	LOCATION #3	LOCATION #4
20100500	TREE REMOVAL, ACRES	ACRE	0.5	0.25	0.25	0.0	0.0
28100107	STONE RIPRAP, CLASS A4	SQ YD	2095.0	0.0	0.0	970.0	1125.0
28100109	STONE RIPRAP, CLASS A5	SQ YD	250.0	100.0	150.0	0.0	0.0
28100709	STONE DUMPED RIPRAP, CLASS A5	SQ YD	1,180.0	790.0	390.0	0.0	0.0
28200200	FILTER FABRIC	SQ YD	2345.0	100.0	150.0	970.0	1125.0
44004000	PAVED DITCH REMOVAL	FOOT	230.0	100.0	130.0	0.0	0.0
66500105	WOVEN WIRE FENCE, 4'	FOOT	690.0	0.0	0.0	690.0	0.0
66501600	WOVEN WIRE GATES, 4'X16' DOUBLE	EACH	2.0	0.0	0.0	2.0	0.0
66503200	BARBED WIRE FENCE, FIVE STRAND	FOOT	210.0	0.0	0.0	210.0	0.0
66503400	BARBED WIRE FENCE REMOVAL	FOOT	610.0	0.0	0.0	610.0	0.0
67100100	MOBILIZATION	L SUM	1.0	0.3	0.3	0.2	0.2
70100450	TRAFFIC CONTROL AND PROTECTION, STANDARD 701201	L SUM	1.0	0.0	0.0	0.5	0.5
70100700	TRAFFIC CONTROL AND PROTECTION, STANDARD 701406	L SUM	1.0	0.5	0.5	0.0	0.0
X7015005	CHANGEABLE MESSAGE SIGN	CAL DA	28.0	14.0	14.0	0.0	0.0

• D5 SCOUR MITIGATION 2009-3
 ** CHAMPAIGN & VERMILION

FILE NAME =	USER NAME = s1msgm	DESIGNED - BJH	REVISED -	STATE OF ILLINOIS DEPARTMENT OF TRANSPORTATION	SUMMARY OF QUANTITIES	F.A. RTE.	SECTION	COUNTY	TOTAL SHEETS	SHEET NO.
c:\pwork\VPWIDOT\S1MSGM\d0120266\d570	70-plen.dgn	DRAWN - GMS	REVISED -			VAR.	*	**	22	5
	PLOT SCALE = 40.0000' / IN.	CHECKED -	REVISED -		SCALE:	SHEET NO. OF SHEETS STA.		TO STA.		
	PLOT DATE = 3/18/2009	DATE -	REVISED -		FED. ROAD DIST. NO.		ILLINOIS FED. AID PROJECT			
						CONTRACT NO. 70770				

S.N. 092-0001 (EASTBOUND LANES) S.N. 092-0002 (WESTBOUND LANES) LOCATION #1

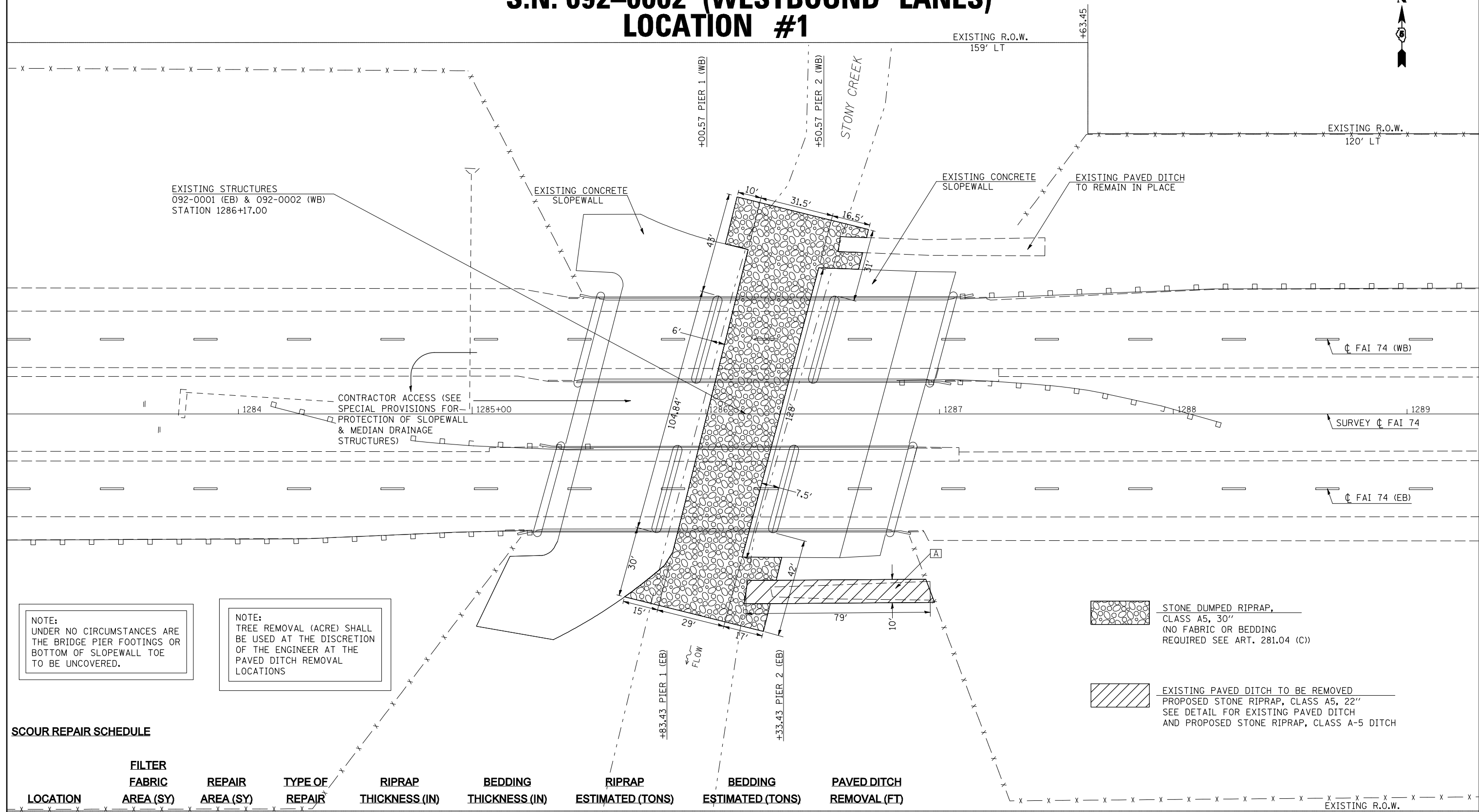

EXISTING STRUCTURES
092-0001 (EB) & 092-0002 (WB)
STATION 1286+17.00

CONTRACTOR ACCESS (SEE
SPECIAL PROVISIONS FOR
PROTECTION OF SLOPEWALL
& MEDIAN DRAINAGE
STRUCTURES)

NOTE:
UNDER NO CIRCUMSTANCES ARE
THE BRIDGE PIER FOOTINGS OR
BOTTOM OF SLOPEWALL TOE
TO BE UNCOVERED.

NOTE:
TREE REMOVAL (ACRE) SHALL
BE USED AT THE DISCRETION
OF THE ENGINEER AT THE
PAVED DITCH REMOVAL
LOCATIONS

- STONE DUMPED RIPRAP,
CLASS A5, 30"
(NO FABRIC OR BEDDING
REQUIRED SEE ART. 281.04 (C))
- EXISTING PAVED DITCH TO BE REMOVED
PROPOSED STONE RIPRAP, CLASS A5, 22"
SEE DETAIL FOR EXISTING PAVED DITCH
AND PROPOSED STONE RIPRAP, CLASS A-5 DITCH

SCOUR REPAIR SCHEDULE

LOCATION	FILTER FABRIC AREA (SY)	REPAIR AREA (SY)	TYPE OF REPAIR	RIPRAP THICKNESS (IN)	BEDDING THICKNESS (IN)	RIPRAP ESTIMATED (TONS)	BEDDING ESTIMATED (TONS)	PAVED DITCH REMOVAL (FT)
MAIN CHANNEL	0.0	790.0	A5	30.0	0.0	1240.0	0.0	0.0
A	100.0	100.0	A5	22.0	8.0	95.0	40.0	100.0



* D5 SCOUR MITIGATION 2009-3
** CHAMPAIGN & VERMILION

FILE NAME =	USER NAME = s1msgm	DESIGNED - BJH	REVISED -
et\pwork\PWID01\S1MSGM\d0120266\d570770-plen.dgn		DRAWN - GMS	REVISED -
PLOT SCALE = 40.0000' / IN.		CHECKED -	REVISED -
PLOT DATE = 6/26/2009		DATE -	REVISED -

**STATE OF ILLINOIS
DEPARTMENT OF TRANSPORTATION**

PLAN SHEET			
S.N. 092-0001 & S.N. 092-0002			
SCALE:	SHEET NO.	OF SHEETS	STA. TO STA.

F.A. RTE.	SECTION	COUNTY	TOTAL SHEETS	SHEET NO.
VAR.	*	**	22	6
CONTRACT NO. 70770				
ILLINOIS FED. AID PROJECT				

PLAN	SURVEYED	DATE
	PLOTTED	BY
	NOTED	
	CHECKED	
	FILE NAME	

PROFILE	SURVEYED	DATE
	PLOTTED	BY
	NOTED	
	CHECKED	
	FILE NAME	

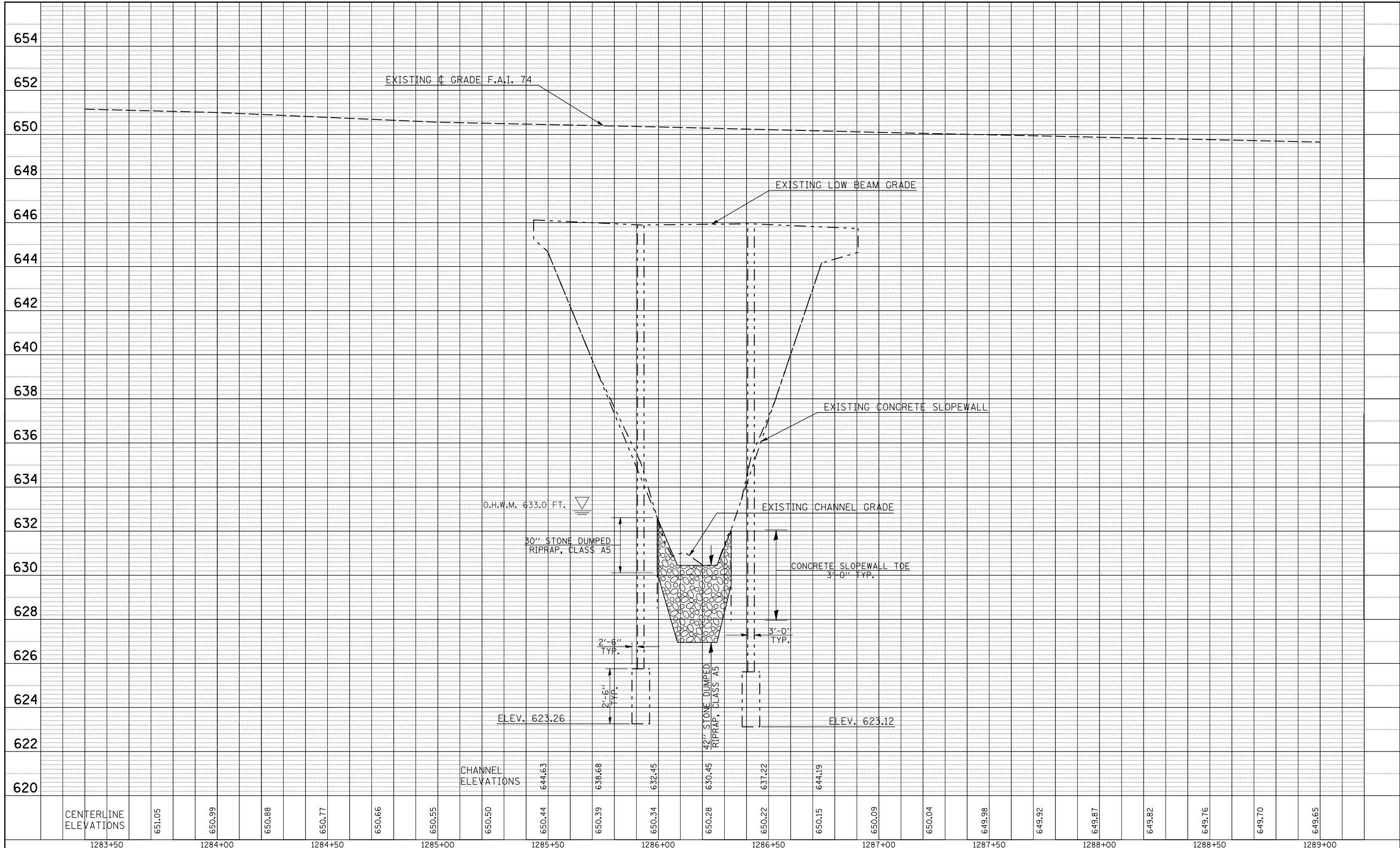

CENTERLINE ELEVATIONS	651.05	650.99	650.88	650.77	650.66	650.55	650.50	650.44	650.39	650.34	650.28	650.22	650.15	650.09	650.04	649.98	649.92	649.87	649.82	649.76	649.70	649.65
	1283+50	1284+00	1284+50	1285+00	1285+50	1286+00	1286+50	1287+00	1287+50	1288+00	1288+50	1289+00										

FILE NAME =	USER NAME = smsgm	DESIGNED - BJH	REVISED -
ct:\pwork\PWIDOT\SIMSGMI\0120266\d570770-plan.dgn		DRAWN - GMS	REVISED -
PLOT SCALE = 40.0000' / IN.		CHECKED -	REVISED -
PLOT DATE = 6/26/2009		DATE -	REVISED -

**STATE OF ILLINOIS
DEPARTMENT OF TRANSPORTATION**

**PROFILE SHEET
S.N. 092-0001 & S.N. 092-0002**

SCALE: SHEET NO. OF SHEETS STA. TO STA.

F.A. RTE.	SECTION	COUNTY	TOTAL SHEETS	SHEET NO.
VAR.	*	**	22	7
CONTRACT NO. 70770				
ILLINOIS FED. AID PROJECT				

- D5 SCOUR MITIGATION 2009-3
- ** CHAMPAIGN & VERMILION

S.N. 010-0029 (EASTBOUND LANES) S.N. 010-0030 (WESTBOUND LANES) LOCATION #2

EXISTING R.O.W.
160' LT

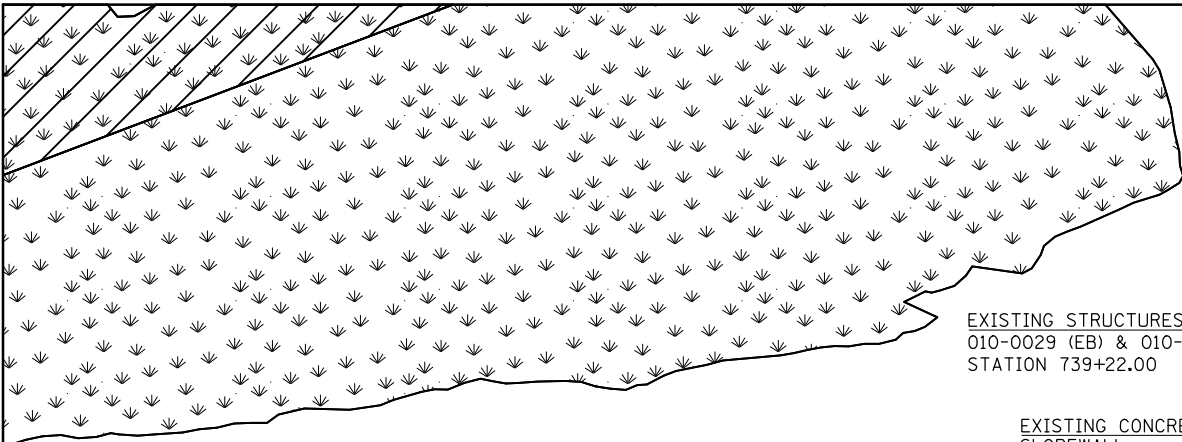

EXISTING STRUCTURES
010-0029 (EB) & 010-0030 (WB)
STATION 739+22.00

EXISTING CONCRETE
SLOPEWALL

EXISTING CONCRETE
SLOPEWALL

NOTE:
WETLAND LOCATIONS HAVE BEEN PLACED ACCORDING TO THE WETLAND DELINEATION REPORT RECEIVED ON MAY 29, 2009 FROM THE ILLINOIS NATURAL HISTORY SURVEY. CONTRACTOR ACCESS IS RESTRICTED TO NON-WETLAND AREAS ONLY AT THIS SITE.

WETLAND LEGEND

- WET MEADOW (PER ILLINOIS NATURAL HISTORY SURVEY)
- PALUSTRINE, FORESTED, DECIDUOUS, TEMPORARILY FLOODED WETLAND (PER NATIONAL WETLANDS INVENTORY)

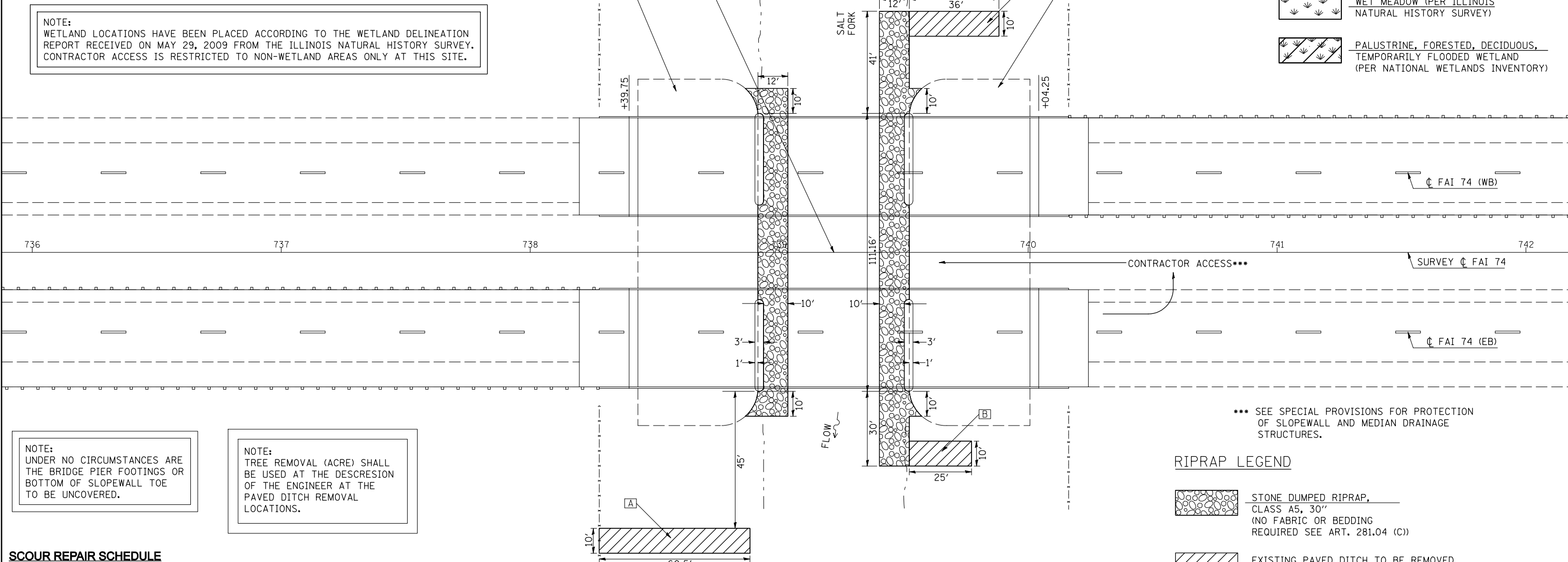

*** SEE SPECIAL PROVISIONS FOR PROTECTION OF SLOPEWALL AND MEDIAN DRAINAGE STRUCTURES.

RIPRAP LEGEND

- STONE DUMPED RIPRAP, CLASS A5, 30" (NO FABRIC OR BEDDING REQUIRED SEE ART. 281.04 (C))
- EXISTING PAVED DITCH TO BE REMOVED PROPOSED STONE RIPRAP, CLASS A5, 22" SEE DETAIL FOR EXISTING PAVED DITCH AND PROPOSED STONE RIPRAP, CLASS A-5 DITCH

NOTE:
UNDER NO CIRCUMSTANCES ARE THE BRIDGE PIER FOOTINGS OR BOTTOM OF SLOPEWALL TOE TO BE UNCOVERED.

NOTE:
TREE REMOVAL (ACRE) SHALL BE USED AT THE DISCRETION OF THE ENGINEER AT THE PAVED DITCH REMOVAL LOCATIONS.

SCOUR REPAIR SCHEDULE

LOCATION	FILTER FABRIC AREA (SY)	REPAIR AREA (SY)	TYPE OF REPAIR	RIPRAP THICKNESS (IN)	BEDDING THICKNESS (IN)	RIPRAP ESTIMATED (TONS)	BEDDING ESTIMATED (TONS)	PAVED DITCH REMOVAL (FT)
PIER #1 (N & S)	0.0	161.0	A5	30.0	0.0	210.0	0.0	0.0
PIER #2 (N & S)	0.0	229.0	A5	30.0	0.0	300.0	0.0	0.0
A	74.0	74.0	A5	22.0	8.0	68.0	31.0	63.0
B	32.0	32.0	A5	22.0	8.0	30.0	15.0	27.0
C	44.0	44.0	A5	22.0	8.0	42.0	19.0	40.0

EXISTING R.O.W.
175' RT

EXISTING R.O.W.
150' RT



* D5 SCOUR MITIGATION 2009-3
** CHAMPAIGN & VERMILION

FILE NAME =	USER NAME = s1msgm	DESIGNED - BJH	REVISED -
et\pwork\p\WID01\S1MSGM\d0120266\d570770-plan.dgn		DRAWN - GMS	REVISED -
	PLOT SCALE = 40.0000' / IN.	CHECKED -	REVISED -
	PLOT DATE = 6/26/2009	DATE -	REVISED -

STATE OF ILLINOIS
DEPARTMENT OF TRANSPORTATION

PLAN SHEET
S.N. 010-0029 & S.N. 010-0030

SCALE: SHEET NO. OF SHEETS STA. TO STA.

F.A. RTE.	SECTION	COUNTY	TOTAL SHEETS	SHEET NO.
VAR.	*	**	22	8
CONTRACT NO. 70770			FED. ROAD DIST. NO. ILLINOIS FED. AID PROJECT	

PLAN	SURVEYED	DATE
	PLOTTED	BY
	GRADES CHECKED	
	STRUCTURE NOTATION CHECKED	
	NOTE BOOK NO.	
	CADD FILE NAME	

PROFILE	SURVEYED	DATE
	PLOTTED	BY
	GRADES CHECKED	
	STRUCTURE NOTATION CHECKED	
	NOTE BOOK NO.	
	CADD FILE NAME	

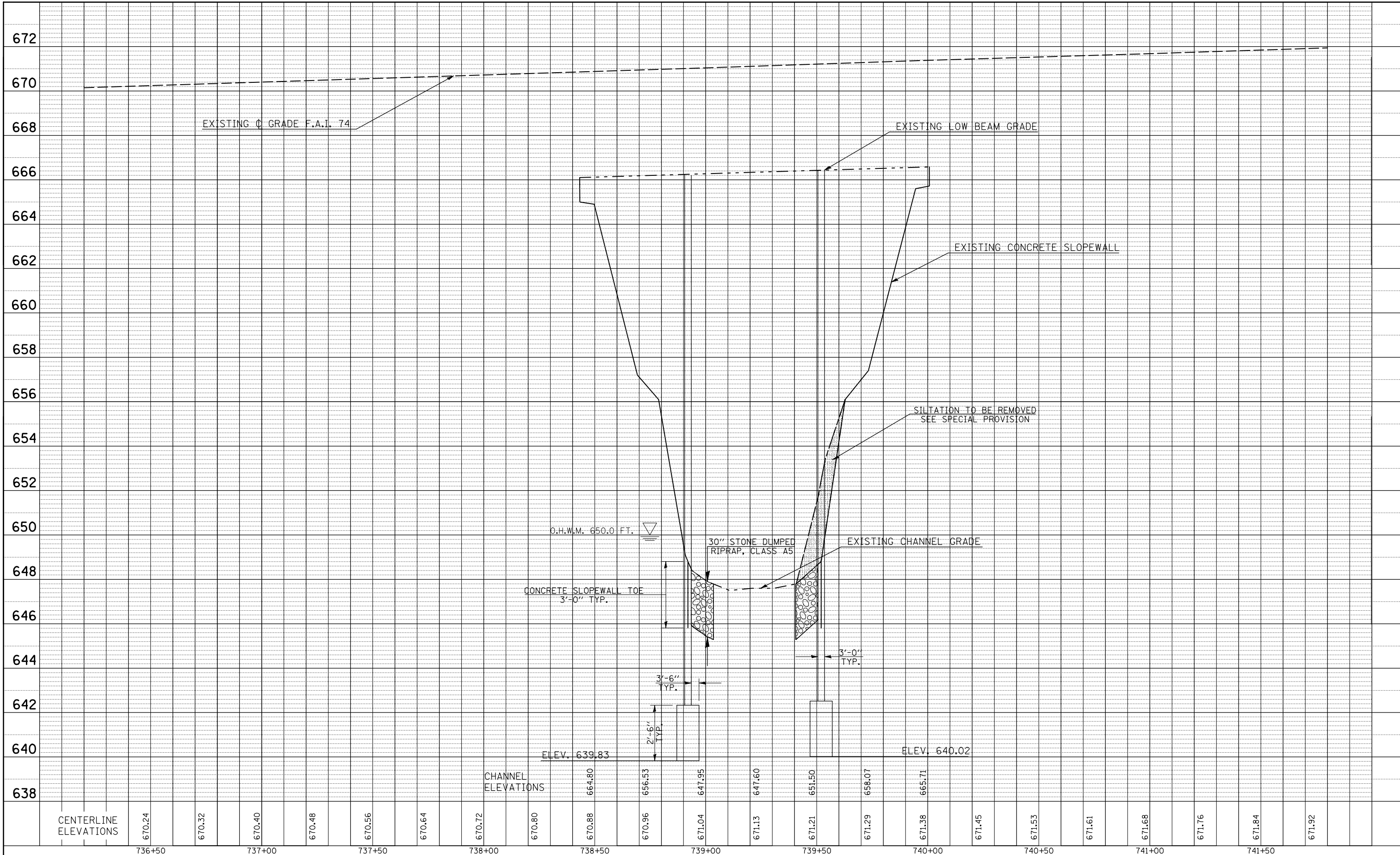

• D5 SCOUR MITIGATION 2009-3
 •• CHAMPAIGN & VERMILION

FILE NAME =	USER NAME = s1msgm	DESIGNED - BJH	REVISED -
ct\pwwork\PWIDOT\SIMSGMI\d0120266\d570770-plan.dgn		DRAWN - GMS	REVISED -
	PLOT SCALE = 40.0000' / IN.	CHECKED -	REVISED -
	PLOT DATE = 6/26/2009	DATE -	REVISED -

**STATE OF ILLINOIS
 DEPARTMENT OF TRANSPORTATION**

**PROFILE SHEET
 S.N. 010-0029 & S.N. 010-0030**

SCALE: SHEET NO. OF SHEETS STA. TO STA.

F.A. RTE.	SECTION	COUNTY	TOTAL SHEETS	SHEET NO.
VAR.	*	**	22	9
CONTRACT NO. 70770				
FED. ROAD DIST. NO. ILLINOIS FED. AID PROJECT				

S.N. 092-0033 LOCATION #3



NOTE:
UNDER NO CIRCUMSTANCES ARE
THE BRIDGE PIER FOOTINGS OR
BOTTOM OF SLOPEWALL TOE
TO BE UNCOVERED.

NOTE:
SEE SPECIAL PROVISIONS FOR
CONTRACTOR ACCESS INFORMATION

NOTE:
BEFORE STARTING ANY FENCE WORK,
CONTACT PROPERTY OWNER:
JOHN HATHAWAY
WHITE WHEEL CORP.
HOME 217-748-6319
CELL 217-799-0258

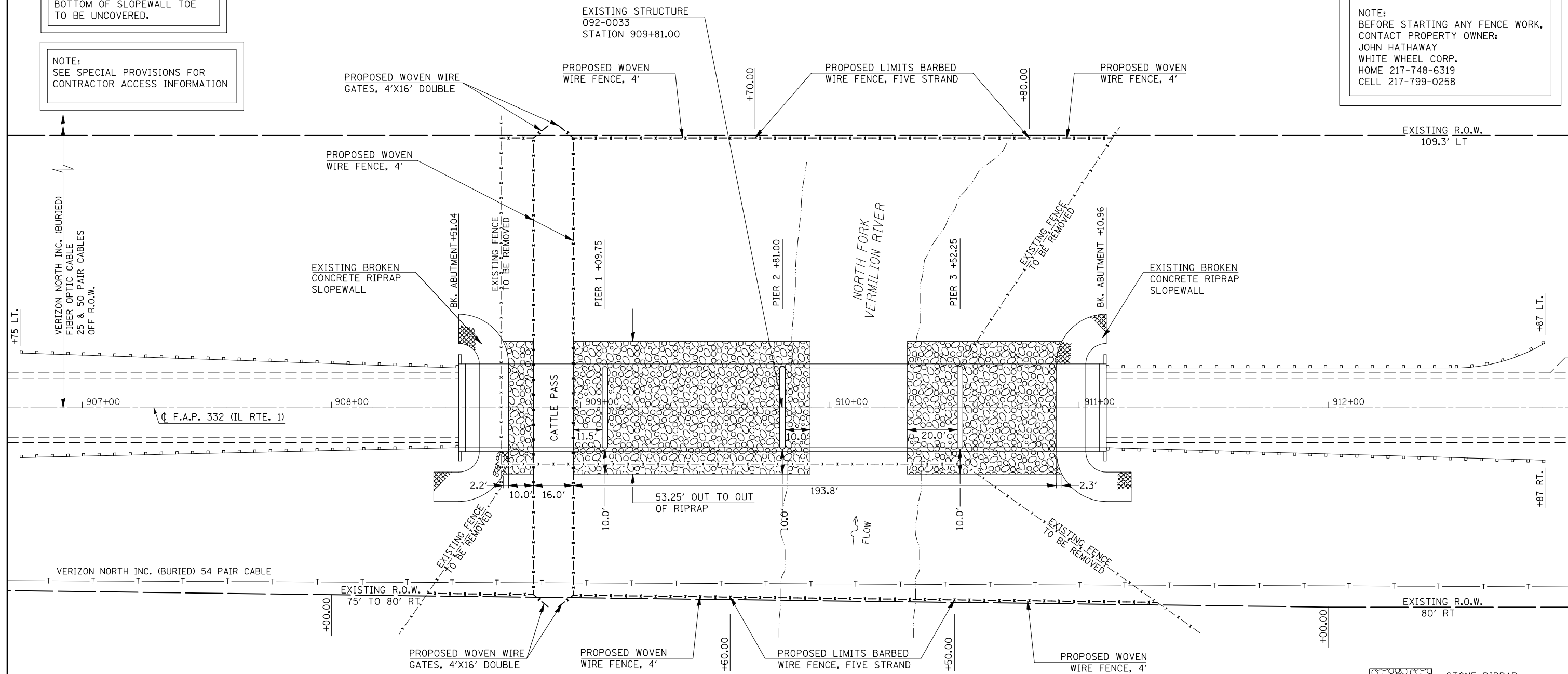

SCOUR REPAIR SCHEDULE

LOCATION	FILTER FABRIC AREA (SY)	REPAIR AREA (SY)	TYPE OF REPAIR	RIPRAP THICKNESS (IN)	BEDDING THICKNESS (IN)	RIPRAP ESTIMATED (TONS)	BEDDING ESTIMATED (TONS)	WOVEN WIRE FENCE, 4' (FOOT)	WOVEN WIRE GATES, 4'X16' DOUBLE (EACH)	BARBED WIRE FENCE, FIVE STRAND (FOOT)	BARBED WIRE FENCE REM (FOOT)
SOUTH END	65.0	65.0	A4	20.0	6.0	60.0	20.0	245.0	0.0	0.0	195.0
SOUTH MID	555.0	555.0	A4	20.0	6.0	510.0	167.0	325.0	2.0	210.0	200.0
NORTH END	350.0	350.0	A4	20.0	6.0	325.0	105.0	120.0	0.0	0.0	215.0

STONE RIPRAP,
CLASS A4, 20"
(WITH 6" BEDDING
STONE AND FILTER
FABRIC)



* D5 SCOUR MITIGATION 2009-3
** CHAMPAIGN & VERMILION

FILE NAME =	USER NAME = s1msgm	DESIGNED - BJH	REVISED -
ct:\pw\work\PWID01\S1MSGM\d0120266\d570770-plan.dgn		DRAWN - GMS	REVISED -
	PLOT SCALE = 40.0000' / IN.	CHECKED -	REVISED -
	PLOT DATE = 3/18/2009	DATE -	REVISED -

STATE OF ILLINOIS
DEPARTMENT OF TRANSPORTATION

PLAN SHEET
S.N. 092-0033

SCALE: SHEET NO. OF SHEETS STA. TO STA.

F.A. RTE.	SECTION	COUNTY	TOTAL SHEETS	SHEET NO.
VAR.	*	**	22	10
CONTRACT NO. 70770				
ILLINOIS FED. AID PROJECT				

PLAN	SURVEYED	BY	DATE
	PLOTTED		
	GRADES CHECKED		
	STRUCTURE NOTATION CHECKED		
	NO.		
	CADD FILE NAME		

PROFILE	SURVEYED	BY	DATE
	PLOTTED		
	GRADES CHECKED		
	STRUCTURE NOTATION CHECKED		
	NO.		
	CADD FILE NAME		

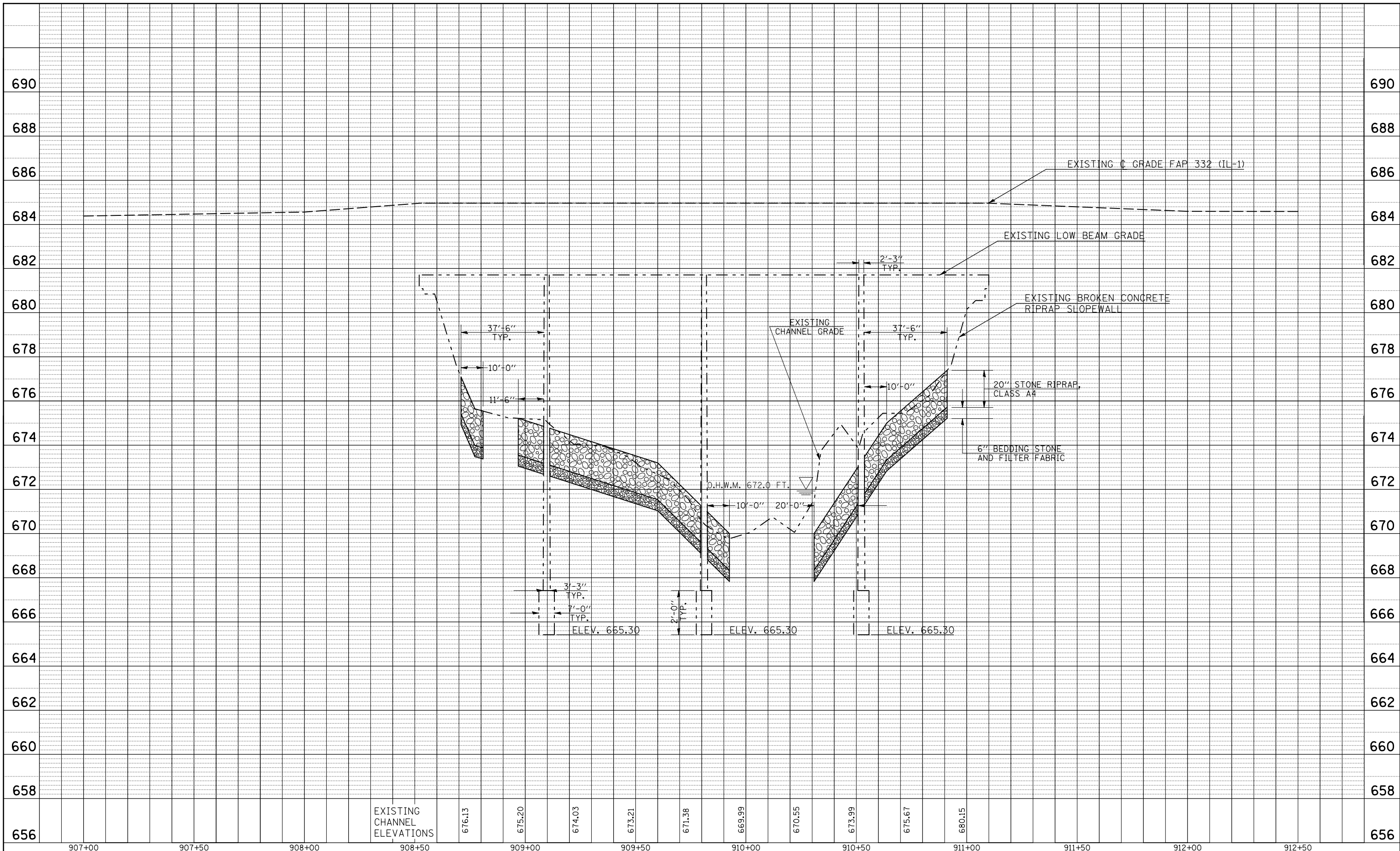

EXISTING CHANNEL ELEVATIONS

676.13 675.20 674.03 673.21 671.38 669.99 670.55 673.99 675.67 680.15

* D5 SCOUR MITIGATION 2009-3
 ** CHAMPAIGN & VERMILION

FILE NAME = c:\pwwork\pwwid01\SIMSGMI\d0120266\d570770-plan.dgn
 USER NAME = simsgm
 PLOT SCALE = 40.0000' / IN.
 PLOT DATE = 6/26/2009

DESIGNED -	BJH	REVISED -	
DRAWN -	GMS	REVISED -	
CHECKED -		REVISED -	
DATE -		REVISED -	

**STATE OF ILLINOIS
 DEPARTMENT OF TRANSPORTATION**

**PROFILE SHEET S.N. 092-0033
 AT UPSTREAM FACE**

SCALE: SHEET NO. OF SHEETS STA. TO STA.

F.A. RTE.	SECTION	COUNTY	TOTAL SHEETS	SHEET NO.
VAR.	*	**	22	11
				CONTRACT NO. 70770
ILLINOIS FED. AID PROJECT				

PLAN	SURVEYED	BY	DATE
	PLOTTED		
	GRADES CHECKED		
	STRUCTURE NOTATION CHECKED		
	NO.		
	CADD FILE NAME		

PROFILE	SURVEYED	BY	DATE
	PLOTTED		
	GRADES CHECKED		
	STRUCTURE NOTATION CHECKED		
	NO.		
	CADD FILE NAME		

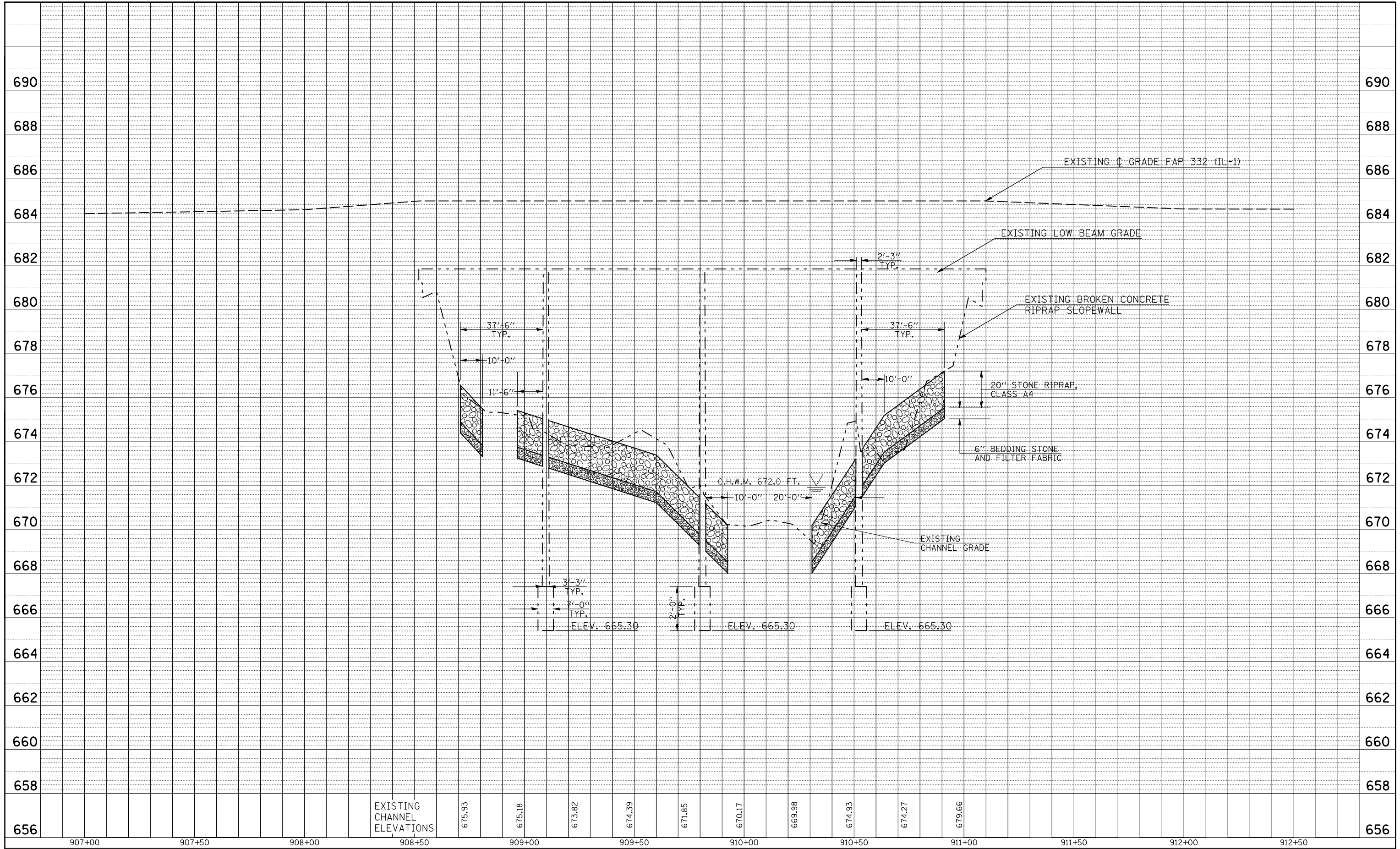

• D5 SCOUR MITIGATION 2009-3
 ** CHAMPAIGN & VERMILION

FILE NAME =
 USER NAME = smsgm
 PLOT SCALE = 40.0000' / IN.
 PLOT DATE = 6/26/2009

DESIGNED -	BJH	REVISED -	
DRAWN -	GMS	REVISED -	
CHECKED -		REVISED -	
DATE -		REVISED -	

**STATE OF ILLINOIS
 DEPARTMENT OF TRANSPORTATION**

**PROFILE SHEET S.N. 092-0033
 UNDER CENTER OF BRIDGE**

SCALE: SHEET NO. OF SHEETS STA. TO STA.

F.A. RTE.	SECTION	COUNTY	TOTAL SHEETS	SHEET NO.
VAR.	*	**	22	12
				CONTRACT NO. 70770
ILLINOIS FED. AID PROJECT				

PLAN	SURVEYED	BY	DATE
	PLOTTED		
	GRADES CHECKED		
	STRUCTURE NOTATION		
	NO. _____		
	CAD FILE NAME		

PROFILE	SURVEYED	BY	DATE
	PLOTTED		
	GRADES CHECKED		
	STRUCTURE NOTATION		
	NO. _____		
	CAD FILE NAME		

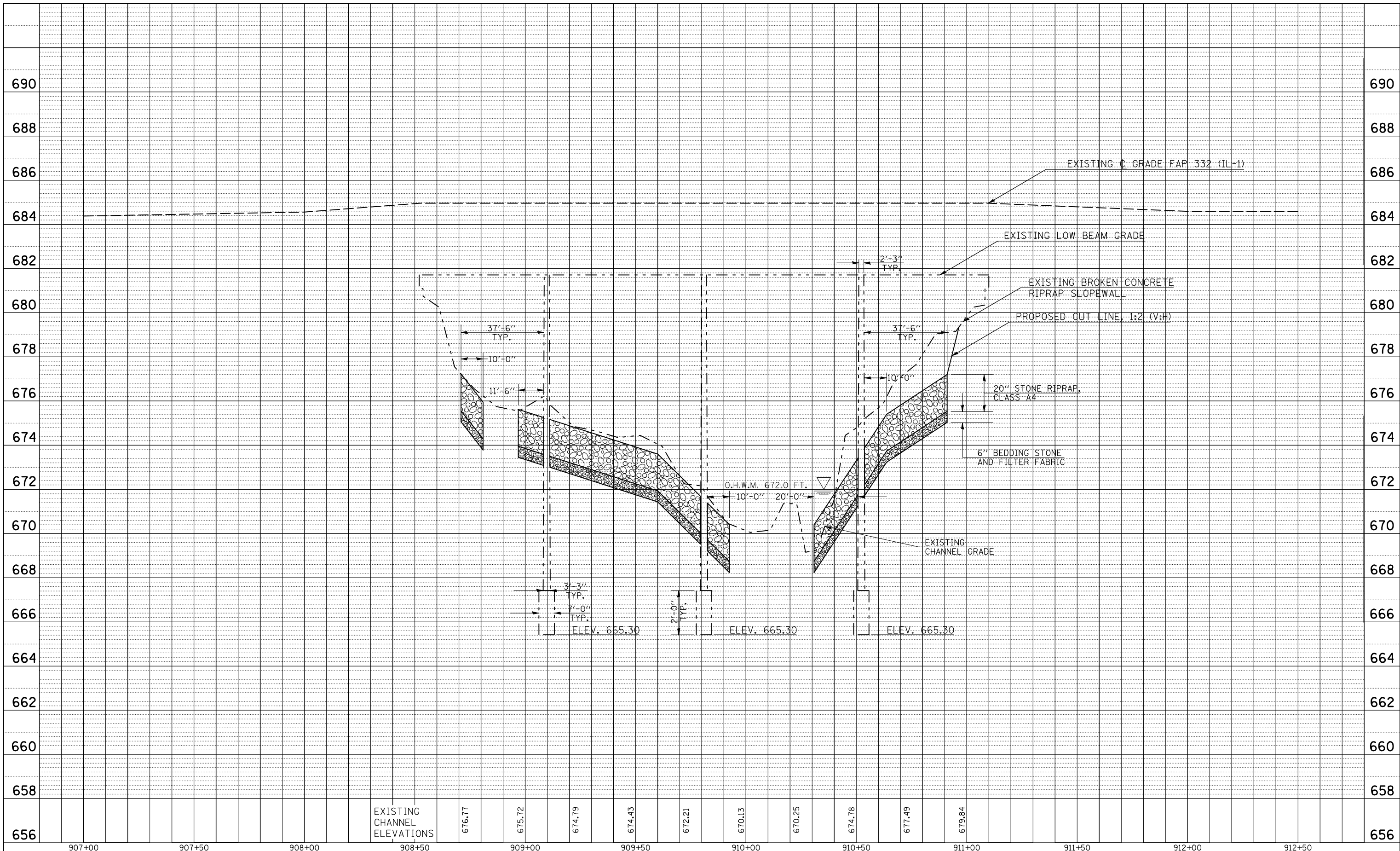

EXISTING CHANNEL ELEVATIONS

676.77 675.72 674.79 674.43 672.21 670.13 670.25 674.78 677.49 679.84

907+00 907+50 908+00 908+50 909+00 909+50 910+00 910+50 911+00 911+50 912+00 912+50

* D5 SCOUR MITIGATION 2009-3
** CHAMPAIGN & VERMILION

FILE NAME =
ct:\pwork\PWIDOT\SIMSGMI\d0120266\d570770-plan.dgn
PLOT SCALE = 40.0000 ' / IN.
PLOT DATE = 6/26/2009

DESIGNED -	BJH	REVISED -	
DRAWN -	GMS	REVISED -	
CHECKED -		REVISED -	
DATE -		REVISED -	

**STATE OF ILLINOIS
DEPARTMENT OF TRANSPORTATION**

**PROFILE SHEET S.N. 092-0033
AT DOWNSTREAM FACE**

SCALE: SHEET NO. OF SHEETS STA. TO STA.

F.A. RTE.	SECTION	COUNTY	TOTAL SHEETS	SHEET NO.
VAR.	*	**	22	13
				CONTRACT NO. 70770
ILLINOIS FED. AID PROJECT				

B.M. 4446-42:
A CHISELED SQUARE IN THE N.E.
WING OF S.N. 092-0144
ELEVATION: 618.51

S.N. 092-0144 LOCATION #4

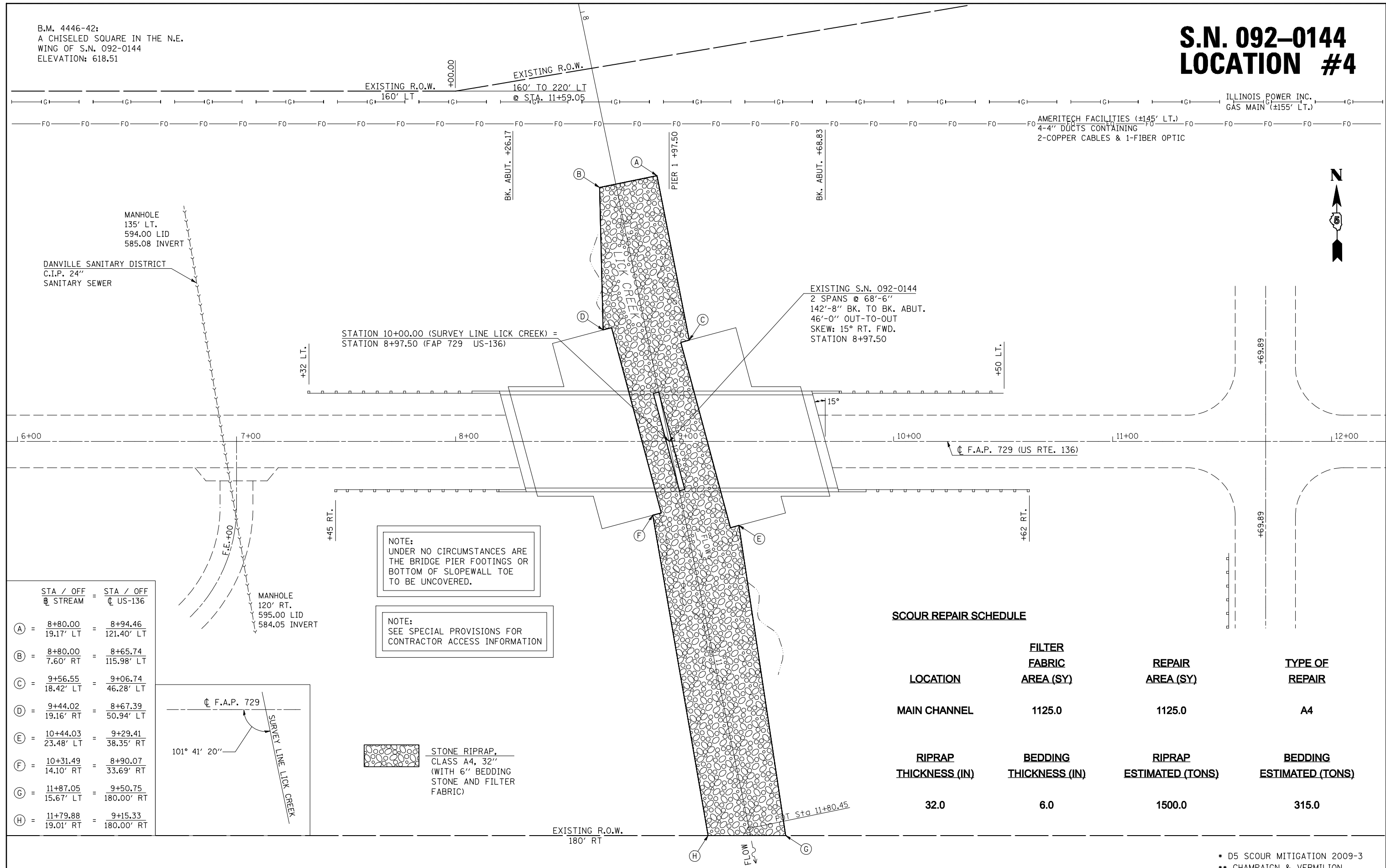

STA / OFF # STREAM	=	STA / OFF # US-136
(A) = 8+80.00 19.17' LT	=	8+94.46 121.40' LT
(B) = 8+80.00 7.60' RT	=	8+65.74 115.98' LT
(C) = 9+56.55 18.42' LT	=	9+06.74 46.28' LT
(D) = 9+44.02 19.16' RT	=	8+67.39 50.94' LT
(E) = 10+44.03 23.48' LT	=	9+29.41 38.35' RT
(F) = 10+31.49 14.10' RT	=	8+90.07 33.69' RT
(G) = 11+87.05 15.67' LT	=	9+50.75 180.00' RT
(H) = 11+79.88 19.01' RT	=	9+15.33 180.00' RT

NOTE:
UNDER NO CIRCUMSTANCES ARE
THE BRIDGE PIER FOOTINGS OR
BOTTOM OF SLOPEWALL TOE
TO BE UNCOVERED.

NOTE:
SEE SPECIAL PROVISIONS FOR
CONTRACTOR ACCESS INFORMATION

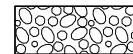
 STONE RIPRAP,
CLASS A4, 32"
(WITH 6" BEDDING
STONE AND FILTER
FABRIC)

SCOUR REPAIR SCHEDULE

LOCATION	FILTER FABRIC AREA (SY)	REPAIR AREA (SY)	TYPE OF REPAIR
MAIN CHANNEL	1125.0	1125.0	A4
RIPRAP THICKNESS (IN)	BEDDING THICKNESS (IN)	RIPRAP ESTIMATED (TONS)	BEDDING ESTIMATED (TONS)
32.0	6.0	1500.0	315.0

FILE NAME =	USER NAME = smsgm	DESIGNED - BJH	REVISED -
et:\pwork\p\WIDOT\SMSGM\d0120266\d570770-plan.dgn		DRAWN - GMS	REVISED -
PLOT SCALE = 40.0000' / IN.		CHECKED -	REVISED -
PLOT DATE = 3/18/2009		DATE -	REVISED -

STATE OF ILLINOIS
DEPARTMENT OF TRANSPORTATION

PLAN SHEET
S.N. 092-0144

SCALE: SHEET NO. OF SHEETS STA. TO STA.

F.A. RTE.	SECTION	COUNTY	TOTAL SHEETS	SHEET NO.
VAR.	*	**	22	14
CONTRACT NO. 70770				
ILLINOIS FED. AID PROJECT				

* D5 SCOUR MITIGATION 2009-3
** CHAMPAIGN & VERMILION

PLAN	SURVEYED	DATE
	PLOTTED	
	CHECKED	
	BY	
	NO.	
	FILE NAME	

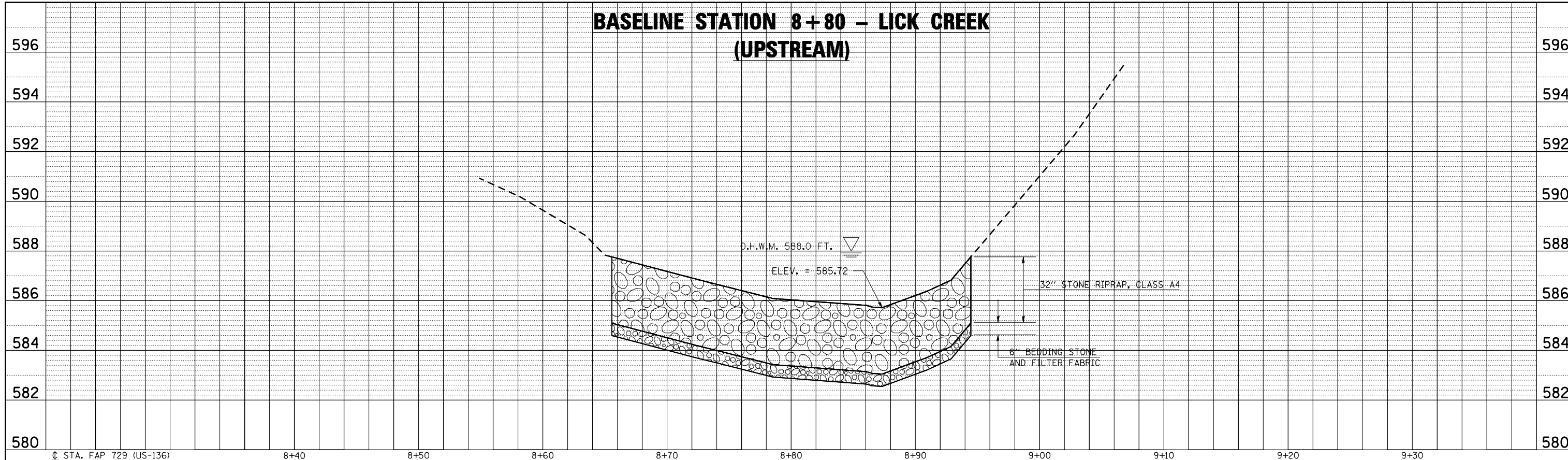

PROFILE	SURVEYED	DATE
	PLOTTED	
	CHECKED	
	BY	
	NO.	
	FILE NAME	

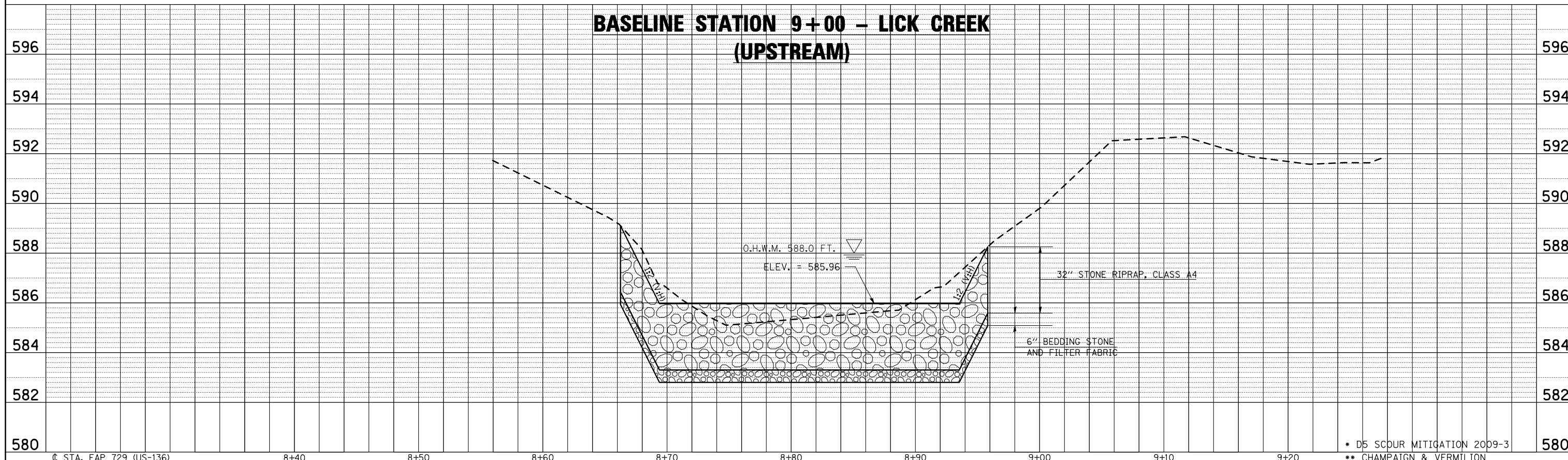

* D5 SCOUR MITIGATION 2009-3
** CHAMPAIGN & VERMILION

FILE NAME =	USER NAME = s1msgm	DESIGNED - BJH	REVISED -	STATE OF ILLINOIS DEPARTMENT OF TRANSPORTATION	UPSTREAM CROSS SECTIONS S.N. 092-0144			F.A. RTE.	SECTION	COUNTY	TOTAL SHEETS	SHEET NO.
ct:\pwwork\pwid01\SIMSGMI\d0120266\d570770-plan.dgn	DRAWN - GMS	REVISED -	REVISED -		SCALE:	SHEET NO.	OF SHEETS	STA.	TO STA.	CONTRACT NO. 70770	22	16
PLOT SCALE = 40.0000' / IN.	CHECKED -	REVISED -	REVISED -									
PLOT DATE = 6/26/2009	DATE -	REVISED -	REVISED -									

ILLINOIS FED. AID PROJECT

PLAN	SURVEYED	DATE
	PLOTTED	
	GRADES CHECKED	
	STRUCTURE NOTATION CHECKED	
	NOTE BOOK NO.	
	CADD FILE NAME	

PROFILE	SURVEYED	DATE
	PLOTTED	
	GRADES CHECKED	
	STRUCTURE NOTATION CHECKED	
	NOTE BOOK NO.	
	CADD FILE NAME	

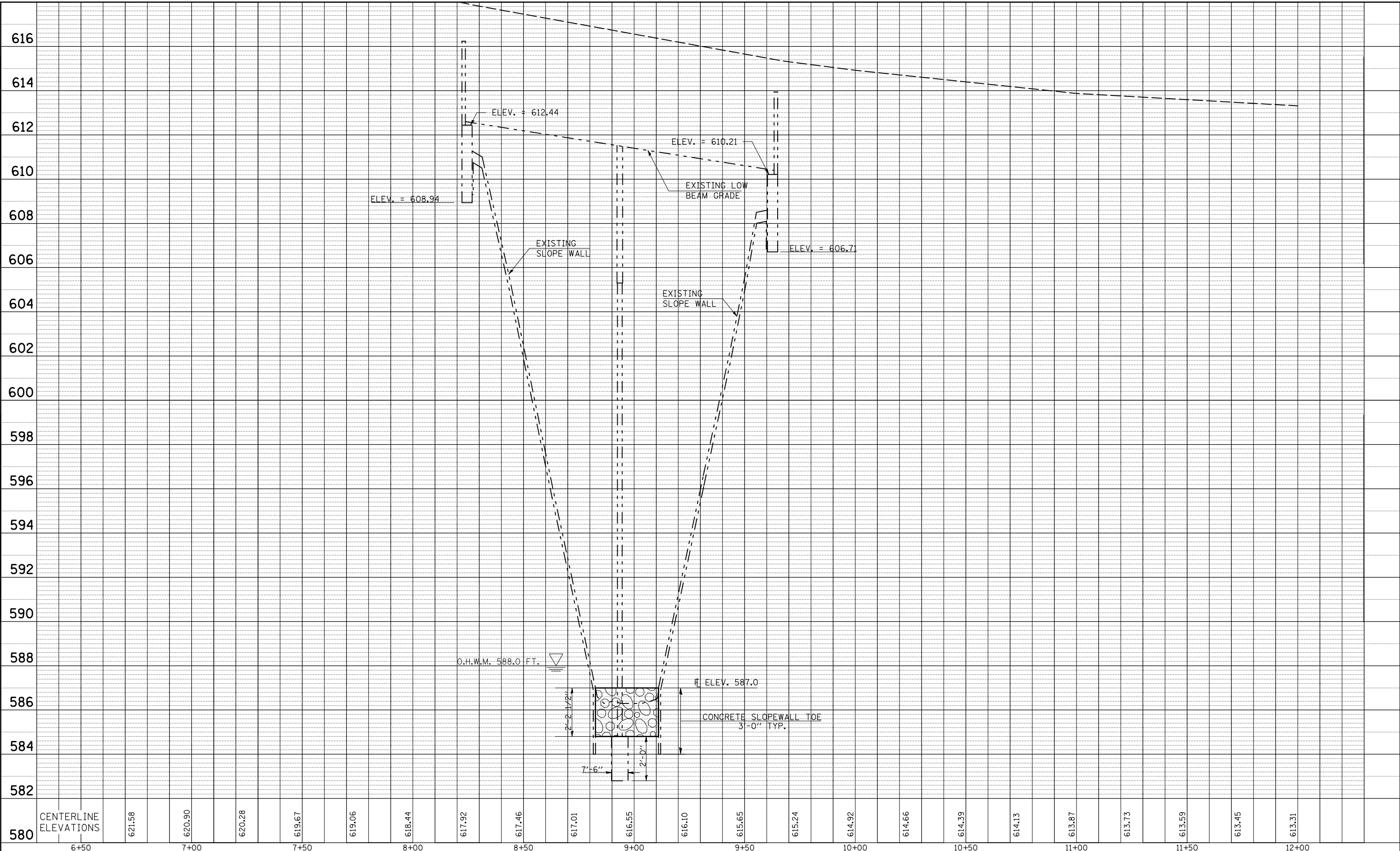

• D5 SCOUR MITIGATION 2009-3
 ** CHAMPAIGN & VERMILION

FILE NAME =	USER NAME = smsgm	DESIGNED - BJH	REVISED -
ct:\pwork\PWIDOT\SIMSGMI\0120266\d570770-plan.dgn		DRAWN - GMS	REVISED -
	PLOT SCALE = 40.0000' / IN.	CHECKED -	REVISED -
	PLOT DATE = 6/26/2009	DATE -	REVISED -

**STATE OF ILLINOIS
 DEPARTMENT OF TRANSPORTATION**

**CROSS SECTION UPSTREAM BRIDGE OPENING
 S.N. 092-0144**

SCALE: SHEET NO. OF SHEETS STA. TO STA.

F.A. RTE.	SECTION	COUNTY	TOTAL SHEETS	SHEET NO.
VAR.	*	**	22	17
			CONTRACT NO. 70770	
ILLINOIS FED. AID PROJECT				

PLAN	SURVEYED	DATE
	PLOTTED	
	CHECKED	
	BY	
	NO.	
	FILE NAME	

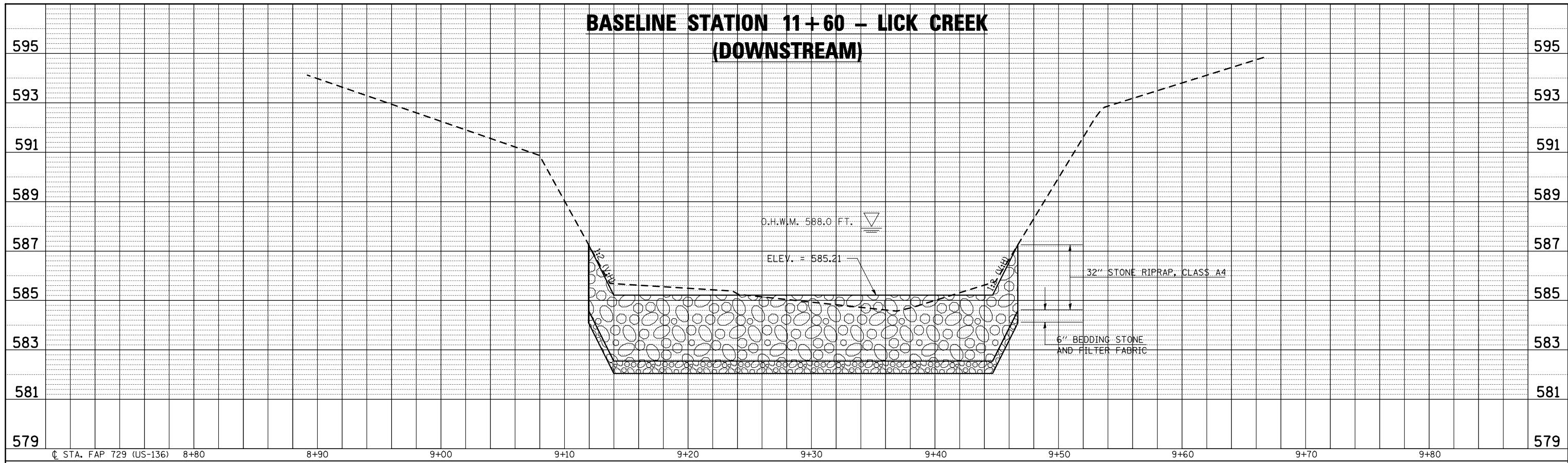

PROFILE	SURVEYED	DATE
	PLOTTED	
	CHECKED	
	BY	
	NO.	
	FILE NAME	

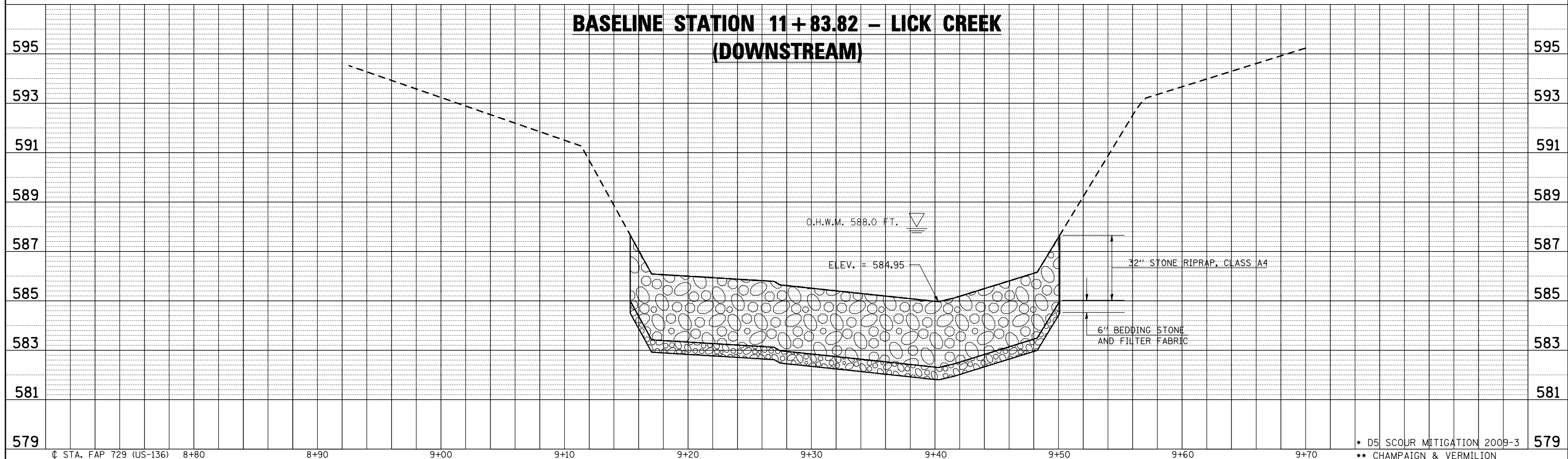

**DETAIL FOR RIPRAP
BETWEEN SLOPE WALL TOES
S.N. 092-0001 & S.N. 092-0002**

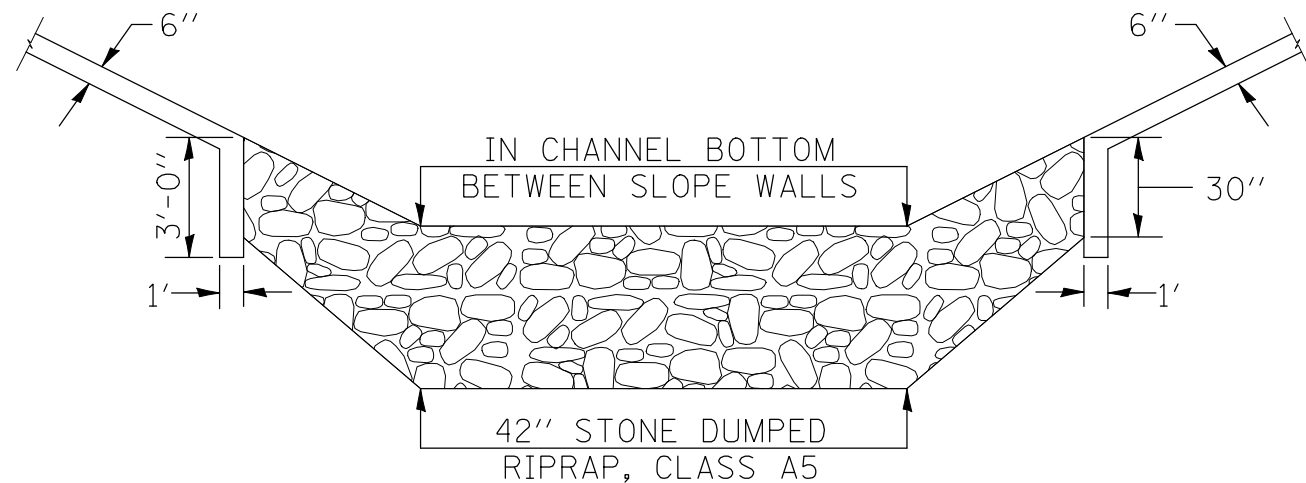

**DETAIL FOR RIPRAP
TOE ALONG FLOW LINE
S.N. 010-0029 & S.N. 010-0030**

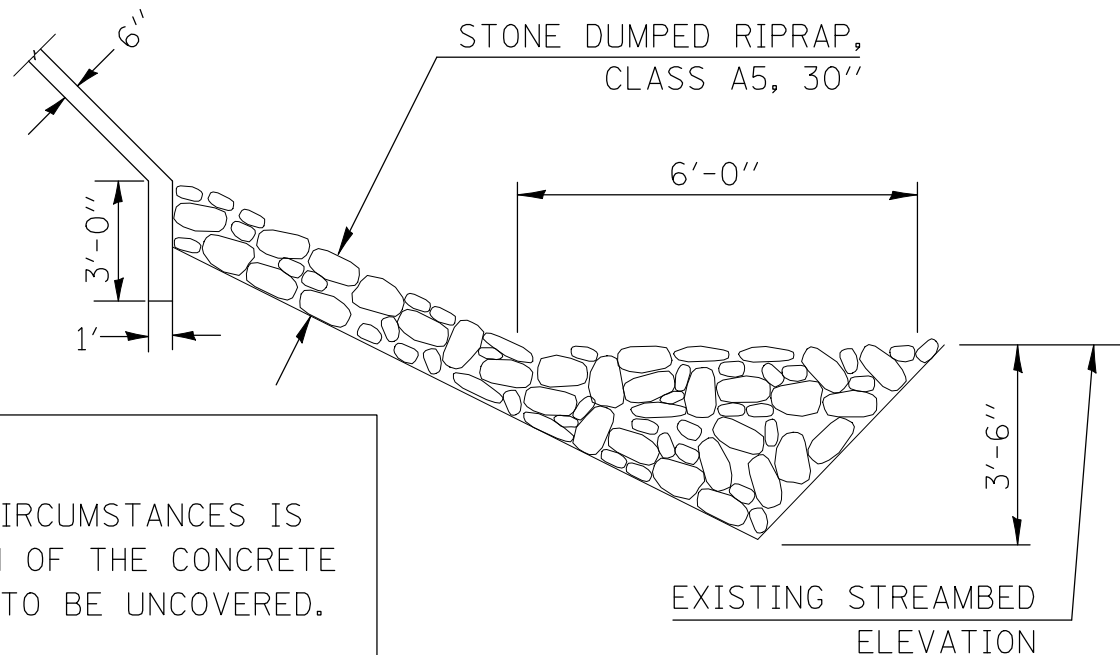

NOTE:
UNDER NO CIRCUMSTANCES IS
THE BOTTOM OF THE CONCRETE
SLOPEWALL TO BE UNCOVERED.

**DETAIL FOR RIPRAP TOE ALONG THE FLOWLINE
AT PIER #2 AND PIER #3 @ S.N. 092-0033**

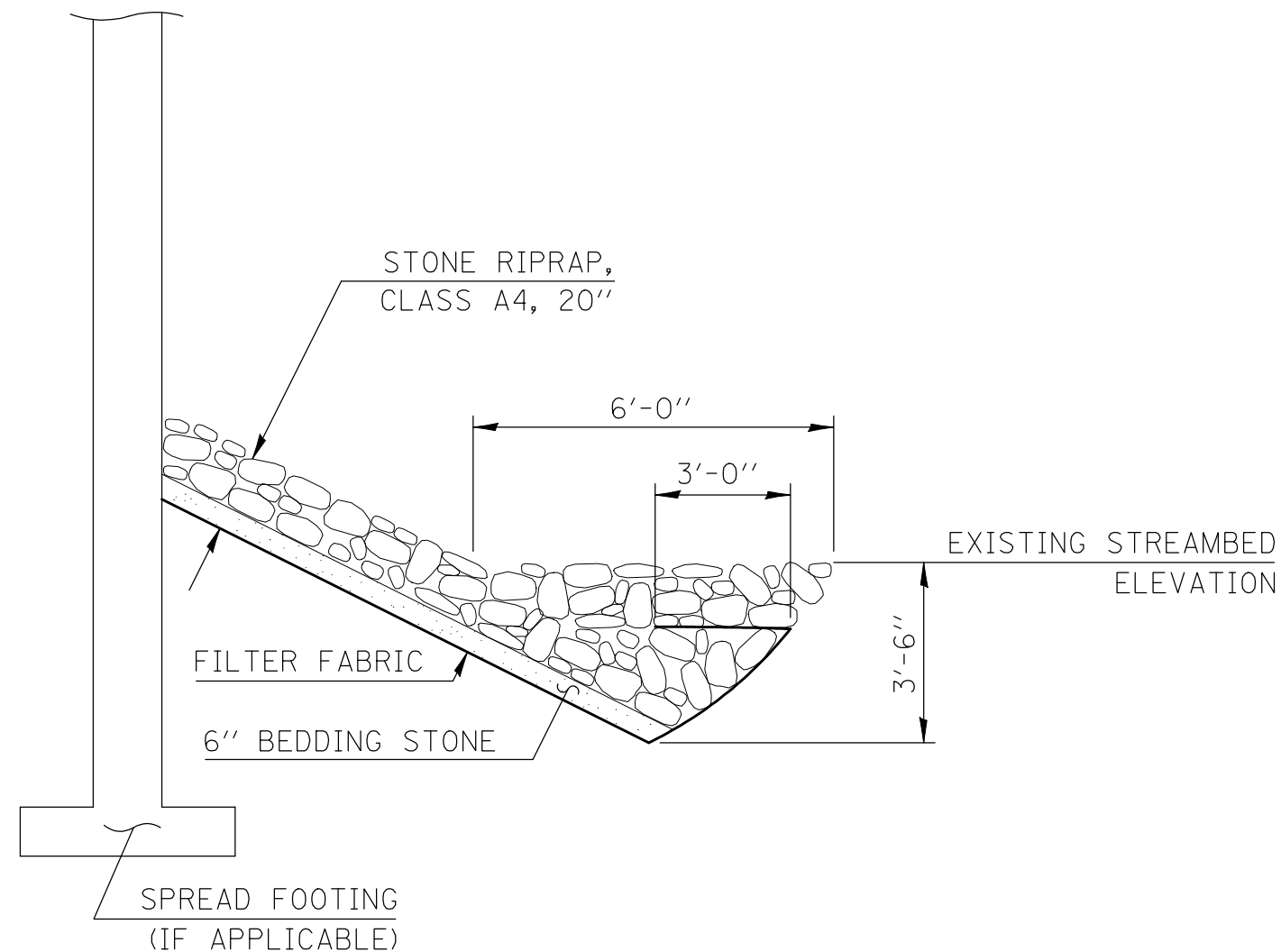

NOTE:
UNDER NO CIRCUMSTANCES
ARE THE BRIDGE PIER OR
ABUTMENT FOOTINGS TO
BE UNCOVERED.

* D5 SCOUR MITIGATION 2009-3
** CHAMPAIGN & VERMILION

FILE NAME =	USER NAME = s1msgm	DESIGNED - BJH	REVISED -
ct:\pw\work\PWIDOT\SIMSGM1\0120266\d570770-plen.dgn		DRAWN - GMS	REVISED -
	PLOT SCALE = 40.0000' / IN.	CHECKED -	REVISED -
	PLOT DATE = 6/26/2009	DATE -	REVISED -

**STATE OF ILLINOIS
DEPARTMENT OF TRANSPORTATION**

**RIPRAP DETAILS
TOE ALONG FLOWLINE**

SCALE: SHEET NO. OF SHEETS STA. TO STA.

F.A. RTE.	SECTION	COUNTY	TOTAL SHEETS	SHEET NO.
VAR.	*	**	22	20
CONTRACT NO. 70770				
ILLINOIS FED. AID PROJECT				

**DETAIL FOR UPSTREAM
EDGE OF RIPRAP
S.N. 092-0033 AND S.N. 092-0144**

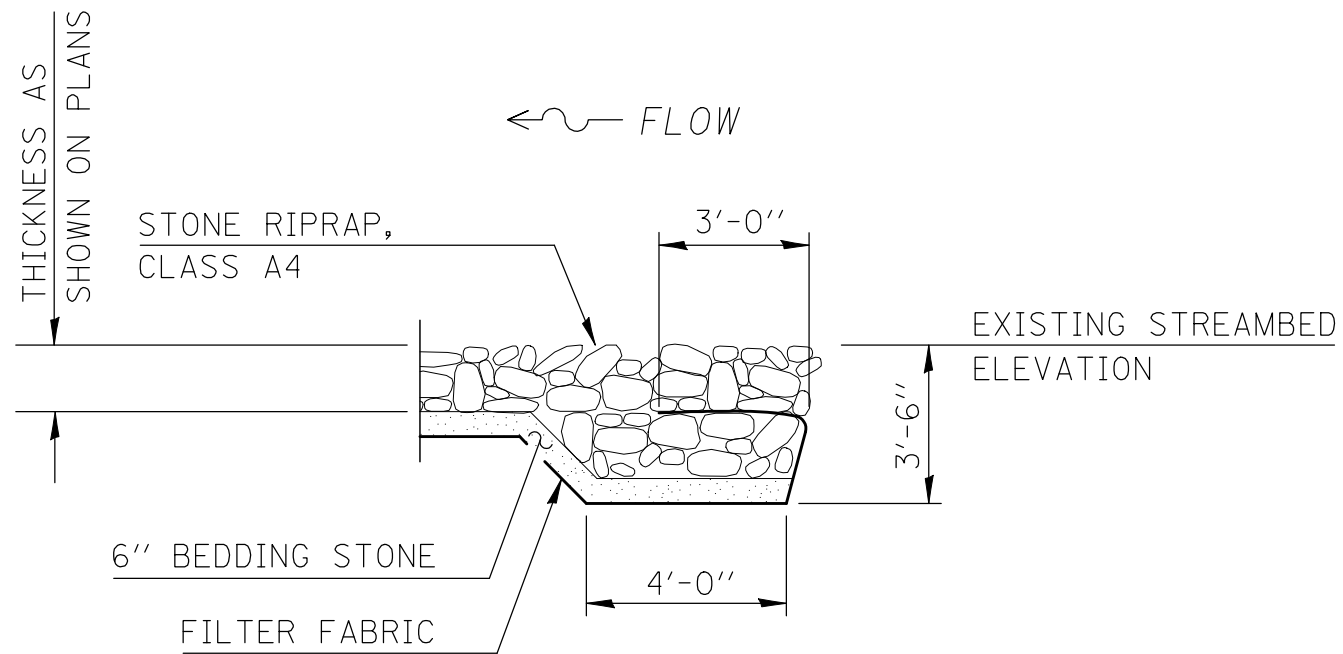

**DETAIL FOR UPSTREAM
EDGE OF RIPRAP
S.N. 010-0029 & S.N. 010-0030
S.N. 092-0001 & S.N. 092-0002**

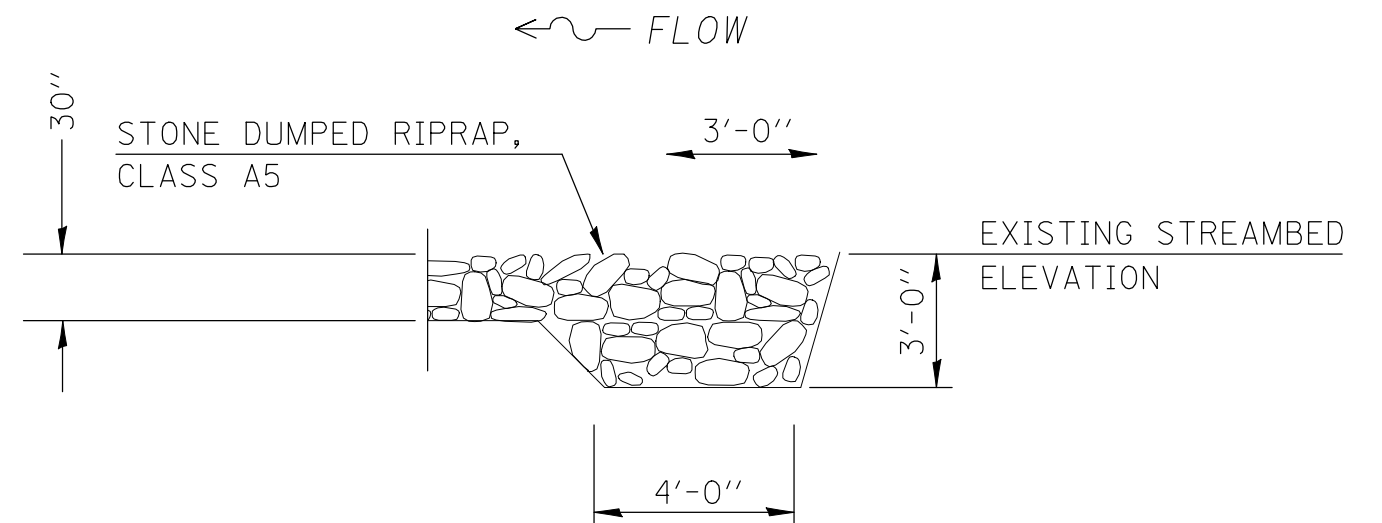

* D5 SCOUR MITIGATION 2009-3
** CHAMPAIGN & VERMILION

FILE NAME =	USER NAME = s1msgm	DESIGNED - BJH	REVISED -
ct:\pw\work\PWIDOT\S1MSGM\d0120266\d570770-plan.dgn		DRAWN - GMS	REVISED -
	PLOT SCALE = 40.0000' / IN.	CHECKED -	REVISED -
	PLOT DATE = 3/18/2009	DATE -	REVISED -

**STATE OF ILLINOIS
DEPARTMENT OF TRANSPORTATION**

**RIPRAP DETAILS
UPSTREAM EDGE**

SCALE: SHEET NO. OF SHEETS STA. TO STA.

F.A. RTE.	SECTION	COUNTY	TOTAL SHEETS	SHEET NO.
VAR.	*	**	22	21
			CONTRACT NO. 70770	
ILLINOIS FED. AID PROJECT				

**PROPOSED STONE RIPRAP, CLASS A5 DITCH
CROSS SECTION**

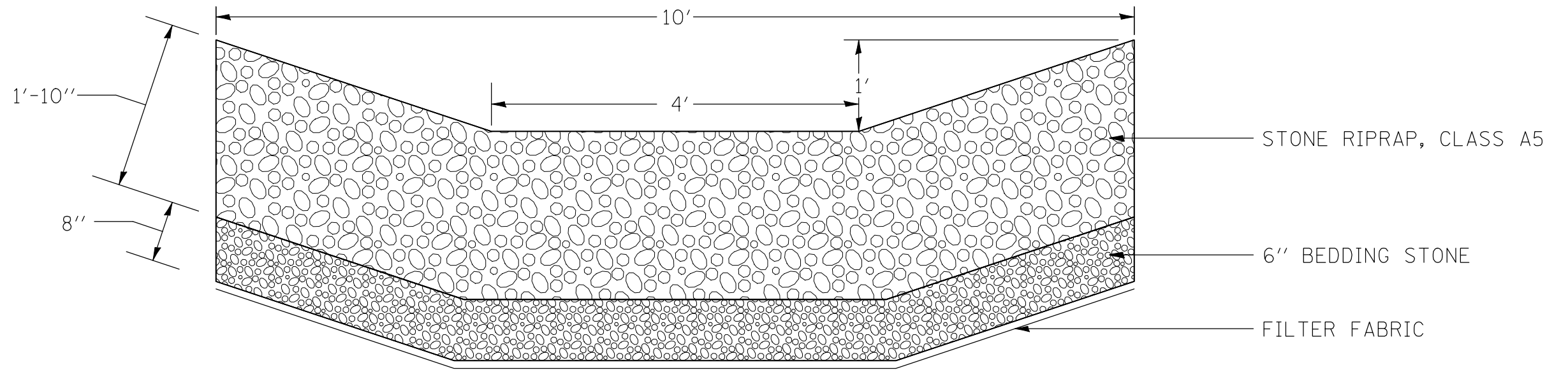

**EXISTING PAVED DITCH
CROSS SECTION**

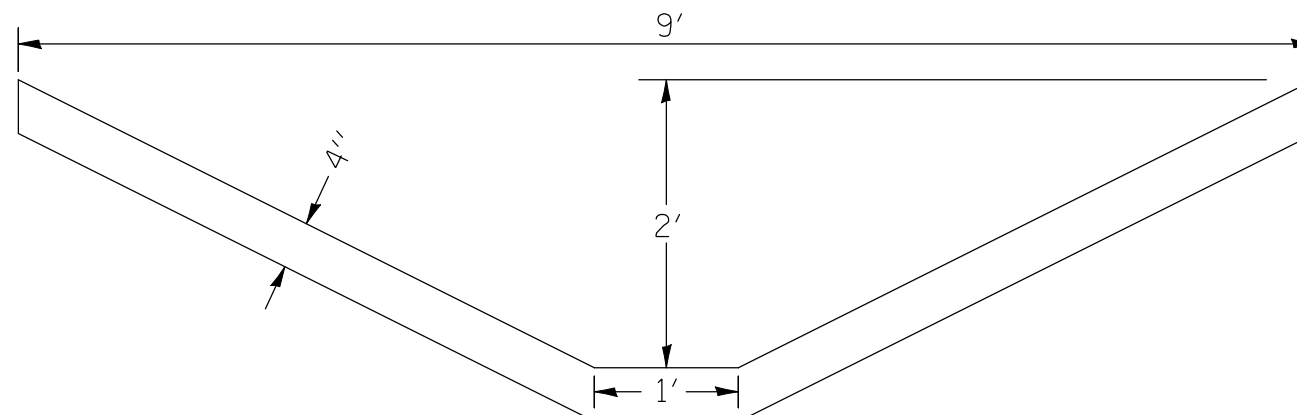

* D5 SCOUR MITIGATION 2009-3
** CHAMPAIGN & VERMILION

FILE NAME =	USER NAME = s1msgm	DESIGNED - BJH	REVISED -
ct\pwork\pwidot\simsgm\d0120266\d570770-plan.dgn		DRAWN - GMS	REVISED -
	PLOT SCALE = 40.0000' / IN.	CHECKED -	REVISED -
	PLOT DATE = 3/18/2009	DATE -	REVISED -

**STATE OF ILLINOIS
DEPARTMENT OF TRANSPORTATION**

**RIPRAP DETAILS
DITCH ARMORING**

SCALE: SHEET NO. OF SHEETS STA. TO STA.

F.A. RTE.	SECTION	COUNTY	TOTAL SHEETS	SHEET NO.
VAR.	*	**	22	22
FED. ROAD DIST. NO. ILLINOIS FED. AID PROJECT			CONTRACT NO. 70770	