

NOTE: SOME QUANTITIES CONTAINED HEREIN ARE OUTSIDE THE PROJECT LIMITS

STAGE I TRAFFIC

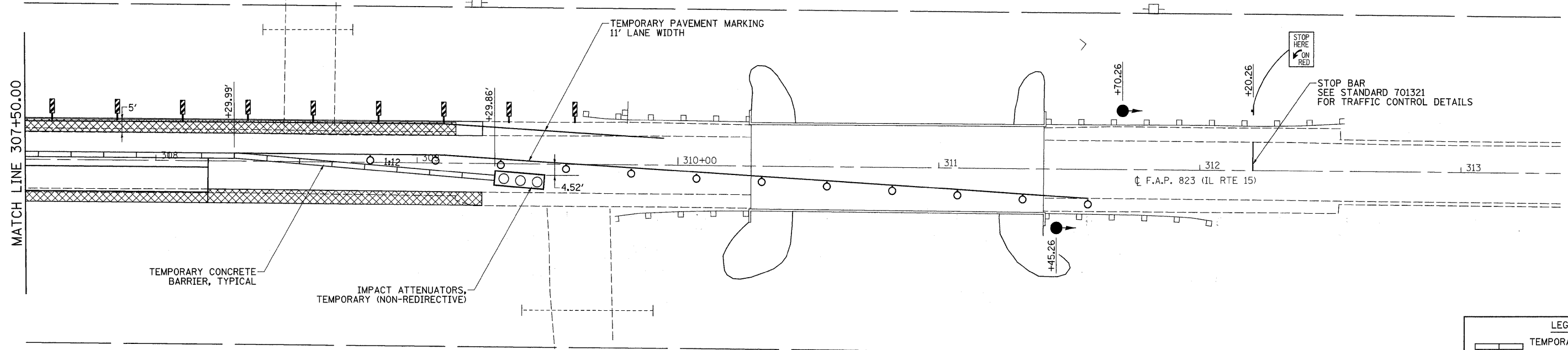

IMPACT ATTENUATORS, TEMPORARY
NON-REDIRECTIVE, TEST LEVEL 2
STA. 309+29.86 RT 1 EACH

LEGEND	
	TEMPORARY CONCRETE BARRIER
	TO BE REMOVED
	EXISTING
	PROPOSED
	PROPOSED BASE COURSE WIDENING

NOTES FOR STAGE I

1. SEE BRIDGE PLANS FOR ADDITIONAL INFORMATION ON STAGE CONSTRUCTION
2. THE CONTRACTOR SHALL PROVIDE CONTINUOUS ACCESS TO ALL ENTRANCES DURING CONSTRUCTION.
3. STOP BARS TO BE LOCATED PER STD. 701321.

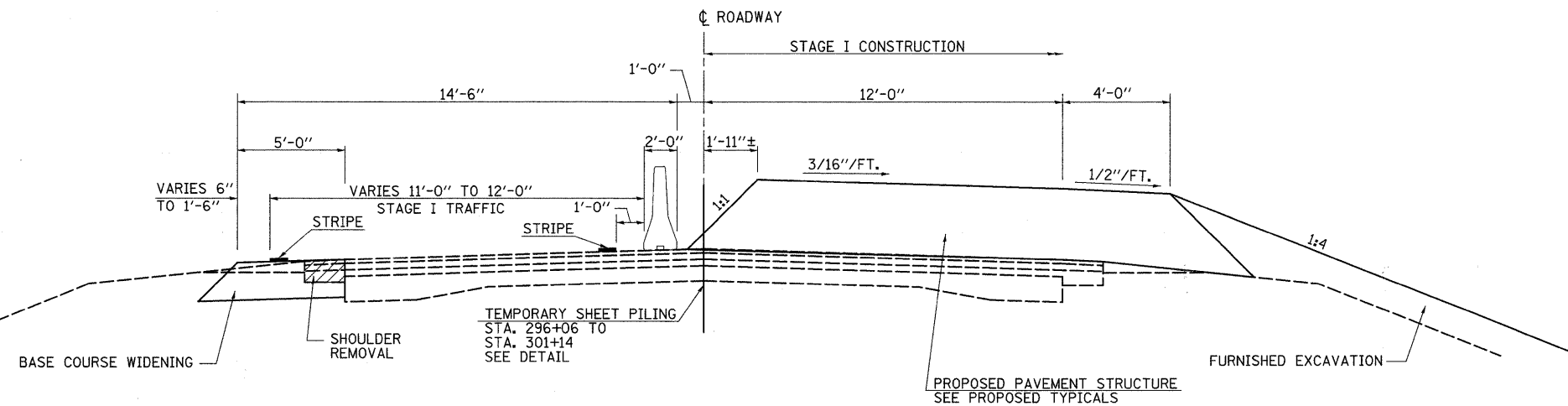

PROPOSED TYPICAL SECTION (STAGE I)

- NOTES:
1. BOTTOM OF SHEET = 4'-0" BELOW EXIST. PGL
 2. MAXIMUM RETAINED HT = 3'-4" ABOVE EXISTING PAVEMENT.
 3. MIN. SECTION MODULUS OF TEMPORARY SHEET PILING = 0.8 IN⁴/FT

STAGE I NOTES

1. CONSTRUCT BASE COURSE WIDENING FOR STAGE I TRAFFIC USING TRAFFIC CONTROL STANDARD 701326.
2. ERECT SIGNS, TRAFFIC SIGNALS, TEMPORARY BARRIERS, ETC. ACCORDING TO TRAFFIC CONTROL STANDARD 701321.
3. PLACE TEMPORARY PAVEMENT MARKING LINE TO ALLOW FOR A 12 FOOT TRAFFIC LANE.
4. REMOVE THE STAGE I PORTION OF THE EXISTING STRUCTURE, PAVEMENT AND GUARDRAIL
5. CONSTRUCT THE STAGE I PORTION OF THE NEW BRIDGE AND ROADWAY.
6. CONSTRUCT DITCHES, SEEDING, AND MULCH.
7. BASE COURSE WIDENING FOR STAGE II TRAFFIC.

TEMPORARY SHEET PILING DETAIL

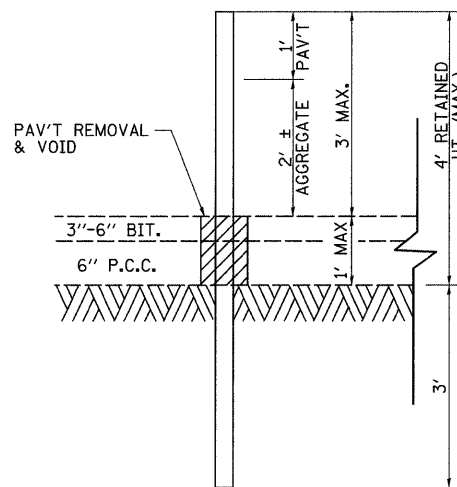

FILE NAME =	USER NAME = rook	DESIGNED -	REVISED -	STATE OF ILLINOIS DEPARTMENT OF TRANSPORTATION	STAGE I CONSTRUCTION		F.A.P. RTE.	SECTION	COUNTY	TOTAL SHEETS	SHEET NO.
P:\0340601.04.FIN\0960055\Drawings\StageC	const\stage_plans\16&17.dgn	DRAWN -	REVISED -		823	(22BY-1,22BY2,22BRB-1	WAYNE	142	23		
	PLOT SCALE = 20,0000' / IN.	CHECKED -	REVISED -		CONTRACT NO. 74238						
	PLOT DATE = 3/26/2009	DATE -	REVISED -		SCALE:	SHEET NO. 3 OF 6 SHEETS	STA.	TO STA.	FED. ROAD DIST. NO.	ILLINOIS FED. AID PROJECT	