

STATE OF ILLINOIS
DEPARTMENT OF TRANSPORTATION

INDEX OF SHEETS

Sheet No.	Description
1	Gen. Plan, Gen. Notes & Total Bill of Mat'l
2	Repair Details

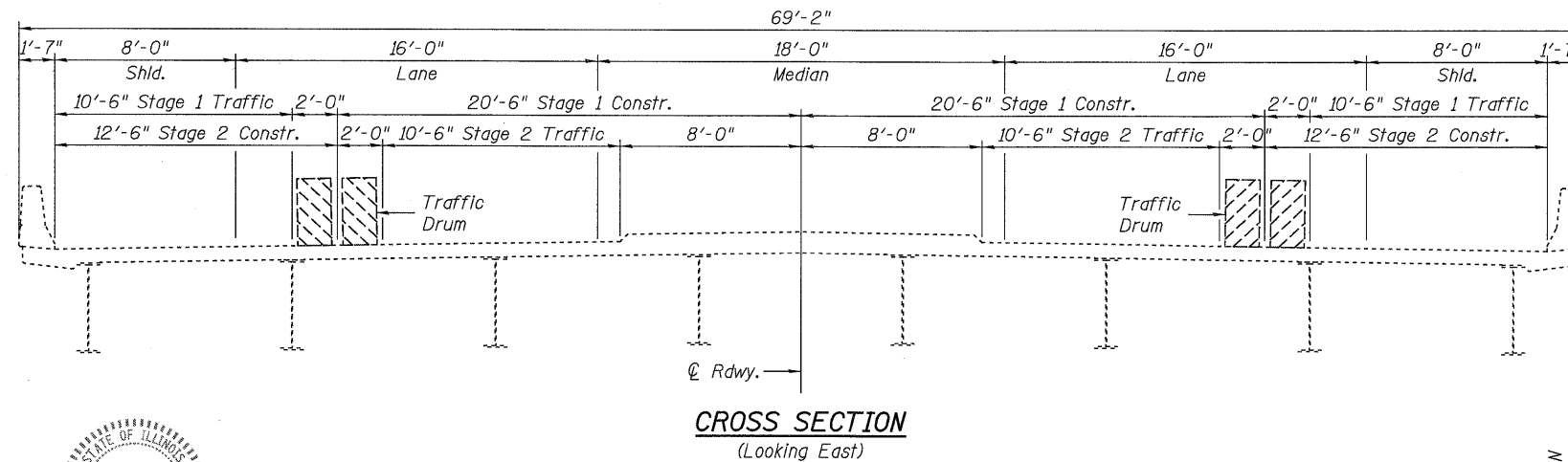
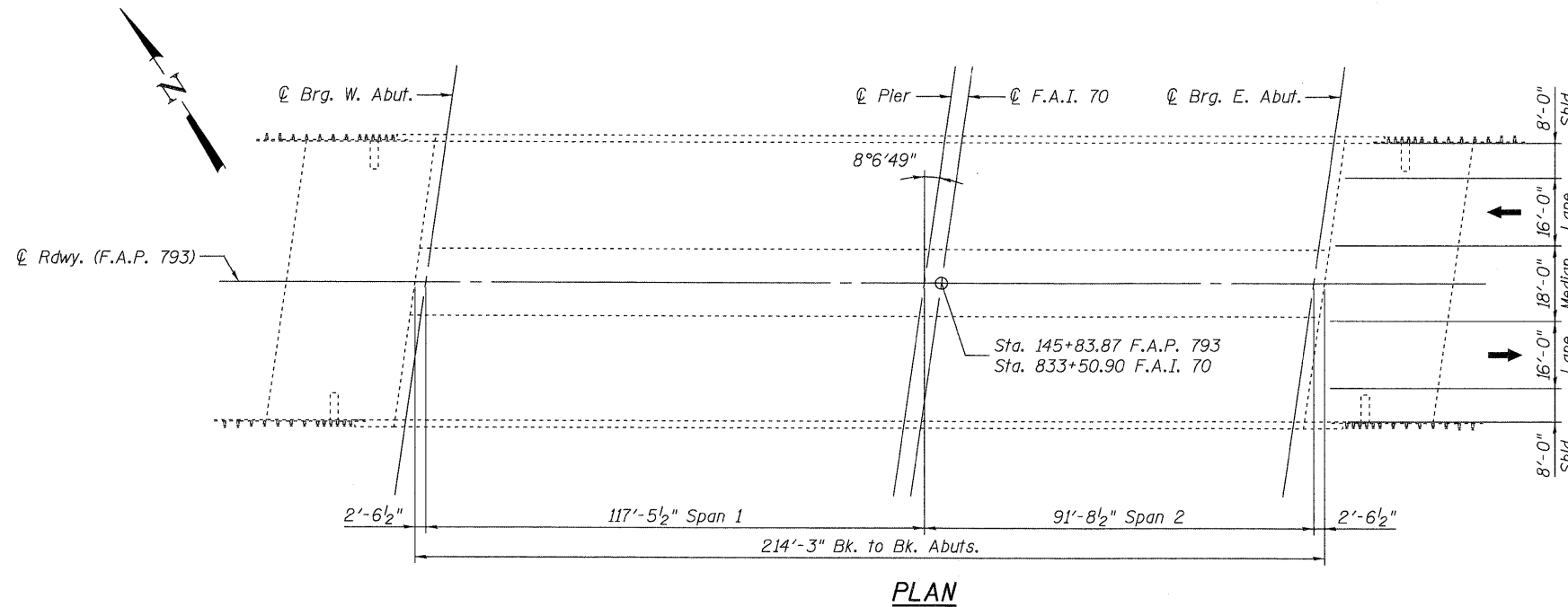
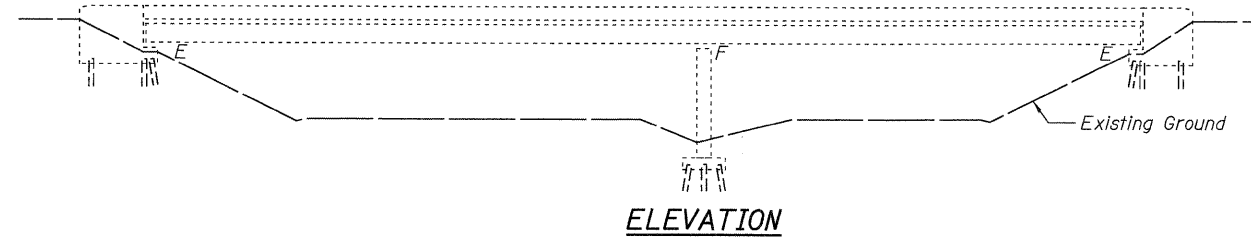

GENERAL NOTES

Concrete Sealer shall be applied to the surfaces of the approach pavements, bridge deck and parapets, including wings. See Special Provision for "BRIDGE DECK CONCRETE SEALER".

TOTAL BILL OF MATERIAL

ITEM	UNIT	SUPER	SUB	TOTAL
Structure Excavation	Cu Yd	--	3	3
Concrete Collar	Cu Yd	--	1.0	1.0
Concrete Sealer	Sq Ft	19616	--	19616
Bridge Washing No. 5	Each	1	--	1
Controlled Low-Strength Material	Cu Yd	--	4	4
Silicone Joint Sealer (Special)	Foot	--	46	46

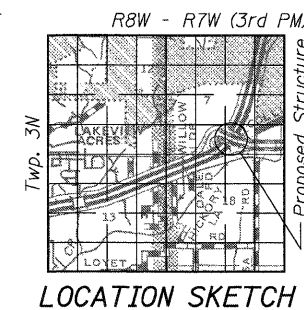

GENERAL PLAN & ELEVATION
F.A.P. ROUTE 793 (U.S. 40) OVER
F.A.I. ROUTE 70
STRUCTURE NO. 060-0267

SHEET 1 OF 2	F.A.I. RTE.	SECTION	COUNTY	TOTAL SHEETS	SHEET NO.
	70	60-(8,9,10)BR	MADISON	150	103
STA. 833+50.90			CONTRACT NO. 76A73		
FED. ROAD DIST. NO. ILLINOIS FED. AID PROJECT					

JD Johnson, Depp & Quisenberry
CONSULTING ENGINEERS
Springfield, Illinois

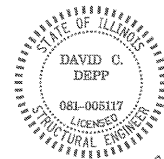

Signed: *David Depp*
Date: *6-4-2009*
Lic. Expires: 11-30-2010

DESIGNED: JDQ	DRAWN: PTR
CHECKED: DCD	CHECKED: DCD